

# Zip-UP UnderDeck™ System Installation Guide

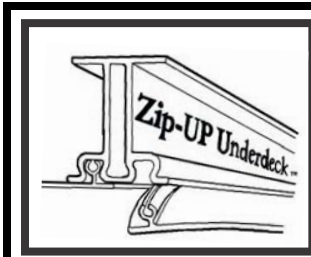

Easy as 1,2,3...

Install Wall Trim:  
Captures all cut edges

Zip-UP Your Panels into the Rails  
Panels space Rails perfectly every time

Trim out Your Zip-UP UnderDeck™ System  
Completely dry with the Zip-UP UnderDeck™ System

## IMPORTANT READ THESE INSTRUCTIONS CAREFULLY BEFORE BEGINNING INSTALLATION OF YOUR ZIP-UP UNDERDECK™ SYSTEM

### Zip-UP Terms

**Wall Trim:** The “E” shaped trim that attaches to the walls or joists around the entire periphery.

**Main Rail:** These are the mounting pieces that will run the length of your deck attached to the furring strips.

**Panel:** Refers to the show surface of your Zip-UP UnderDeck™ System. The Panels “Zip” into the Main Rails allowing for easy access for cleaning.

**Seam Trim:** This is the piece that allows for the extension of your UnderDeck application by capping the ends of Main Rails that do not end at Wall Trim. The next section is installed the same as the first.



*wall trim*

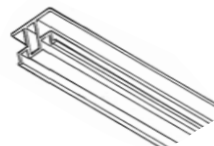

*rail*



*panel*

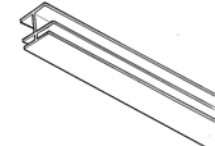

*seam trim*

### Before You Begin

**Preparing your Deck:** Take a good look at the area you are finishing. A typical deck will have the joists running perpendicular to the house. You will need to install a lattice work that runs perpendicular to your joists that will induce a gradient of 2 inches over 16 feet. You do this by attaching a furring strip perpendicular to your joists spread out about every 4 feet with each furring strip getting progressively thicker. For example; the first furring strip at 4 feet from the house would be ½ inch thick, the furring strip at 8 feet would be 1 inch thick, the furring strip at 12 feet would be 1 ½ inches thick, and the furring strip at 16 feet would be 2 inches thick. Use the “Self Leveling” method when attaching the furring strips. If you are to use a gutter system, the Zip-UP UnderDeck™ System should overlap the gutter system by at least 1 inch.

**WARNING:** Installing the Zip-UP UnderDeck™ System in temperatures below 50°F is not recommended. Making cuts and driving attachments into the product may cause cracks in the product below this temperature.

**Tools:** The tools you will use to install your Zip-UP UnderDeck™ System are as follows: tin snips, utility knife, hack saw, tape measure, vinyl siding hole punch, and a power drill/screwdriver.

**Plan your ceiling:** You will want to make sure that your ceiling is centered such that you do not end up with a very small panel on either side of your deck. Measure your deck width to start. Since the center of Main Rail to center of Main Rail dimension is 12 1/8 inches, you will need to divide the deck width by this number to derive the amount of panels you need. If Your deck is longer than the length of panels available, you will need to plan for a seam. You can start from the center of your deck and work to the sides, or you can start from one side and work across the deck to the other side.

**Estimating materials:** To estimate your materials you will start with the Wall Trim. Sum the lengths of the sides of the deck and divide by 12 feet. Round up to the nearest whole number for the total number of Wall Trim needed. The number of Panels will be derived from the width of your deck, taking into consideration your layout calculated in the previous step. The amount of Main Rails for each section equals the number of Panels minus one. If your deck is longer than the length of Panel available, you will need to determine how many seams are required. The amount of Seam Rail you need is based on the width of the deck and the number of seams needed.

**Additional materials:** Screws work best for attaching your Zip-UP UnderDeck™ System. We recommend using 1” to 1 1/2” dry-wall screws with washers. Furring strips will be needed to induce a gradient. A gutter system maybe needed to direct run off water.

**WARNING:** Corners and cut edges may be sharp. Wear safety glasses and use due care when handling.



# Wall Trim and Rails

## Installing Wall Trim

Install the Wall Trim along the sides of the deck (figure 2-1) that will not have a gutter. Where applicable, attach the Wall Trim to the furring strips to ensure the Wall Trim will follow the same gradient as the rest of the ceiling (figure 2-2).

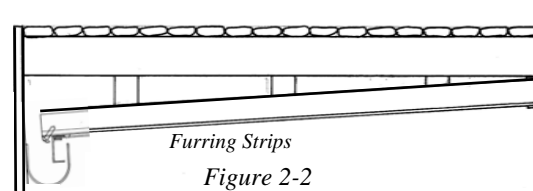
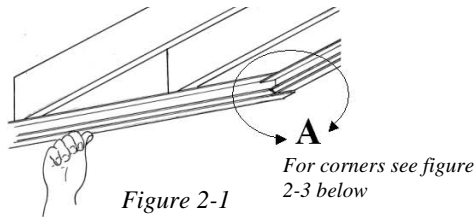

Corners can be mitered, or simply overlapped as indicated in figure 2-1 and 2-3. To make the overlap condition, the Middle flange of the wall trim should be cut out at a 45 degree angel. This will allow the panel to fit in properly with out Bulging the material.

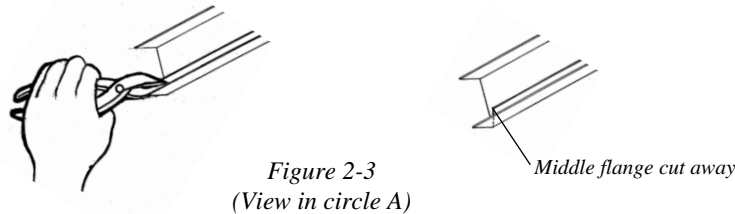

The wall trim used along the gutter edge should be flipped down and installed between the Panel and Main Rail (see figure 2-4). Allow for the Main Rail to extend beyond the Panel at least 1/2 inch when installing to allow for attachment screws to secure the Wall Trim.

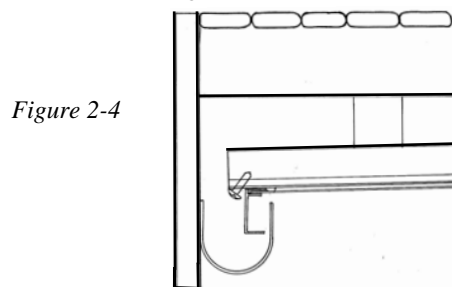

## Installing The First Panel and Main Rail

After you have installed the Wall Trim, and have put careful consideration into your layout, you are ready to install the Panels and Main Rails. The first Main Rail installation is VERY IMPORTANT to ensure the overall quality of your Zip-UP UnderDeck™ System. It is this Main Rail that will be the keystone from which the rest of the Main Rails will be based. There are two methods to put up your Main Rails. Refer to the “Plan your ceiling” paragraph from the first page. The measurement exercise you went through in the “Plan your ceiling” paragraph should have told you where your center Panel will be and how wide the cut Panels will be along the sides of the deck. You can start with the Main Rail in the center of the deck if you wish, but we recommend starting with a cut Panel at one side of the deck and install your ceiling as you progress across the deck. Cut the first Panel along its length that will be used on the first side of the deck and prep the Panel ends (see Prepping Your Panel). Fit the cut edge into the Wall Trim. Zip your first Main Rail into the Panel, making sure you insert the end of the Main Rail as far into the Wall Trim as possible (figure 2-5 and 2-7). The Wall Trim will assist in holding the rail and panel up as you make your attachments (figure 2-6). To attach the Main Rail to the furring strip hold the Main Rail up to the furring strip and using the vinyl siding hole punch, punch an elongated hole into the top of the Main Rail where the attachment is to be made. Rotate the Main Rail up making sure that the Main Rail rests flat against and is perpendicular to the furring strips. Attach with screws (figure 2-6). Because the Main Rails are ridged, you only need to fasten the Main Rail to the furring strips at about every 4 feet. By using the first Panel as a guide for the first Main Rail, you can assure the first Main Rail will be straight and parallel to the side of the deck.

**IMPORTANT:** When attaching the Main Rails to the furring strips, **DO NOT OVER TORQUE THE SCREWS** (see Figure 3-2). By leaving a small amount of play between the screw head and the Main Rail, the Main Rail will be free to expand and contract with the change in weather. Make sure the screws are installed in the elongated hole such that they will not conflict with each other.

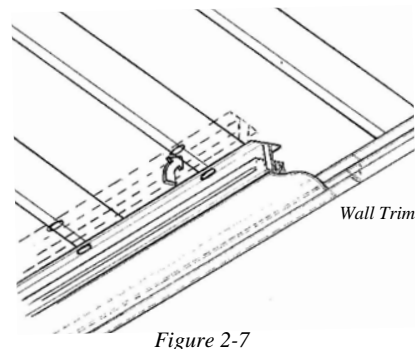
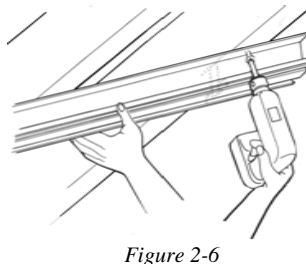
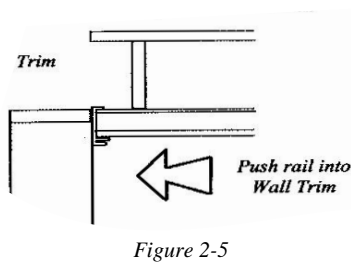

## Panel Preparation and Seam Trim

### The Zip-UP UnderDeck™ System Is Self Leveling

To let your Main Rails self level, do not screw the furring strips into every joist. Space your attaching points out to every second or even third joist, skipping those joists that are highest (figure 3-1). The furring strips are stiff enough for this.

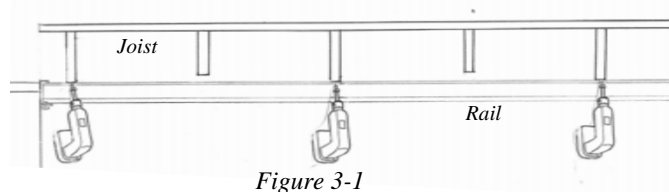

Figure 3-1

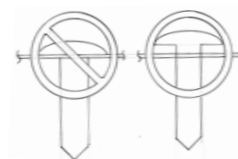

Figure 3-2

### Prepping Your Panel

There is some important prep work to be done to your Panels before installing them. First the Zip-UP feature must be trimmed approximately one inch from the ends (see figure 3-3). This material can be removed easily with a pair of tin snips or pliers. Carefully cut the area of the feature away to ensure proper fit to the Wall Trim. After the Panel is prepped, start at the wall, tucking the end of the Panel into the Wall trim's lower channel. Zip your panel into the Main Rail as in figure 3-4.

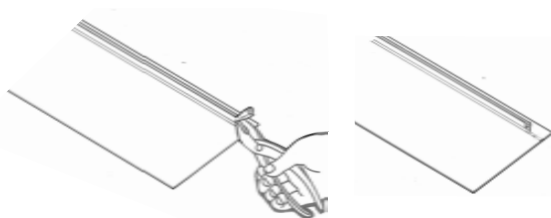

Figure 3-3

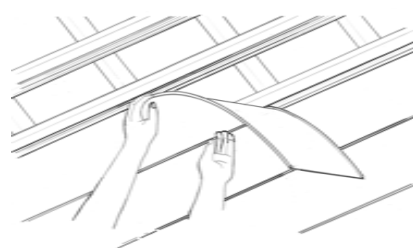

Figure 3-4

### Installing The Second Panel and Main Rail

To install the second Panel and Main Rail, zip-up the next Panel into the first Main Rail, making sure the end of the Panel is tucked into the Wall Trim. Next, zip the second Main Rail into the Panel, again making sure the ends of the Main Rail are captured firmly by the Wall Trim (Note that the first Main Rail will hold the assembly up). Rotate the Main Rail and Panel up to the furring strips and make your attachments as established above.

### Remaining Rails and Panels

Proceed across your deck, installing Panels and Main Rails in the same way.

### Install Seam Rail

Some installations may require the use of a seam. A seam is necessary when the length of the deck is greater than the length of your panel. In this case the Seam Trim will be installed in the center of the deck with the gradient sloping away from the seam on either side ending at the gutter system. The Seam Trim is designed to cap the end of the Main Rails. Before installing the Seam Trim, the ends of the Main Rails must be trimmed even. This is to make sure your Seam Trim is straight and centered. To even out the Main Rail ends, peel back the Panels as shown in figure 3-5, then use a chalk line (or any device that you may have for marking a straight line) to mark the ends of the Main Rails and cut them. Install the Seam Trim and secure it to the Main Rails by screwing it to the end of the Main Rails. Trim the Panels so that they are even with the Main Rails. Prep the Panel "Zip" feature as done in the previous step (Figure 3-3). Cap the ends of the Main Rails with the Seam Trim (figure 3-6). Install the first Main Rail of the next section repeating the steps taken on the previous page in "Installing the First Panel and Main Rail". Make sure the Panel edges align between the two sections. The Seam Trim holds the end of the new Main Rails the same way your Wall Trim did in the first section.

**NOTE:** The Seam Trim MUST be installed after the first section is completed and before the next section is started. This is because the Seam Trim fits between the Main Rail ends of the two sections.

**WARNING:** If a seam is needed, pitch the sections on either side of the seam away from the seam making the seam the highest point of the ceiling. The seam is not sealed and placement of the seam in the middle of a pitched ceiling will not allow water to flow.

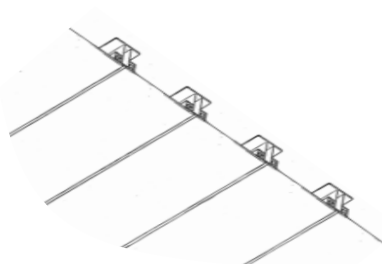

Figure 3-5  
Cut ends to a straight line

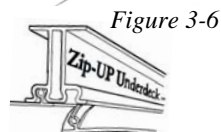
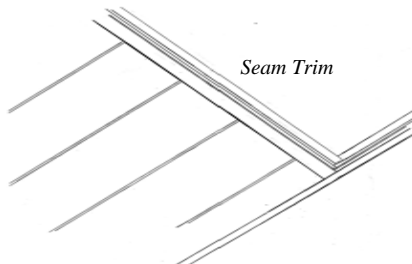
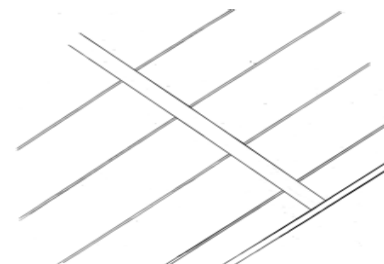

Figure 3-6



Installed Seam Trim

### **Installing a Gutter System**

Once the Zip-UP UnderDeck™ System is in place, a gutter system can be installed. It is recommended to purchase the type of gutter with the strap that attaches underneath the gutter so that the gap between the gutter and Zip-UP UnderDeck™ System is minimized for appearance.

### **Trimming out the Deck**

Once the Zip-UP UnderDeck™ System and your gutter system is in place. It is recommended to trim out areas where a gap exist that might allow small animals (such as birds) to enter between the Deck and Zip-UP UnderDeck™ System.

### **Thermal Expansion**

The Zip-UP UnderDeck™ System is made of high quality PVC material. PVC will shrink and expand with severe temperature changes. It is recommend to allow for the expansion of the Zip-UP UnderDeck™ System by punching elongated holes in the Main Rails just before making the attachment. Use screws with washers and only use enough torque to secure the Main Rails to the joist yet allowing for movement of the Main Rails for thermal expansion.

### **Painting**

#### *Requirements*

Your Zip-UP UnderDeck™ System may be painted only with latex paint. Always prime before painting for best results.

#### *Panel removal*

Painting over panel joint lines may cause difficulty for Panel removal. Removal of a Panel that has been painted over may cause the paint to chip or flake requiring touch up.

### **Panel Removal**

Once the Zip-UP UnderDeck™ System is in place, it may be necessary to remove a Panel to access plumbing or wiring. To remove a Panel, simply push up in the center of the Panel to be removed and using a pry bar or the claw part of your hammer pry the exposed Panel edge down one side at a time. Once the seal of the Panel is broken, the Panel will unzip.

### **Storage**

To Store your Zip-UP UnderDeck™ System, while you wait for installation, it is important to lay the components on a flat surface. If the Zip-UP UnderDeck™ System has been stored in severe cold temperatures, it will be necessary for the components to warm to room temperature before you will be able to install.

## **Limited Warranty**

### **Our Warranty**

This warranty is our pledge that all Zip-UP UnderDeck™ System materials purchased will be free from manufacturing defects from the date of purchase for 5 years in your home in which these products were installed. This warranty applies to material purchased by you only for use in your own residence and not for resale.

