

DESIGN

PURCHASE

CONSTRUCT

ENJOY

Project 110 Estate Wooden Mailbox Post Assembly

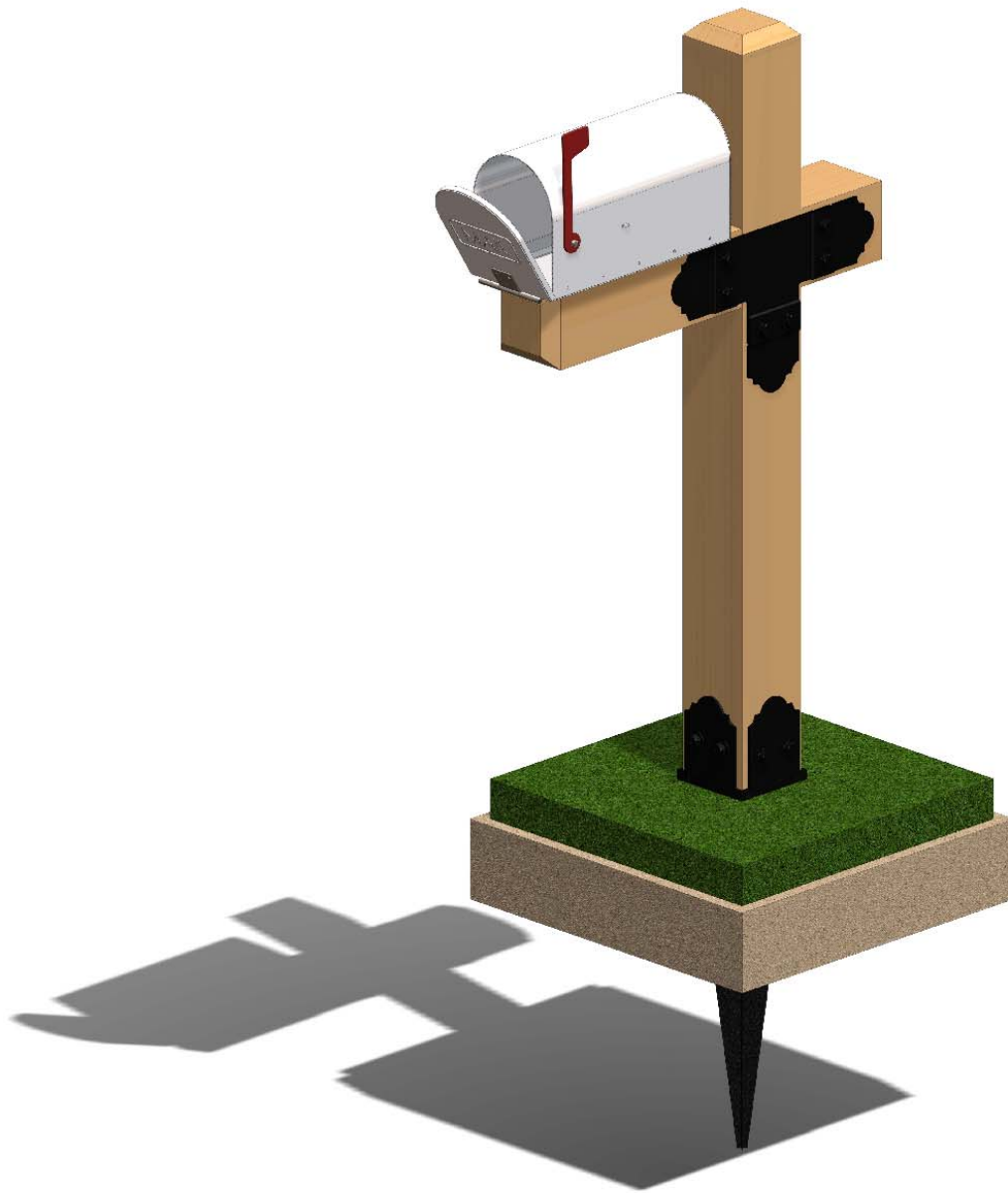

for Post Anchor,
see Installation
Instructions,
56632-34



OZCO BUILDING PRODUCTS ■ ■ ■

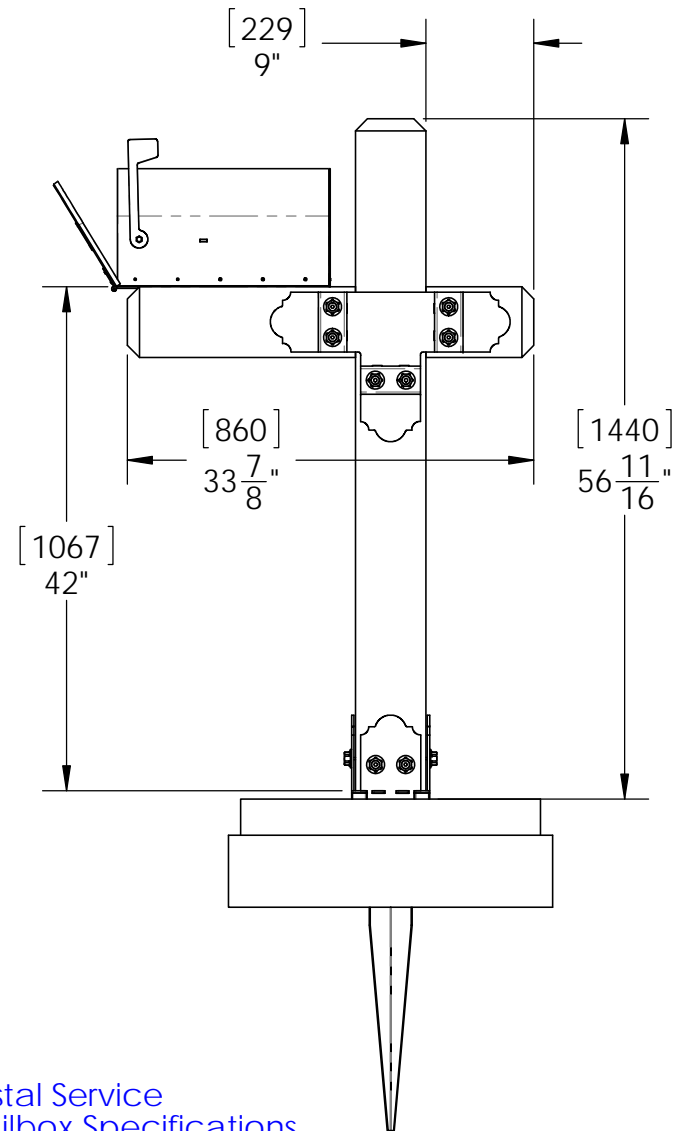
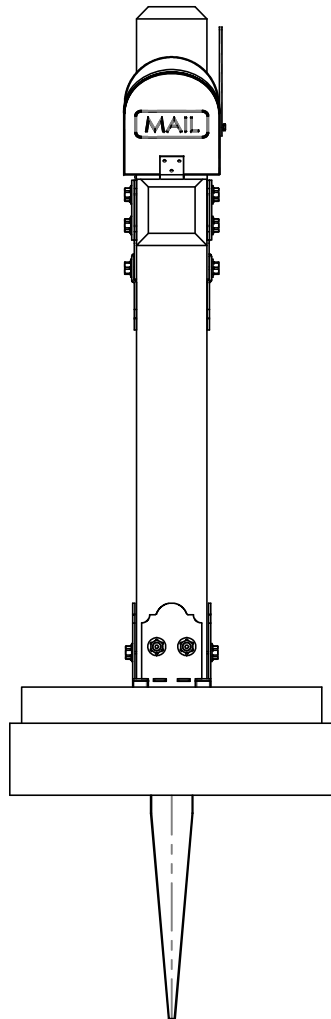

Postal Service
Mailbox Specifications

Overview

Project 110 Estate Wooden Mailbox Post Assembly

V1.00 - Installation Instructions effective May 1, 2015 and reflects information that available as of April 10, 2014. This information is updated periodically and should not be relied upon after May 1, 2015. Please visit www.OZCOBP.com to get current information

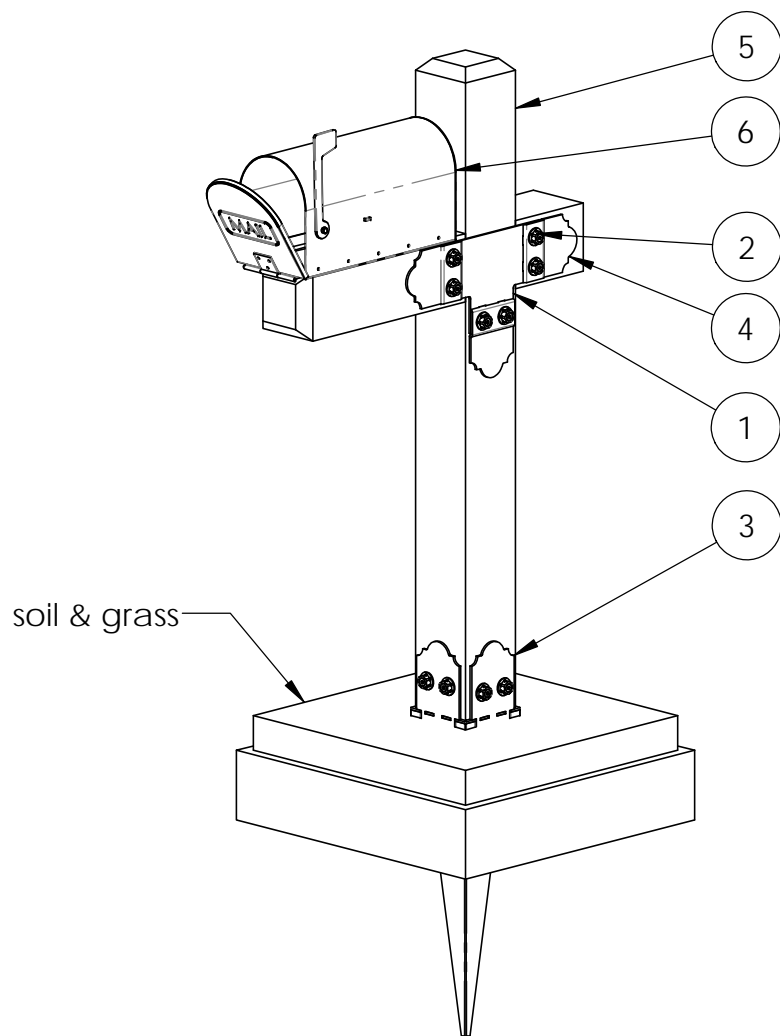

ITEM NO.	QTY.	PART NUMBER	DESCRIPTION
1	1	56612	T Tie Plate
2	1	56626	OWT Timber Screw 2-3/4"
3	1	56633	Assembly, 6x6 Post Anchor
4	3	56611	Truss Accent
5	1	6x6x8	6x6 Cedar Post
6	1	mailbox	

Bill of Materials

Project 110 Estate Wooden Mailbox Post Assembly

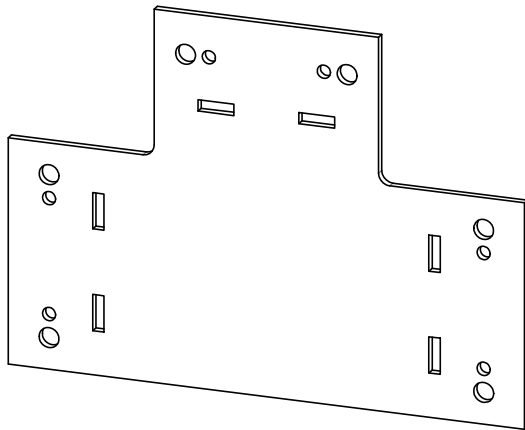

56612

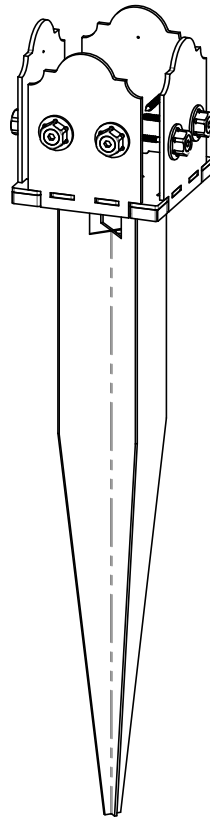

56633

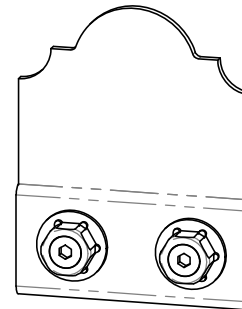

56611

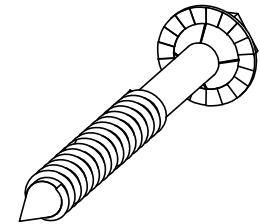

56626



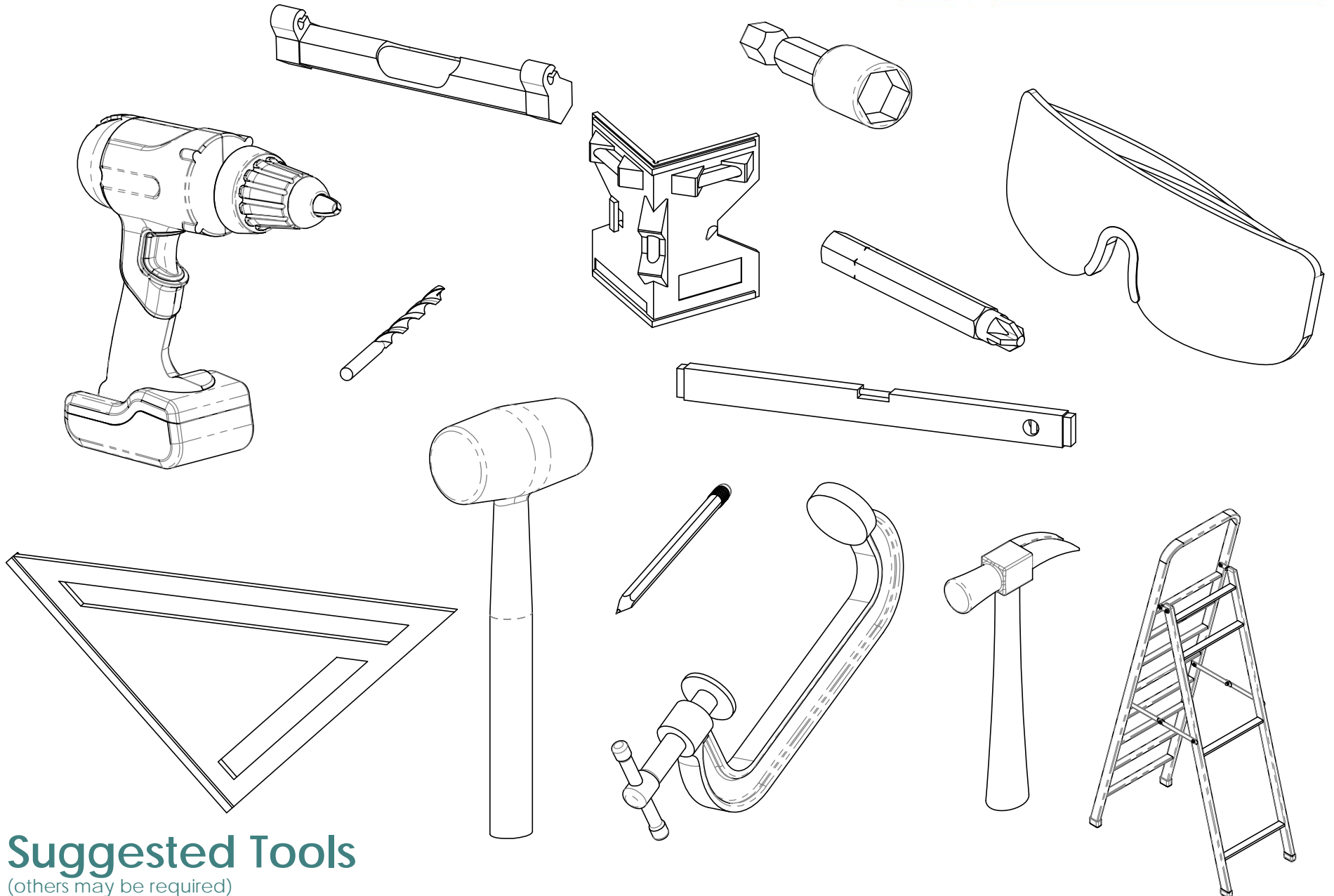

Suggested Tools

(others may be required)

Project 110 Estate Wooden Mailbox Post Assembly

V1.00 - Installation Instructions effective May 1, 2015 and reflects information that available as of April 10, 2014. This information is updated periodically and should not be relied upon after May 1, 2015. Please visit www.OZCOBP.com to get current information

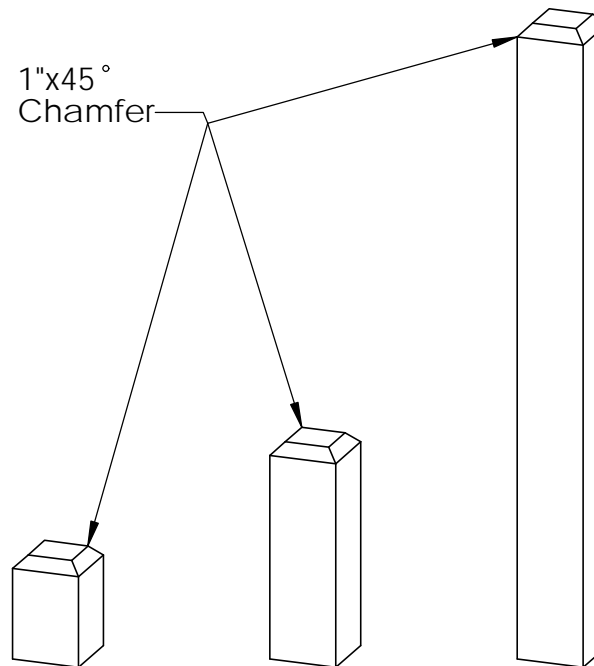
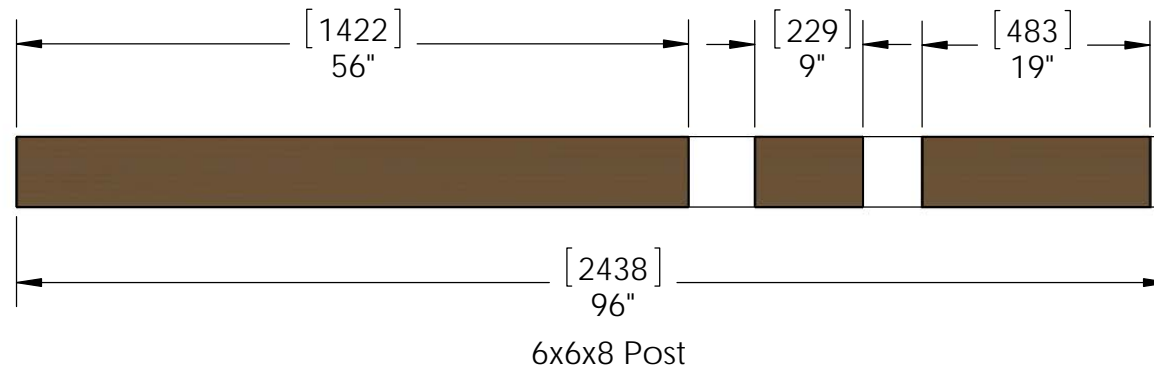

Cutlist

Project 110 Estate Wooden Mailbox Post Assembly

V1.00 - Installation Instructions effective May 1, 2015 and reflects information that available as of April 10, 2014. This information is updated periodically and should not be relied upon after May 1, 2015. Please visit www.OZCOBP.com to get current information

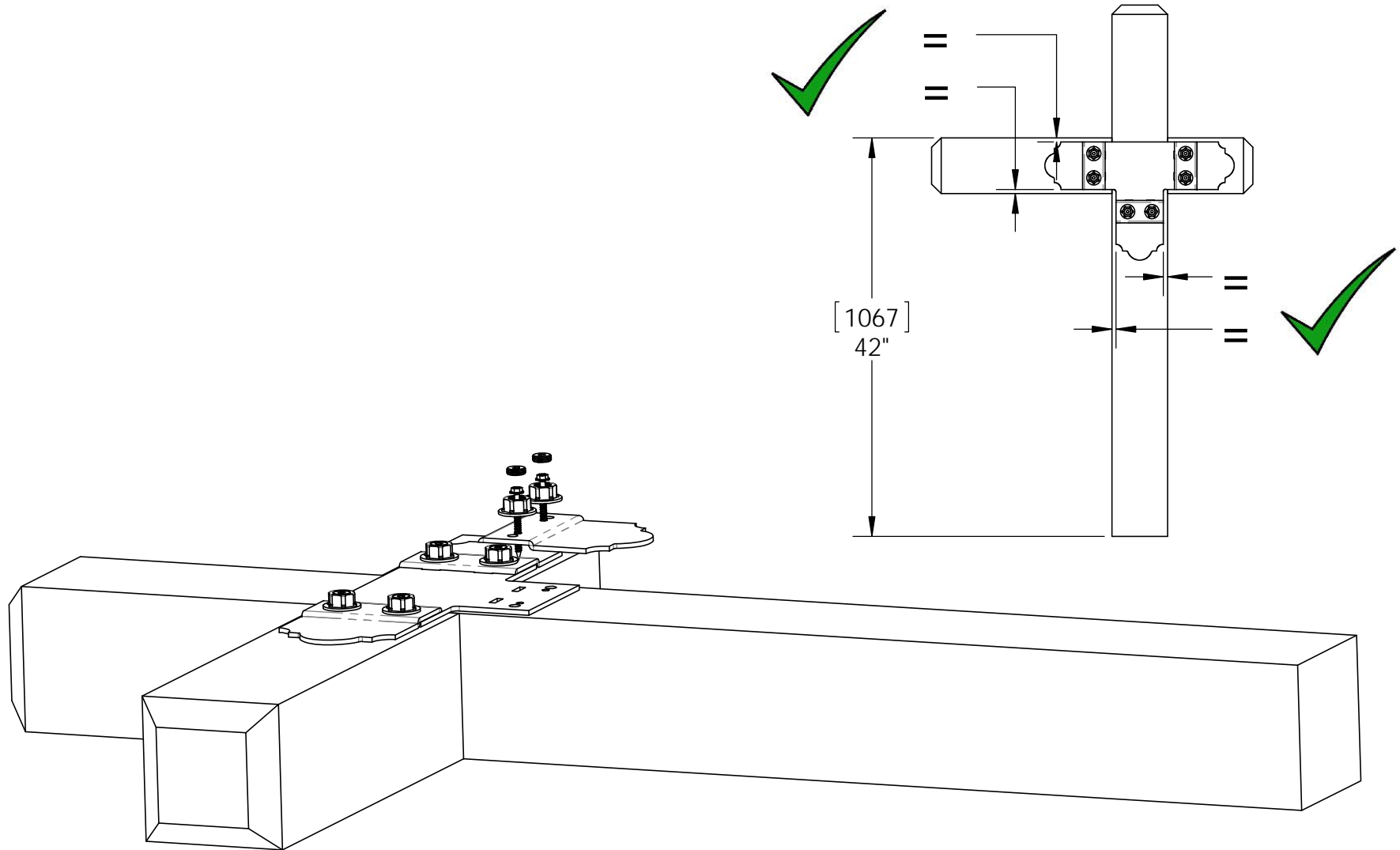

assemble on flat non-marring surface

step 1

Project 110 Estate Wooden Mailbox Post Assembly

V1.00 - Installation Instructions effective May 1, 2015 and reflects information that available as of April 10, 2014. This information is updated periodically and should not be relied upon after May 1, 2015. Please visit www.OZCOBP.com to get current information

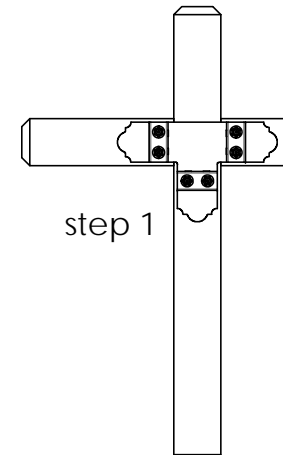
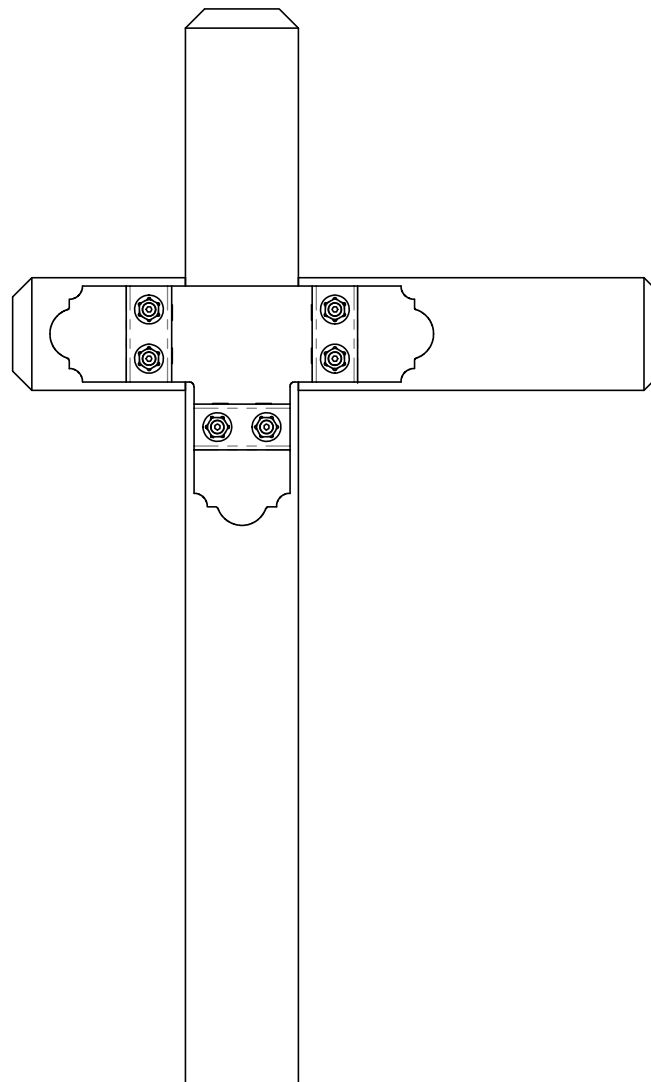

step 2
repeat step 1 on opposite side

Project 110 Estate Wooden Mailbox Post Assembly

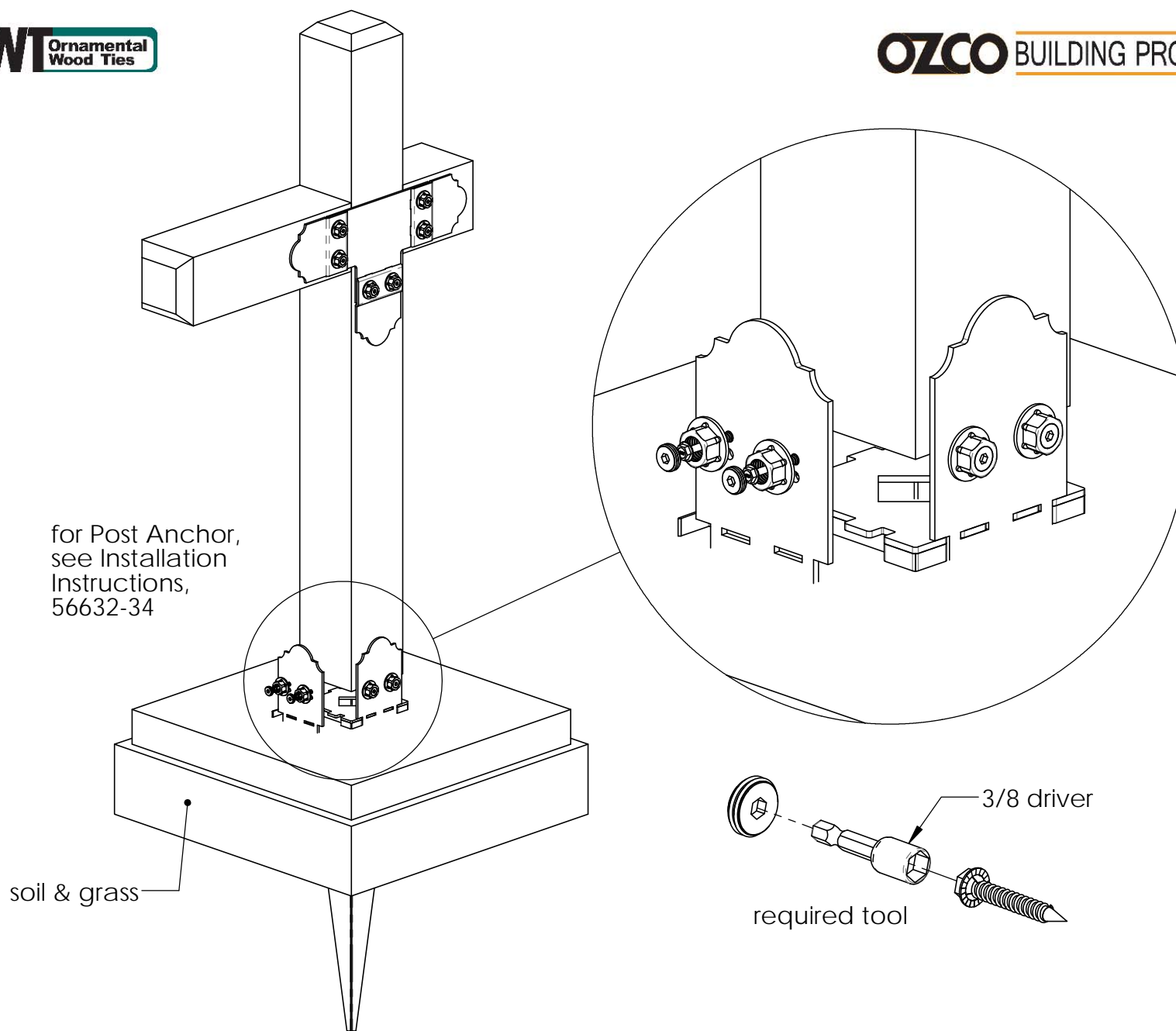

step 3

Project 110 Estate Wooden Mailbox Post Assembly

install mailbox per
manufacturers instructions

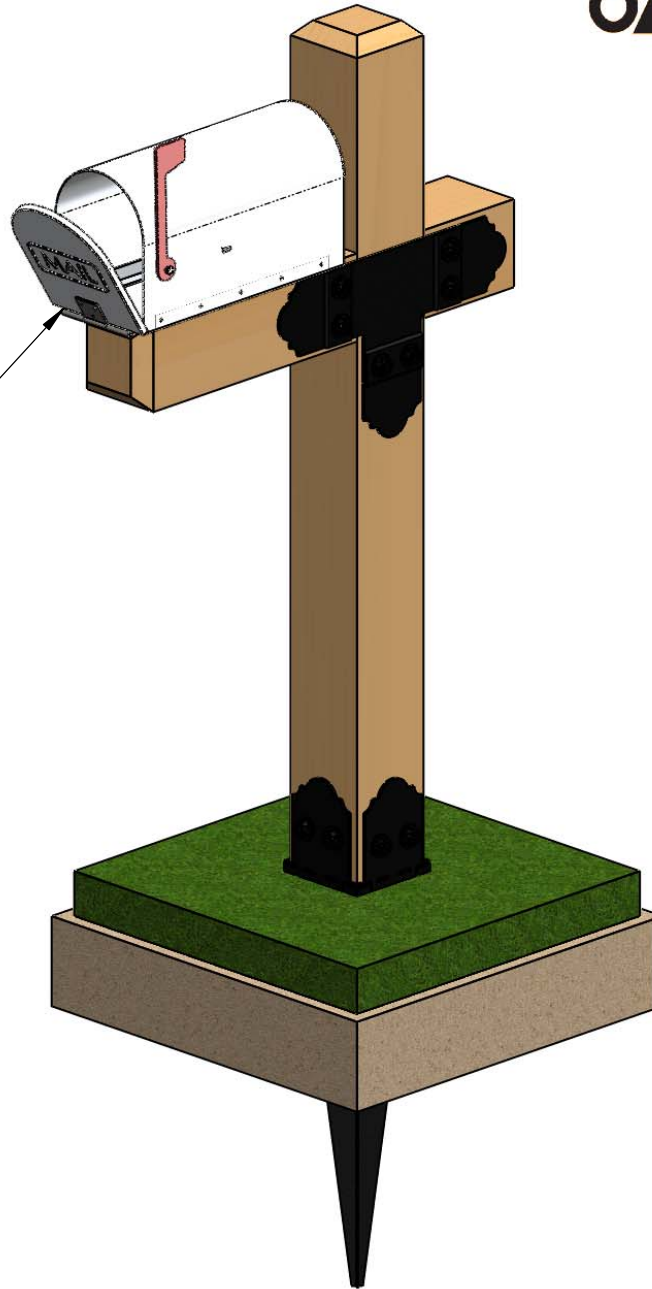

step 4

Project 110 Estate Wooden Mailbox Post Assembly

V1.00 - Installation Instructions effective May 1, 2015 and reflects information that available as of April 10, 2014. This information is updated periodically and should not be relied upon after May 1, 2015. Please visit www.OZCOBP.com to get current information