

**DESIGN**

**PURCHASE**

**CONSTRUCT**

**ENJOY**

## Project 111 Wooden Mailbox Post Assembly



Project 111 Wooden Mailbox Post Assembly



V1.00 - Installation Instructions effective May 1, 2015 and reflects information that available as of April 10, 2014. This information is updated periodically and should not be relied upon after May 1, 2015. Please visit [www.OZCOBP.com](http://www.OZCOBP.com) to get current information

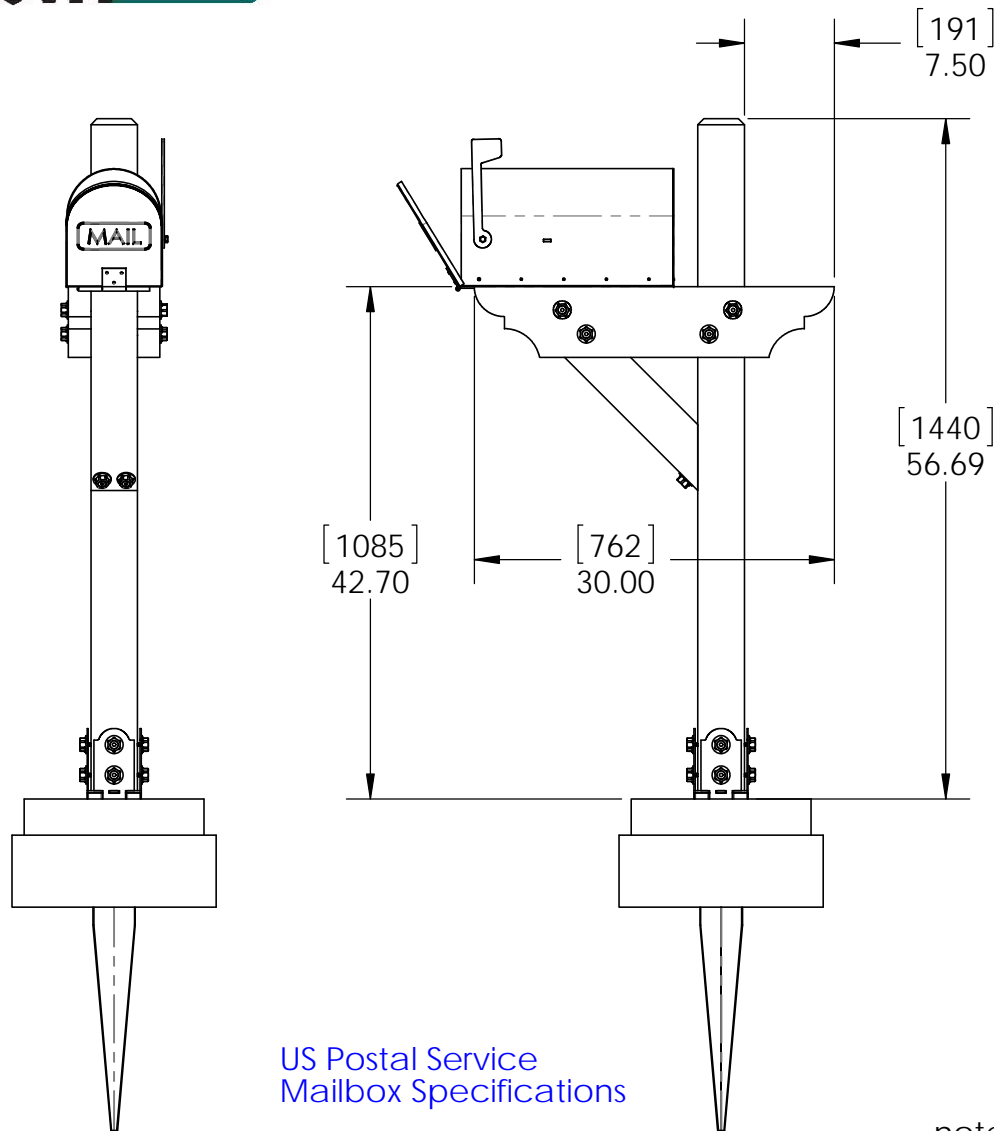

US Postal Service  
Mailbox Specifications

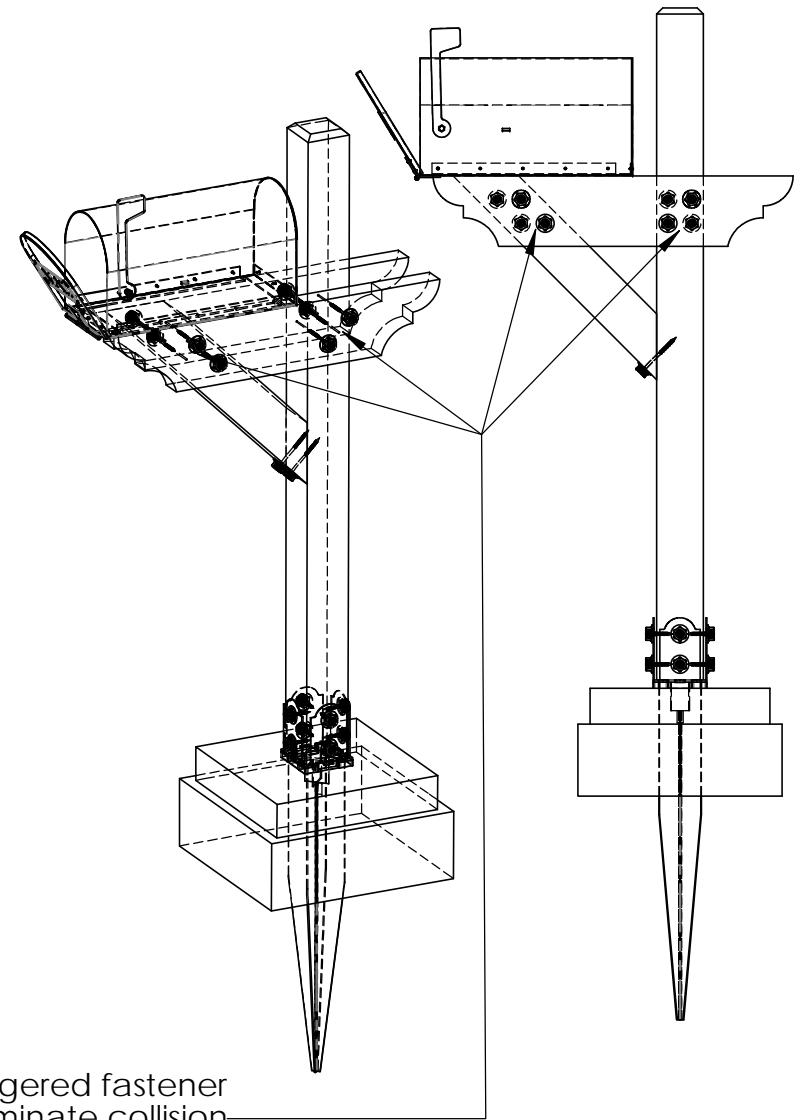

## Overview

### Project 111 Wooden Mailbox Post Assembly

V1.00 - Installation Instructions effective May 1, 2015 and reflects information that available as of April 10, 2014. This information is updated periodically and should not be relied upon after May 1, 2015. Please visit [www.OZCOBP.com](http://www.OZCOBP.com) to get current information

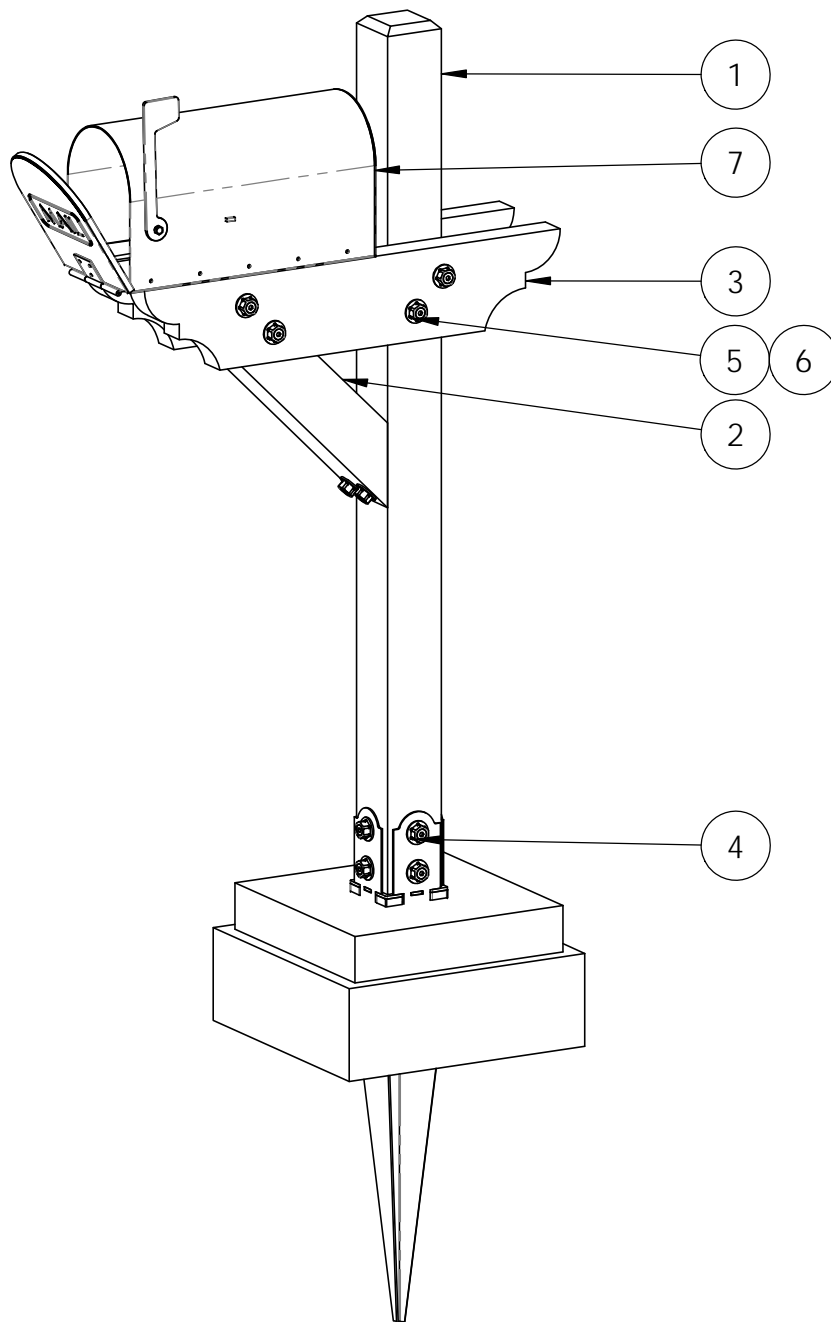

ITEM NO.	QTY.	PART NUMBER	DESCRIPTION
1	1	4x4 Cedar Post	56" with chamfered end
2	1	4x4 Cedar Post	2 with corner support cut
3	2	2x6 Cedar Board	30" with cuts
4	1	56632	4x4 Post Anchor
5	1	56627	OWT Timber Screw 3-3/4"
6	1	56621	1 1/2" Hex Cap Nut
7	1	mailbox	

## Bill of Material

### Project 111 Wooden Mailbox Post Assembly

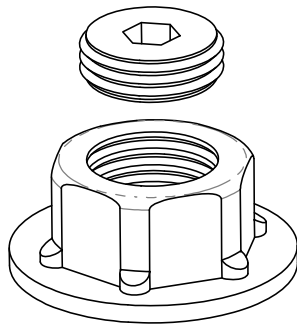

56621

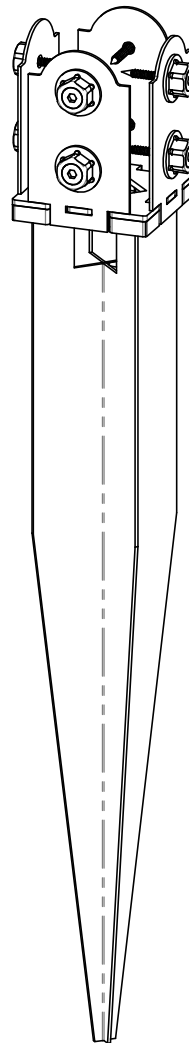

56632

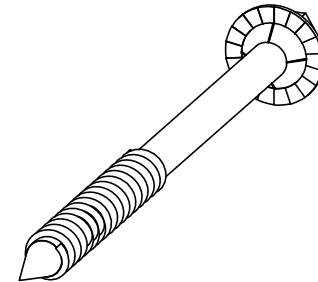

56627





V1.00 - Installation Instructions effective May 1, 2015 and reflects information that available as of April 10, 2014. This information is updated periodically and should not be relied upon after May 1, 2015. Please visit [www.OZCOBP.com](http://www.OZCOBP.com) to get current information

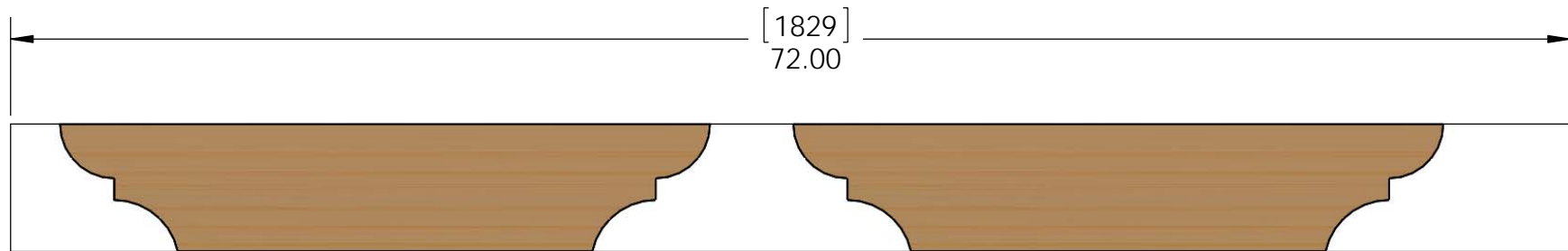

Note: both pieces can be cut from 1 board  
2x6x72 board

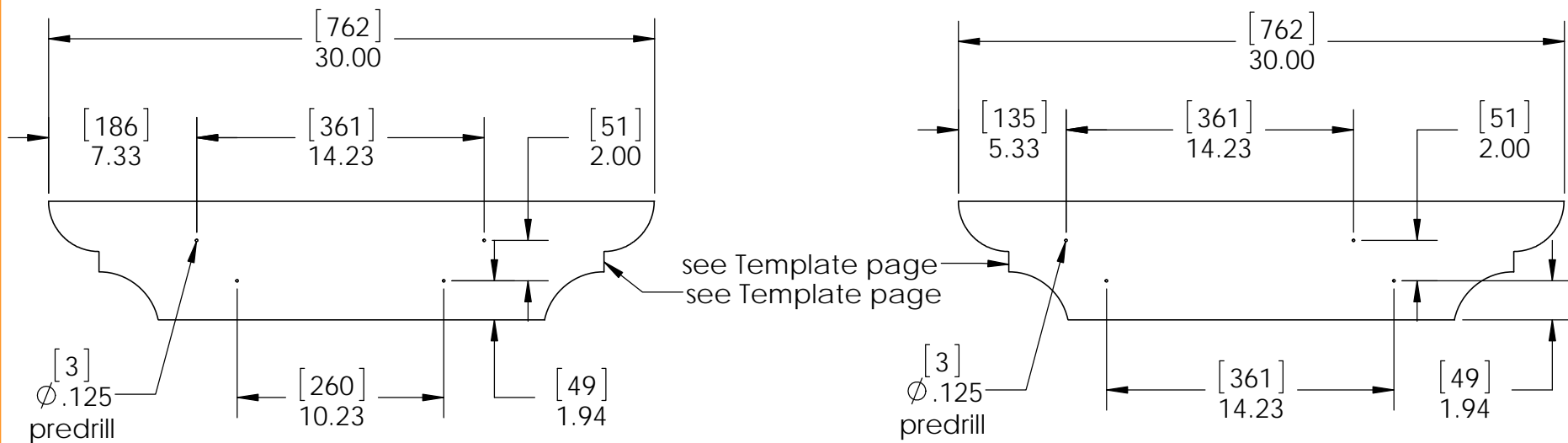

## Cutlist

Project 111 Wooden Mailbox Post Assembly

V1.00 - Installation Instructions effective May 1, 2015 and reflects information that available as of April 10, 2014. This information is updated periodically and should not be relied upon after May 1, 2015. Please visit [www.OZCOBP.com](http://www.OZCOBP.com) to get current information

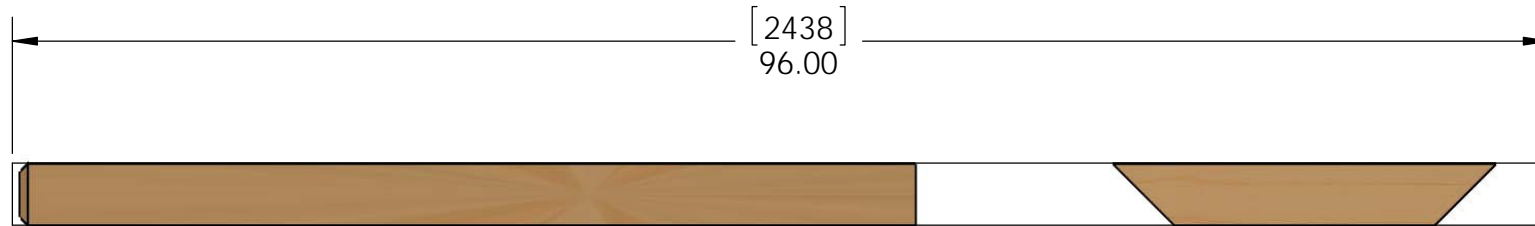

Note: both pieces can be cut from 1 post  
4x4x96 post

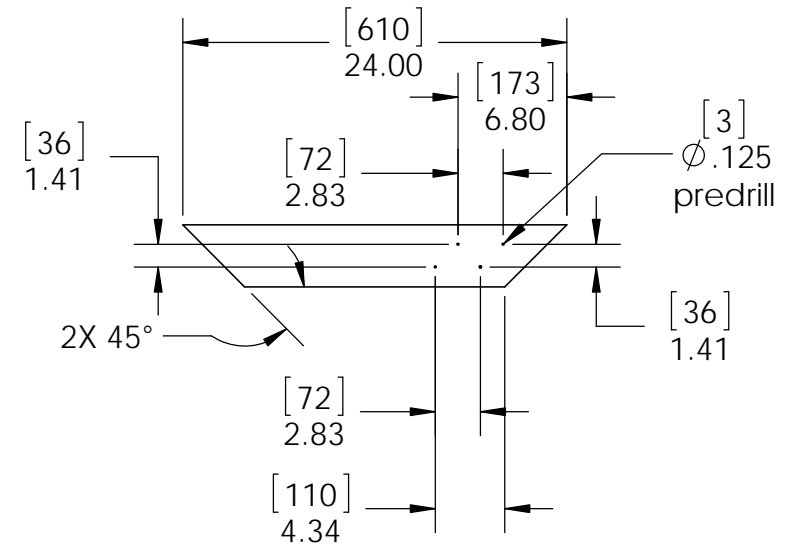
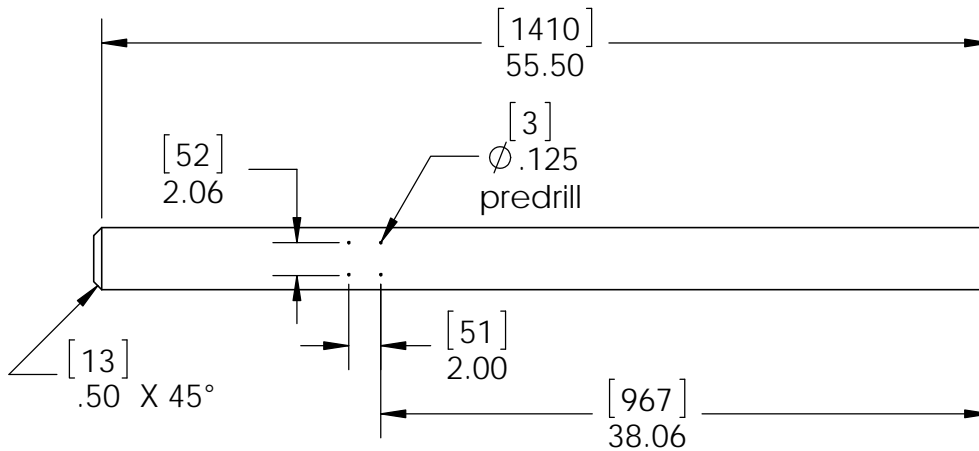

## Cutlist

### Project 111 Wooden Mailbox Post Assembly

V1.00 - Installation Instructions effective May 1, 2015 and reflects information that available as of April 10, 2014. This information is updated periodically and should not be relied upon after May 1, 2015. Please visit [www.OZCOBP.com](http://www.OZCOBP.com) to get current information

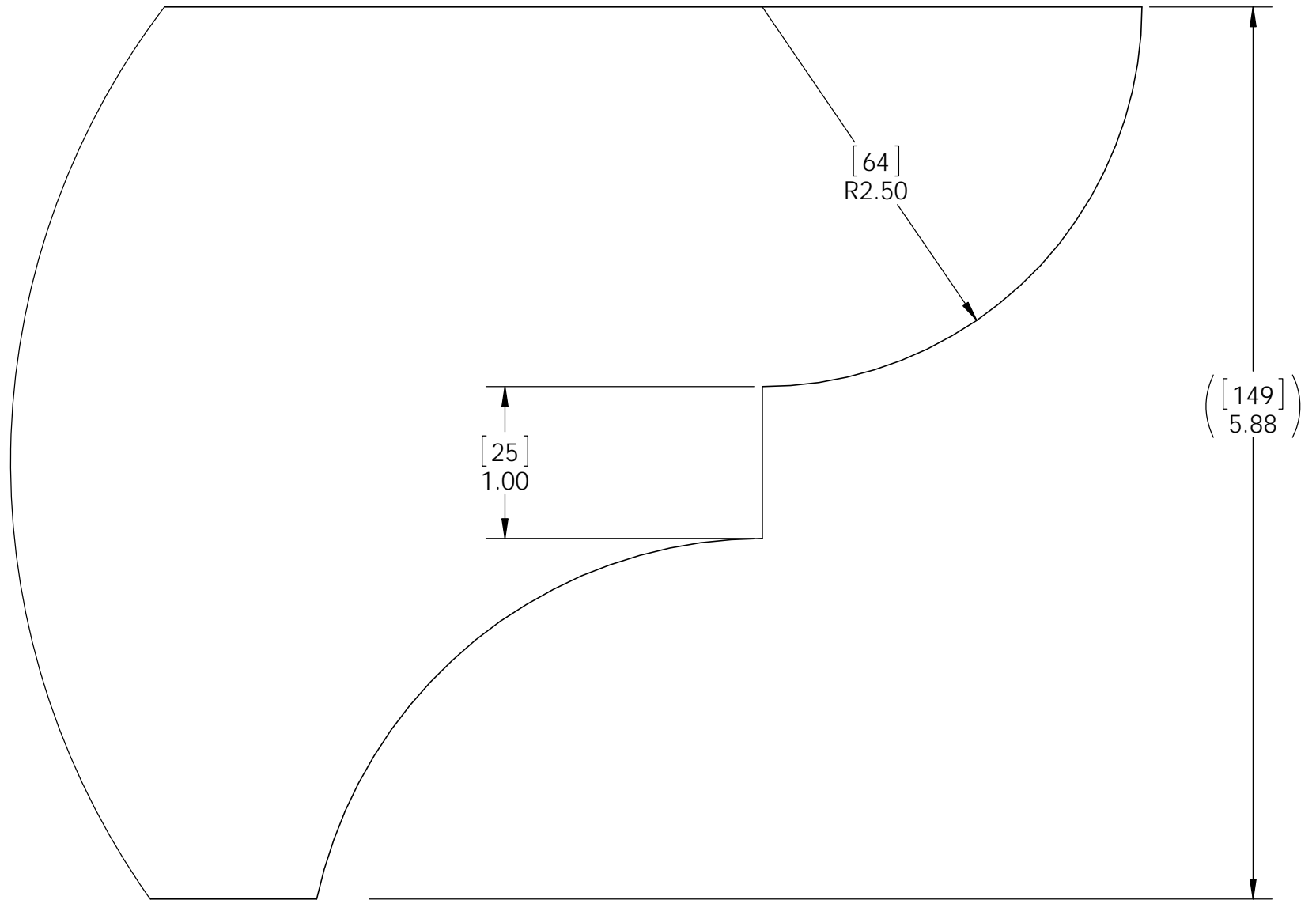

## Template (scale 1:1)

Project 111 Wooden Mailbox Post Assembly



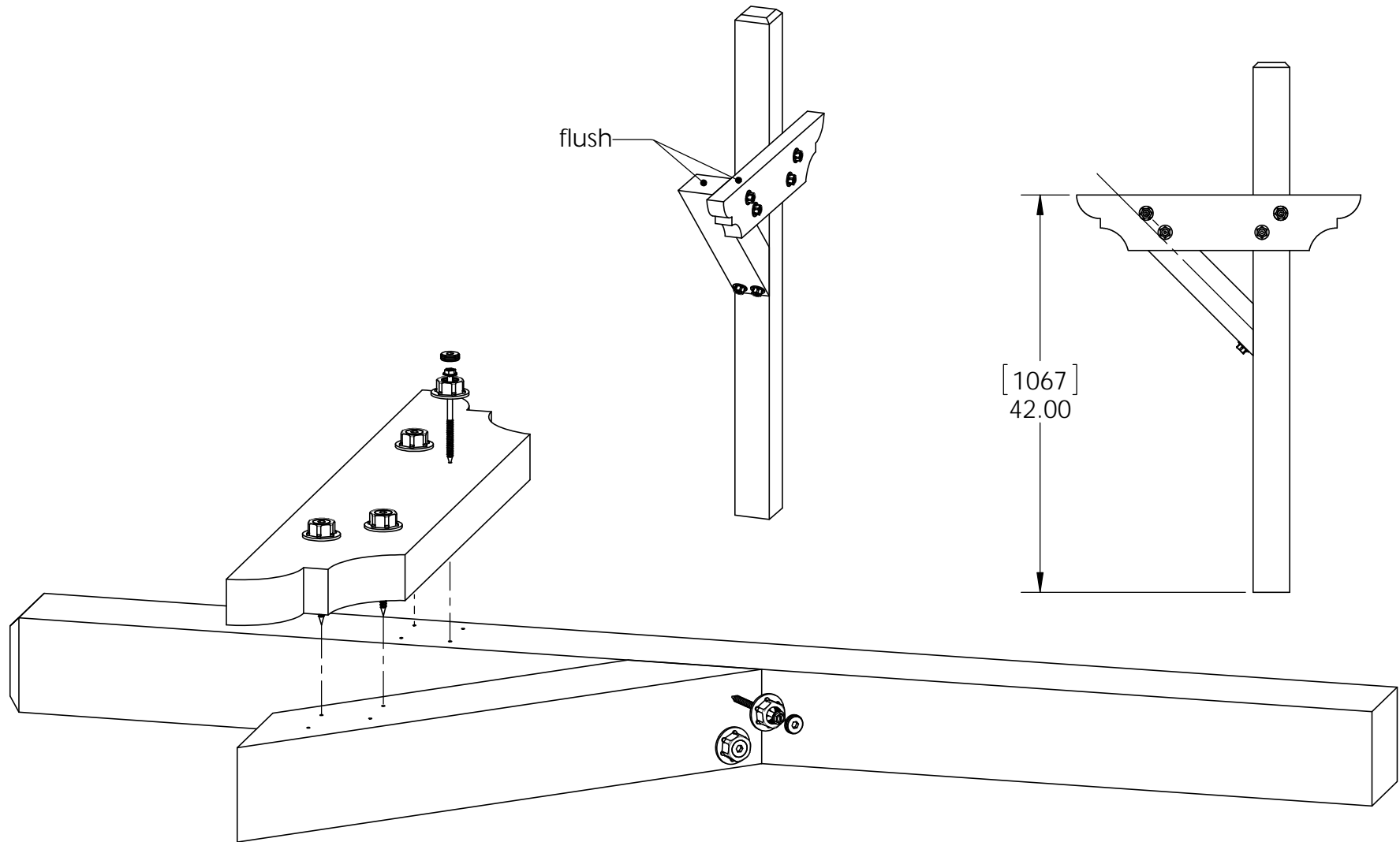

assemble on flat non-marring surface

## step 1

Project 111 Wooden Mailbox Post Assembly

V1.00 - Installation Instructions effective May 1, 2015 and reflects information that available as of April 10, 2014. This information is updated periodically and should not be relied upon after May 1, 2015. Please visit [www.OZCOBP.com](http://www.OZCOBP.com) to get current information

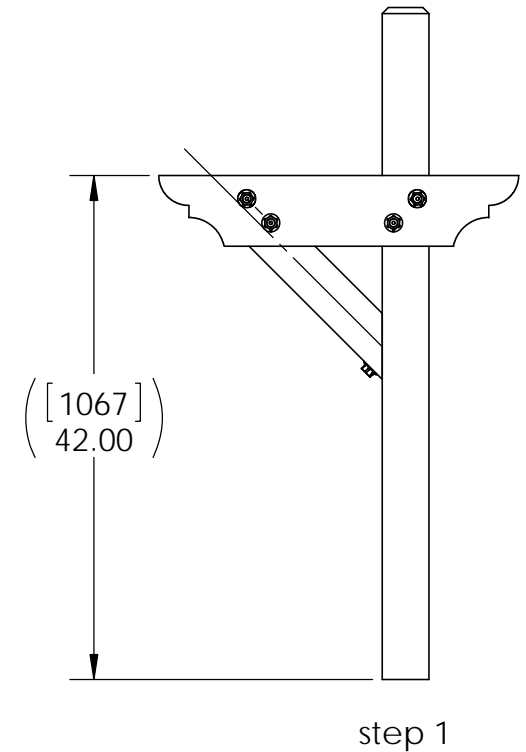
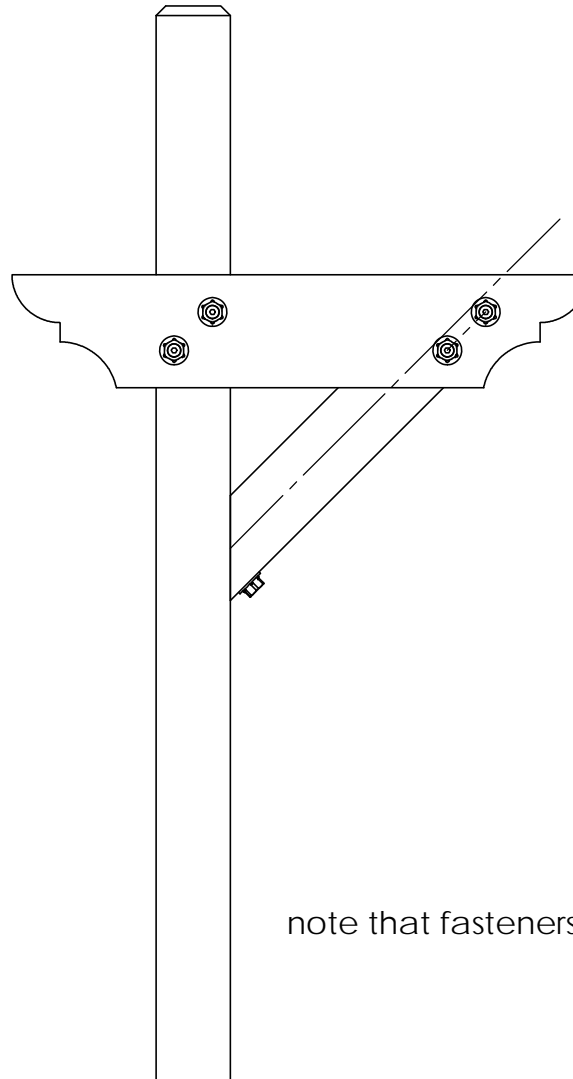
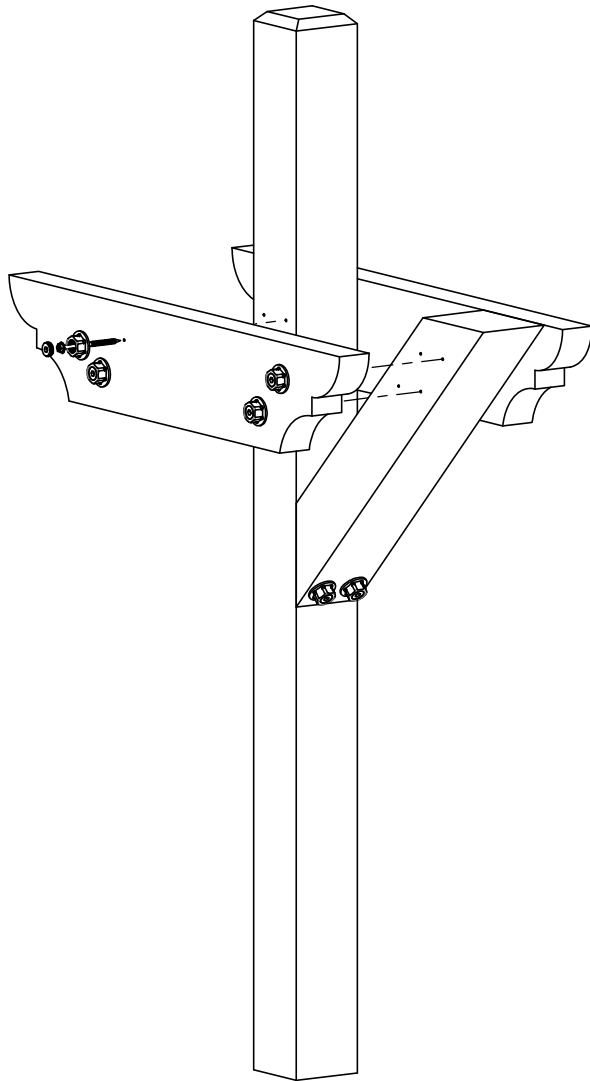

note that fasteners do not collide from opposite side

**step 2**  
repeat step 1 on opposite side

**Project 111 Wooden Mailbox Post Assembly**

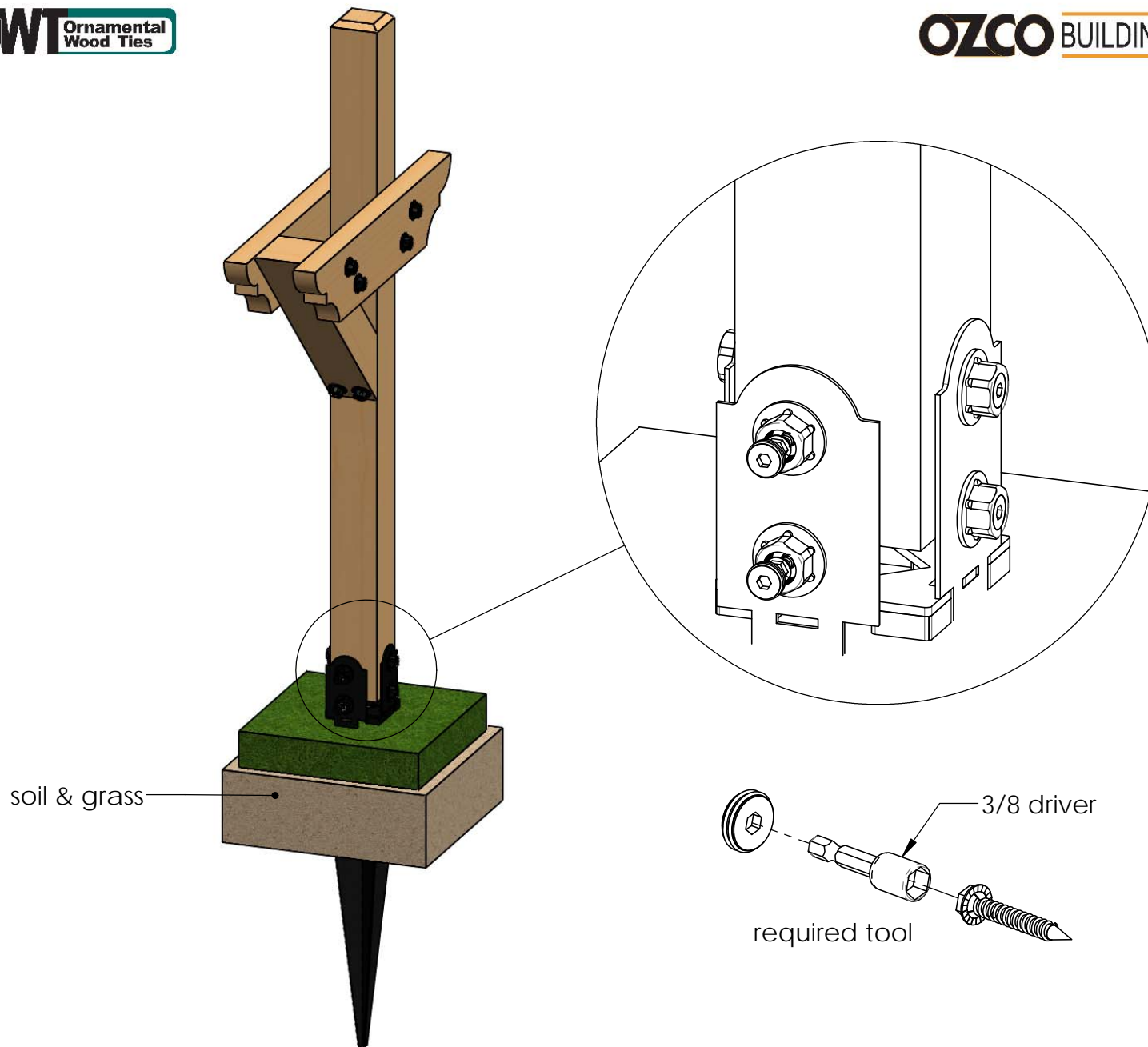

### step 3

#### Project 111 Wooden Mailbox Post Assembly

install mailbox per  
manufacturers instructions

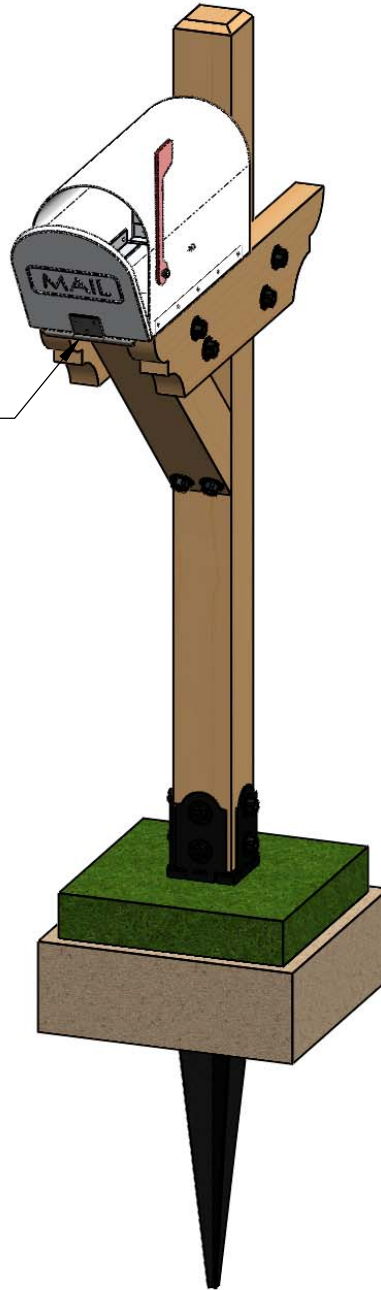

## step 4

### Project 111 Wooden Mailbox Post Assembly

V1.00 - Installation Instructions effective May 1, 2015 and reflects information that available as of April 10, 2014. This information is updated periodically and should not be relied upon after May 1, 2015. Please visit [www.OZCOBP.com](http://www.OZCOBP.com) to get current information