

KIT CONTAINS:

1. **MISCELLANEOUS PACK:**

- (1) LATCH ASSEMBLY
- (1) KEEPER ASSEMBLY
- (1) OFFSET KEEPER BACKPLATE
- (2) HANDLES WITH SET SCREWS
- (1) SQUARE SPINDLE,
- (1) SET SCREW WRENCH

2. **A SET OF MOUNTING HARDWARE:**

- (2) #8 x 2" LG. PH. FLAT HEAD SELF-DRILLING SCREWS.
- (7) #8 x 3/4" LG. PH. FLAT HEAD SELF-DRILLING SCREWS.
- (1) #6-32 KEEPER ADJUSTMENT LOCK
- (2) KEYS (Locking Version Only).

IMPORTANT NOTE:

MAKE SURE THE POSTS USED FOR THIS APPLICATION ARE SECURELY ANCHORED AND VERTICAL (USE A LEVEL). THIS LATCH FITS 1" TO 2" GATE FRAMES AND ANY POST SIZE.

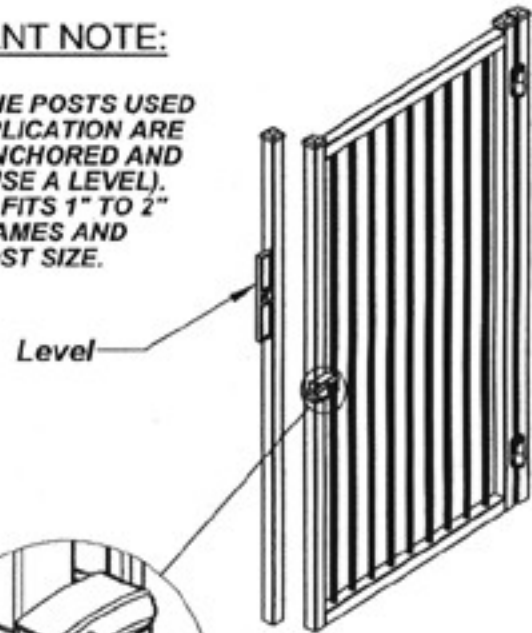

REVERSED

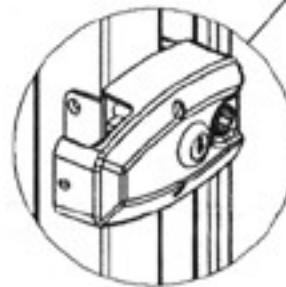

DETAIL "A"

STEP-1

Position **Latch Assembly**, at desired height as shown on Detail "A". Fasten to the gate with the supplied screws; #8 x 2" are used for the **Front of The Housing**, #8 x 3/4" are used for the **Return Tab**. The Latch is not handed and can be mounted as shown or reversed.

STEP-2

With the **Latch Assembly** fastened in place, attach the **Square Spindle** into one of the **Handles** tightening the set screw with the **Wrench** provided. Insert **Square Spindle** into the Spindle hole on the front housing. Attach **Spindle Bushing** into the Spindle hole on the back housing. Finally, attach the other **Handle** at opposite end of **Square Spindle** with provided **Set Screw**.

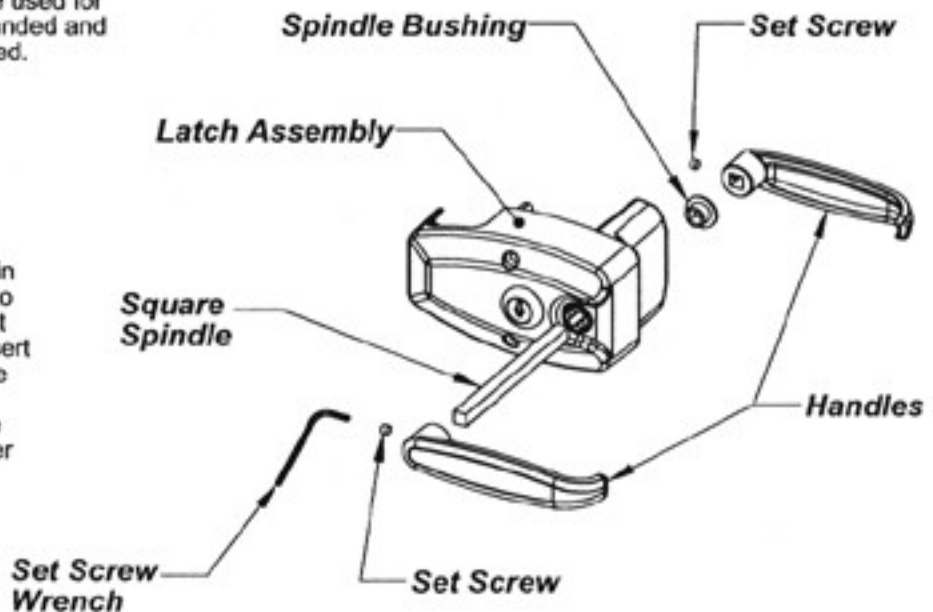

IMPORTANT NOTE:

To allow for a wide range of gaps, an optional Offset Keeper Back Plate is included. A table with Gap Range has been provided below. Make sure to have the correct Back Plate assembled with Keeper before proceeding with Step 3 of the installation. Keeper can be mounted as shown or reversed for an opposite handed gate.

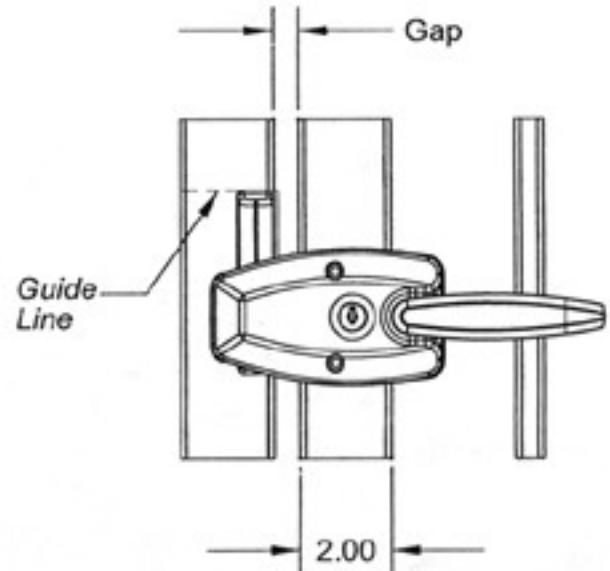
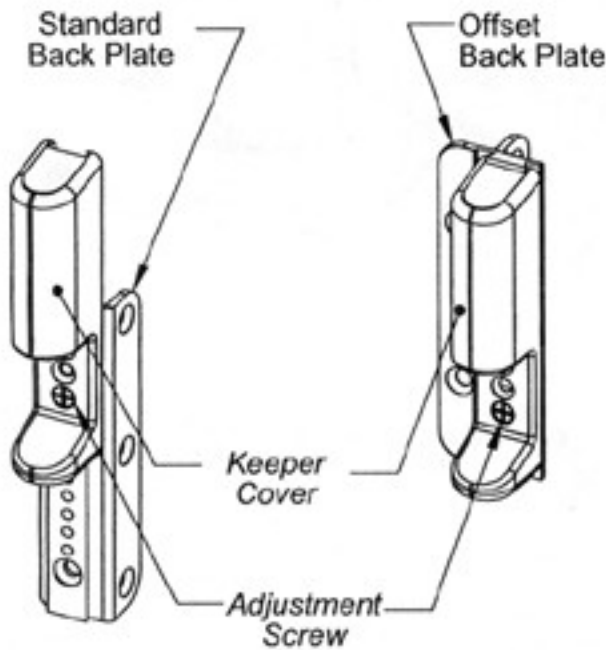

Back Plate	Gap Range
Standard Back Plate	5/16 To 13/16
Offset Back Plate	13/16 To 1-7/16

STEP-3

Once the Keeper is assembled with the proper Back Plate and in the proper direction for the gate handing, allow the Keeper to engage the latch. Close the gate and mark a Guide Line at the top of the Keeper on the fence post as shown above. Disengage the Keeper from the latch and mount the Keeper to the post with the supplied #8 x 3/4" screws. If using the Standard Back Plate, the Keeper will need to be disassembled to install all of the screws. Close the gate, allowing the latch to engage. Adjust Keeper as shown, open gate and install the Adjustment Screw.

