

# Hanover Trellis

## Assembly & Mounting Instructions

### General Information:

- Read instructions through carefully before beginning assembly.
- Identify each component from material list.
- When assembling components, place on a non-abrasive surface to avoid scratches.
- Do not use excessive force when assembling components.
- In the event of missing or defective parts, please call our customer service department at **1-800-282-9346 (ext.#20)**.



### Materials Included:

Part #	Description	Quantity
1	3 1/2" sq. x 58" Posts	2
2	1 3/4" sq. x 36 3/4" Top	1
3	1 3/4" sq. x 36 3/4" Middle rail	3
4	7/8" x 1 1/2" x 19 5/8" Spokes	2
5	7/8" x 1 1/2" x 15 5/8" Spokes	2
6	1 3/4" sq x 36 3/4" Bottom rail	1
7	Keystone	1
8	Arches	1
9	7/8" x 1 1/2" x 43 1/4" side spindle	5
10	Hardware kit (Includes): 3/4" Self-tapping stainless screws	8

### Materials (Optional):

- Pre-mix concrete (recommended for added stability).
- Pressure treated 2x4 or 4x4 2 ft long ripped to 3" wide

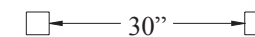

(Fig. 2)

Post layout for installation.

### Tools Required:

- Cordless drill with #2 Robertson bit
- Tape measure
- Level
- Shovel
- Pencil

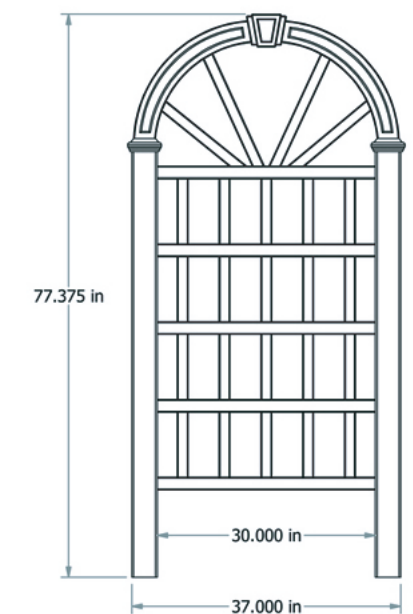

(Fig. 1)

Product dimensions & part identification.

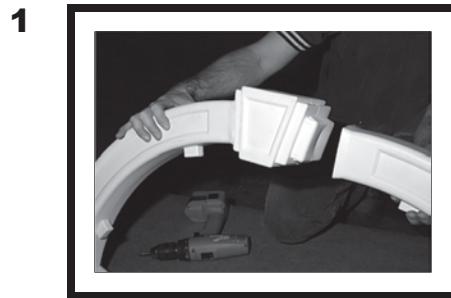

1 Take the arches (part 7) and snap them onto either side of the keystone (part 6).

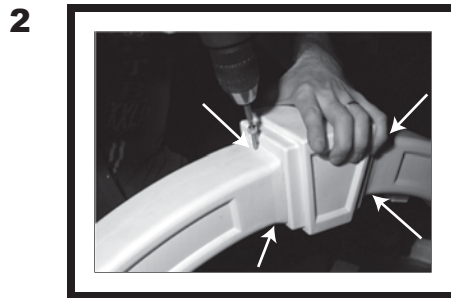

2 Using four screws, fasten the arches to the keystone on both sides as illustrated (arrows show each screw location). **Note:** all screws are self-tapping and require no pre-drilling. Set aside the assembled arch.



3 Lay out the bottom rail (part #6). Insert the side spindles (part #9) into the precut holes until they “bottom out”.

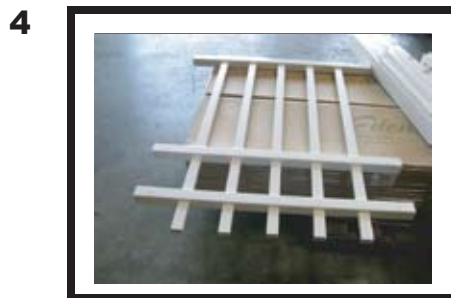

4 Slide the three middle rails (part #3) onto the side spindles. Space the rails approximately 9” apart.



5 Finish the “ladder” by placing the top rail (part #2) onto the side spindles. The top rail has holes on both sides, but the spindles will not all go through it.



6 Lay out one post (part #1). Align the rails with the pre-routed holes in the post and push in past the locking tabs. Flip over and do the same for the other post.  
**Note:** make sure the long end of each post is facing the same direction. The rails do not come out. The top rail faces the short end.



7 Stand the completed panel up and position the arch over the posts. Slip one of the short spokes (part 5) into the closest hole in the top rail as illustrated. Push the opposite end onto the nearest arch socket.



8 Slip one of the long spokes (part 4) into the next hole in the top rail as illustrated. Again, push the opposite end onto the next arch socket. Repeat steps 10 and 11 for the remaining spokes. **Note:** pay close attention to the angled ends of each spoke, to ensure a proper fit.



9 Hold one end of the arch down into the post and secure in place with two screws on two sides of the post. Position the screws directly under the arch cap to ensure proper attachment to the arch. Repeat this for the opposite side.



10 Dig two 12” deep holes in the desired location using the distance shown in (Fig. 2) on the front cover. Insert pressure treated wood into the trellis post. Set the trellis into position, and use a level to check the posts. Once you are satisfied with the orientation, fill in the holes. For added stability in high wind or high traffic areas, we recommend using pre-mix concrete (not included).

## Questions ? :

If you have any questions concerning the assembly or installation of this product and require assistance, please call our **Customer service department at 1-800-282-9346 (ext.#20)**, Weekdays from 8:00 am. to 4:00 pm. Eastern standard time.

If you have any comments or suggestions about our product or service, please let us know! Call: **1-800-282-9346 (ext.#20)**, or E-mail: **info@newenglandarbors.com**

To learn more about us, visit us on the web at: **www.newenglandarbors.com**