

ECR/DCR		REV.		REVISIONS		DATE	APPD
-	-	-	-	DESCRIPTION		8/29/16	-
				INITIAL RELEASE			

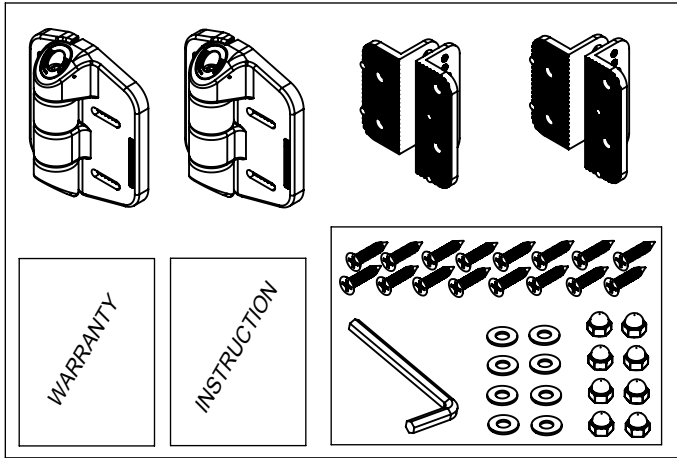
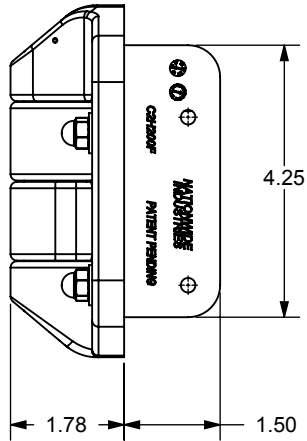
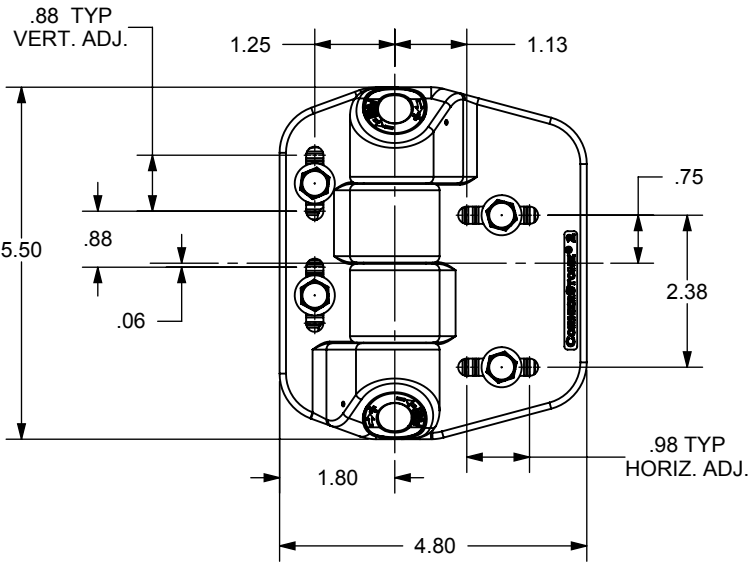
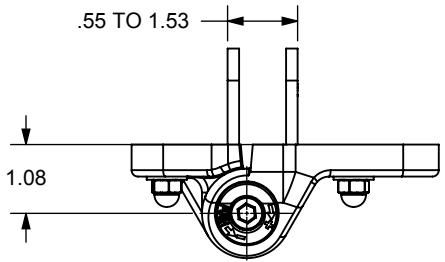
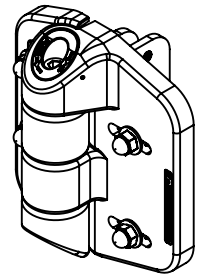
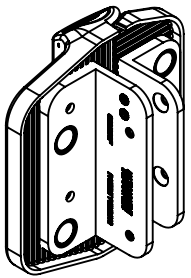

- PACKAGING:**
 POLYBAGGED SET INCLUDES
 (2) HINGE ASSEMBLIES
 (2) BACKPLATE H
 (2) BACKPLATE V
 (1) POLYBAGGED SCREW PACK
 (16) #12 FLAT HD 18-8 SS SCREWS
 SEE CHART FOR LENGTH AND TYPE
 (1) 1/4" HEX WRENCH
 (8) 1/4" FLAT WASHER 18-8 SS
 (8) 1/4-20 ACORN NUT 18-8 SS
 (1) INSTRUCTION SHEET
 (1) WARRANTY SHEET

C2H200F-SD-WH	WHITE	SELF-DRILLING	1.25"
C2H200F-SD-BK	BLACK	SELF-DRILLING	1.25"
C2H200F-WH	WHITE	SHEET METAL	1.00"
C2H200F-BK	BLACK	SHEET METAL	1.00"
PART NO.	COLOR	SCREW TYPE	SCREW LENGTH

PROPRIETARY AND CONFIDENTIAL
 THE INFORMATION CONTAINED IN THIS DRAWING IS THE SOLE PROPERTY OF NATIONWIDE INDUSTRIES. ANY REPRODUCTION IN PART OR AS A WHOLE WITHOUT THE WRITTEN PERMISSION OF NATIONWIDE INDUSTRIES IS PROHIBITED.

DIMENSIONS ARE IN INCHES		NAME	DATE
TOLERANCES:		DRAWN	EET 8/29/16
FRACTIONAL: ±1/16"		CHECKED	
ANGULAR: ±MACH ±1° BEND ±1°		ENG APPR.	
TWO PLACE DECIMAL ±0.01		MFG APPR.	
THREE PLACE DECIMAL ±0.005		G.A.	
MATERIAL		COMMENTS:	
30% GF NYLON 6/6			
FINISH			
DO NOT SCALE DRAWING			

NATIONWIDE INDUSTRIES

**CORNERSTONE 2
 2" FULLY ADJUSTABLE
 HINGE**

SIZE	DWG. NO.	REV.
A	CS--C2H200F	-
SCALE: 1:1	WEIGHT:	SHEET 1 OF 1