

2016 UL 325 ENTRAPMENT PROTECTION

IDENTIFY ENTRAPMENT AREAS

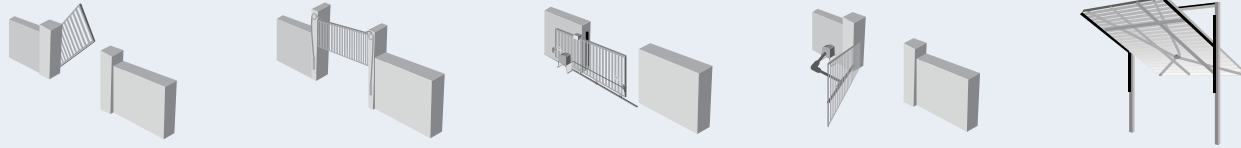

It is the contractor's responsibility to determine the number of potential areas where the risk of entrapment may exist. A minimum of two independent means of monitored protection must be present at all motorized gate entrapment points. The same device cannot be used for both means.

MONITOR PROTECTION DEVICES



Most UL listed gate operators manufactured after January 12, 2016 incorporate a monitored inherent (built-in) device along with an additional input for a monitored external device. These external sensors are monitored for presence and function at least once during each operation cycle.

PROTECT UNIVERSAL SAFETY



THE SOLUTION
MIM-62



GATE EDGE MODULE
GEM-10X



MONITORED GATE LINK
MGL-K20



REFLECTI-GUARD
RG



PRIME-GUARD
PG

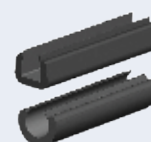

GATE EDGES
VARIOUS MODELS

As the pioneer of gate safety, Miller Edge's gate collection includes photo eyes and gate edges, which are available in multiple monitored electrical configurations. In addition, monitored accessories offer compatibility with nearly any operator brand to suit your safeguarding needs.

GATE SAFETY MATTERS



UNDERSTANDING GATE SAFETY CODES & STANDARDS



WHY COMPLY?



AHJ

(Authority Having Jurisdiction)
Adopts & enforces codes by state, locality, etc.

LOCAL ENFORCERS

States, localities, and agencies adopt codes

OSHA

(Occupational Safety & Health Administration)
Government agency that regulates workplaces.

RESIDENTIAL & COMMERCIAL CODES

Codes adopt standards established by nationally recognized testing labs

IRC 2012

(International Residential Code ≥2012)
A code regulating the construction of
1-2 family dwellings limited to three stories
above grade plane.

IFC 2009

(International Fire Code ≥2009)
Regulates fire safety for buildings, facilities, storage,
processes, and fire apparatus access roads.

IBC 2009

(International Building Code ≥2009)
Provides requirements to safeguard the public
health, safety, and general welfare of the occupants
of new and existing buildings and facilities thereof.

ICC

(International Code Council)
Develops model codes and standards used in the design, build,
and compliance process to construct safe, sustainable, affordable,
and resilient structures. Supports IRC, IFC, IBC, and others.

NFPA 70: NEC

(National Fire Protection Agency)
Adopted in 50 states, the NEC is the benchmark for safe electrical
design, installation, and inspection to protect people and property
from electrical hazards. Contributes to IRC, IFC, and IBC.

NATIONALLY RECOGNIZED TESTING LABS

Independent facilities that provide testing and certification services to manufacturers for compliance with safety standards

ASTM F2200

Standard specifications for
automated vehicular gate construction

AUTOMATED
GATE
OPERATOR

UL325

A safety standard for door, gate, drapery, louver,
and window operators and systems. Specifically,
UL 325 applies to electric operators and other
opening/closing appliances rated 600 volts or less.

SAFETY MATTERS