

ECR/DCR		REV.	REVISIONS	DESCRIPTION	DATE	APPD
-	-	-	INITIAL RELEASE		07-02-09	-

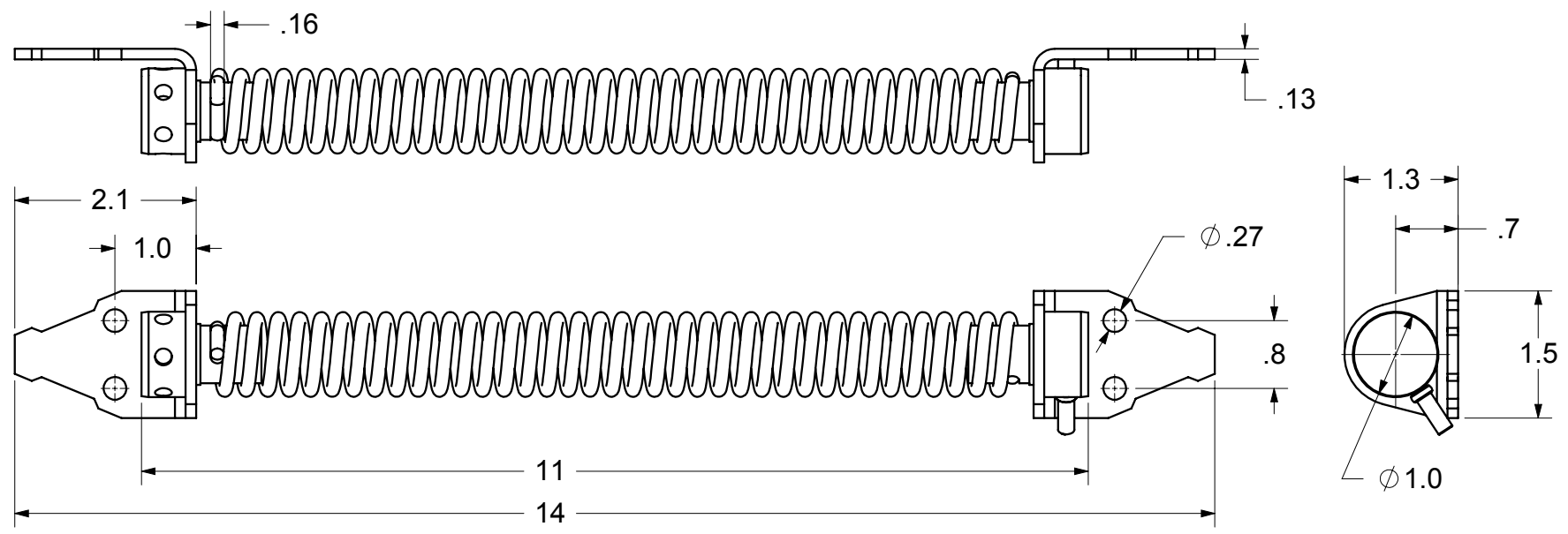

**SPRING ASSEMBLY**

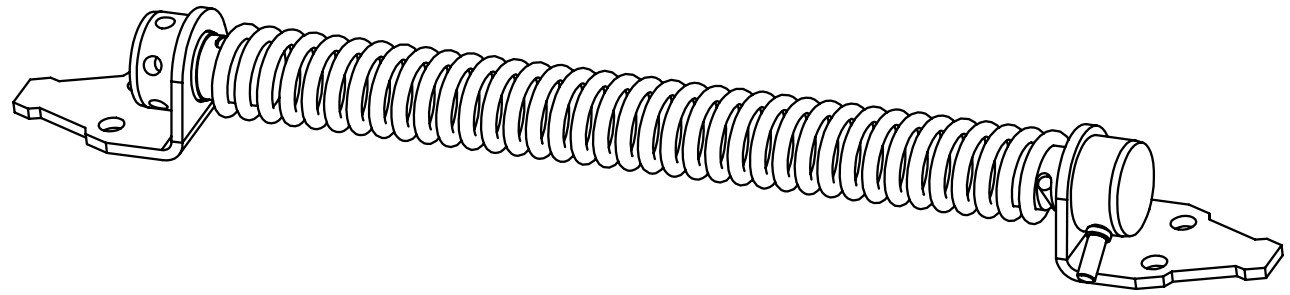
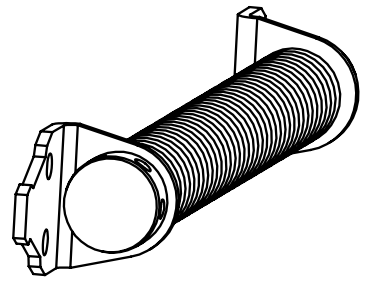
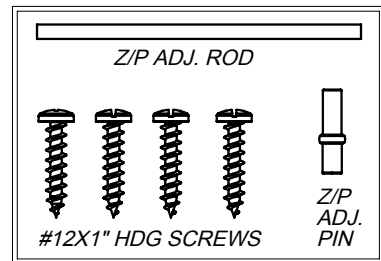

**SCREW PACK**

**PACKAGING:**  
 EACH SPRING ASSEMBLY IS  
 INDIVIDUALLY POLYBAGGED  
 WITH A POLYBAGGED SCREW  
 PACK

**PROPRIETARY AND CONFIDENTIAL**  
 THE INFORMATION CONTAINED IN THIS  
 DRAWING IS THE SOLE PROPERTY OF  
 NATIONWIDE INDUSTRIES. ANY  
 REPRODUCTION IN PART OR AS A WHOLE  
 WITHOUT THE WRITTEN PERMISSION OF  
 NATIONWIDE INDUSTRIES IS PROHIBITED.

DIMENSIONS ARE IN INCHES TOLERANCES: FRACTIONAL: ±1/16" ANGULAR: MACH ±1° BEND ±1° TWO PLACE DECIMAL ±0.01 THREE PLACE DECIMAL ±0.005		NAME <b>EET</b>	DATE <b>7/2/09</b>
MATERIAL <b>Z/P STEEL</b>	FINISH <b>POWDERCOAT</b>	COMMENTS: POWDERCOAT IS INTERPON 600 OR NWI APPROVED EQ.	
DO NOT SCALE DRAWING			



**WOOD GATE SPRING**

SIZE <b>A</b>	DWG. NO. <b>CS--NW38304Q</b>	REV. <b>-</b>
SCALE: 1:2		WEIGHT: 0.152 LB.
SHEET 1 OF 1		