

		REVISIONS			
ECR/DCR	REV	DESCRIPTION	DATE	APPROVED	
---	--	INITIAL RELEASE	7/02/09	--	
ECR-0599	1	REVISED ADJ PIN AND SCREW PIN	9/21/11	CGS	

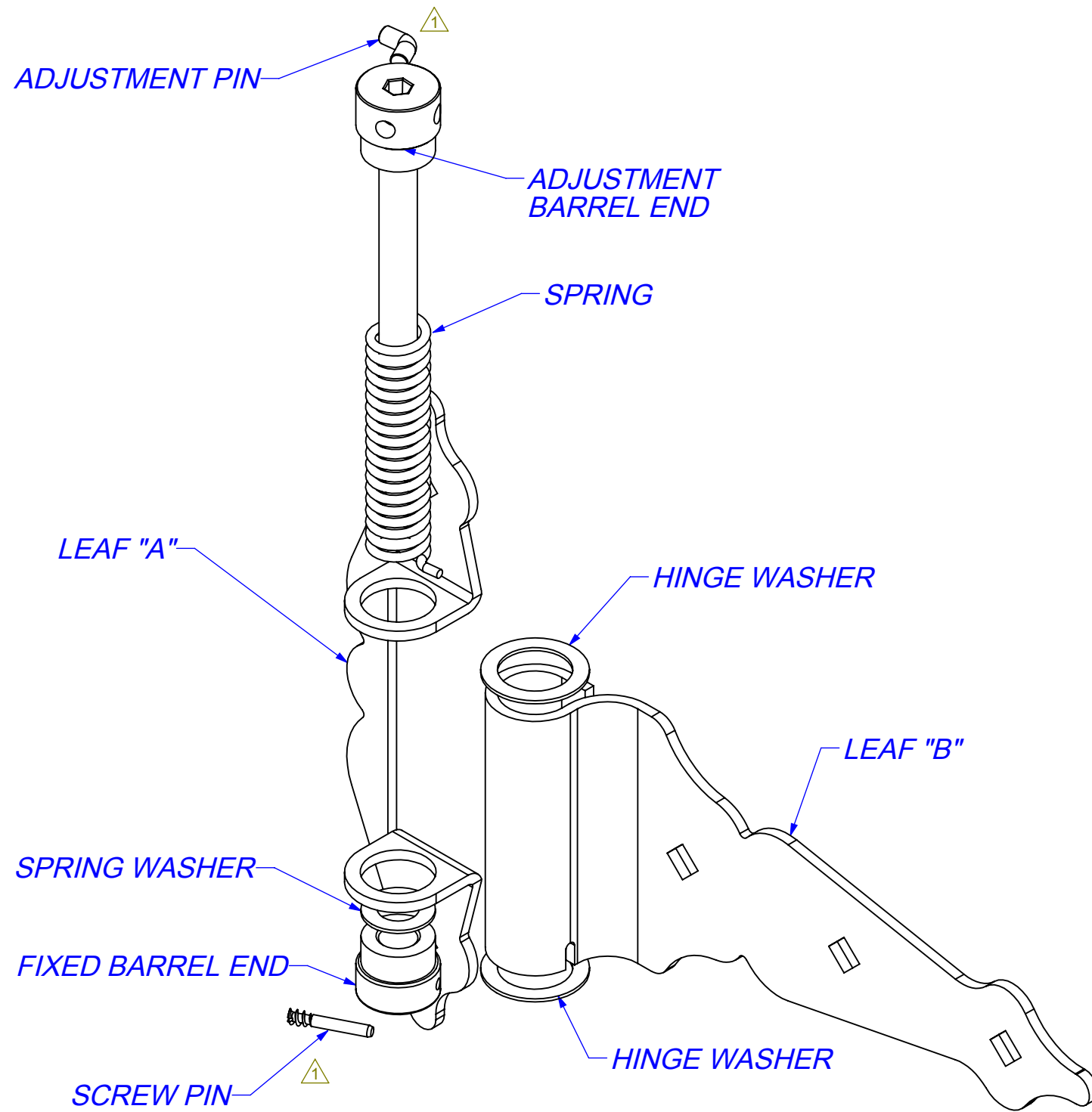

HINGE ASSEMBLY
(EXPLODED VIEW)

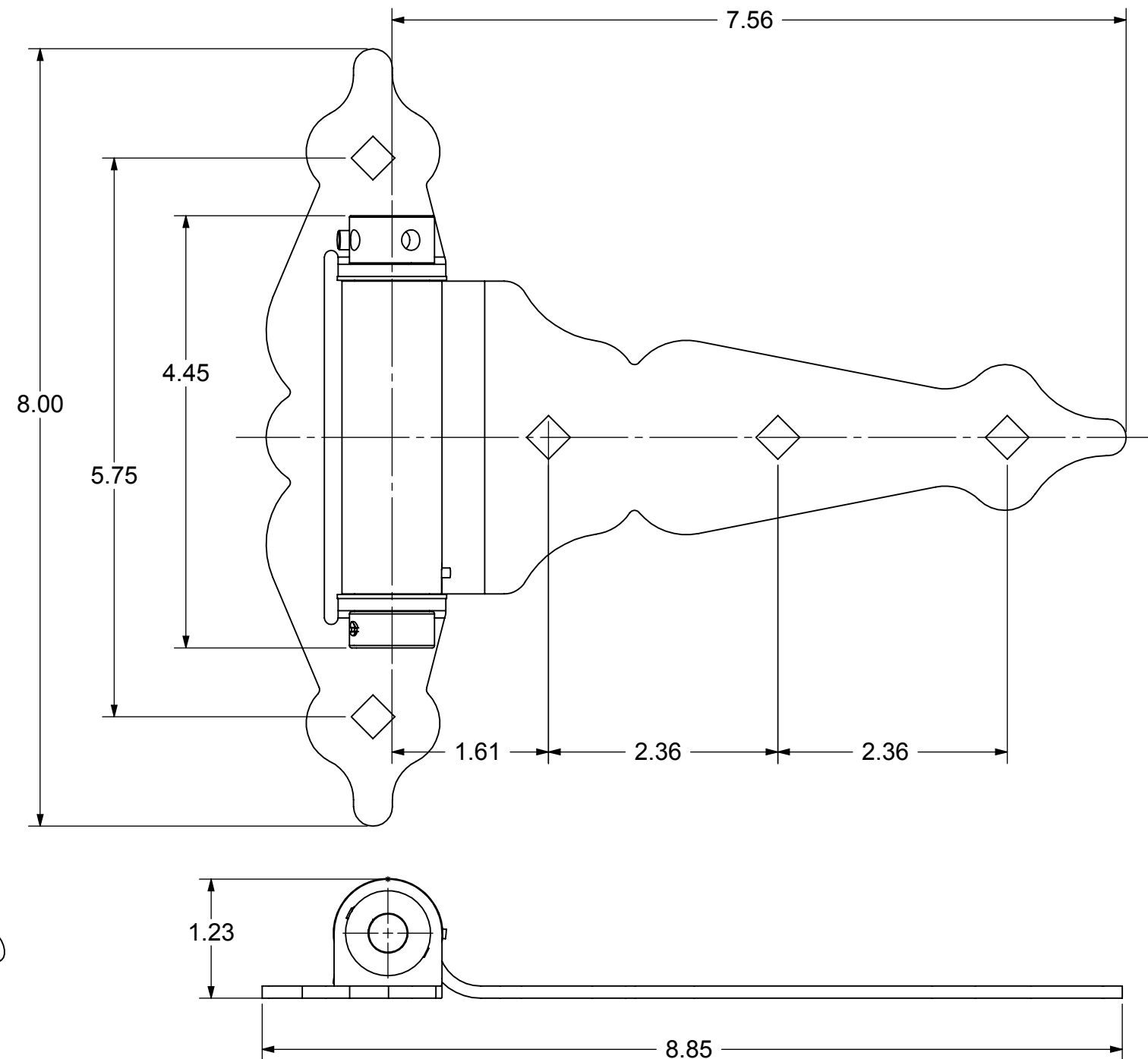

PACKAGE INCLUDES:

- (2) HINGE ASSEMBLIES**
- (2) ADJUSTMENT PINS**
- (1) ALLEN WRENCH**
- (10) 5/16 x 1.75 LG LAG SCREWS**

PROPRIETARY AND CONFIDENTIAL
THE INFORMATION CONTAINED IN THIS DRAWING IS THE SOLE PROPERTY OF NATIONWIDE INDUSTRIES. ANY REPRODUCTION IN PART OR AS A WHOLE WITHOUT THE WRITTEN PERMISSION OF NATIONWIDE INDUSTRIES IS PROHIBITED.

NEXT ASSY	USED ON
APPLICATION	

DIMENSIONS ARE IN INCHES
TOLERANCES:
FRACTIONAL $\pm 1/16"$
ANGULAR: MACH $\pm 1^\circ$ BEND $\pm 1^\circ$
TWO PLACE DECIMAL ± 0.01
THREE PLACE DECIMAL ± 0.005

MATERIAL
ZINC PLATED STEEL

FINISH
POWDER COAT

DO NOT SCALE DRAWING

	NAME	DATE
DRAWN	CGS	7/2/09
CHECKED		
ENG APPR.	EET	7/2/09
MFG APPR.		
Q.A.		
COMMENTS:		

ORNAMENTAL "T" HINGE
8" SELF-CLOSING

SIZE	DWG. NO.	REV.
B	CS--NW38937HDQ	1

SCALE: 1:1.5 WEIGHT: SHEET 1 OF 1