

REVISIONS				
ECR/DCR	REV.	DESCRIPTION	DATE	APPD.
-	-	INITIAL RELEASE	5/23/13	-

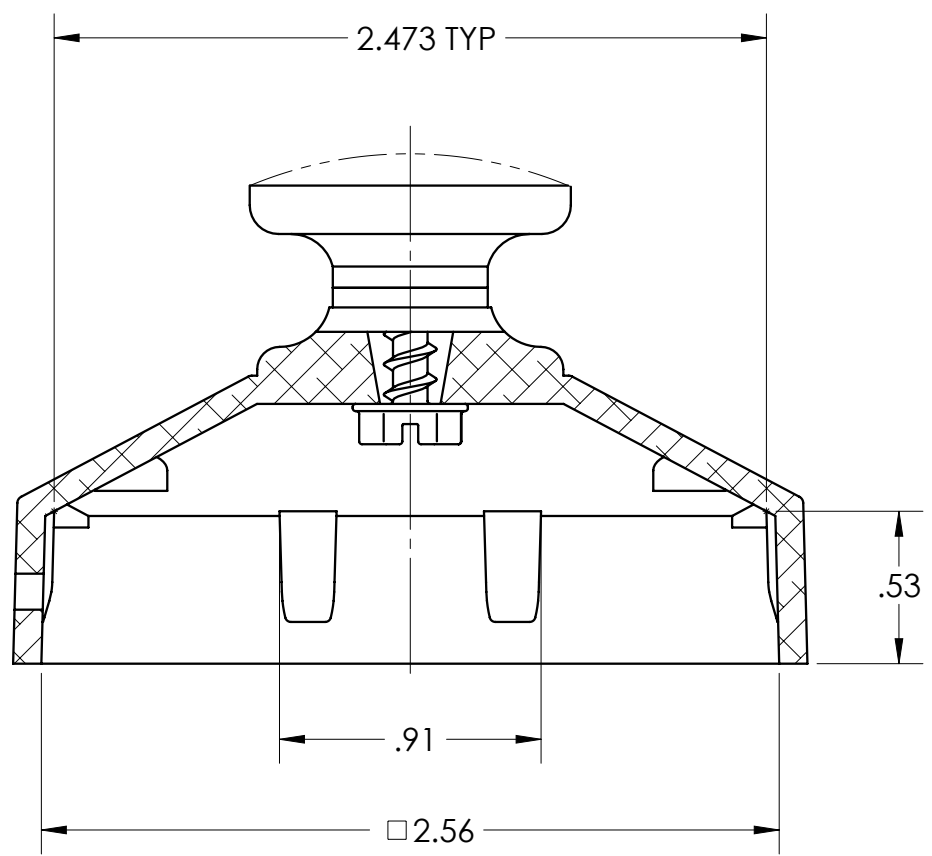

DETAIL K
SCALE 3:2

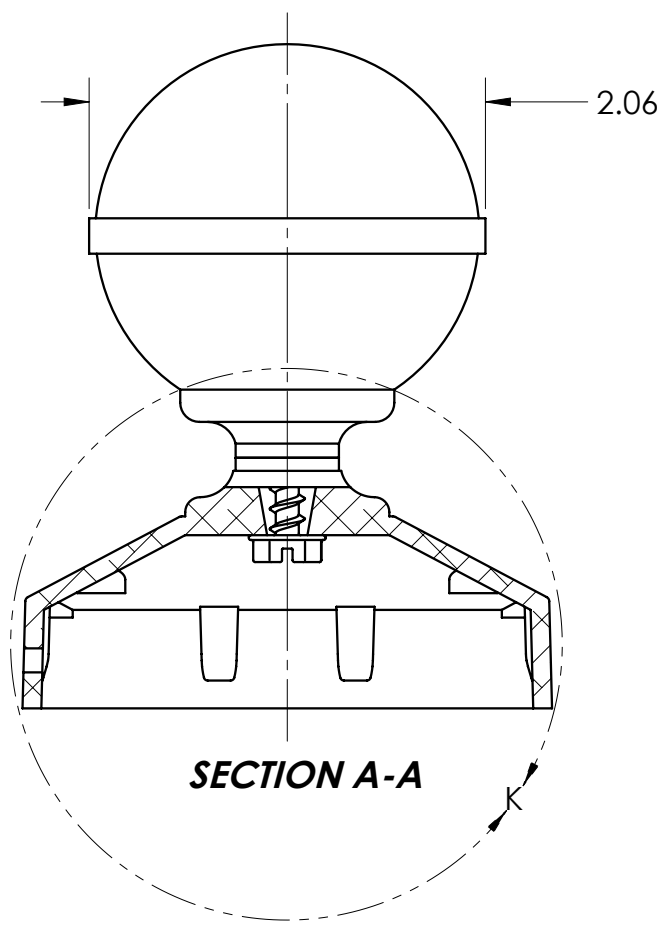
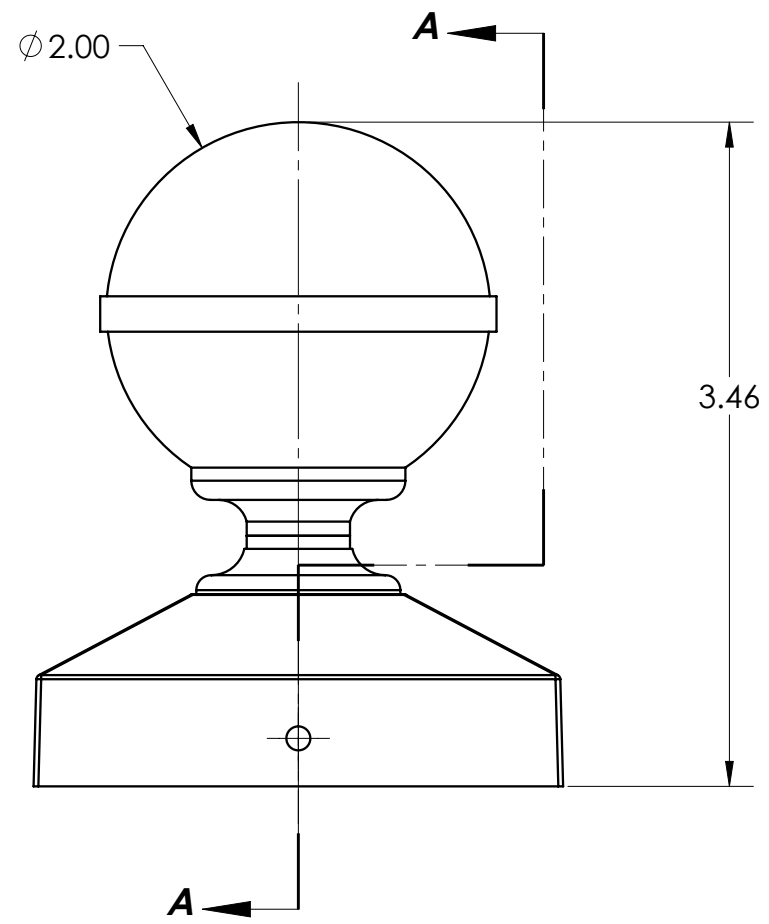
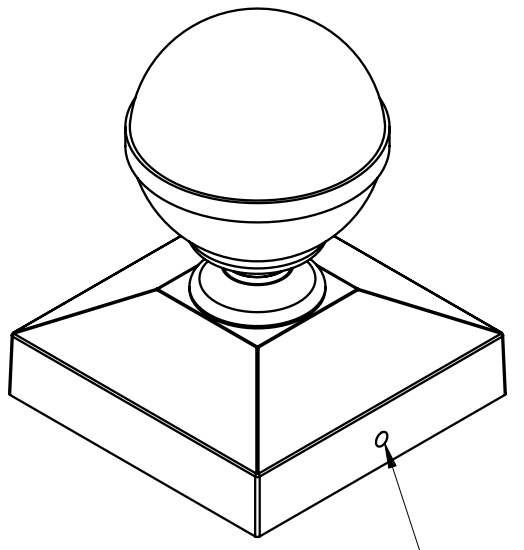
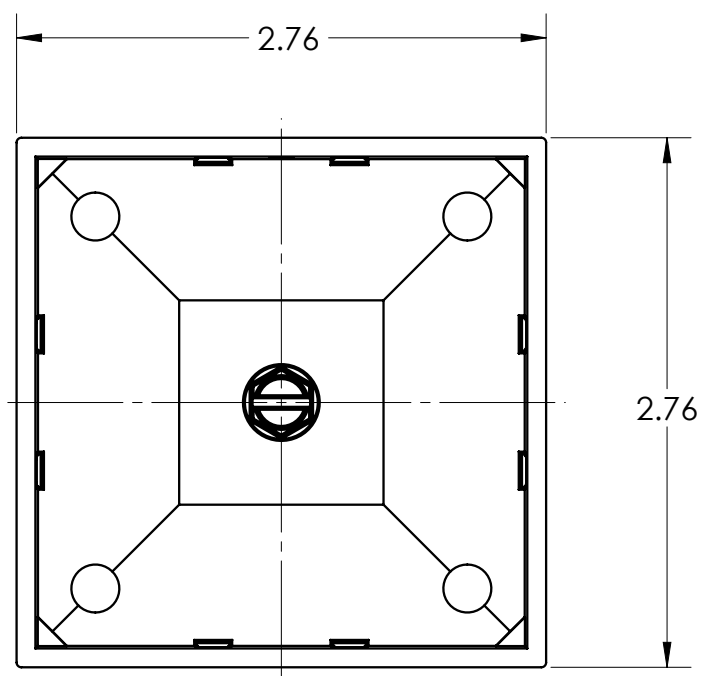

OPTIONAL
SCREW HOLE

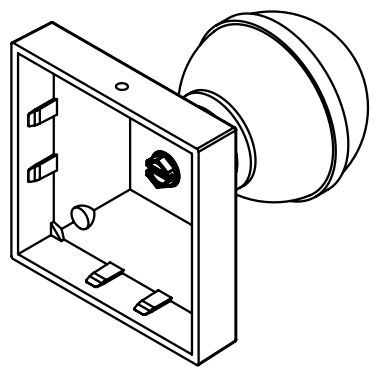

PROPRIETARY AND CONFIDENTIAL
THE INFORMATION CONTAINED IN THIS DRAWING IS THE SOLE PROPERTY OF NATIONWIDE INDUSTRIES. ANY REPRODUCTION IN PART OR AS A WHOLE WITHOUT THE WRITTEN PERMISSION OF NATIONWIDE INDUSTRIES IS PROHIBITED.

DIMENSIONS ARE IN INCHES		NAME	DATE
TOLERANCES:		DRAWN	AMM 5/23/13
FRACTIONAL $\pm 1/16"$		CHECKED	-
ANGULAR: MACH $\pm 1^\circ$ BEND $\pm 1^\circ$		ENG APPR.	-
TWO PLACE DECIMAL ± 0.01		MFG APPR.	-
THREE PLACE DECIMAL ± 0.005		Q.A.	-
MATERIAL		COMMENTS:	
A360 CAST ALUM			
FINISH			
MILL / POWDERCOAT			
DO NOT SCALE DRAWING			



2.5" LIGHT WEIGHT BALL CAP

SIZE	DWG. NO.	REV.
B	CS--NW6179	-
SCALE: 1:1	WEIGHT: LB.	SHEET 1 OF 1