



LOCINOX
Let's make it better together

PRODUCT BROCHURE

NORTH AMERICA



Gate Closers



Access Control



Gate Hardware

SEE WHAT'S **NEW!**

SERVAL (p. 12)



FORTIMA (p. 29)



VALENTINO (p. 44)



INTERIO (p. 21)



NEED INSPIRATION?

HAVE A LOOK AT OUR INTEGRATED SOLUTIONS.

GATE CONCEPTS: Before you start, have a look at our gate concepts

GATE CLOSERS & SELF-CLOSING HINGES

NEW Self-closing Spring Hinges

Gate Closers With Hinge Included (New Fit)

Gate Closers (Retrofit)

LOCKS & KEEPS

NEW FORTiMA Magnetic Pool Safety Latch

AUTOMATION & ELECTRONICS

NEW VALENTINO Battery Powered Code Lock

HINGES & DROP BOLTS

TURNSTILE MECHANISM

#WEARELOCINOX

We are pioneers of high quality outdoor gate hardware. All our products are developed based on 4 criteria:



EASE OF USE



WEATHERPROOF



INDUSTRIAL QUALITY



INNOVATIVE DESIGN

WE'LL SAVE YOU TIME & MONEY

Whether you're a fence contractor, distributor, manufacturer, or locksmith - an easy and efficient installation is always beneficial. Every Locinox solution meets the highest quality standards; our products withstand the test of time and are designed to cope with the most extreme weather circumstances.



SPEED OF INSTALLATION
SAVE TIME & MONEY



PRODUCT QUALITY
ELIMINATE SERVICE CALLS



LEFT OR RIGHT HANDED
SAVE ON INVENTORY

ACCESS CONTROL SOLUTIONS FOR ANY GATE



CHILDPROOF & CODE COMPLIANT SWIMMING POOL SOLUTIONS

FORTIMA (p.29)

Sleek and sturdy child safe magnetic latch for pools and parks

TIGER (p.15)

Compact hinge and gate closer in one

PUMA (p.54)

Compact 2-way adjustment 180° surface mounted hinge

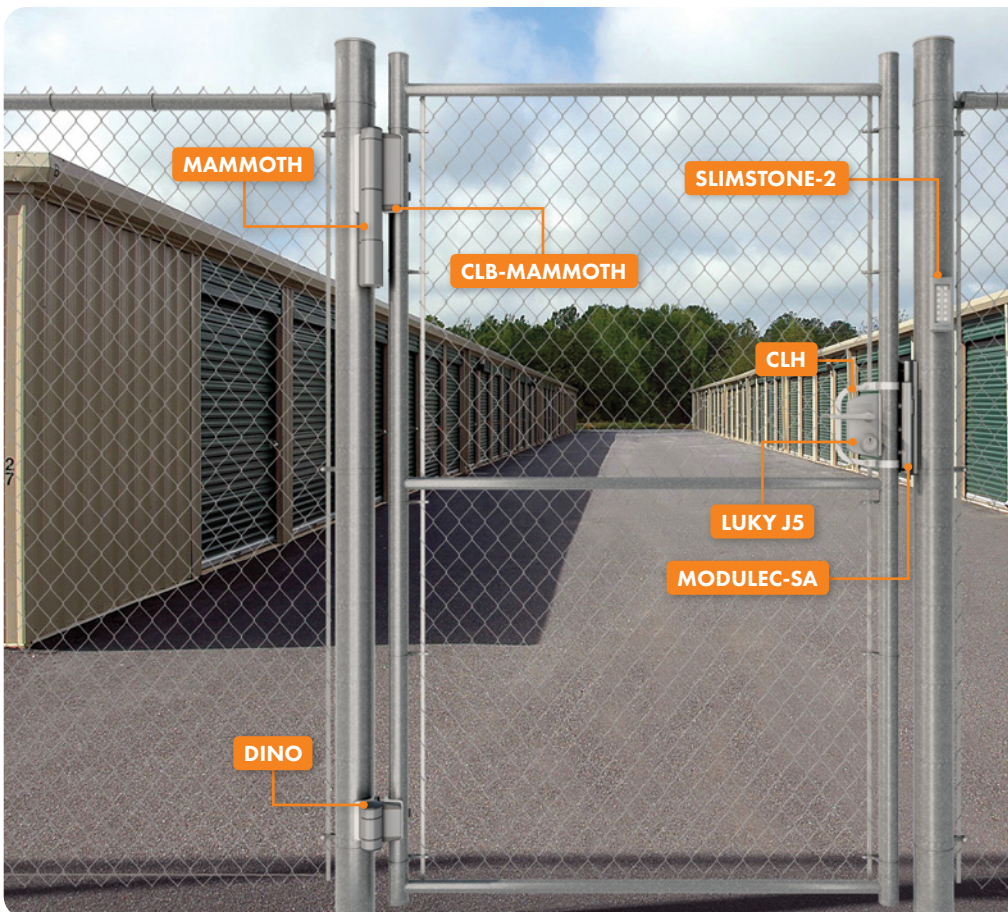

SAFE SOLUTIONS FOR INDUSTRIAL GRADE CHAIN LINK GATES

MAMMOTH (p.14)

Stylish hydraulic gate closer for heavy gates

CLB-MAMMOTH (p.16)

Chain link bracket for Mammoth

LUKY J5 (p.35)

Surface mounted US Mortise cylinder gate lock

CLH (p.38)

Chain link tension bar adaptor

3019LA-S-C-V (p.38)

Adaptor plate for LA and LS locks

MODULEC-SA (p.47)

Surface mounted electric strike

3018-MOD (p.47)

Adaptor plate for Modulec strike

SLIMSTONE-2 (p.45)

Robust, weatherproof and frost-free keypad (IP68)



RELIABLE & DURABLE SOLUTIONS FOR DOG PARK GATES

TIGER (p.15)

Compact hinge and gate closer in one

CLB-TIGER (p.16)

High quality aluminum bracket for installation of Tiger gate closer on round chain link fences

LUKY J5 (p.35)

Surface mounted US mortise cylinder gate lock (USA)

KEYDROP (p.55)

High quality key lockable drop bolt

CLH (p.38)

Chain link tension bar adaptor

3019LA-S-C-V (p.38)

Adaptor plate for LA and LS locks

SAKL QF (p.38)

Adjustable keep out of stainless steel

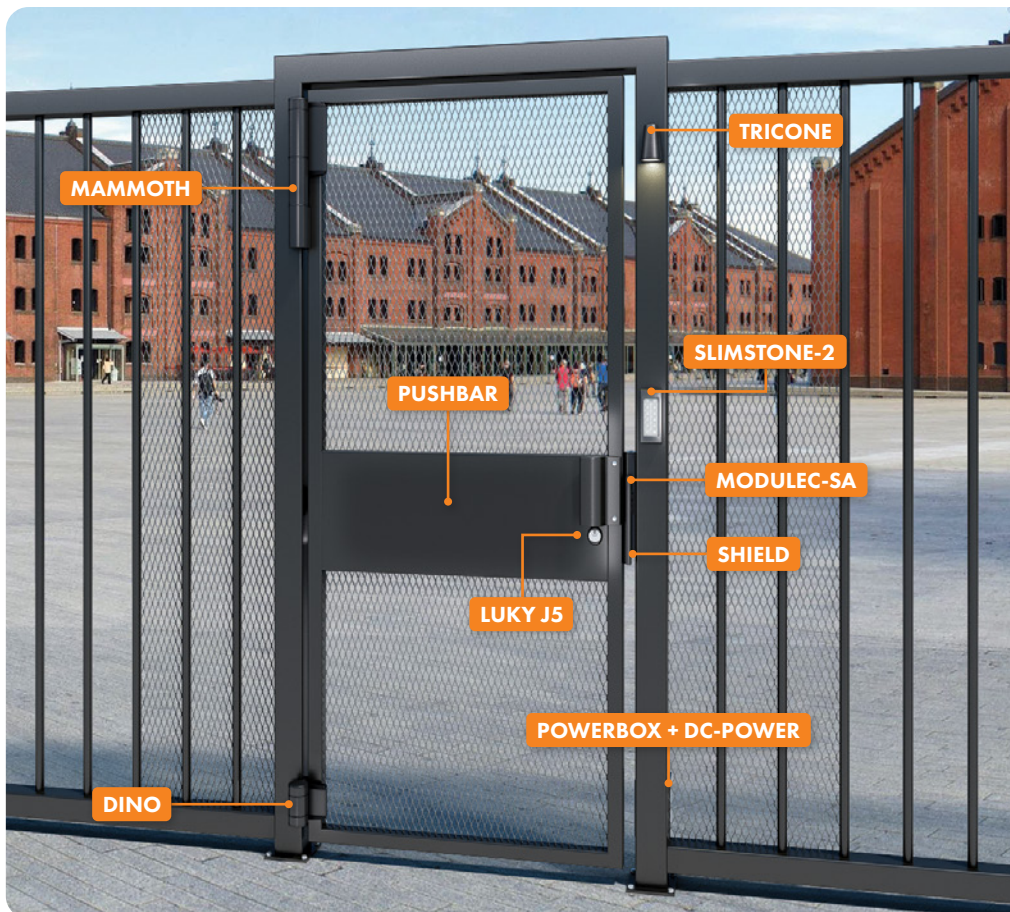

SAFE & CONVENIENT SOLUTIONS FOR ADA AND FREE EGRESS GATES

MAMMOTH (p.14)

Powerful 180° hydraulic gate closer and hinge in one, for gates up to 330 lbs

LUKY J5 (p.35)

Gate lock with handles – includes 2 US Mortise cylinders

PUSHBAR (p.37)

Easy-to-open panic release bar

SLIMSTONE-2 (p.45)

Robust, weatherproof and frost-free keypad (IP68)

MODULEC-SA (p.47)

Premium surface mounted electric strike

SHIELD (p.38)

Anti-theft protection plate for keeps

TRICONE (p.50)

Elegant LED exterior light

POWERBOX + DC-POWER (p.51)

Transformer housing + Safety power supply

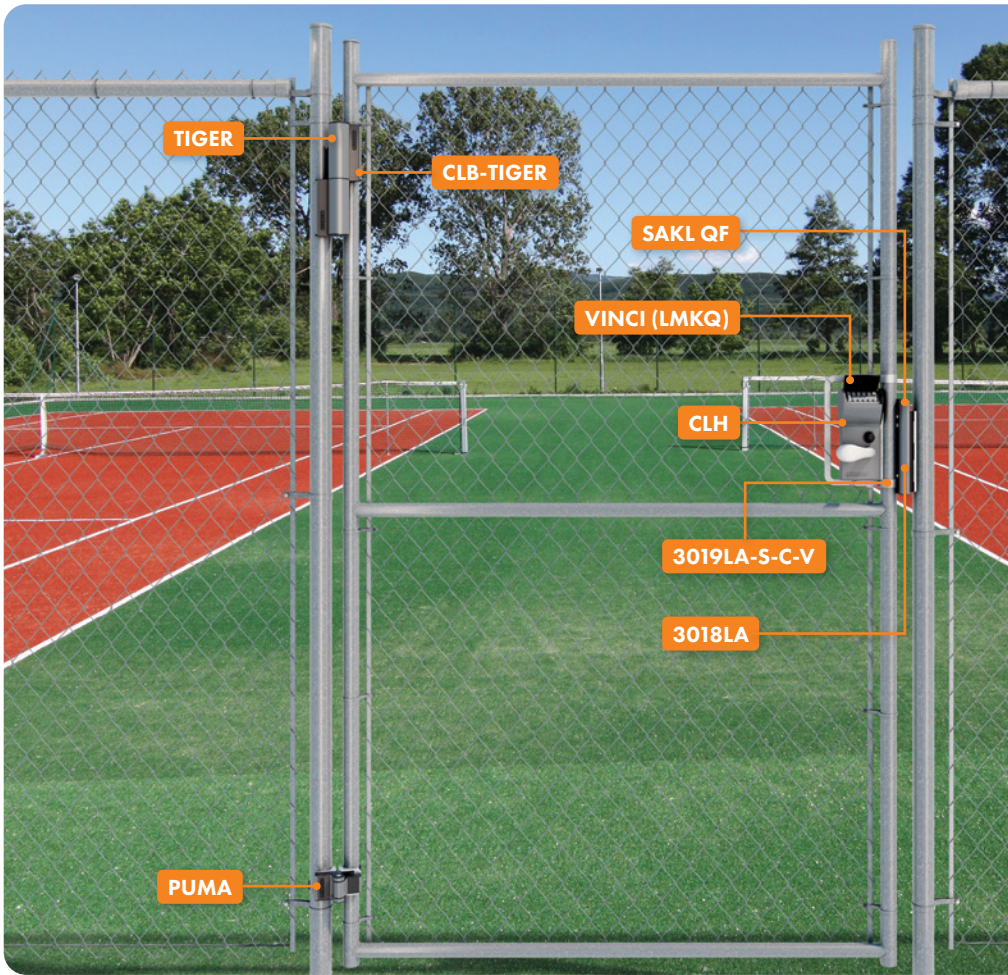

EASY & RELIABLE SOLUTIONS FOR CHAIN LINK ACCESS GATES

TIGER (p.15)

Compact hinge and gate closer in one

CLB-TIGER (p.16)

High quality aluminum bracket for installation of Tiger gate closer on round chain link fences

PUMA (p.54)

Compact 2-way adjustment 180° surface mounted hinge

VINCI (LMKQ) (p.36)

Surface mounted mechanical code lock

CLH (p.38)

Chain link tension bar adaptor

3019LA-S-C-V

3019LA-S-C-V (p.38)

Adaptor plate for LA and LS locks

3018LA

SAKL QF (p.38)

Industrial stainless steel keep

3018LA (p.38)

Round adaptor plate for locks

PUMA



THE COMPLETE CHAIN LINK CONCEPT GATE FOR ALL USES

SAMSON-2 (p.17)

Hydraulic retrofit gate closer for wide gates up to 330 lbs

SB (p.16)

Galvanized bracket to mount Samson-2 on chain link gates

LUKY J5 (p.35)

Surface mounted US mortise cylinder gate lock (USA)

3019LA-S-C-V (p.38)

Adaptor plate for LA and LS locks

6403 (p.38)

Round adaptor plate for SH keeps

SHKL (p.38)

Industrial stainless steel security keep

SHIELD (p.38)

Anti-theft protection plate for keeps

CLH (p.38)

Chain link tension bar adaptor

SB

SAMSON-2

SHKL

CLH

LUKY J5

SHIELD

3019LA-S-C-V

6403



SERVAL p. 12

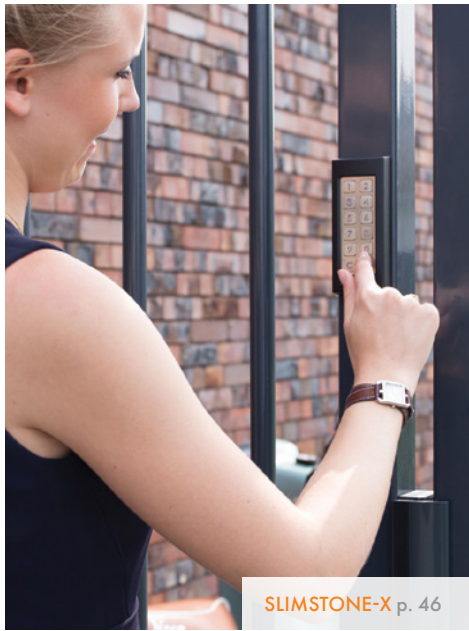

SLIMSTONE-X p. 46



VALENTINO p. 44



MAMMOTH p. 14

WE HAVE THE SOLUTION YOU NEED.



FREE VINCI p. 36



FORTIMA p. 29



TIGER p. 15



MAGLOCK p. 49



MAMMOTH HYDRAULIC
GATE CLOSER (p. 13)

Gate closers

Hydraulic gate closers will transform any gate into a self-closing solution. Comfort, safety and peace of mind are guaranteed thanks to pure hydraulic power. High quality components ensure Locinox gate closers to be 100% weatherproof, maintenance-free and extremely durable. A constant and consistent functioning is guaranteed during an ice cold winter or a sweltering summer. The unique concept ensures an easy and efficient fixation thanks to the patented Quick-Fix system. Moreover, closing speed and final snap can be adjusted very precisely and 100% to your customers' wishes.



12 SERVAL

13 MAMMOTH-HD

14 MAMMOTH



15 TIGER

17 SAMSON-2

18 LION



19 VERTICLOSE-2

20 VERTICLOSE-2 WALL

21 INTERIO

22 PANTHER

CUTTING EDGE SELF-CLOSING TECHNOLOGY



1 CONSISTENCY

If your gate closes too slow, children or pets could sneak through. If your gate closes too fast, it might become a problem for wheelchair users. A loud slamming gate is not only annoying for you and your neighbors, it's also harmful to your gate.

2 COMFORT

The in-house developed high-helix screws guarantee consistent functionality and ensure a comfortable opening speed for elderly or disabled persons.

5 DURABILITY

The powerful torsion spring guarantees the necessary closing force. Your gate will always close, unaffected by strong winds, the width of your gate, or the outside temperature.

3 WEATHERPROOF

Our gate closers are equipped with rotary seals. These seals protect the gate closers from dirt or dust particles intruding the mechanism, assuring your customers worry-free functioning for many years to come.

4 PRECISION

Some customers prefer their gate to close slowly, while others want it to go a little faster. No problem! All our hydraulic gate closers can easily be adjusted to the wishes of your customers in a matter of seconds.

6 QUALITY

The anodized aluminum housing guarantees full protection against all weather conditions. This housing is frost-free and wind, dust and waterproof, which allows your gate closer to function perfectly.

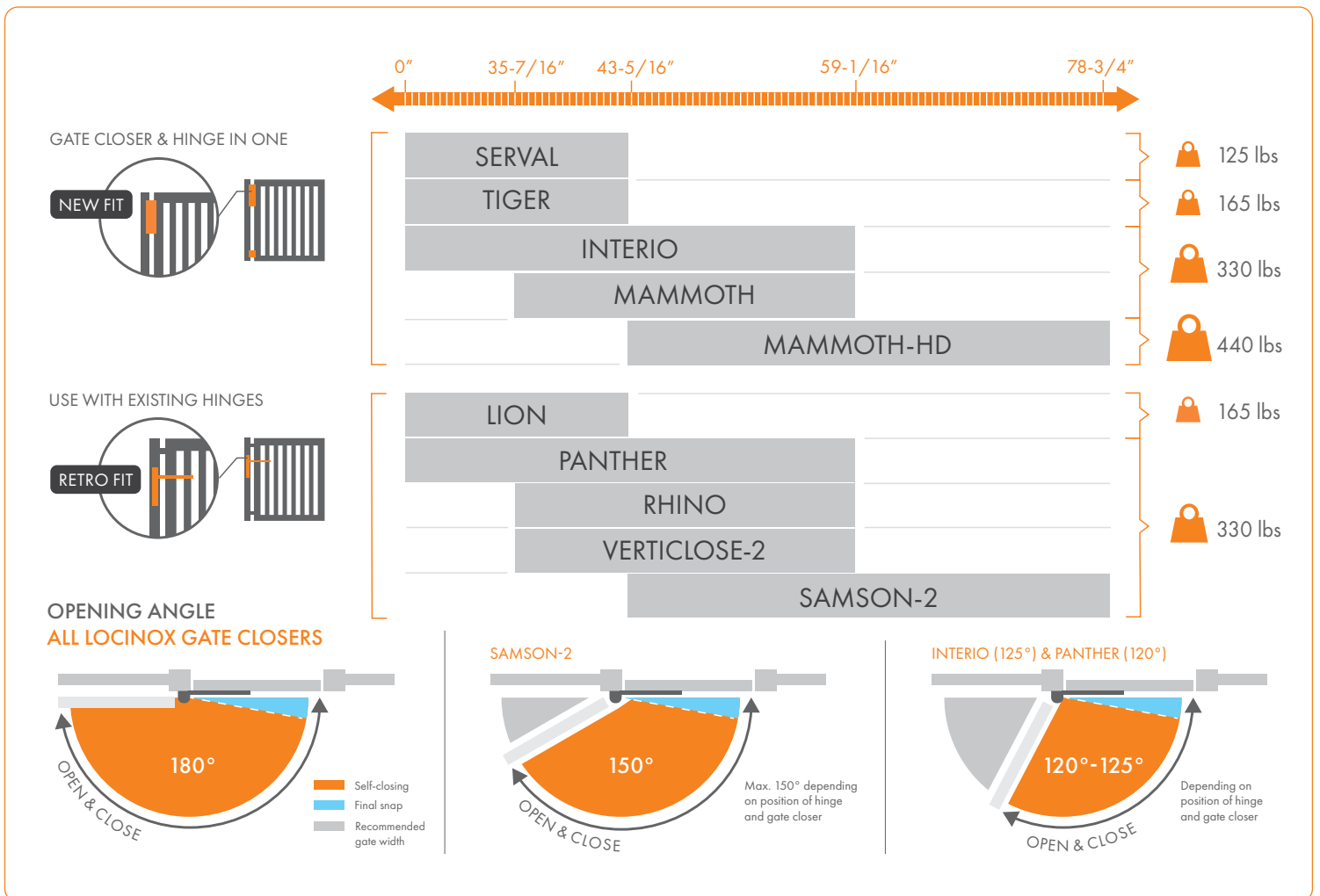

LOCINOX[®]

Let's make it better together

Introducing *NEW*
180° SPRING HINGE



SERVAL

180° SPRING HINGE

Perfectly pairs with the FortiMa latch

NEW

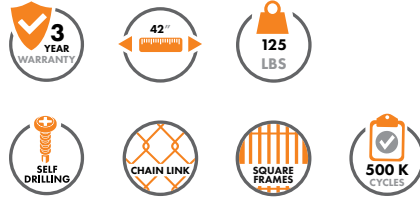

- ✓ Fiberglass reinforced PA housing
- ✓ Automatic 180° closure
- ✓ Adjustable closing speed
- ✓ Aesthetic design
- ✓ Fast and easy installation
- ✓ Horizontal & vertical adjustability
- ✓ Easy to open: max 14Nm/125lbs

RECOMMENDED APPLICATIONS

- Ornamental steel
- Ornamental aluminum
- Galvanized/Steel chain link (for round installations, use adaptors)
- For wood and vinyl installations, please contact manufacturer

INSTALLATION

- New or retrofit installations with 125 lbs holding force
- Installs on square or round posts
- No welding required!
- Reversible for left or right opening gates
- Adjustable closing speed and final snap

RECOMMENDED FOR



MAMMOTH-HD

HEAVY DUTY 180° GATE CLOSER AND HINGE IN ONE FOR GATES UP TO 440 LBS

NEW



- ✓ Stainless steel double bearing
- ✓ Powder coated aluminum housing
- ✓ Specifically designed for exterior use: rain & frost-proof
- ✓ Secure, fast, and easy attachment: Quick-Fix mounting bolts
- ✓ 180° closing angle – NO gate stop needed
- ✓ Closing speed unaffected by humidity and temperature changes
- ✓ ADA compliant opening resistance (< 5 lbs) from gate width 4 ft. 7 in and up (max 30 Nm)
- ✓ Adjustable closing speed & final snap
- ✓ Vandal-proof and easy to install
- ✓ Installation gap 1/16" min up to 1-3/8" max (SQUARE)
- ✓ Adjustability 3/4" gap and 3/4" height
- ✓ Patented hydraulic damping
- ✓ For left and right opening gates



MAMMOTH-HD-9005

MAMMOTH-HD-ZILV

RECOMMENDED APPLICATIONS

- Ornamental steel
- Ornamental aluminum
- Galvanized/Steel
- For wood and vinyl installations, please contact the manufacturer

INSTALLATION

- New or retrofit installations using Locinox Quick-Fix mounting bolts with 2,000 lbs holding force
- Installs on square posts
- Aligns with ease using the DRILLVISE-II or DRILLVISE-IV installation tools (p. 25)
- No welding required!
- Reversible for left or right opening gates
- Adjustable closing speed and final snap

RECOMMENDED FOR

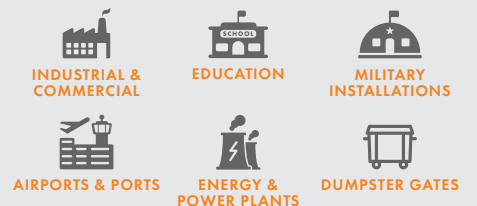

MAMMOTH

HEAVY DUTY 180° GATE CLOSER AND HINGE IN ONE FOR GATES UP TO 330 LBS



- ✓ Stainless steel double bearing
- ✓ Powder coated aluminum housing
- ✓ 180° closing angle - NO gate stop needed
- ✓ Patented hydraulic damping
- ✓ Closing speed unaffected by humidity and temperature changes
- ✓ ADA compliant: low opening resistance: max. 16 Nm (3-5 lbs)
- ✓ Adjustable closing speed & final snap
- ✓ Designed for exterior use: rain & frost-free
- ✓ Secure, fast and easy attachment: Quick-Fix anchor bolts
- ✓ Installation gap 1/16" min up to 1-3/8" max (ornamental)
- ✓ Vandal-proof
- ✓ Adjustability 3/4" gap and 3/4" height
- ✓ Round installation with CLB-MAMMOTH (p. 16)



MAMMOTH180-9005

MAMMOTH180-ZILV

RECOMMENDED APPLICATIONS

- Ornamental steel
- Ornamental aluminum
- Galvanized/Steel chain link (for round installations, use adaptors on p. 17)
- For wood and vinyl installations, please contact the manufacturer

INSTALLATION

- New or retrofit installations using Locinox Quick-Fix mounting bolts with 2,000 lbs holding force per each
- Installs on square or round posts using chain link brackets (p. 17)
- Aligns with ease using the DRILLWISE-II or DRILLWISE-IV installation tools (p. 25)
- No welding required!
- Reversible for left or right opening gates
- Adjustable closing speed and final snap

RECOMMENDED FOR



TIGER

COMPACT 180° HYDRAULIC GATE CLOSER AND HINGE IN ONE FOR GATES UP TO 165 LBS



PUMA HINGE INCLUDED



- ✓ Double stainless steel bearing
- ✓ Powder coated aluminum housing
- ✓ 180° closing angle - NO gate stop needed
- ✓ Patented hydraulic damping
- ✓ Closing speed unaffected by humidity and temperature changes
- ✓ ADA compliant: low opening resistance: max. 14 Nm (3-5 lbs)
- ✓ Adjustable closing speed & final action
- ✓ Specifically designed for exterior use: rain & frost-proof
- ✓ Secure, fast and easy attachment: Quick-Fix mounting bolts
- ✓ Installation gap $\frac{7}{16}$ " min up to 1" max (ornamental)
- ✓ Adjustability $\frac{5}{8}$ " gap and $\frac{3}{4}$ " height
- ✓ Fits chain link (gap $1-\frac{1}{16}$ " to $1-\frac{1}{8}$ ")
- ✓ Round Installation with CLB-TIGER (p. 16)

9005

ZILV



TIGER-9005



TIGER-ZILV

RECOMMENDED APPLICATIONS

- Ornamental steel
- Ornamental aluminum
- Galvanized/Steel chain link (for round installations, use adaptors on p. 15)
- For wood and vinyl installations, please contact the manufacturer

INSTALLATION

- New or retrofit installations using Locinox Quick-Fix mounting bolts with 2,000 lbs holding force
- Installs on square or round posts using chain link brackets (p. 17)
- Aligns with ease using TIGERDRILL (p. 25)
- No welding required!
- Reversible for left or right opening gates
- Adjustable closing speed and final snap

RECOMMENDED FOR



FIT LOCINOX GATE CLOSERS ON ROUND FRAMES?

CLB-TIGER

CHAIN LINK BRACKET FOR
TIGER GATE CLOSER



- ✓ Design gap including brackets: 1- $\frac{3}{8}$ "
- ✓ Brackets for Puma hinge included
- ✓ Gap from 1- $\frac{1}{16}$ " to 1- $\frac{1}{16}$ "

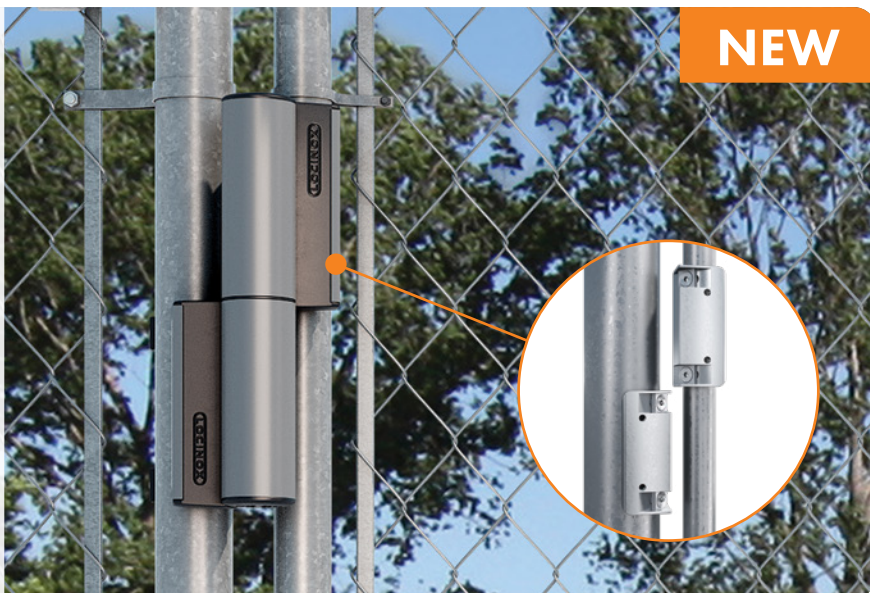

NEW

NEW

CLB-MAMMOTH

CHAIN LINK BRACKET FOR
MAMMOTH GATE CLOSER



- ✓ Design gap including brackets: 1- $\frac{5}{8}$ "
- ✓ Brackets for Dino hinge included
- ✓ Gap from 1- $\frac{3}{16}$ " to 2- $\frac{1}{16}$ "



SB

CHAIN LINK BRACKET FOR
SAMSON-2 GATE CLOSER



- ✓ Galvanized steel mounting brackets accept standard Quick-Fix anchor bolts on Samson-2

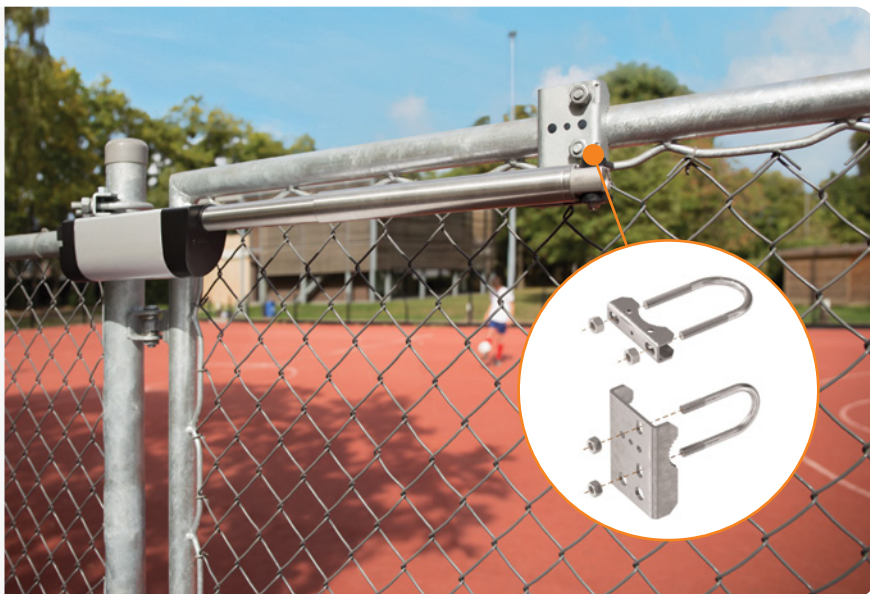

SAMSON-2

HYDRAULIC RETROFIT GATE CLOSER FOR WIDE GATES UP TO 330 LBS



- ✓ Powerful gate closer for retrofit situations
- ✓ Powder coated aluminum housing
- ✓ 150° opening & closing angle depending on the hinge situation
- ✓ Patented hydraulic damping
- ✓ Closing speed unaffected by humidity and temperature changes
- ✓ Adjustable closing speed & final action
- ✓ Specifically designed for exterior use: rain & frost-proof
- ✓ Secure, fast and easy installation: Quick-Fix mounting bolts
- ✓ To use with separate hinges (retrofit)
- ✓ Fits chain link with separate brackets (SB)



ZILV



SAMSON-2

RECOMMENDED APPLICATIONS

- Ornamental steel
- Ornamental aluminum
- Galvanized/Steel chain link (for round installations, use brackets on p. 15)
- For wood and vinyl installations, please contact the manufacturer

INSTALLATION

- Retrofit installation using Locinox Quick-Fix mounting bolts with 2,000 lbs holding force
- Installs on square or round posts using SB chain link brackets (p. 17)
- No welding required!
- Reversible for left or right opening gates
- Adjustable closing speed and final snap
- Samson-2 is a gate closer, not a hinge. Separate, exterior rated hinges are needed and recommended

RECOMMENDED FOR

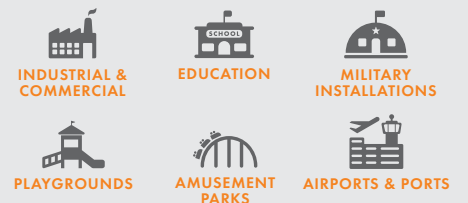

LION

COMPACT 90° OR 180° RETROFIT GATE CLOSER FOR GATES UP TO 165 LBS



- ✓ Powerful 180° gate closer for retrofit situations
- ✓ Powder coated aluminum housing
- ✓ 180° closing angle - NO gate stop needed
- ✓ Patented hydraulic damping
- ✓ Closing speed unaffected by humidity and temperature changes
- ✓ ADA compliant: low opening resistance: max. 15 Nm (3-5 lbs)
- ✓ Adjustable closing speed & final action
- ✓ Specifically designed for exterior use: rain & frost-proof
- ✓ Secure, fast and easy attachment: Quick-Fix mounting bolts
- ✓ To use with separate hinges (retrofit)
- ✓ Can be installed on round frames using the 3018-LION adaptor



9005

LION-9005



ZILV

LION-ZILV

3018LION

ADAPTOR PLATE FOR LION GATE CLOSER



- ✓ Aluminum adaptor plate for Lion on round profiles
- ✓ Black anodized
- ✓ For both 90° and 180° mounting situations
- ✓ Easily installed between strike and post

RECOMMENDED APPLICATIONS

- Ornamental steel
- Ornamental aluminum
- Galvanized/Steel chain link
- For wood and vinyl installations, please contact the manufacturer
- Concrete

INSTALLATION

- Retrofit installation using Locinox Quick-Fix mounting bolts with 2,000 lbs holding force
- No welding required!
- Reversible for left or right opening gates
- Adjustable closing speed and final snap
- Comes with 90° and 180° rail sets for on-site flexibility. The existing hinges will determine the setup needed
- Lion is a gate closer, not a hinge. Separate, exterior rated hinges are needed and recommended
- Easily installs on square or round posts using the Lion adaptor plate (p. 17)

RECOMMENDED FOR



INDUSTRIAL & COMMERCIAL



EDUCATION



MILITARY INSTALLATIONS



PLAYGROUNDS



AMUSEMENT PARKS



AIRPORTS & PORTS

VERTICLOSE-2

HEAVY-DUTY 90° OR 180° RETROFIT HYDRAULIC GATE CLOSER FOR GATES UP TO 330 LBS



- ✓ Powerful 180° gate closer for retrofit situations
- ✓ Powder coated aluminum housing
- ✓ 180° closing angle - NO gate stop needed
- ✓ Patented hydraulic damping
- ✓ Closing speed unaffected by humidity and temperature changes
- ✓ ADA compliant: low opening resistance: max. 15 Nm (3-5 lbs). For gates of 4ft or more
- ✓ Adjustable closing speed & final action
- ✓ Specifically designed for exterior use: rain & frost-proof
- ✓ Secure, fast and easy attachment: Quick-Fix mounting bolts
- ✓ To use with separate hinges (retrofit)



VERTICLOSE-2-9005

VERTICLOSE-2-ZILV

RECOMMENDED APPLICATIONS

- Ornamental steel
- Ornamental aluminum
- For wood and vinyl installations, please contact the manufacturer
- Concrete

INSTALLATION

- Retrofit installation using Locinox Quick-Fix mounting bolts with 2,000 lbs holding force
- No welding required!
- Reversible for left or right opening gates
- Adjustable closing speed and final snap
- Comes with 90° and 180° rail sets for on-site flexibility. The existing hinges will determine the setup needed.
- Verticlose-2 is a gate closer, not a hinge. Separate, exterior rated hinges are needed and recommended.

RECOMMENDED FOR

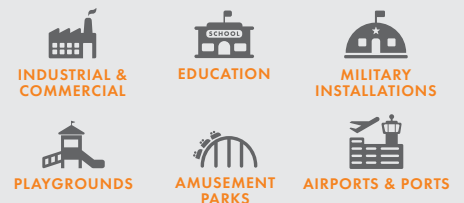

VERTICLOSE-2-WALL

90° OR 180° HYDRAULIC GATE CLOSER FOR WALL-MOUNTED GATES UP TO 330 LBS



- ✓ Powerful 180° gate closer for retrofit situations
- ✓ Powder coated aluminum housing
- ✓ 180° closing angle - NO gate stop needed
- ✓ Patented hydraulic damping
- ✓ Closing speed unaffected by humidity and temperature changes
- ✓ ADA compliant: low opening resistance: max. 15 Nm (3-5 lbs). For gates of 4ft or more
- ✓ Adjustable closing speed & final action
- ✓ Specifically designed for exterior use: rain & frost-proof
- ✓ Secure, fast and easy attachment: Quick-Fix mounting bolts
- ✓ Specially designed arm for wall mounting while guaranteeing a big opening angle

ZILV



VERTICLOSE-2-WALL-ZILV

RECOMMENDED APPLICATIONS

- Ornamental steel
- Ornamental aluminum
- For wood and vinyl installations, please contact the manufacturer
- Concrete

INSTALLATION

- Designed for installations in alleyways or narrow spaces
- Retrofit installation using Locinox Quick-Fix mounting bolts with 2,000 lbs holding force
- Installs with ease on square profiles to concrete or wood columns
- No welding required!
- Reversible for left or right opening gates
- Comes with 90° and 180° rail sets for on-site flexibility. The existing hinges will determine the setup needed.
- The Verticlose-2 Wall is a gate closer, not a hinge. Separate, exterior rated hinges are needed and recommended.

RECOMMENDED FOR



INTERIO

CONCEALED, BUILT-IN HYDRAULIC GATE CLOSER



- ✓ Built-in, self-closing hinge up to 125° with adjustable closing speed and final snap
- ✓ Weatherproof aluminum housing designed for exterior use
- ✓ Consistent closing speed thanks to our patented hydraulic damping
- ✓ Vandal and tamper proof
- ✓ ADA compliant (< 5 lbs; max 20 Nm) from gate widths of 3 ft or more
- ✓ Secure, fast and easy attachment using our Quick-Fix mounting bolts
- ✓ Optional sets available for ground and wall installation
- ✓ Required with gate stop



INTERIO-9005

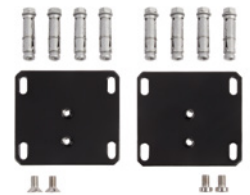

INTERIO-WALL-9005



INTERIO-GROUND-9005

RECOMMENDED APPLICATIONS

- Ornamental steel
- Ornamental aluminum

INSTALLATION

- New or retrofit installations using Locinox Quick-Fix mounting bolts, each with 2,000 lbs holding force
- Installs by inserting into square gate frames of 2" (with wall thickness of less than 0.125); or 2-1/4"; or 2-1/2" (with wall thickness of more than 0.125)
- Aligns with ease using DRILLVISE-II or DRILLVISE-IV install tools (p.25)
- No welding required
- Reversible for left or right opening gates
- Adjustable closing speed and final snap

RECOMMENDED FOR

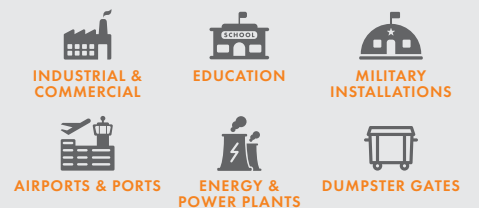

PANTHER

ALL-ROUND HYDRAULIC GATE CLOSER FOR WALL AND POST MOUNTING



- ✓ Gate closer for wall-mounting with adjustable closing speed and final action
- ✓ Consistent closing speed thanks to patented hydraulic damping
- ✓ Robust yet stylish design with high quality components
- ✓ Weatherproof, scratch resistant and corrosion free anodized aluminum housing
- ✓ Designed to be installed above the gate
- ✓ Integrated pretension for extremely smooth installation
- ✓ Closing force over the full 130° opening angle
- ✓ Quick-Fix and wall anchors included
- ✓ For left and right handed gates
- ✓ ADA compliant (< 5 lbs; max 19 Nm) from gate widths of 3ft. or more
- ✓ Recommended with gate stop



PANTHER-9005

RECOMMENDED APPLICATIONS

- Ornamental steel
- Ornamental aluminum
- For wood and vinyl installations, please contact the manufacturer
- Design for concrete column posts

INSTALLATION

- Designed for installations in alleyways or narrow spaces with concrete column posts
- Retrofit installation using Locinox Quick-Fix mounting bolts with 2,000 lbs holding force
- Installs with ease on square profiles to concrete or wood columns
- No welding required!
- Reversible for left or right opening gates
- The existing hinges will determine the setup needed.
- The Panther is a gate closer, not a hinge. Separate, exterior rated hinges are needed and recommended.

RECOMMENDED FOR



RHINO

AESTHETICAL 180° GATE CLOSER WITH DIRECT CONNECTION TO THE HINGE



- ✓ 180° self-closing double bearing hinge with adjustable closing speed and final snap
- ✓ Consistent closing speed thanks to patented hydraulic damping
- ✓ Compact design with high quality components
- ✓ Weatherproof, scratch resistant and corrosion free anodized aluminum housing
- ✓ Fits 180° hinges M16 & M20 (GBMU & GBMU4D)
- ✓ Bearing eyebolt is recommended (1034-ROLL-M16)
- ✓ Integrated pretension for extremely smooth installation
- ✓ For left and right handed gates
- ✓ ADA compliant (< 5 lbs; max 20 Nm) from gate widths of 3ft. or more



9005

RHINO-9005



Z1LV

RHINO-Z1LV

RECOMMENDED APPLICATIONS

- Ornamental steel
- Ornamental aluminum
- For wood and vinyl installations, please contact the manufacturer

INSTALLATION

- Designed for installations with Locinox hinges, GBMU, GBMU4D, BOLTONHD-4D (p.47)
- Retrofit installation using Locinox Quick-Fix mounting bolts with 2,000 lbs holding force
- Installs with ease on square profiles
- No welding required!
- Reversible for left or right opening gates
- The RHINO is a gate closer, not a hinge. Separate, Locinox hinges are needed.

RECOMMENDED FOR

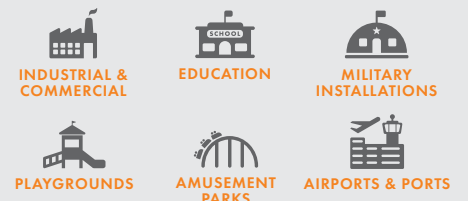

LION-VTC DRILL

ASSEMBLY AND DRILL CALIBER FOR LION AND VERTICLOSE-2 GATE CLOSERS

- ✓ Sturdy case with compartments
- ✓ Spare set with 10 Quick-Fix expanders
- ✓ Includes 2 drill bits Ø5 mm and Ø15 mm

INSTALL IN HALF THE TIME WITH EXTREME ACCURACY

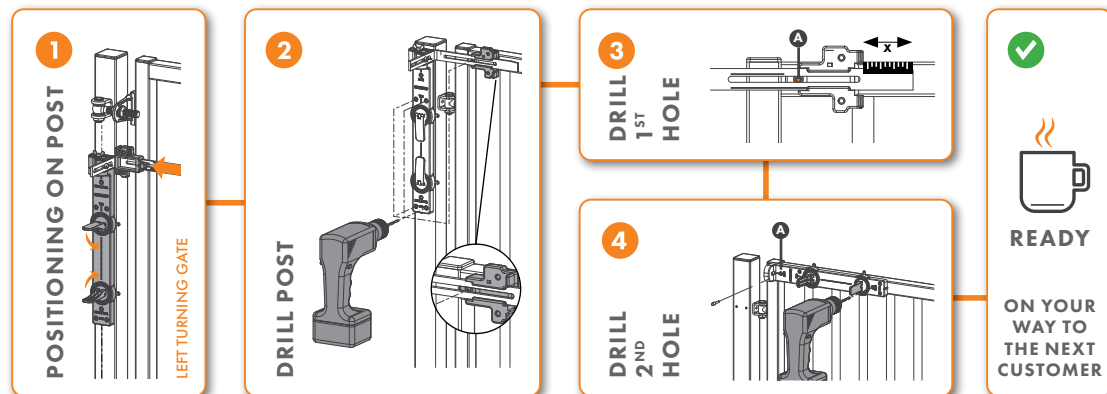

TIGERDRILL

INSTALLATION AND DRILLING JIG FOR TIGER GATE CLOSER

- ✓ Includes 2 drill bits Ø5 mm and Ø15 mm
- ✓ Spare set with 10 Quick-Fix expanders
- ✓ Solid plastic box with compartments for convenient storage
- ✓ Includes accessories for assembly and adjustment of Tiger
- ✓ Recommended to be combined with DRILLWISE-IV



INSTALL IN HALF THE TIME WITH EXTREME ACCURACY

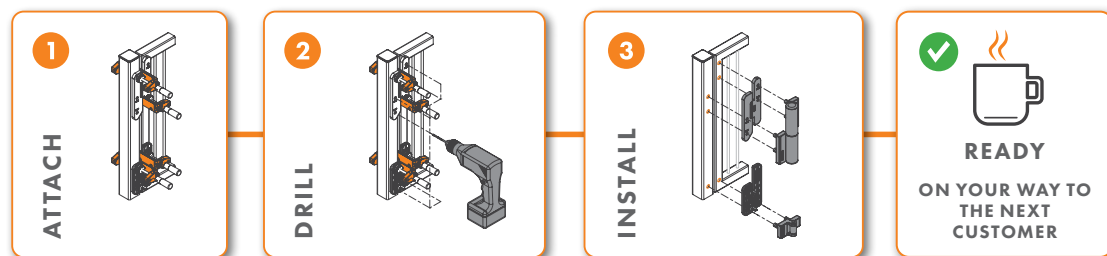

DRILLWISE-2

CLAMP SET FOR GATE FRAME POSITIONING

- ✓ Solid plastic box with compartments for convenient storage
- ✓ 2 special clamps with 1-3/16" to 4-3/4" adjustability with support plates to position gate frames
- ✓ Strong steel clamp with padding to avoid damage



DRILLWISE-4

TOOLBOX WITH 4 LOCINOX CLAMPS

- ✓ Solid plastic box with compartments for convenient storage
- ✓ 4 special clamps with 1-3/16" to 4-3/4" adjustability
- ✓ Strong steel clamp with padding to avoid damage
- ✓ Soft plastic mounting surfaces guarantee a perfect grip without risk of damage



FORTIMA (p. 29)



SAMSON-2 (p. 17)



LION (p. 18)



VERTICLOSE-2 (p. 19)



MAMMOTH-HD (p. 13)



RHINO (p. 23)



PANTHER (p. 22)



INTERIO (p. 21)





LUKY GATE LOCK (p. 35)

Locks

Locinox locks guarantee a perfect operating gate. Every lock is thoroughly tested in our test center where they are exposed to the most extreme circumstances. This ensures us that our locks will work in all weather conditions. We offer a variety of locks for garden gates, industrial gates or swimming pool gates. Locinox locks - the safest solution in fence protection.



35 SWING GATE LOCKS

36 MECHANICAL CODE LOCKS

37 PANIC EXIT SOLUTIONS



38 ACCESSORIES

39 SLIDING GATE LOCKS



FORTIMA

SLEEK AND STURDY CHILD SAFE MAGNETIC LATCH FOR POOLS AND PARKS



- ✓ Extreme weather resistance in any climate
- ✓ Patented durable design with anodized aluminum housing
- ✓ Tested to 2 million cycles
- ✓ Strongest magnetic force on the market (more than twice industry average) - attraction distance of 1-1/8"
- ✓ Rekeyable to match any lock
- ✓ Full horizontal and vertical adjustability
- ✓ Push down prevention: only opens when magnet is pulled up for additional security
- ✓ Sag-proof! 3/4" vertical tolerance after installation
- ✓ Compatible with square (K) and round frames (R); for metal, vinyl or wooden gates



RECOMMENDED APPLICATIONS

- Perfect for Pool or Park gates, residential and commercial
- Ornamental steel
- Ornamental aluminum
- Galvanized/Steel chain link
- Wood or Vinyl

INSTALLATION

- Quick & easy bolt-on installation (self drilling screws or Quick-Fix)
- No welding required!
- Reversible for either side of the gate
- Can be installed with a minimum gap of 3/8" up to 1-3/8"
- Easily adjusts up and down, full adjustability

RECOMMENDED FOR





POOLS



PARKS



DOG PARKS



PLAYGROUNDS

UNIQUE DESIGN

REKEYABLE

WEATHER RESISTANT

TESTED TO 2 MIL CYCLES

SAG-PROOF

PUSH DOWN PREVENTION

GUARANTEED STRENGTH

**Strongest magnet
on the market!**

Watch our tests on
LOCINOXUSA.COM



The Serval is the newest member of the Locinox family product line. For a spring hinge with 180° functionality, the Serval is the simple spring hinge option. The Serval can be paired with the FortiMa pool and park gate latch.

FORTiMA

Sleek and Sturdy Child Safe Magnetic Latch
for pools and parks



LOCINOX USA LLC

460 Windy Point Drive
Glendale Heights
IL 60139 - USA

☎ 877- LOCINOX ✉ salesusa@locinox.com

For additional product details, drawings, specs or reference pictures, visit www.locinoxusa.com

IT'S MORE THAN A LOCK. IT'S PEACE OF MIND.

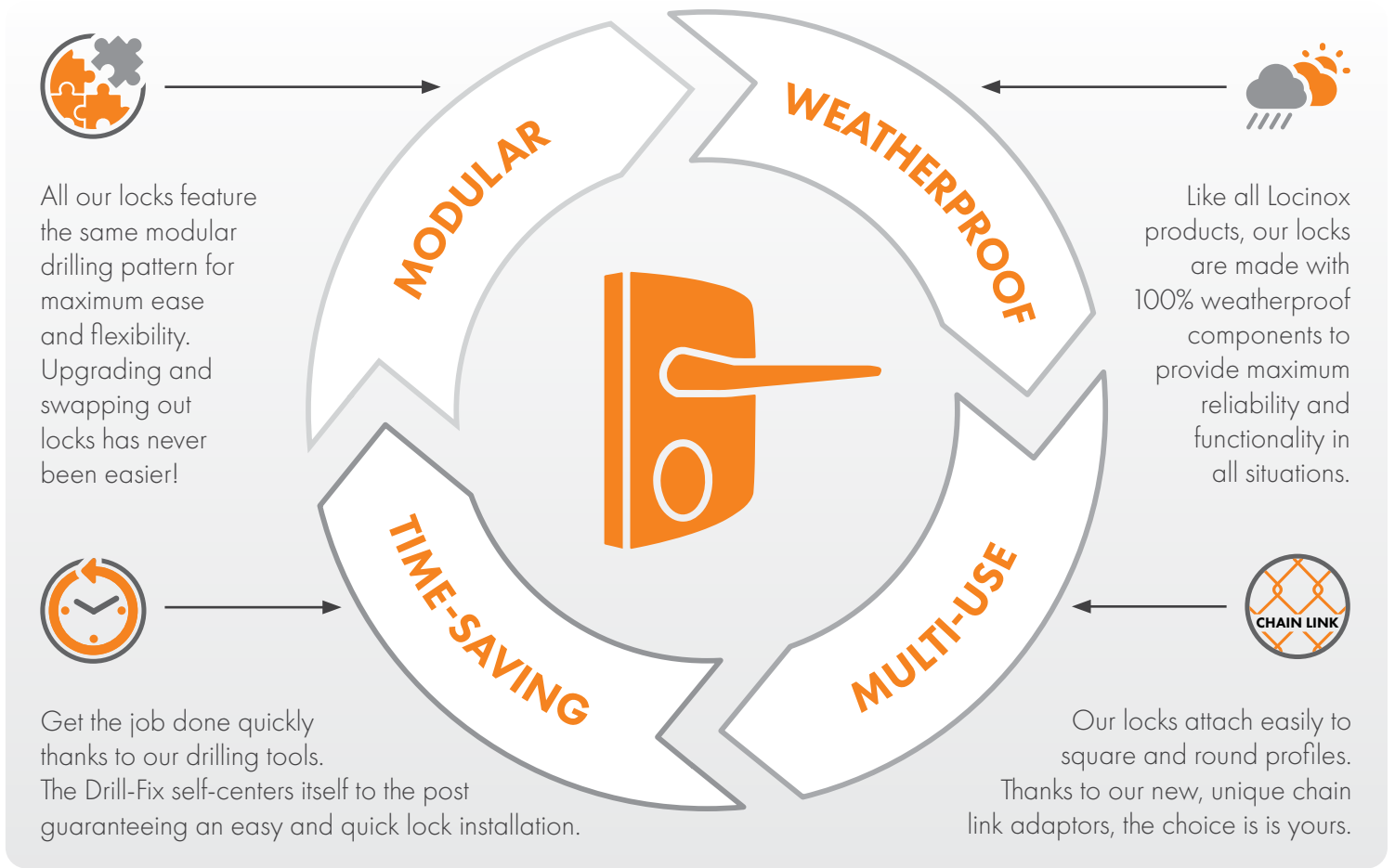

DRILL-FIX

TOOL CASE WITH CALIBER FOR SURFACE MOUNTED LOCKS AND CORRESPONDING KEEPS

- ✓ Tool case with self-centering drilling tool for fast assembly of Locinox surface mounted gate locks and keeps
- ✓ Drill jig can be used for round, square or rectangular profiles from 1-1/4" up to 3"
- ✓ Includes 3 drill bits (Ø3/8", Ø9/16", Ø11/16")
- ✓ Useful for installation of Locinox bolt-on locks and keeps in 4 easy steps
- ✓ Includes LA Locitool
- ✓ Includes Allen Key and positioning pin



1 INSTALLATION METHOD FOR ALL OUR LOCKS



12 REASONS WHY YOU SHOULD CHOOSE LOCINOX

1 30+ YEARS OF HIGH PRECISION ENGINEERING EXPERTISE

2 MAINTENANCE FREE
Fit & forget

3 5 YEARS PREMIUM WARRANTY

4 CORROSION RESISTANT
100% stainless steel internal mechanism. Lock box resistant to 1000+ hours of salt spray testing thanks to KTL coating

5 EASY INSTALLATION & 15/16" ADJUSTABILITY

6 DOUBLE LATCHING
Separate day and night bolt

7 WHEN LOCKED, RESISTING TO 2200+ LBS LATERAL FORCES

8 PATENTED QUICK-FIX BOLTS
Resisting to forces up to 2200 lbs

9 SECURE LOCKING
15/16" throw in one turn of the key

10 500K GUARANTEED TESTING

11 500+ CONFIGURATIONS AVAILABLE FROM STOCK
Shipment within 24h

12 STURDY HANDLES OUT OF ONE PIECE OF ANODIZED ALUMINIUM

LAKQ U2

SAKL QF



It gets even better. Endless upgrades possible!



KIDLOC
CHILDPROOF SECURITY KNOB



FREE VINCI
SURFACE MOUNTED MECHANICAL CODE LOCK WITH FREE EXIT



LPKQ U2
SURFACE MOUNTED ANTI-PANIC GATE LOCK WITH FREE EXIT PUSH PAD



LAKQ H2
SURFACE MOUNTED ORNAMENTAL GATE LOCK

Compatible with many keeps



SHKL QF
ADJUSTABLE SECURITY KEEP OUT OF STAINLESS STEEL



MODULEC-SA
SURFACE MOUNTED ELECTRIC STRIKE

LUKY J5

SURFACE MOUNTED US MORTISE CYLINDER GATE LOCK



- ✓ ISO 9227 KTL / E-coated lock box withstands 1000 hours of salt spray test
- ✓ Gate lock with double cylinder dead bolt. Designed for 1-1/8" (28.6mm) mortise profile cylinder
- ✓ Thread size: 1.150 x 32 UNS – Cylinder face: 1.360 (1-3/8") diameter
- ✓ Rekeyable cylinder 1-1/8" Schlage C-keyway 5pin (drilled 6pin) – AR Cam
- ✓ Throw of the deadbolt, 7/8" in 1 turn of the key
- ✓ Key-operated self-latching bolt, allows Free Exit application
- ✓ Adjustment of the bolts up to 3/8" continuous without dismantling the lock box
- ✓ 4-hole mounting with two hex head socket screws
- ✓ The lock box requires a 3-3/8" spacing to the first picket, fitting nicely into most gates



LUKY J5-9005



LUKY J5-ZILV

RECOMMENDED APPLICATIONS

- Ornamental steel
- Ornamental aluminum
- Galvanized/Steel chain link
- For wood and vinyl installations, please contact the manufacturer

INSTALLATION

- Quick & easy bolt-on installation
- No welding required!
- Reversible for either side of the gate
- Spacing needed to insert lock: 3-3/8"
- Easily adjusts up to 3/8" for the bolts without dismantling the lock box
- 4-hole mounting with two hex head socket screws
- Deadbolt adjustable by 7/8" in 1 turn of the key
- Easily installs on square or round posts using the lock adaptor plate (p. 34)

RECOMMENDED FOR



VINCI - LMKQ

SURFACE MOUNTED MECHANICAL CODE LOCK



- ✓ ISO 9227 KTL / E-coated lock box withstands 1000 hours of salt spray test
- ✓ Operational code panel on both sides
- ✓ Independent entrance and exit codes
- ✓ Polyamide rain and dust cover
- ✓ Easy and fast set-up or modification of the access codes
- ✓ With adjustable rollerbolt for easy closing
- ✓ Extremely strong and user-friendly mechanism
- ✓ Automatic code reset after opening by means of the handle



9005



ZILV

VINCI - LMKQ-9005

VINCI - LMKQ-ZILV

FREE VINCI - LFKQ

SURFACE MOUNTED MECHANICAL CODE LOCK WITH SECURED ENTRANCE AND FREE EXIT



- ✓ ISO 9227 KTL / E-coated lock box withstands 1000 hours of salt spray test
- ✓ Operational code panel on both sides
- ✓ Code in, free exit out
- ✓ Polyamide rain and dust cover
- ✓ Easy and fast set-up or modification of the access codes
- ✓ With adjustable rollerbolt for easy closing
- ✓ Extremely strong and user-friendly mechanism
- ✓ Automatic code reset after opening by means of the handle



9005



ZILV

FREE VINCI-LFKQ-9005

FREE VINCI-LFKQ-ZILV

PUSHBAR-L

PANIC RELEASE BAR FOR LOCKS



- ✓ Black powder coated aluminum push bar with stainless steel mechanism
- ✓ Fast and easy installation with Quick-Fix
- ✓ For left and right turning gates
- ✓ Blinded 5/16" follower included
- ✓ Possible to combine with half handle sets with 5/16" follower
- ✓ Maximum gate width: 5 ft. for 55-1/8" version



9005

PUSHBAR-L-1400

3006PUSH

FREE-EXIT PUSH PAD



- ✓ The set is adaptable on all surface mounted Locinox locks with aluminum U-lock box
- ✓ The 3006PUSH replaces the handles
- ✓ Facilitates the opening of the gate



ZILV

3006PUSH-ZILV

SAKL/SHKL/SF KEEP

ADJUSTABLE (SECURITY) KEEP OUT OF STAINLESS STEEL



- ✓ Stainless steel keep with polyamide finishing
- ✓ Stop plate in extruded aluminum with rubber strip
- ✓ Easy left or right hand changing
- ✓ Innovative Quick-Fix mounting
- ✓ Adjustable for profiles: 1-1/2" to 2-1/2"
- ✓ Min. gap 1 1/4" for SA/SH, 3/8" for SF

SHIELD

ANTI-THEFT PROTECTION PLATES



- ✓ Vandal-proof protection plate
- ✓ Compatible with Locinox surface mounted locks
- ✓ Serves as a pick plate - use for extra security
- ✓ Shield can easily be mounted on the surface mounted lock and is available for gate frames of 1-1/2" to 2-1/2"
- ✓ Can be combined with keeps and Modulec-strike

SHIELD-9005

9005

SHIELD-ZILV

ALUM

FAST & EASY INSTALLATION ON CHAIN LINK!

6403

ADAPTOR PLATE FOR SH KEEPS



3019LA

ADAPTOR PLATE FOR LA AND LS LOCKS



3018LA

ADAPTOR PLATE FOR SA KEEPS



3018MOD

CHAIN LINK ADAPTOR FOR MODULEC SA OR SH



CLH-LA

CHAIN LINK TENSION BAR FOR LOCKS



CLH-CO

CHAIN LINK TENSION BAR FOR CODE LOCKS



FORTYLOCK / SIXTYLOCK

MORTISE LOCK WITH 3/4" BACKSET FOR PROFILES OF 1-1/2" OR MORE

SELECT YOUR
INSERT LOCK
ON P. 61



- ✓ Lock mechanism with cover plate protects against dirt penetration
- ✓ Patented "Click-It" system makes thread tapping unnecessary
- ✓ Continuous adjustment of the daybolt up to 3/8" without dismantling the lock box
- ✓ Key-operated self-latching bolt, allows Free Exit application
- ✓ Stainless steel mechanism, hook, front plate and latch bolt
- ✓ Easy left or right changing of the self-latching daybolt
- ✓ Throw of the hook: 13/16"
- ✓ Center-distance cylinder \Leftrightarrow handles = 3-5/8"
- ✓ Optional: Cover shield for handle & cylinder holes in aluminum, polyamide or stainless steel
- ✓ Handles & cover plates to be ordered separately
- ✓ Compatible with all Europrofile cylinders



FORTYLOCK



SIXTYLOCK

ACCESSORIES FOR FORTYLOCK / SIXTYLOCK



INTRALEC-3006FIX

BUILT-IN ELECTRIC KEEP FOR FORTYLOCK, FIFTYLOCK AND SIXTYLOCK INSERT LOCKS

3006FIX

ALUMINUM ANODIZED HANDLE PAIR WITH FREE EXIT AND BLOCKING OPTION



SF-

STAINLESS STEEL KEEPER FOR NARROW GAPS



SFKO-

STAINLESS STEEL SURFACE MOUNTED KEEP FOR INSERT LOCKS

LSKZ

SURFACE MOUNTED SLIDING GATE LOCK



- ✓ ISO 9227 KTL / E-coated lock box withstands 1000 hours of salt spray test
- ✓ Chassis, mechanism and Twistfinger in stainless steel
- ✓ Adjustable for horizontal or vertical mounting of the keep (catch bolt)
- ✓ Mounting with 2 hex head socket screws
- ✓ Innovative closing system
- ✓ Stainless steel collar around the Twistfinger prevents cutting through the Twistfinger (catch bolt)
- ✓ Standard with reinforced aluminum handle pair
- ✓ 3006S: Square 5/16" shaft



9005



ZILV

LSKZ-9005

LSKZ-ZILV

LEONARDO - LLKZ

MECHANICAL CODE LOCK FOR SLIDING GATES



- ✓ 100% mechanical: no battery or electricity required
- ✓ Adjustable for horizontal or vertical mounting of the keep (catch bolt)
- ✓ Operational code panel on both sides
- ✓ Independent entrance and exit codes
- ✓ Equipped with dust and rain covers
- ✓ Easy and fast set-up or modification of the access codes
- ✓ Accepts 4 to 6 digit code combinations
- ✓ Extremely strong and user-friendly mechanism
- ✓ Automatic code reset after opening by means of the handle
- ✓ Anti-code detection with integrated security press plate



9005



ZILV

LLKZ-9005

LLKZ-ZILV

VALENTINO (p. 44)



SLIMSTONE-2 (p. 45)



MODULEC (p. 47)



B-MAG (p. 48)



VALENTINO BATTERY POWERED
ELECTRONIC CODE LOCK (p. 44)
AND **SAKL QF** (p. 38)



Automation & Electronics

Automation has become a fundamental factor in the fence & gate sector. Locinox offers a wide range of solutions to support user-friendly smart gates and fences.



45 KEYPADS



47 ELECTRIC STRIKES



48 ELECTROMAGNETIC LOCKS

50 ELECTRICAL DROP BOLTS

51 ELECTRICAL ACCESSORIES

VALENTINO

BATTERY POWERED ELECTRONIC CODE LOCK



- ✓ 150.000 open/close cycles on the same batteries
- ✓ Easy setup & modification of codes
- ✓ Vandal proof battery compartment
- ✓ Support for free-exit, pushbar & code controlled handles
- ✓ Extremely durable internal components
- ✓ Highly robust e-coated & powder coated lock box
- ✓ Bolt adjustability of 13/16"
- ✓ Roller bolt for smooth closing
- ✓ Possibility for different entry & exit codes
- ✓ Low battery warning sign
- ✓ Weather protected illuminated panel on both sides



9005

VALENTINO - 9005



ZILV

VALENTINO - ZILV

RECOMMENDED APPLICATIONS

- Ornamental steel
- Ornamental aluminum
- Concrete
- Galvanized steel
- For wood and vinyl installations, please contact the manufacturer

INSTALLATION

- Easy & fast bolt-on installation
- 20 mm (13/16") adjustability
- 6 AA batteries for use in Valentino
- Same hole pattern as Free Vinci code lock
- Usage of adaptor plate 3019LA to install on round profiles

RECOMMENDED FOR



SLIMSTONE-2

STURDY, FROST-FREE AND WEATHER RESISTANT
KEYPAD WITH 2 INTEGRATED RELAYS



- ✓ IP68 rated - Extremely resistant to water and dust
- ✓ Aluminum vandal-proof housing with scratch-resistant textured lacquer
- ✓ Energy efficient adjustable white led lights
- ✓ Highly resistant stainless steel push buttons tested for 1,000,000 pushes and more
- ✓ Easy programming of up to 100 user codes
- ✓ Smart heating element guarantees frost-free use
- ✓ Tested from -22°F to 185°F
- ✓ Adjustable time range between pulse and timer mode (100ms - 99s)
- ✓ Voltage: 10 up to 26 V AC/DC
- ✓ Current: 1.0 A (with heating) - Pmax= 13.5W (with max heating)
- ✓ 6-½ft connection cable included
- ✓ Comes with 2 integrated relays

9005



SLIMSTONE-2 - 9005

ZILV



SLIMSTONE-2 - ZILV

RECOMMENDED APPLICATIONS

- Ornamental steel
- Ornamental aluminum
- Concrete
- Galvanized steel
- For wood and vinyl installations, please contact the manufacturer

INSTALLATION

- Easy & fast bolt-on installation
- Plug & play with 2 integrated relays (Slimstone-2 will connect 2 devices and operate separately using 2 different codes)
- 6.5 ft. connection cable included
- Programs up to 100 codes

RECOMMENDED FOR



SLIMSTONE-X

STRONG, FROST-FREE AND WATERTIGHT KEYPAD



- ✓ IP68 rated - Extremely resistant to water and dust
- ✓ Aluminum vandal-proof housing with scratch-resistant textured lacquer
- ✓ Energy efficient adjustable white led lights
- ✓ Highly resistant stainless steel push buttons tested for 1,000,000 pushes and more
- ✓ Easy programming of up to 400 user codes
- ✓ Smart heating element guarantees frost-free use
- ✓ Tested from -22°F to 185°F
- ✓ Adjustable time range between pulse and timer mode (100ms - 99s)
- ✓ Working voltage keypad: 24V DC
- ✓ Current: 520 mA (with heating)
- ✓ 2 m connection cable included

9005



SLIMSTONE-X - 9005

ZILV



SLIMSTONE-X - ZILV

SWITCHSTONE-STD

2-CHANNEL RELAY MODULE



- ✓ Mounting on DIN-rail or directly
- ✓ Consumption: maximum 1.7 W
- ✓ Includes 2 250V AC/26V DC relays, each with COM, Fail Open and Fail Close contact
- ✓ Voltage: 24 V DC
- ✓ Current: maximum 0.07 A
- ✓ Long range secure 2-wire communication with the SlimStone-X, up to 300 m distance

RECOMMENDED APPLICATIONS

- Ornamental steel
- Ornamental aluminum
- Concrete
- Galvanized steel
- For wood and vinyl installations, please contact the manufacturer

INSTALLATION

- Easy & fast bolt-on installation
- Plug & play with 2 integrated relays (Slimstone-2 will connect 2 devices and operate separately using 2 different codes)
- 6.5 ft. connection cable included
- Programs up to 100 codes

RECOMMENDED FOR



MODULEC

SURFACE MOUNTED ELECTRIC STRIKE



- ✓ Tested up to 500,000 movements
- ✓ Fast and easy fixation with Quick-Fix
- ✓ 660 lbs holding force on the latch bolt
- ✓ Same drilling pattern as SA, SH and SM keeps
- ✓ Easy left or right hand changing
- ✓ Corrosion-resistant: black anodized housing
- ✓ Adjustable for profiles: 1-1/2" to 2-1/2"
- ✓ Voltage: 12V-24V AC/DC
- ✓ Consumption: 12V - 1.25A / 24V - 0.62A
- ✓ Power: 15W



9005



ZILV

MODULEC-SA-9005

MODULEC-SH-ZILV

3018MOD-SA/SH

ADAPTOR PLATE FOR MODULEC STRIKE



- ✓ Aluminum adaptor plate for Modulec on round profiles
- ✓ Black anodized
- ✓ Separate versions for SA and SH available
- ✓ Easily installed between strike and post

RECOMMENDED APPLICATIONS

- Ornamental steel
- Ornamental aluminum
- Galvanized steel
- For wood and vinyl installations, please contact the manufacturer

INSTALLATION

- Quick & easy bolt-on installation using Locinox Quick-Fix mounting bolts
- Uses the same drilling pattern as SA and SH keeps
- Reversible for either side of the gate

RECOMMENDED FOR



B-MAG

INTEGRATED MAGNET LOCK FOR SWING GATES



- ✓ Guaranteed holding force tested on every Maglock
- ✓ 500h salt spray resistant! SGS certified (ISO 9227)
- ✓ Special two-layer protective coating developed for outdoor use
- ✓ Anti-residual magnetism kick-off system
- ✓ Minimal pulling force: 2,500N
- ✓ Available in 600 lbs pull force resistance
- ✓ Current: 460mA/12V or 230mA/24V



B-MAG-9005

B-MAG-ZILV

S-MAG

ELECTROMAGNETIC LOCK FOR SLIDE GATES



- ✓ Guaranteed holding force tested on every Maglock
- ✓ 500h salt spray resistant! SGS certified (ISO 9227)
- ✓ Special two-layer protective coating developed for outdoor use
- ✓ Anti-residual magnetism kick-off system
- ✓ Available in 600 lbs pull force resistance
- ✓ Minimal pulling force: 2,500N
- ✓ Current: 460mA/12V or 230mA/24V



S-MAG-9005

S-MAG-ZILV

MAG

SURFACE MOUNTED ELECTROMAGNETIC LOCK WITH INTEGRATED PULL/PUSH HANDLES



- ✓ Guaranteed holding force tested on every Maglock
- ✓ 500h salt spray resistant! SGS Certified (ISO 9227)
- ✓ Perfect for pedestrian gates
- ✓ Special two-layer protective coating developed for outdoor use
- ✓ SGS Certified
- ✓ Powder coated aluminum housing
- ✓ Anti-residual magnetism kick-off system
- ✓ Raised edge on the magnet housing makes it impossible to put a crowbar between the magnet and the armature plate
- ✓ Fast and easy fixing by means of 5 holes with Quick-Fix
- ✓ Available in 660 and 1320 lbs pull force resistance

9005



MAG-9005

ZILV



MAG-ZILV

MAGMAG

SURFACE MOUNTED ELECTROMAGNETIC LOCK WITHOUT INTEGRATED HANDLES



- ✓ Guaranteed holding force tested on every Maglock
- ✓ 500h salt spray resistant! SGS Certified (ISO 9227)
- ✓ Perfect for driveway gates
- ✓ Special two-layer protective coating developed for outdoor use
- ✓ SGS Certified
- ✓ Powder coated aluminum housing
- ✓ Anti-residual magnetism kick-off system
- ✓ Raised edge on the magnet housing makes it impossible to put a crowbar between the magnet and the armature plate
- ✓ Fast and easy fixing by means of 5 holes with Quick-Fix
- ✓ Available in 660 and 1320 lbs pull force resistance

9005



MAGMAG-9005

ZILV



MAGMAG-ZILV

ELECTRADROP

MOTORIZED ELECTRICAL DROP BOLT



- ✓ Vandal-proof, powder coated aluminum housing
- ✓ To be connected to the warning light on automated gates (min 3 sec prewarning signal) or directly on the gate automation
- ✓ Automatic detection and memorization of the continuous or pulse signal
- ✓ Mechanical release possible (by key) in case of emergency
- ✓ Obstacle detection with automatic stop of the drop bolt in case of pressure exceeding 40 lbs



9005

ELECTRADROP-9005



ZILV

ELECTRADROP-ZILV

TRICONE

DESIGN LED-LIGHTING FOR GATES



- ✓ Fast and easy installation with Quick-Fix
- ✓ Aluminum housing with plastic (POM) cable guiding
- ✓ 3 white High-Flux LED Lights
- ✓ ± 140° beam angle
- ✓ Life expectancy: 50,000 hours
- ✓ 300 lux (illumination)
- ✓ Power: ± 1W (with 12V DC)
- ✓ 12V AC or DC (max. 18V DC or peak AC)
- ✓ Minimal power consumption and long lasting performance
- ✓ Resin encapsulated print circuit board for weather resistance
- ✓ Power up to 20 Tricones with 1 Locinox AC transformer or up to 15 with the DC power
- ✓ IP54



9005

TRICONE-9005



ZILV

TRICONE-ZILV

WALL-FIX

WALL FIXATION SET FOR KEEPS

- ✓ For a solid anchoring of keeps in walls
- ✓ Can be used for SAKL, SHKL, SMKL, SFKB, SFKP and all Modulec - keeps
- ✓ Consists out of 2 expansion anchors with matching bolts



PB-1

POWERBOX - TRANSFORMER HOUSING

- ✓ Waterproof transformer box - IP66
- ✓ Powder coated aluminum housing
- ✓ DIN-rail mount: 3-3/8" (5 units)
- ✓ Supplied with 2 gland nuts M20 and 2 stop plugs M16
- ✓ Designed with heat-dissipation fins at the back



PB-1-9005

9005

PB-1-ZILV

ZILV

DVK-HD

REINFORCED, BRAIDED STAINLESS STEEL GUIDING CABLE

- ✓ Vandal-proof, stainless steel, braided guiding cable
- ✓ Available with 17-3/4" or 25-9/16" braided cable
- ✓ Protects electrical wiring against vandalism, moist, dirt and vermin
- ✓ Strong fixation by means of 8 self-tapping stainless steel screws
- ✓ Cable entry: aluminum housing
- ✓ Inner diameter: $\varnothing 3/8"$



DC-POWER

SAFETY POWER SUPPLY 12V OR 24V DC

- ✓ Mounting on DIN-rail or directly
- ✓ Power: 25W
- ✓ Primary voltage: 110V
- ✓ Secondary voltage: available in 12V or 24V
- ✓ Aluminum housing
- ✓ Robust control module: encapsulated for superior humidity resistance



Hinges & Drop bolts

Hinges support the weight of the gate and ensure it opens and closes smoothly. Because of this heavy task, our hinges are hot-dip galvanized or made of stainless steel. Thanks to our wide range we offer a solution for every situation. Our patented 4D hinge is a top-of-the-line innovation. This hinge is adjustable in 4 dimensions (height/depth/alignment/left or right turning).

Note: The horizontal width of the gate divided by the vertical distance between the hinges installed should be equal or less than 2

Hinge Quick-Guide

Hinge	Page	Min gap gate frame to post	Max adjustability	Max gate weight in lbs*
BOLTONHD-4D	p 47	1/4"	2-3/8"	440
GBMU4D12	p 47	7/8"	1-5/8"	220
GBMU4D16	p 47	1-3/8"	2-3/8"	440
GBMU4D20	p 47	1-3/8"	4-7/8"	880
GBMU-X-M12	p 47	1/4"	1-3/4"	220
GBMU-X-M16	p 47	5/16"	2-3/8"	440
GBMU-X-M18	p 47	5/16"	2-1/8"	550
GBMU-X-M20	p 47	1/2"	3-1/8"	880
GBMU-X-M22	p 47	1/2"	3-1/2"	970
GAM-12-130	p 47	1-13/16"	3-5/16"	220
Puma	p 48	3/8"	5/8"	132
Dino	p 48	1/2"	3/4"	330
Bearing Hinge 40x40	p 48	1"	1-3/8"	440
Bearing Hinge 50x50	p 48	3/8"	1-3/8"	440
3DM	p 48	5/8"	5/8"	330
3DW	p 49	0"	5/8"	770

*All gate weights specified are intended for pedestrian gates. For wider (driveway) gates, please contact us at 877-LOCINOX

B-SAFE

STAINLESS STEEL
SAFETY CABLE FOR
GATES UP TO 1,100 LBS



- ✓ Stainless steel safety cable rated at 3,300 lbs.
- ✓ EN 12604 compliant
- ✓ Cable length of 11-13/16", thickness of 3/16" thick with protective transparent sleeve of 1/16"
- ✓ For gates up to 1,100 lbs
- ✓ Easy installation guaranteed
- ✓ Installed using Quick-Fix anchor bolts (rated at 2,000 lbs. each)

B-SAFE

9005

BOLTONHD-4D

180° BOLT-ON 4D ADJUSTABLE HINGE



- ✓ Easy to fix with Quick-Fix or bolt through fixing
- ✓ Vandal-proof eyebolt & crossbolt
- ✓ 180° opening
- ✓ Eliminates the need to stock left and right swinging gates
- ✓ 1/16" adjustable in height
- ✓ 1" adjustable in depth
- ✓ U-clamp and GRIP in aluminum
- ✓ Hot dip galvanized eyebolt and crossbolt

BOLTONHD-4D - 9005

9005

BOLTONHD-4D - ZILV

ALUM

GBMU4D

180° WELD-ON 4D ADJUSTABLE HINGE



- ✓ 180° opening and closing angle
- ✓ Grip: hot dip galvanized
- ✓ Eliminates the need to stock left and right swinging gates
- ✓ Only the grip is available in different RAL-colors
- ✓ Eyebolt M16: (5/8") hot dip galvanized
- ✓ 7/8" adjustability in height
- ✓ Version Z: U-shaped ear plate and groove plate zinc-plated

GBMU

180° 3-WAY ADJUSTABLE HINGE



- ✓ U-shaped ear plate and groove plate in black steel to weld on
- ✓ Eyebolt, bolt & nut, hot-dip galvanized
- ✓ Available in 5 sizes: M12, M16, M18, M20 and M22
- ✓ 180° opening and closing angle

GAM-12

90° 2-WAY ADJUSTABLE BEARING HINGE



- ✓ Length of the threaded axle: 5-1/8" or 5-15/16"
- ✓ Hinge axle M12 in stainless steel
- ✓ 90° opening and closing angle
- ✓ Welding ear in black steel

PUMA

COMPACT 2-WAY ADJUSTABLE 180° SURFACE MOUNTED HINGE



- ✓ Resistant to extreme weather conditions thanks to the stainless steel hinge axle
- ✓ 180° opening and closing angle
- ✓ For gates up to 3.5 ft wide and 135 lb
- ✓ For left and right opening gates
- ✓ Aesthetic design & powder coated aluminum housing
- ✓ 3/4" vertical adjustability
- ✓ Fast and easy installation with Quick-Fix
- ✓ 3/8" width-adjustable

PUMA-9005

9005

PUMA-ZILV

ZILV

DINO

180° DOUBLE BEARING HINGE



- ✓ Opening angle: 180°
- ✓ Contains 2 stainless steel bearings
- ✓ Vandal-proof
- ✓ Can be combined with the Mammoth
- ✓ For gates up to 330 lbs and 5 ft. wide
- ✓ For left and right handed gates
- ✓ Aesthetic design
- ✓ Powder coated aluminum housing
- ✓ Fast and easy fixation with Quick-Fix

DINO-9005

9005

DINO-ZILV

ZILV

CLB-DINO

CHAIN LINK BRACKET FOR DINO HINGE



- ✓ Aluminum anodized assembly brackets for Dino on chain link fences
- ✓ Includes brackets for two Dino hinges
- ✓ Diameter post: 48 to 102 mm
- ✓ Diameter gate profile: 35 to 48 mm
- ✓ Drilling jig included for easy installation
- ✓ All fixations included
- ✓ Gap from 29 to 54 mm

CLB-DINO-9005

9005

CLB-DINO-ZILV

ZILV

BEARING HINGE

90° 2-WAY ADJUSTABLE BEARING HINGE



- ✓ Specially developed for automated gates
- ✓ Maintenance free sealed bearing
- ✓ Rust resistant housing
- ✓ Can be used as top & bottom hinge

3DM

180° 3-WAY ORNAMENTAL HINGE

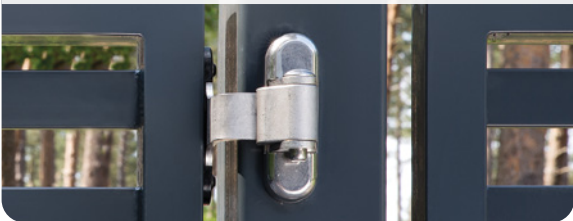

- ✓ 180° hinge for metal & aluminum gates with 4" posts
- ✓ 5/8" adjustable in width, 3/8" in height and 3/8" in depth
- ✓ Innovative Quick-Fix mounting
- ✓ Vandal-proof
- ✓ Reversible for left or right hand swing gates
- ✓ Hinge socket, axle and socket cover plate in stainless steel

3DW

180° 3-WAY STRAP HINGE



- ✓ 180° hinge for wooden gates
- ✓ Vandal-proof
- ✓ Reversible for left or right hand swing gates
- ✓ Hinge socket, axle and socket cover plate in stainless steel

KEYDROP

KEY LOCKABLE DROP BOLT



- ✓ Throw: 5-1/2"
- ✓ Height adjustability of the drop bolt: 4"
- ✓ Lockable drop bolt with cylinder
- ✓ Height adjustability in 3 positions: 2" per position
- ✓ Same drilling pattern as VSF and VSA
- ✓ The gate can be locked in open or closed position
- ✓ Possible to match same key as gate lock
- ✓ For square gate profiles 1-1/4" or larger

KEYDROP-9005

9005

KEYDROP-ZILV

ALUM

VSF/VSA

HOT-DIP GALVANIZED DROP BOLT



- ✓ Aluminum head block and housing
- ✓ For gate profiles 1-1/2" or more
- ✓ Height adjustability of the drop bolt: 4"
- ✓ Throw: 5-1/2"
- ✓ Fast and easy fixation with Quick-Fix
- ✓ Easy to retrofit

VSF/VSA-9005

9005

VSF/VSA-ZILV

ZILV

EGS

ECONOMIC GROUND CATCH FOR DROP BOLT



- ✓ Simple and economic In-ground catch designed to put in concrete
- ✓ Without stop plate
- ✓ Hot-dip galvanized base-plate with polypropylene catcher
- ✓ For drop bolts with a maximum bolt diameter of 3/4"

3020-HYB-ALU-9005

COVER SHIELD FOR INSERT LOCKS



- ✓ Cover shield for handle & cylinder holes
- ✓ Standardised gate pattern: compatible with HWLB for Hybrid locks
- ✓ Available in polyamide, aluminium and stainless steel

3006B/3006BH

BLACK ANODIZED ALUMINIUM HANDLE PAIR



- ✓ Square 8 mm follower



3006B-H

BLACK ANODIZED ALUMINIUM HANDLE PAIR WITH 120 MM LONG SPINDLE FOR INSERT LOCKS



- ✓ Square 8 mm follower



Turnstiles

The Locinox (electro)mechanical control unit allows you to easily create a maintenance free and high quality turnstile. You have an (electro)mechanical unit at your disposal with which you can match the design of your turnstile to the design of your fencing!



(ELECTRO)MECHANIC CONTROL UNIT FOR TURNSTILES

THE COMPLETE TURNITEC SOLUTION

- 1 TT-BM3S 120° / TT-SM4S 90°**
The essential module for any turnstile
- 2 TT-DM3 120° / TT-SDM4 90°**
Recommended hydraulic damping mechanism for extra user comfort
- 3 TT-FO2/TT-FC2**
Fail Open or Fail Close electromechanical module for access control
- 4 TT-CL2**
Counter and passing light signal module for visitor flow management
- 5 TT-BSP**
Welding plate for fast and perfect installation of Turnitec on any turnstile
- 6 TT-SAH**
Recommended for perfect connection of the basic module with the spline axle
- 7 TT-PIVOT**
Lower bearing for a smooth operation

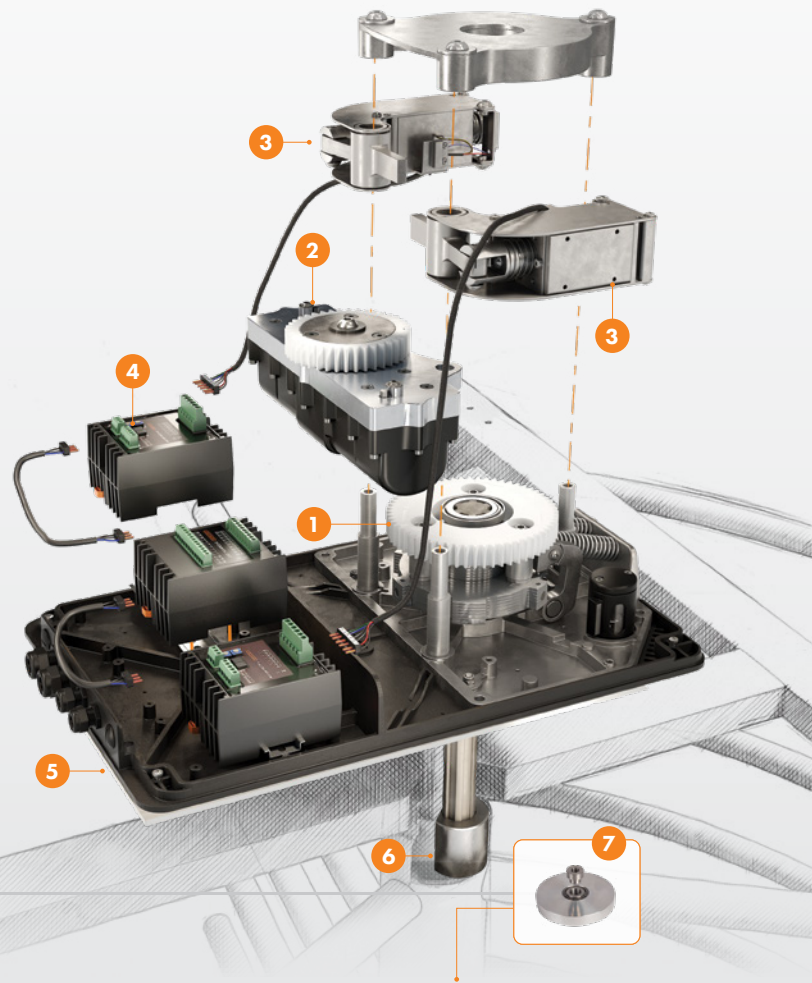

POPULAR APPLICATIONS



PARKING SITES

ELECTROMECHANICAL
ACCESS CONTROL
FOR EXTRA SECURITY



AIRPORTS



PUBLIC AREAS

MECHANICAL
FREE ENTRY AND EXIT
OR LOCKED

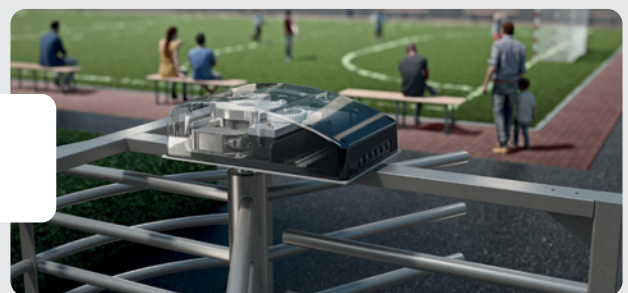

SCHOOLS

HOW TO CHOOSE YOUR INSERT LOCK?

SELECT LOCK



A: Gate frame size
B: Backset

FORTYLOCK 1

Square Frames of 2" and up 3/4" backset

SIXTYLOCK 2

Square Frames of 2-1/2" and up 1-9/16" backset

H-METAL 3

Square Frames of 2-1/2" and up 1-3/8" backset

H-METAL-WB 4

Comes with a weldable lock box (housing)

H-WOOD 5

Solid Wood Frames of 3-1/2" and up 2-3/8" backset

SELECT COVER PLATES



A2
Stainless Steel Silver



ALU
Aluminum Silver



ALU
Aluminum Black



STD
Polymer Black



SELECT CYLINDER SIZE

3012-54-STD- 2-1/8" length

3012-60-STD- 2-3/8" length

3012-80-STD- 3-1/8" length

SELECT HANDLES



3006FIX

Free exit and blocking option. Comes with cover plates. Silver

Only for 1 2



3006I-H

Stainless steel Silver



3006M-H

Aluminum Silver



3006J-H

Aluminum Silver



3006B-H

Aluminum Black



PUSHBAR-H

Free exit panic bar

Not for 1

SELECT KEEPER



SFKO

Surface-mounted stainless steel keep for insert locks
min 1-9/16" gap to 2-3/8"



SF

Built-in stainless steel keeper
min. 3/8" gap to 5/8" gap



SHKM

Built-in stainless steel keeper
min 7/8" gap



INTRALEC

Built-in electric strike for insert locks

min 1/4" gap

Only for 1 2



SHKW

Built-in stainless steel keeper for wooden gates

min 7/8" gap

Not for 5

✓ PROJECT DONE!



#WEARELOCINOX



FORWARD

Innovation as the engine of your growth



MODULARITY

Designed with flexibility at every moment



ADDED VALUE

High quality to ensure your peace of mind



24/7 WEBSHOP

Order when it suits you



FULL SERVICE

Exceptional after-sales service



3 YEAR WARRANTY

Sustainable solutions in the very long term



TRANSPARENCY

Clear and concise communication



RELIABLE

Our promises and deadlines are always met



LOYAL

Long-term relationships and a win-win situation for everyone

LOCINOX USA LLC

460 Windy Point Drive
Glendale Heights
IL 60139 - USA

 877- LOCINOX

 salesusa@locinox.com

v2022

For additional product details, drawings, specs or reference pictures, visit:  www.locinoxusa.com