



instant post holes

OZCO BUILDING PRODUCTS

Product & Packaging Specs

34" 2x2 Post Base (I2-850)

Item #: 30300

ITEM NO.	QTY.	PART NUMBER	DESCRIPTION
1	1	30300-11	Assembly, Base Anchor
2	1	30300-14	Base, Post Anchor Steel

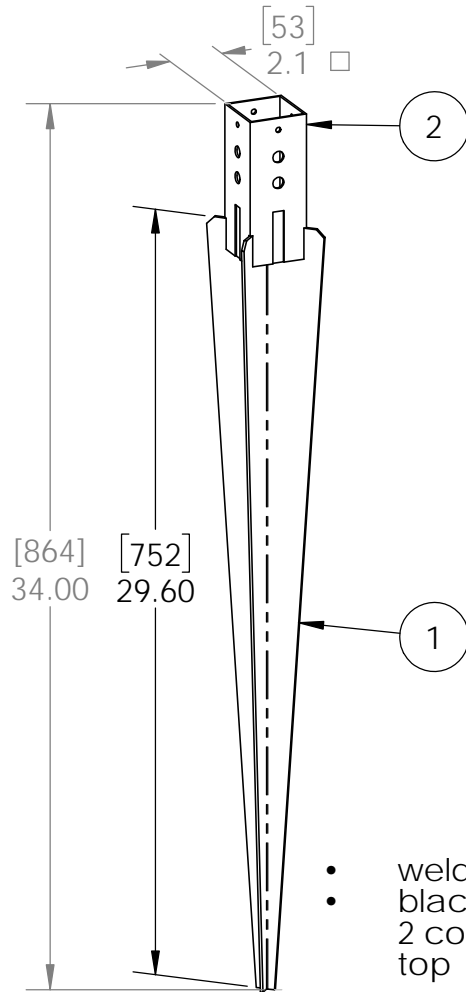
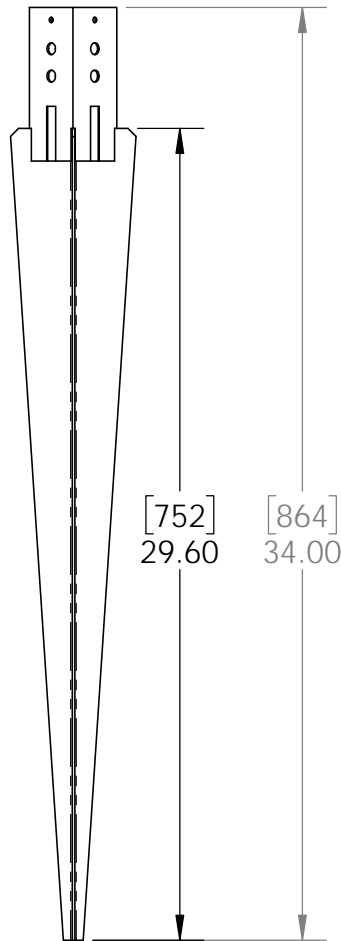
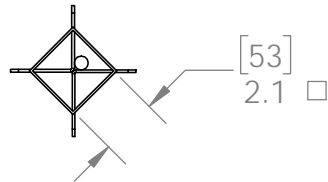

- weld together
- black paint item 2 completely & top 2" of item 1

Weight: 5.62 LBS
 Scale: 1:7
 Last updated: 10/14/2016

30300-10



Product & Packaging Specs

34" 2x2 Post Base (I2-850)

Item #: 30300

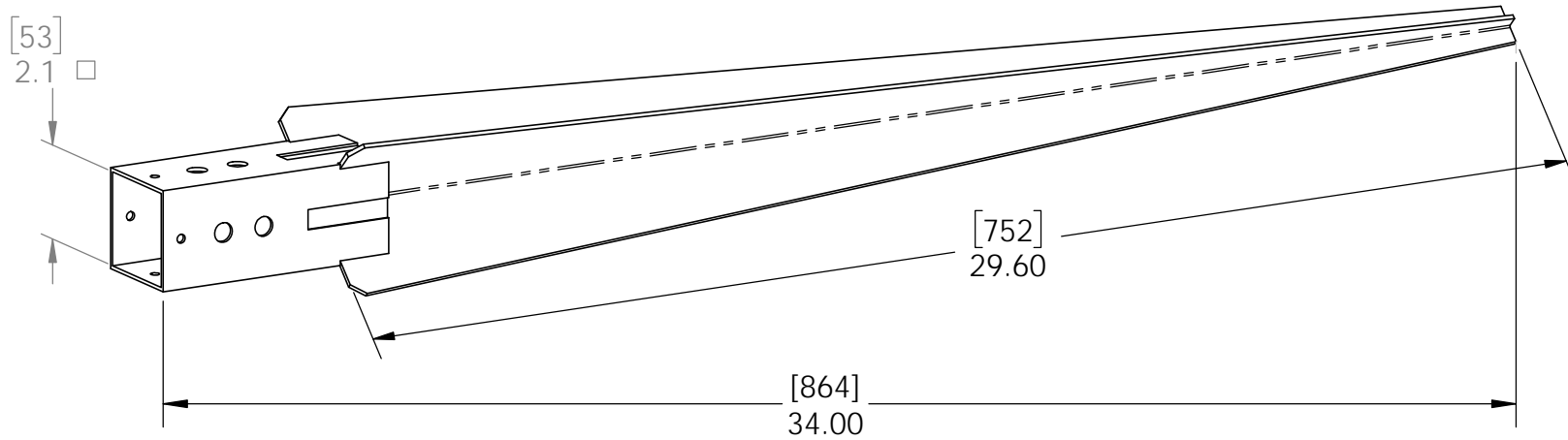

Weight: 5.62 LBS
Scale: 1:4
Last updated: 10/14/2016

30300-10

OZ-POST

instant post holes

OZCO BUILDING PRODUCTS

Product & Packaging Specs

34" 2x2 Post Base (I2-850)

Item #: 30300

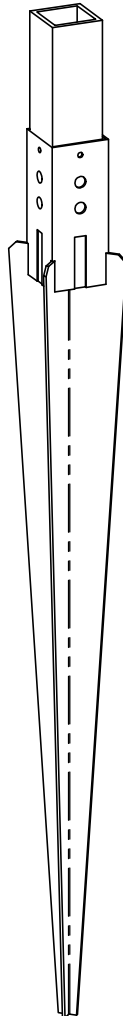
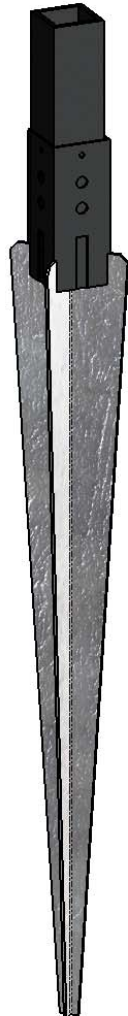
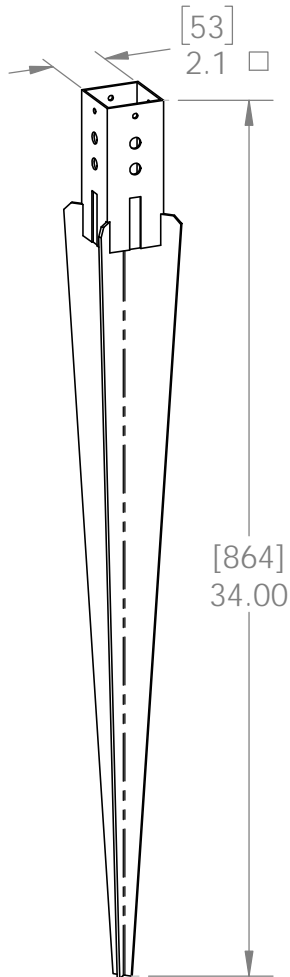

Weight: 5.62 LBS
Scale: 1:7
Last updated: 10/14/2016

30300-10

V2.00 - Installation Instructions, Specifications and Project Plans are effective 10/14/2016 . This information is updated periodically and should not be relied upon after 2 years from 10/14/2016 . Please visit OZCOBP.com to get current information. 3



instant post holes

OZCO BUILDING PRODUCTS ■■■

Product & Packaging Specs

34" 2x2 Post Base (I2-850)

Item #: Typical Installation

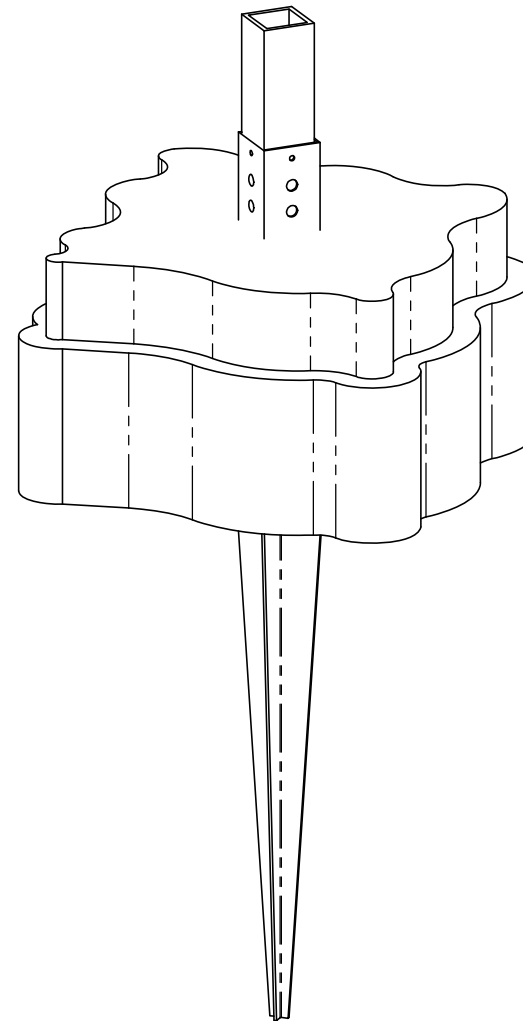
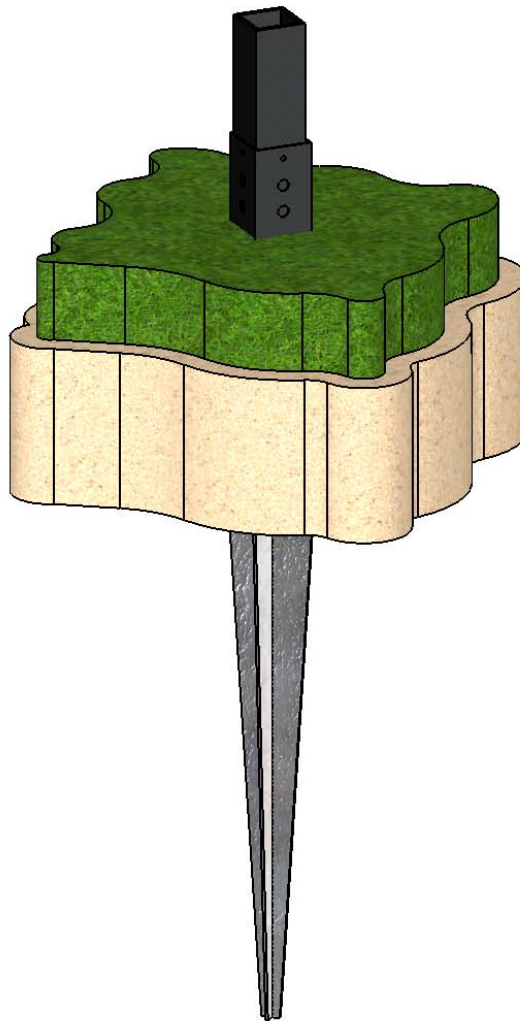

Weight: 5.62 LBS
Scale: 1:6
Last updated: 10/14/2016

30300-10

V2.00 - Installation Instructions, Specifications and Project Plans are effective 10/14/2016 . This information is updated periodically 4 and should not be relied upon after 2 years from 10/14/2016 . Please visit OZCOBP.com to get current information.



Product & Packaging Specs

30300 Packing

Item #: Unit packing

ITEM NO.	QTY.	PART NUMBER	DESCRIPTION
1	1	Bag, 1x2 packing	Bag, 1x2 Packing
2	4	Default	Screw, Hex Washer Head, 8-18 x 1 self drilling
3	1	30300-10	34" 2x2 Post Base (I2-850)

place bag of screws inside cavity and tape in place



Weight: 5.64 LBS
 Scale: 1:6
 Last updated: 10/14/2016

30300-10



Product & Packaging Specs

Case, 30300
Item #: Case, 30300

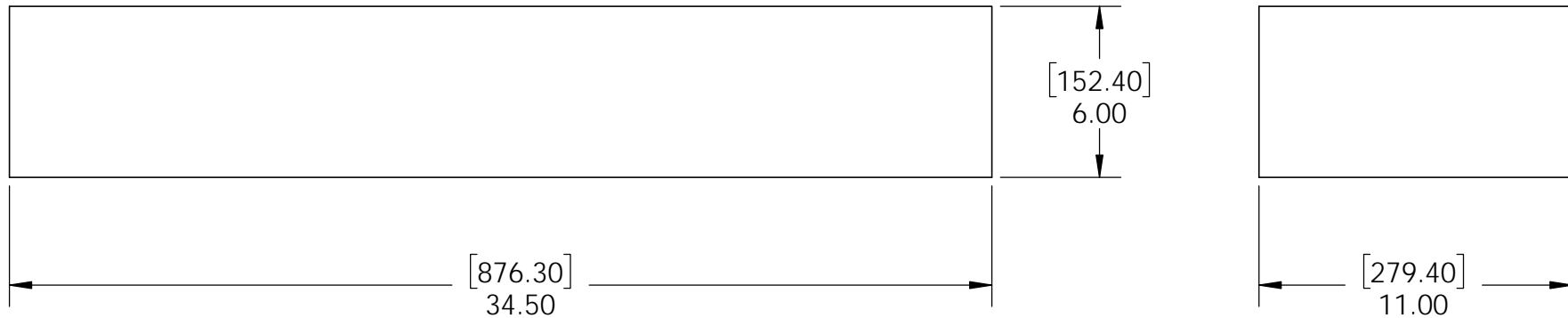
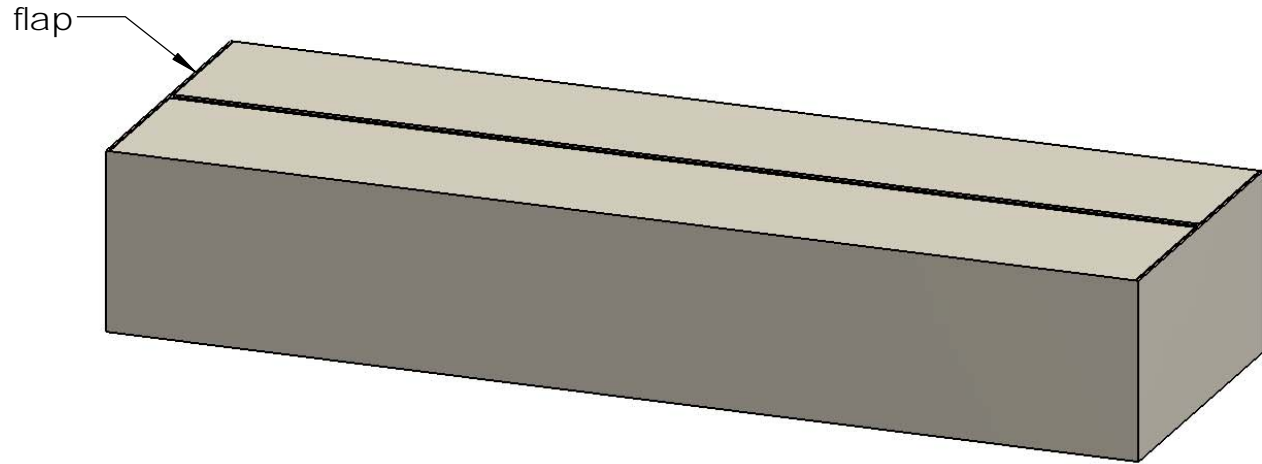

Material: Corrugated Paper
Finish: See Artwork
Weight: 0.41 LBS
Scale: 1:6
Last updated: 10/14/2016

30300-10



Product & Packaging Specs

30300 Packing
Item #: Box packing

box shown
without flaps
for clarity

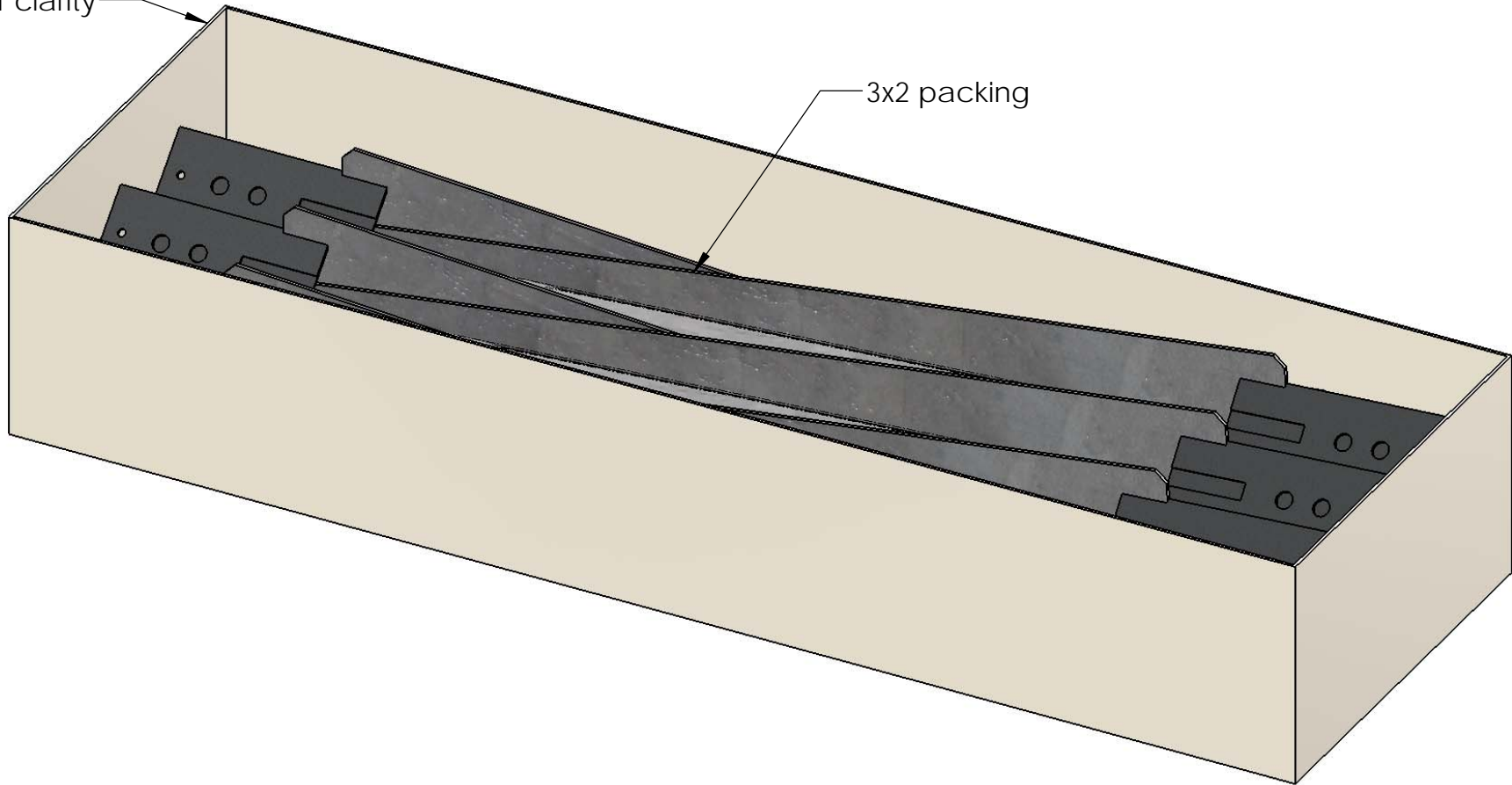

Weight: 34.11 LBS
Scale: 1:4
Last updated: 10/14/2016

30300-10

V2.00 - Installation Instructions, Specifications and Project Plans are effective 10/14/2016 . This information is updated periodically and should not be relied upon after 2 years from 10/14/2016 . Please visit OZCOBP.com to get current information. 14



Product & Packaging Specs

30300 Packing
Item #: Pallet packing

Item #: **30300** | **I2-850**
I2-850 (2" Square) Ornamental
PALLET 120 pcs
 SKU#: **30302** 
 Weight: **851** lbs
 LOT# _____ Priority# _____ 

Total number of cases: 20
 Total number of pieces:
 20x6=120 pieces on pallet

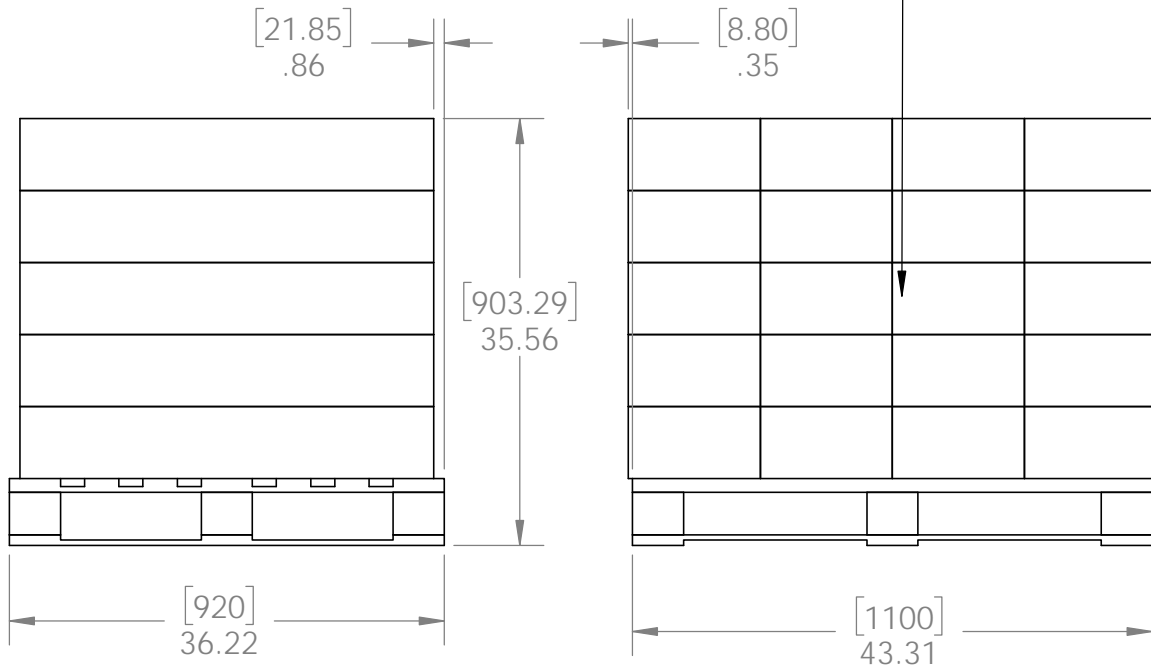
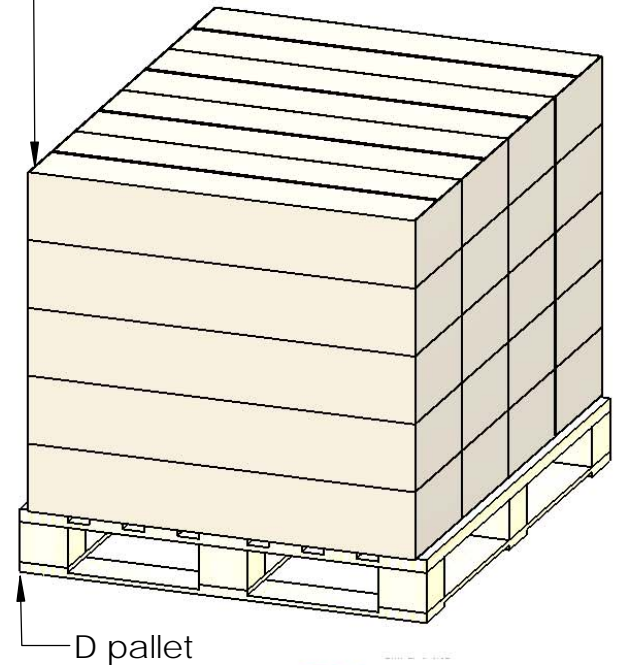

additional pallet packing instructions

- plywood on top layer
- strap to pallet
- clear wrap around boxes

Weight: 851 LBS
 Scale: 1:16
 Last updated: 10/14/2016

30300-10