

Product & Packaging Specs

Flush Outside 90°

Item #: 56614

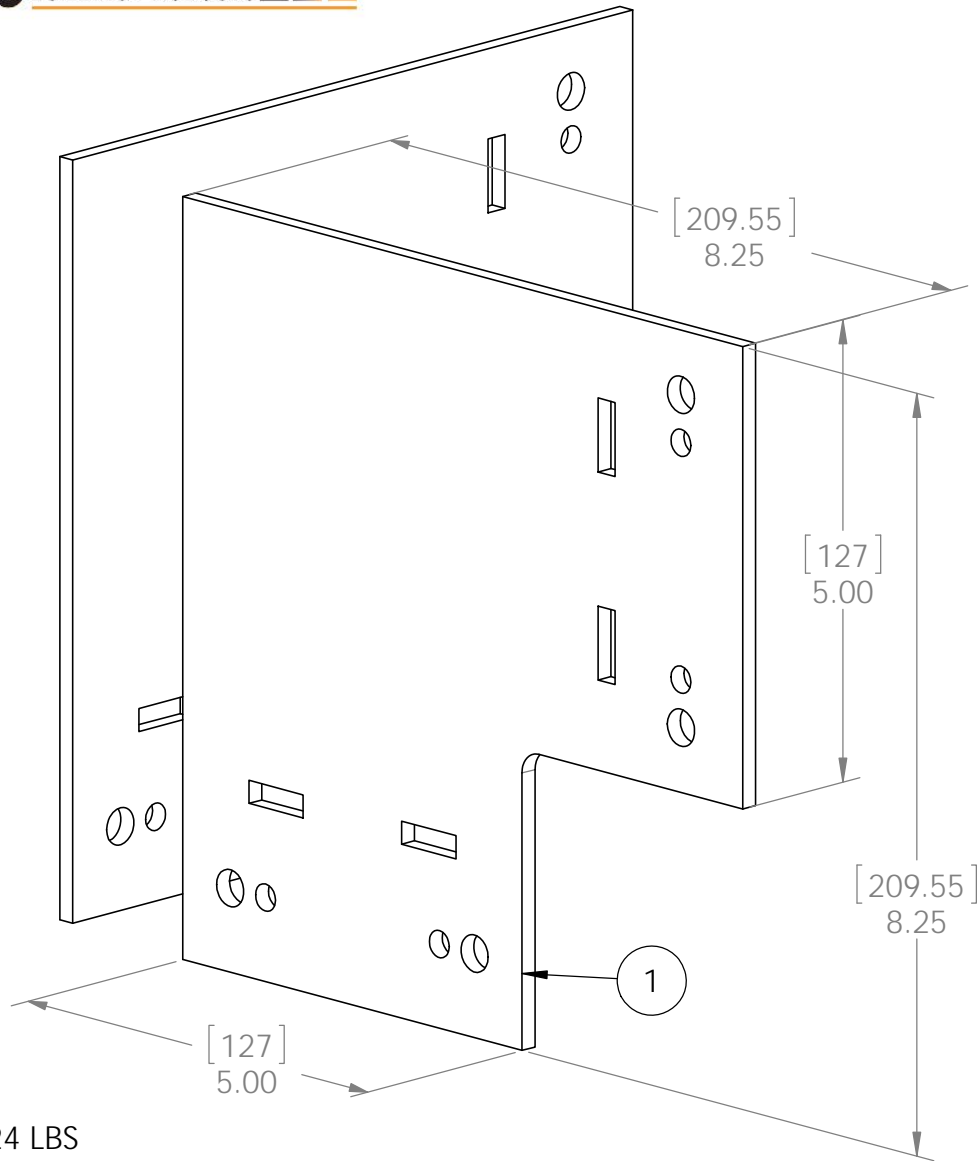

ITEM NO.	QTY.	PART NUMBER	DESCRIPTION
1	2	56614-11	Flush Outside 90°

Weight: 6.24 LBS
Scale: 1:2
Last updated: 7/13/2015

Product & Packaging Specs

Flush Outside 90°

Item #: Typical Installation & Basic Assembly

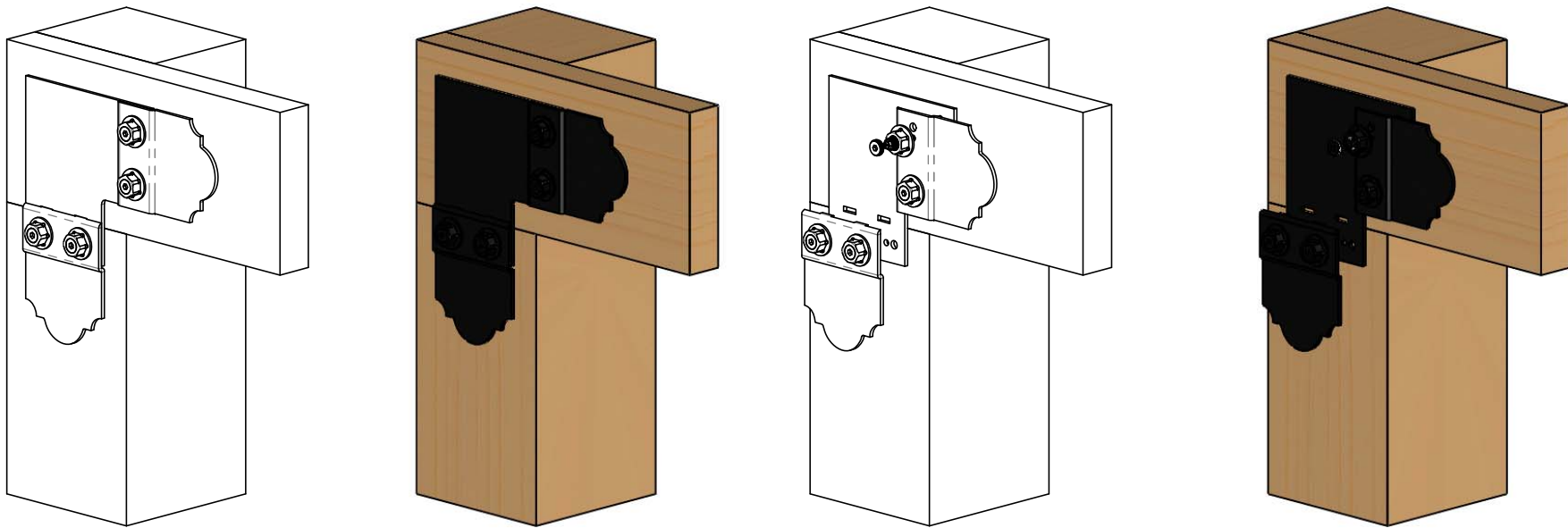

Weight: 6.24 LBS
Scale: 1:8
Last updated: 7/13/2015

56614-10

Product & Packaging Specs

Flush Outside 90°
Item #: 56614ASM with 56625

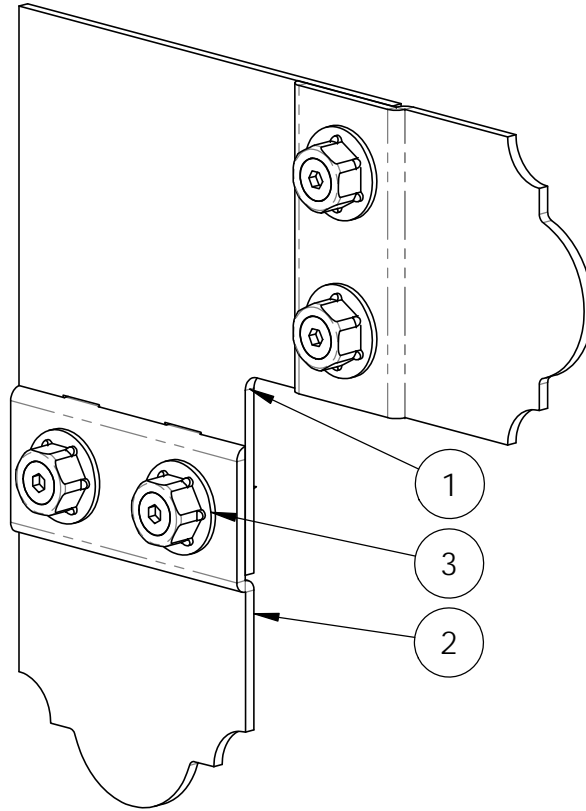

ITEM NO.	QTY.	PART NUMBER	DESCRIPTION
1	1	56614-11	Flush Outside 90°
2	4	56625	OWT Timber Screw 1-3/4"
3	2	56611	Truss Accent Assembly

Weight: 6.24 LBS
Scale: 1:3
Last updated: 7/13/2015

56614-10

not sold as shown; for use in Projects only

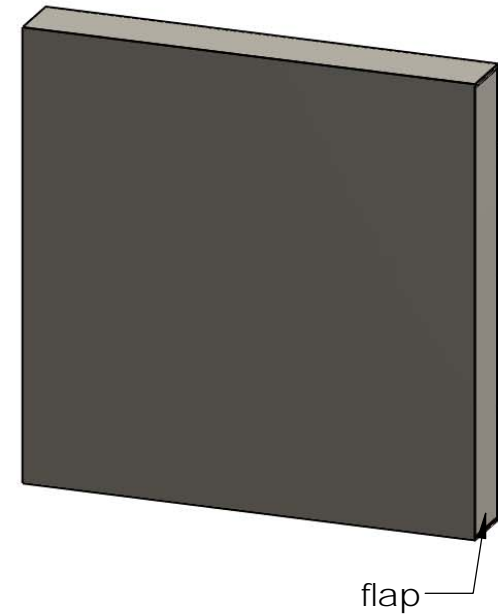
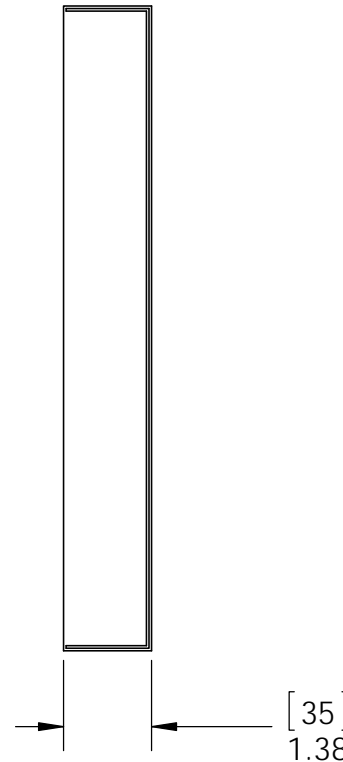
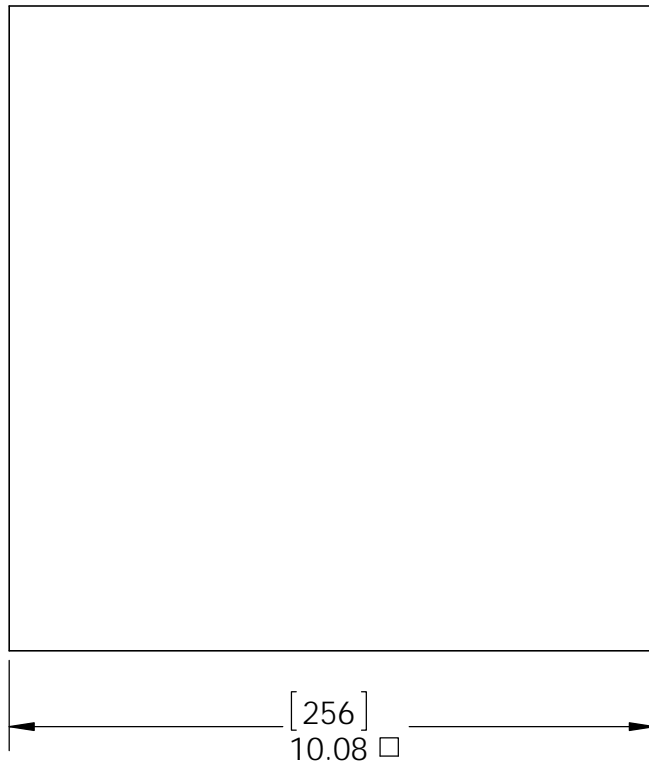

Material: Corrugated Paper
Finish: See Artwork
Weight: 0.06 LBS
Scale: 1:3
Last updated: 7/13/2015

56614-10

Product & Packaging Specs

56614 Packing
 Item #: Box packing

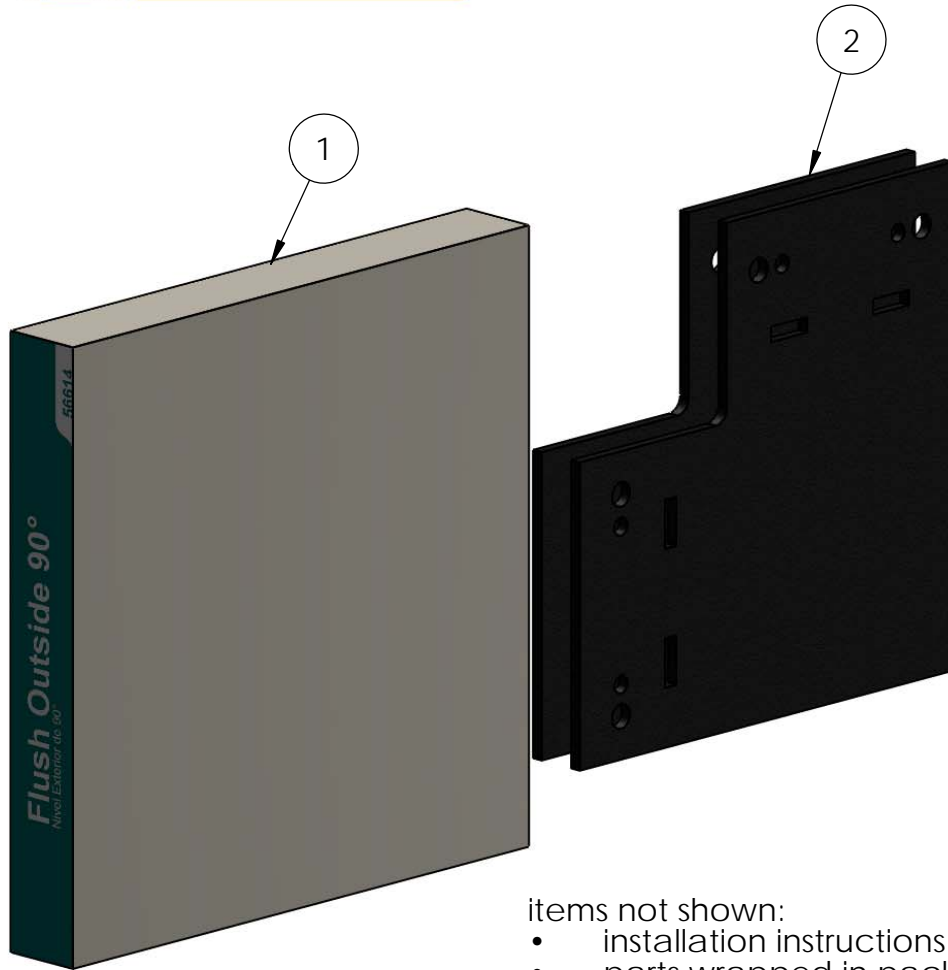

ITEM NO.	QTY.	PART NUMBER	DESCRIPTION
1	1	56614 Box	Box, Flush Outside 90°
2	2	56614-11	Flush Outside 90°

items not shown:

- installation instructions
- parts wrapped in packing foam sheet

Weight: 6.09 LBS
 Scale: 1:3
 Last updated: 7/13/2015

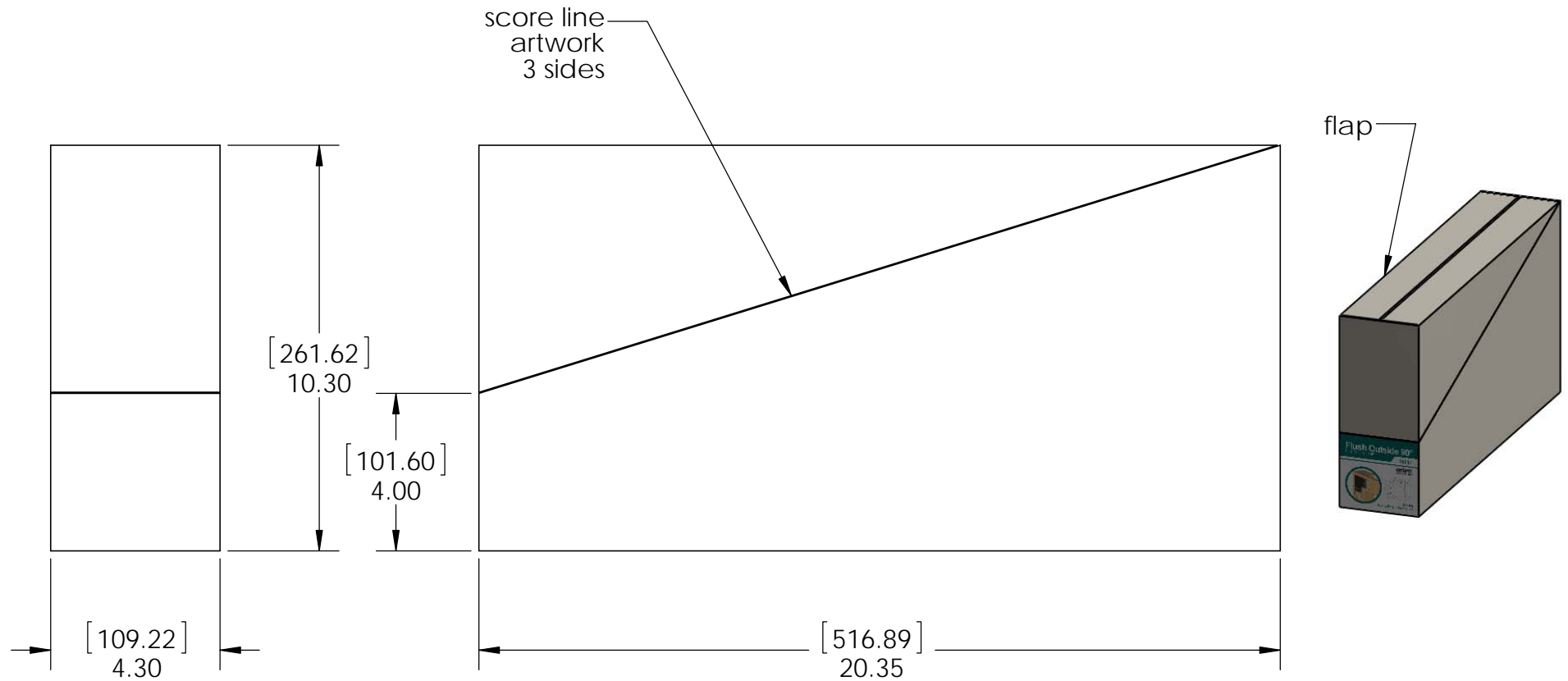

Material: Corrugated Paper
 Finish: See artwork
 Weight: 0.26 LBS
 Scale: 1:4
 Last updated: 7/13/2015

Product & Packaging Specs

56614 Packing

Item #: Case packing

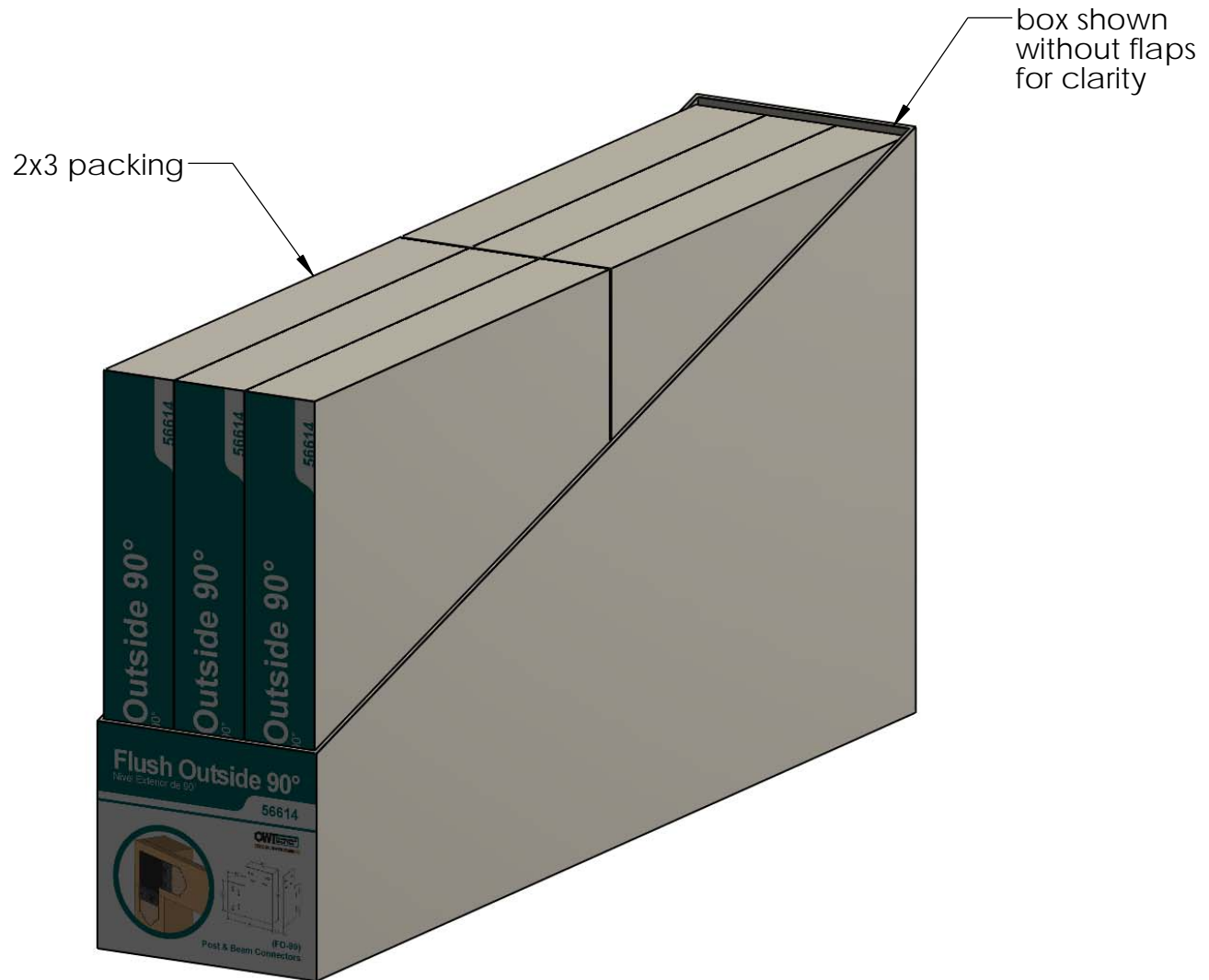

Weight: TBD LBS
Scale: 1:3
Last updated: 7/13/2015

56614-10

Product & Packaging Specs

56614 Packing

Item #: Pallet packing

Item #: **56614** | **F090**
 Flush Outside 90°
PALLET **144 pcs**
 sku#: **56814**
 Weight: **938** lbs
 LOT# Priority# 

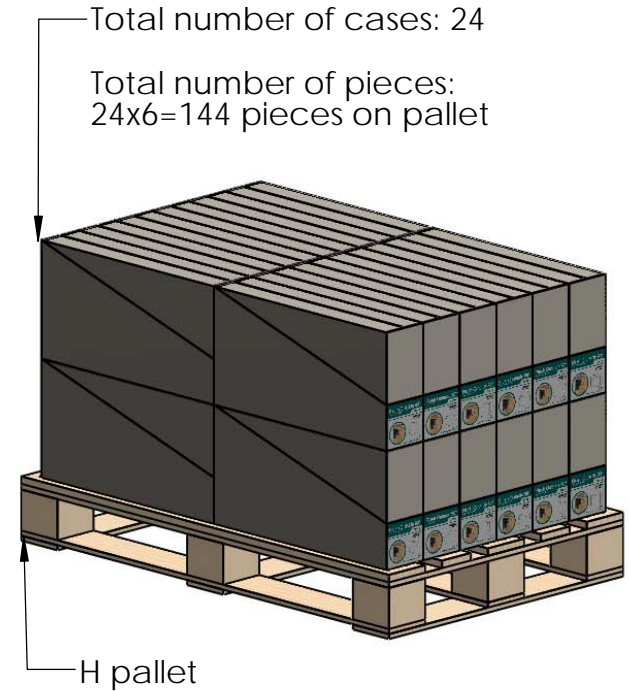
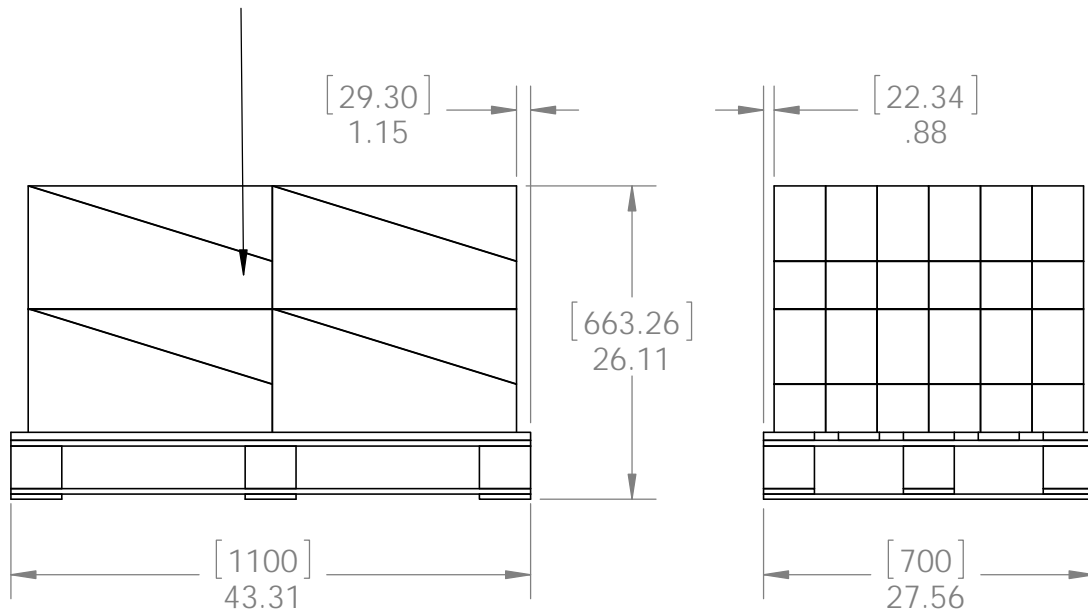

additional pallet packing instructions

- plywood on top layer
- strap to pallet
- clear wrap around boxes

Weight: 938 LBS
 Scale: 1:16
 Last updated: 7/13/2015