

Product & Packaging Specs

Post to Beam Bolt Inline

Item #: 56637

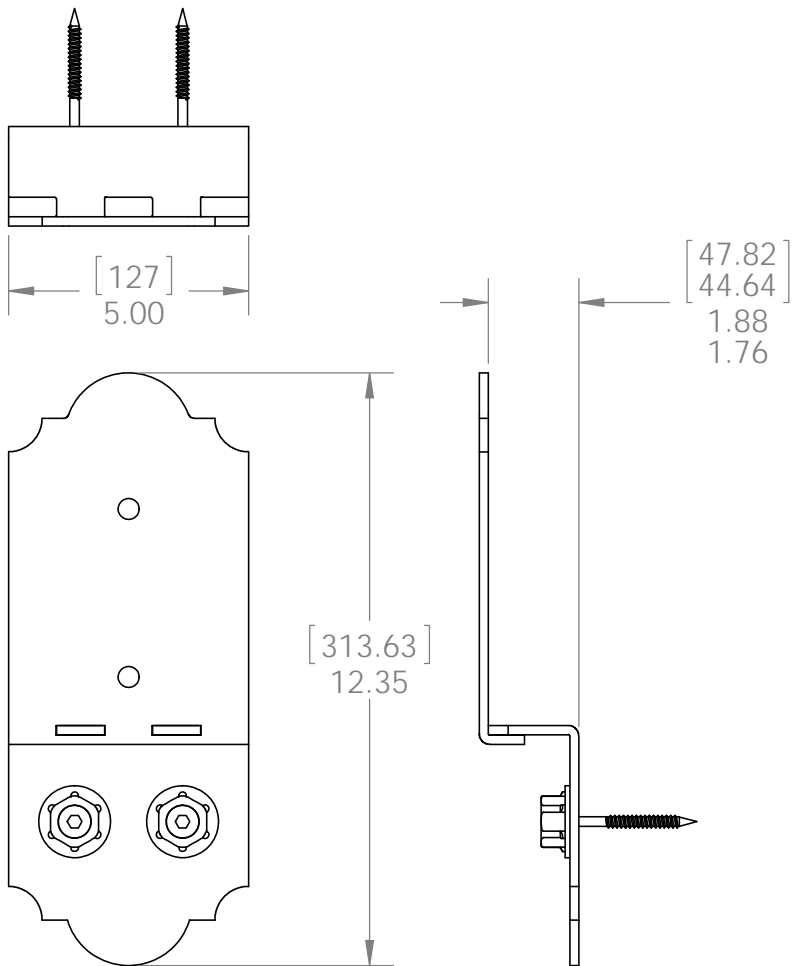

ITEM NO.	QTY.	PART NUMBER	DESCRIPTION
1	1	56610-11	Ledge, Post to Beam
2	1	56637-11	Plate, Bolt Inline
3	2	56621	1 1/2" Hex Cap Nut
4	0.08	56626	OWT Timber Screw 2-3/4"

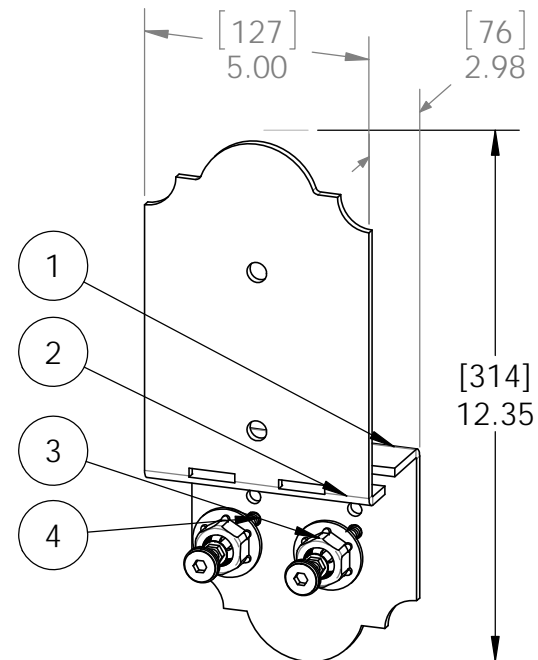

kit contains 2 assemblies

Weight: 3.64 LBS
 Scale: 1:4
 Last updated: 7/13/2015

56637-10

Product & Packaging Specs

Post to Beam Bolt Inline

Item #: Typical Installation & Basic Assembly

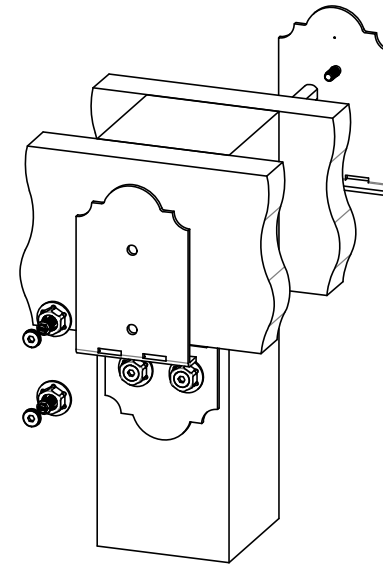
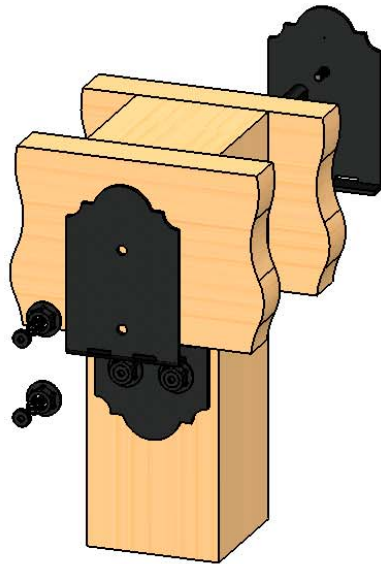
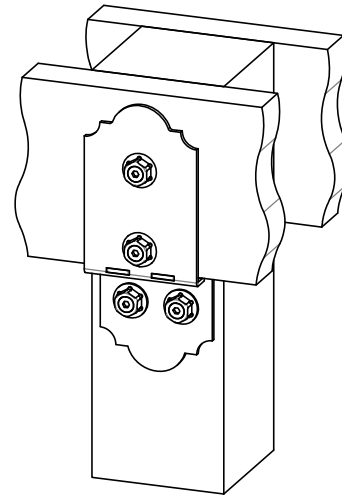
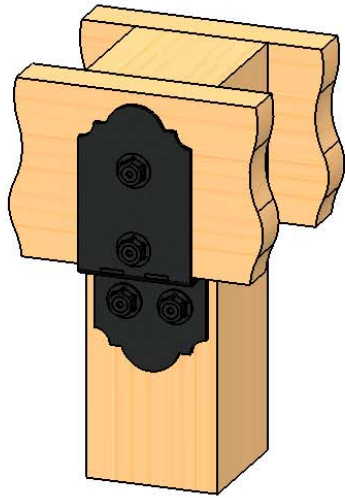

Scale: 1:8
Last updated: 7/13/2015

56637-10

Product & Packaging Specs

Box, Post to Beam

Item #: 56637 Box

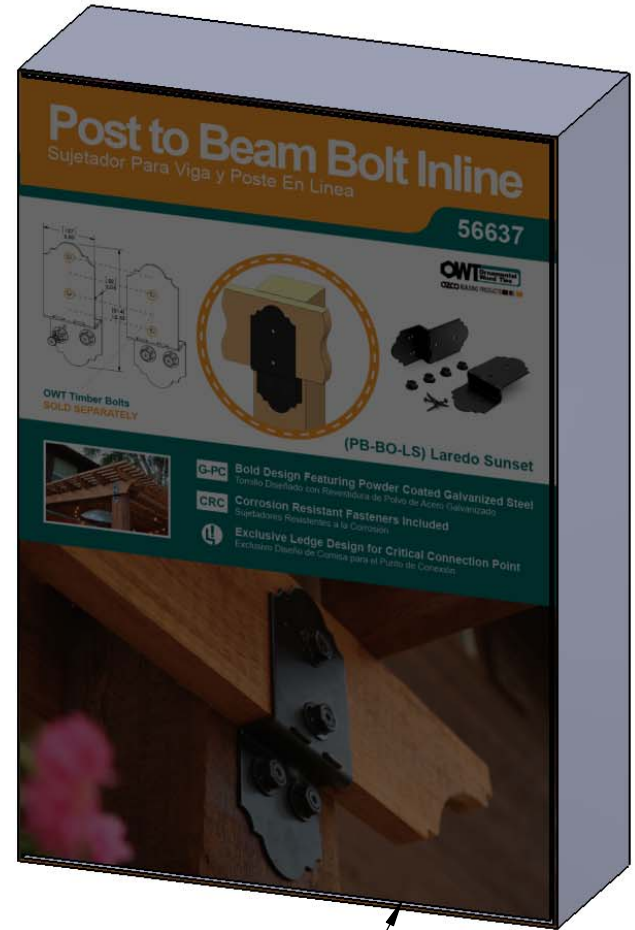
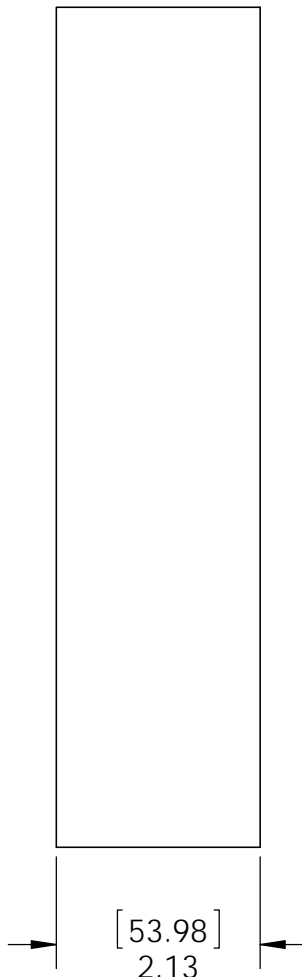
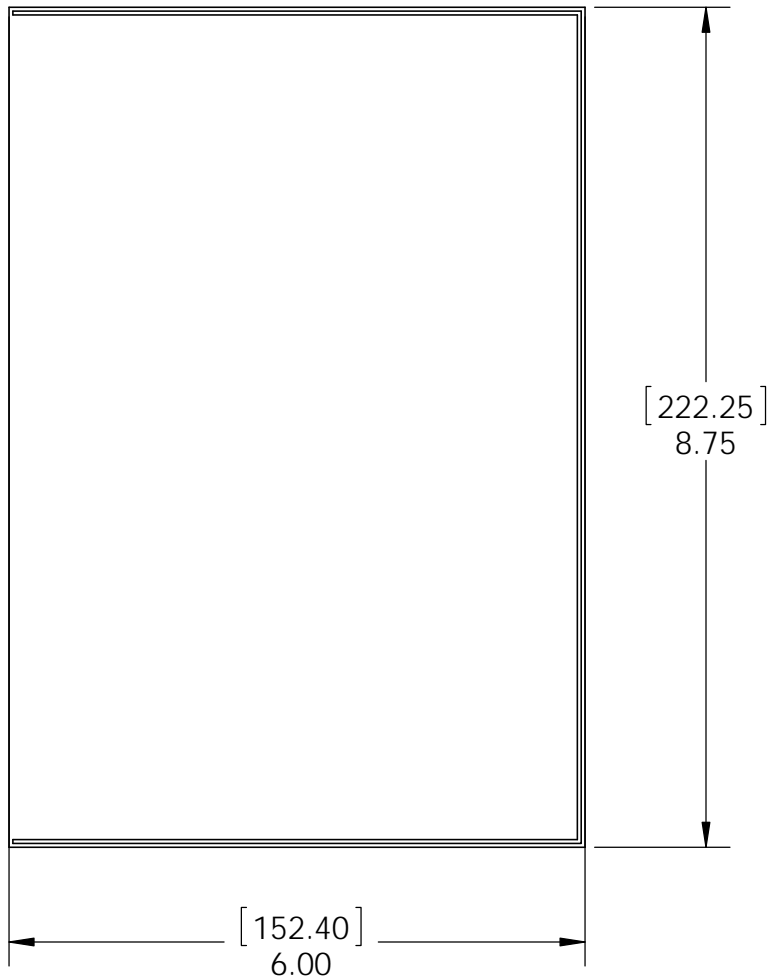

Material: Corrugated Paper
 Finish: See Artwork
 Weight: 0.04 LBS
 Scale: 1:2
 Last updated: 7/13/2015

56637-10

Product & Packaging Specs

56637 Packing

Item #: Box packing

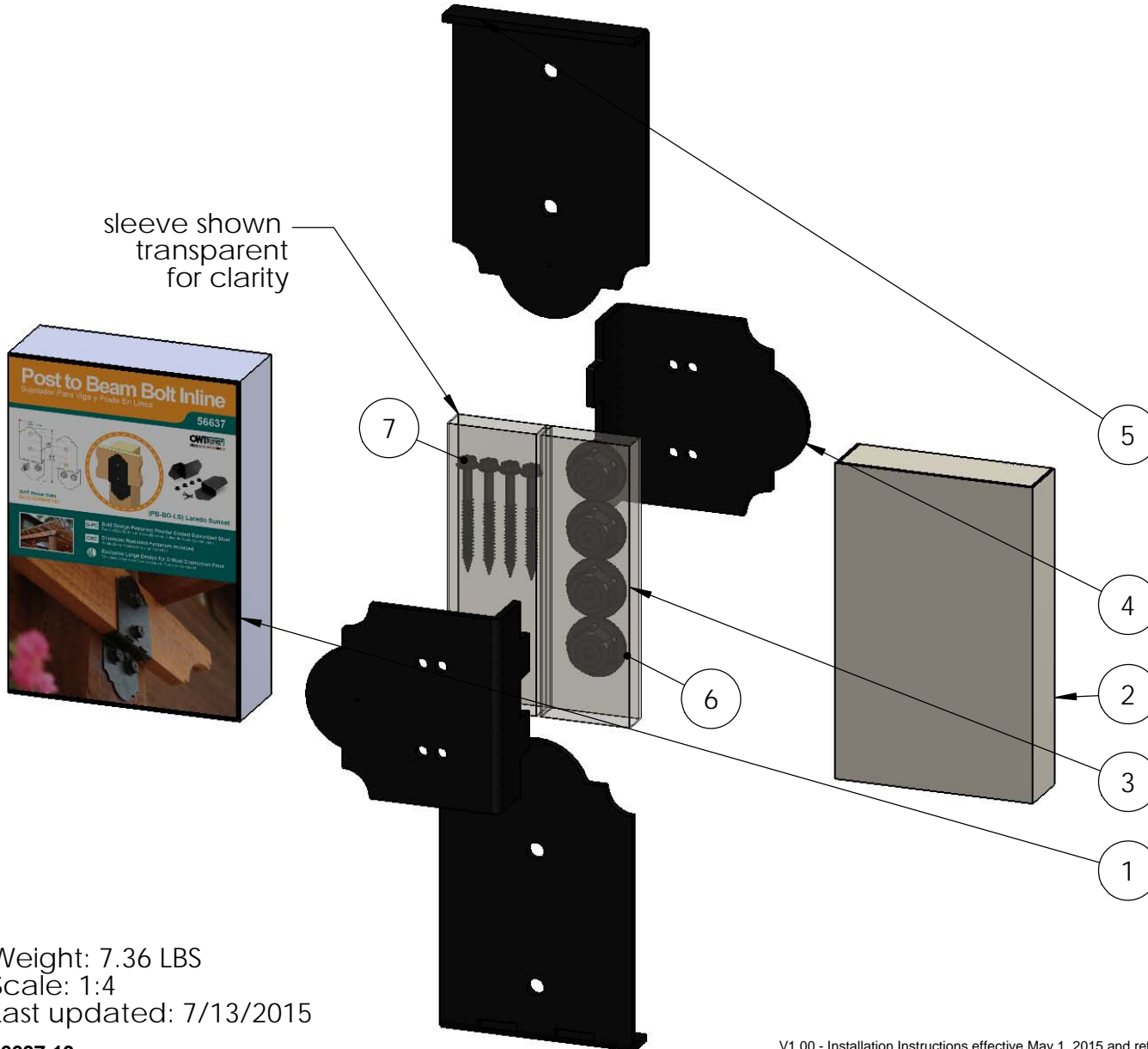

ITEM NO.	QTY.	PART NUMBER	DESCRIPTION
1	1	56637 Box	Box, Post to Beam
2	1	56637 Inner Box	Box, 56637 Inner
3	1	56637 Inner Box Sleeve	Sleeve, Post to Beam Inner Box
4	2	56610-11	Ledge, Post to Beam
5	2	56637-11	Plate, Bolt Inline 1 1/2"
6	4	56621	Hex Cap Nut
7	0.16	56626	OWT Timber Screw 2-3/4"

Weight: 7.36 LBS
 Scale: 1:4
 Last updated: 7/13/2015

56637-10

Product & Packaging Specs

Case, Post to Beam

Item #: 56637 Box Case

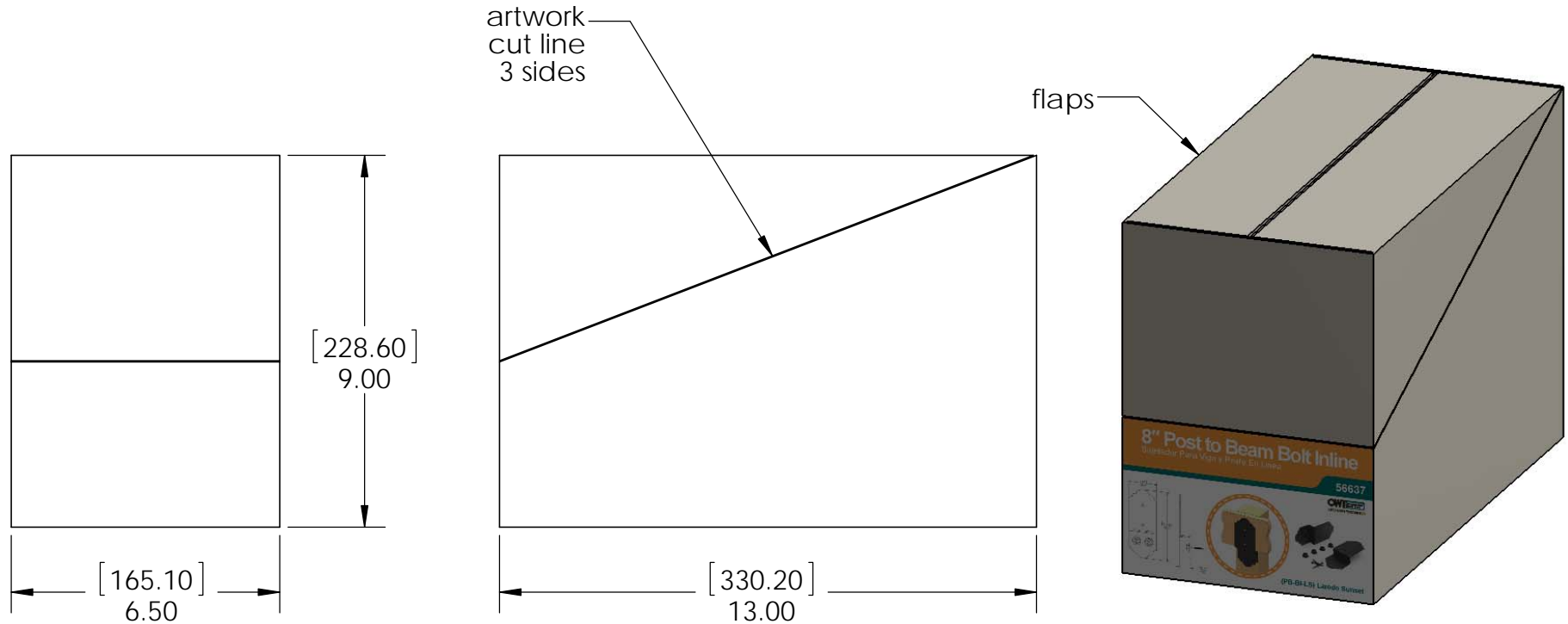

Material: Corrugated Paper
 Finish: See artwork
 Weight: 0.23 LBS
 Scale: 1:4
 Last updated: 7/13/2015

56637-10

Product & Packaging Specs

56637 Packing

Item #: Case packing

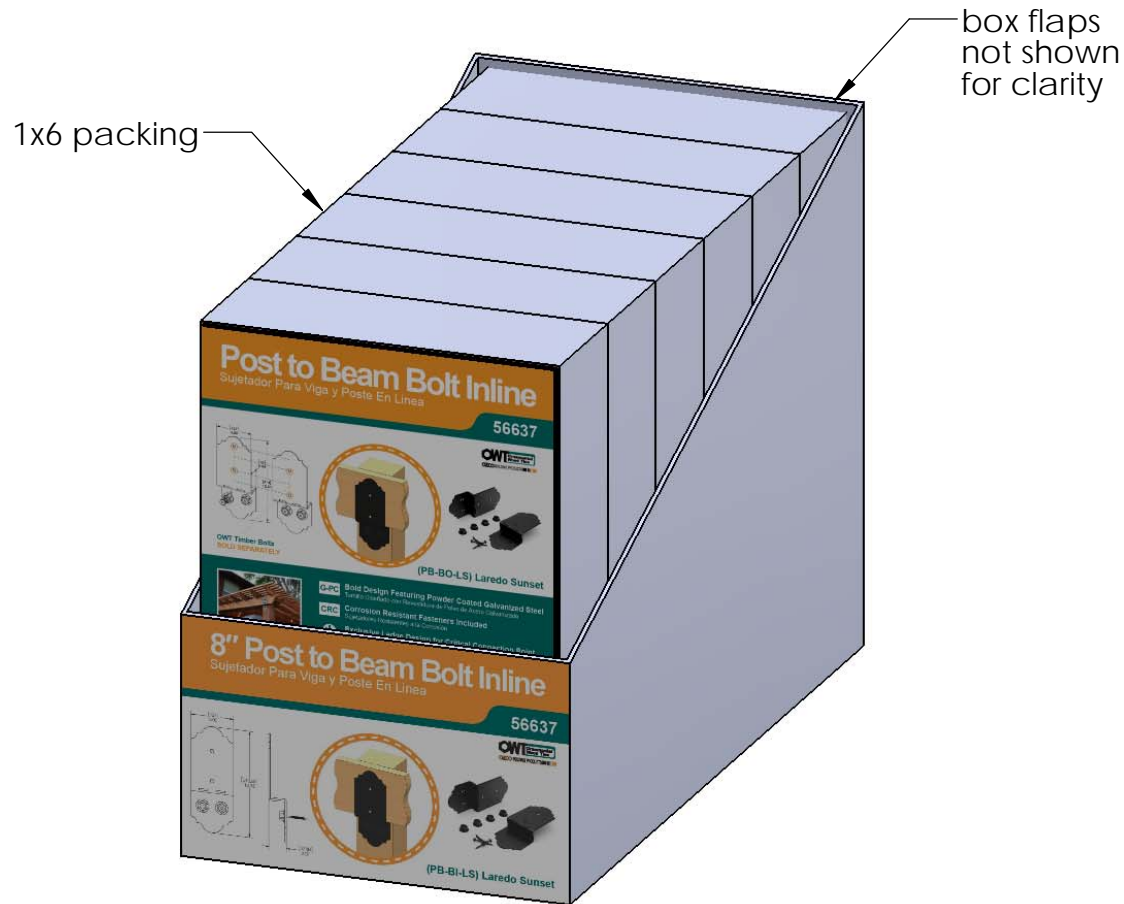

Weight: 7.55 LBS
Scale: 1:3
Last updated: 7/13/2015

56637-10

Item #: **56637** | **P2B-BI-LS**
 Post to Beam Inline LS
PALLET 168 pcs
 SKU#: **56837**
 Weight: **1339** lbs
 LOT# _____ Priority# _____

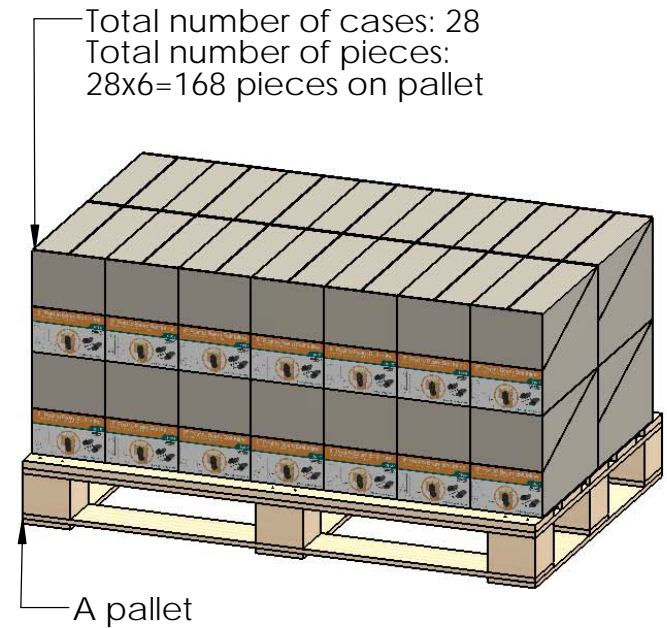
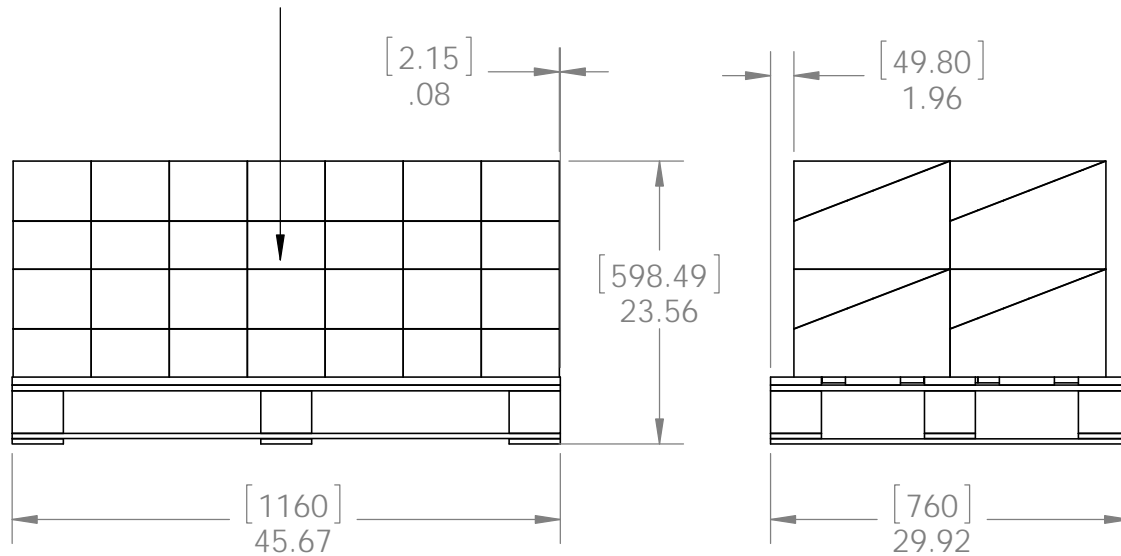

additional pallet packing instructions

- plywood on top layer
- strap to pallet
- clear wrap around boxes

Weight: 1339 LBS
 Scale: 1:16
 Last updated: 7/13/2015