



OZCO BUILDING PRODUCTS

Product & Packaging Specs

6-8" Joist Hanger Tab

Item #: 56640

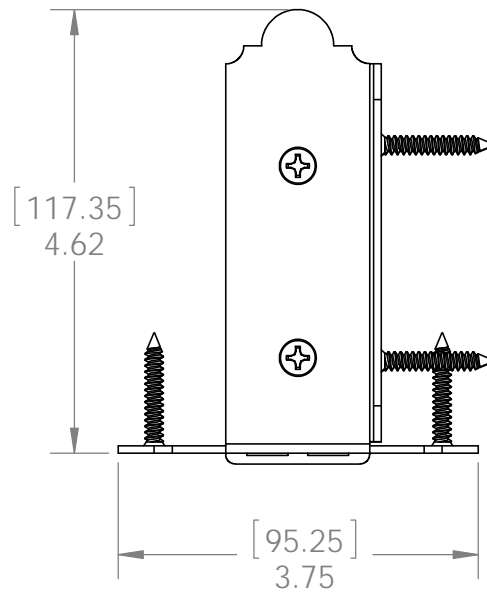
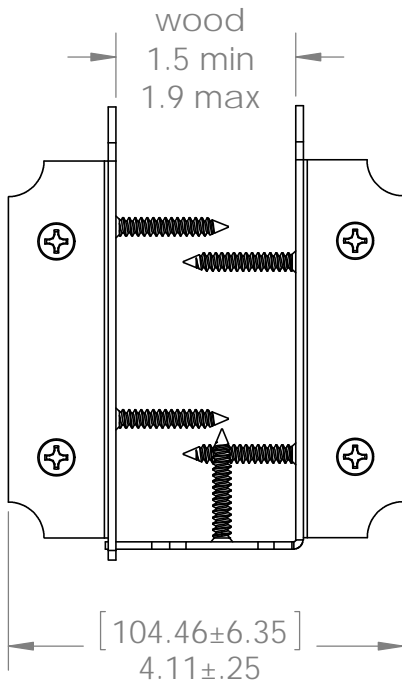
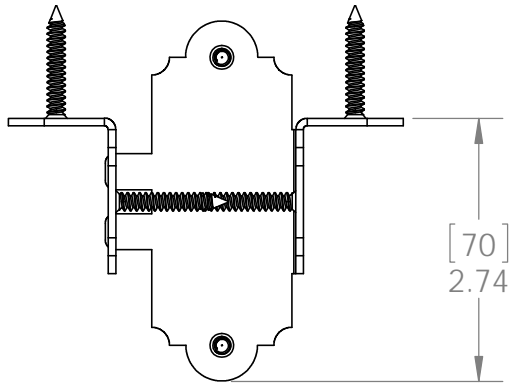

ITEM NO.	QTY.	PART NUMBER	DESCRIPTION
1	1	56640-11	56639 PART A
2	1	56640-12	56639 Part B
3	10	80010	SCREW, FHP #10 X 1.25", BLACK

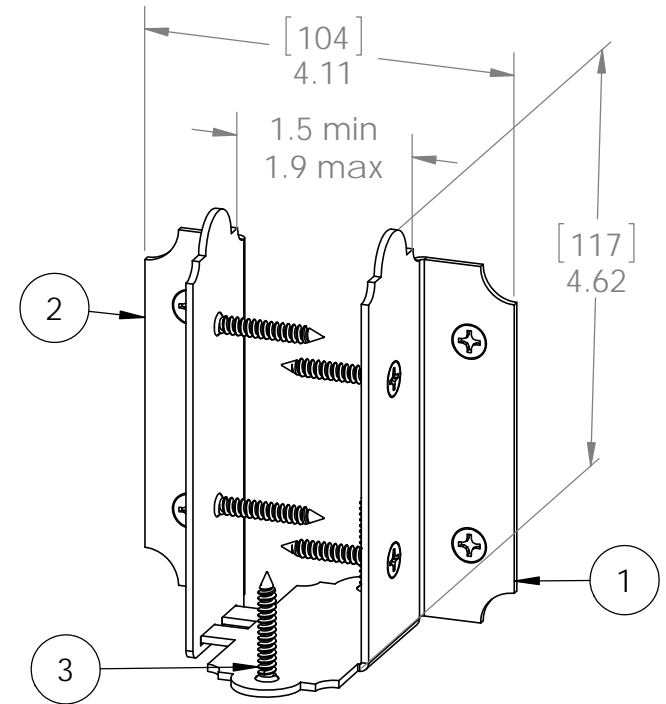

Weight: 0.58 LBS
 Scale: 1:2
 Last updated: 7/13/2015

56640-10

revision B corrects #10 screws to #12

V1.00 - Installation Instructions effective May 1, 2015 and reflects information that available as of April 10, 2014. This information is updated periodically and should not be relied upon after May 1, 2015. Please visit www.OZCOBP.com to get current information



OZCO BUILDING PRODUCTS

Product & Packaging Specs

6-8" Joist Hanger Tab

Item #: 56640

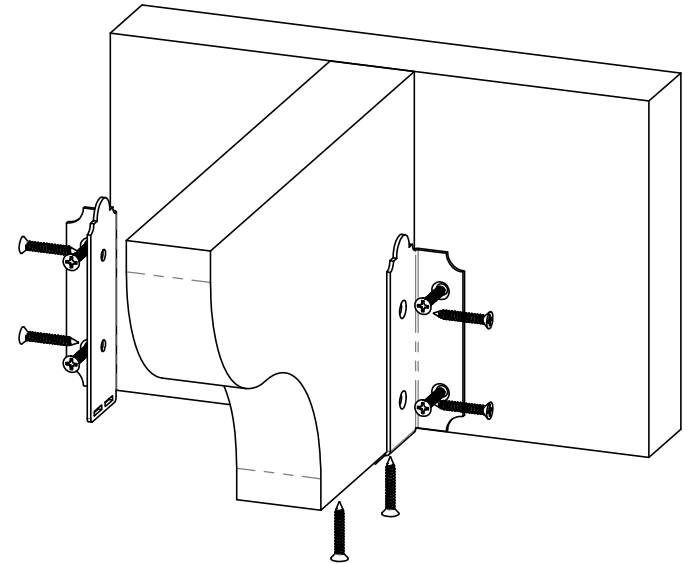
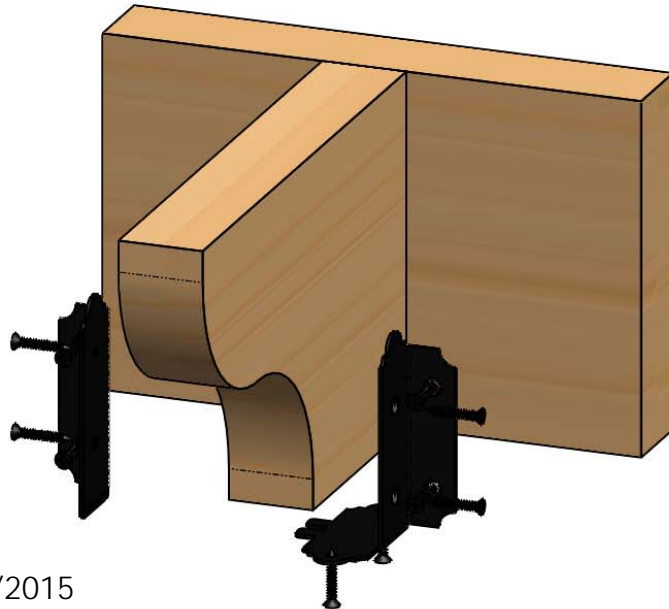
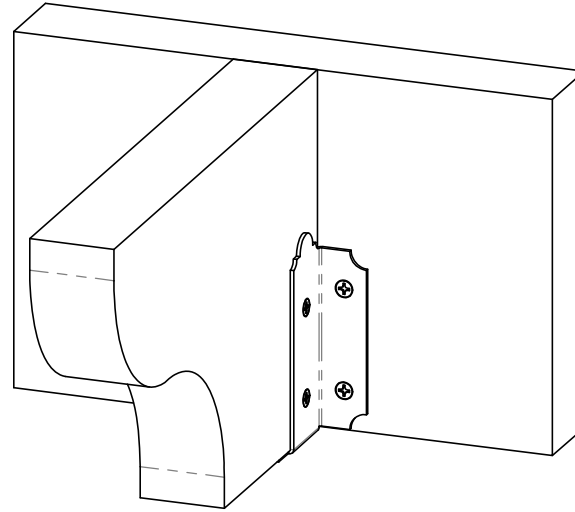
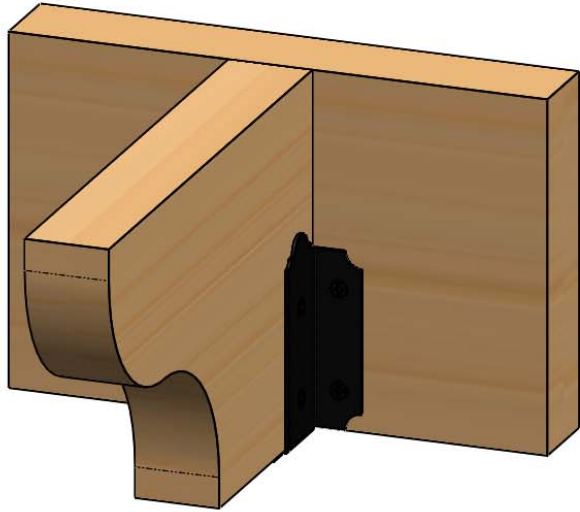

Weight: 0.58 LBS
Scale: 1:4
Last updated: 7/13/2015

56640-10

V1.00 - Installation Instructions effective May 1, 2015 and reflects information that available as of April 10, 2014. This information is updated periodically and should not be relied upon after May 1, 2015. Please visit www.OZCOBP.com to get current information

Product & Packaging Specs

Box, 6-8" Joist Hanger

Item #: Box

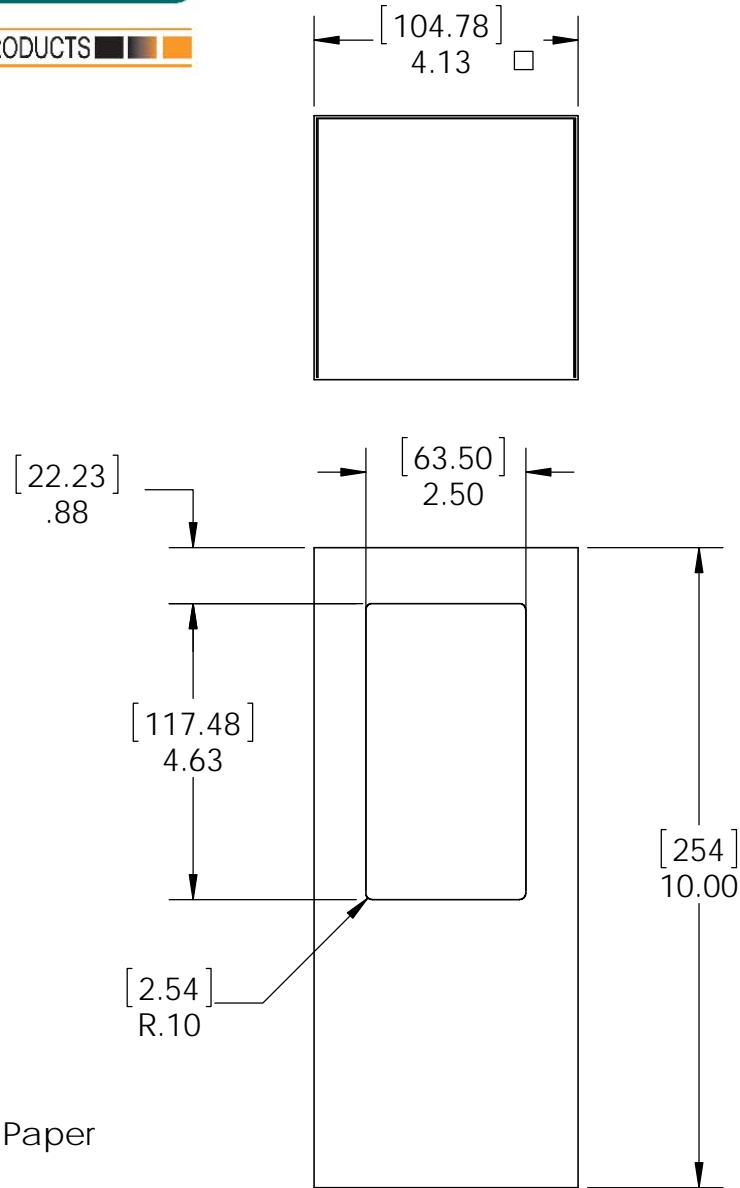

Material: Corrugated Paper
 Finish: See Artwork
 Weight: 0.04 LBS
 Scale: 1:3
 Last updated: 7/13/2015

56640-10

Product & Packaging Specs

56640 Packing

Item #: Box Packing

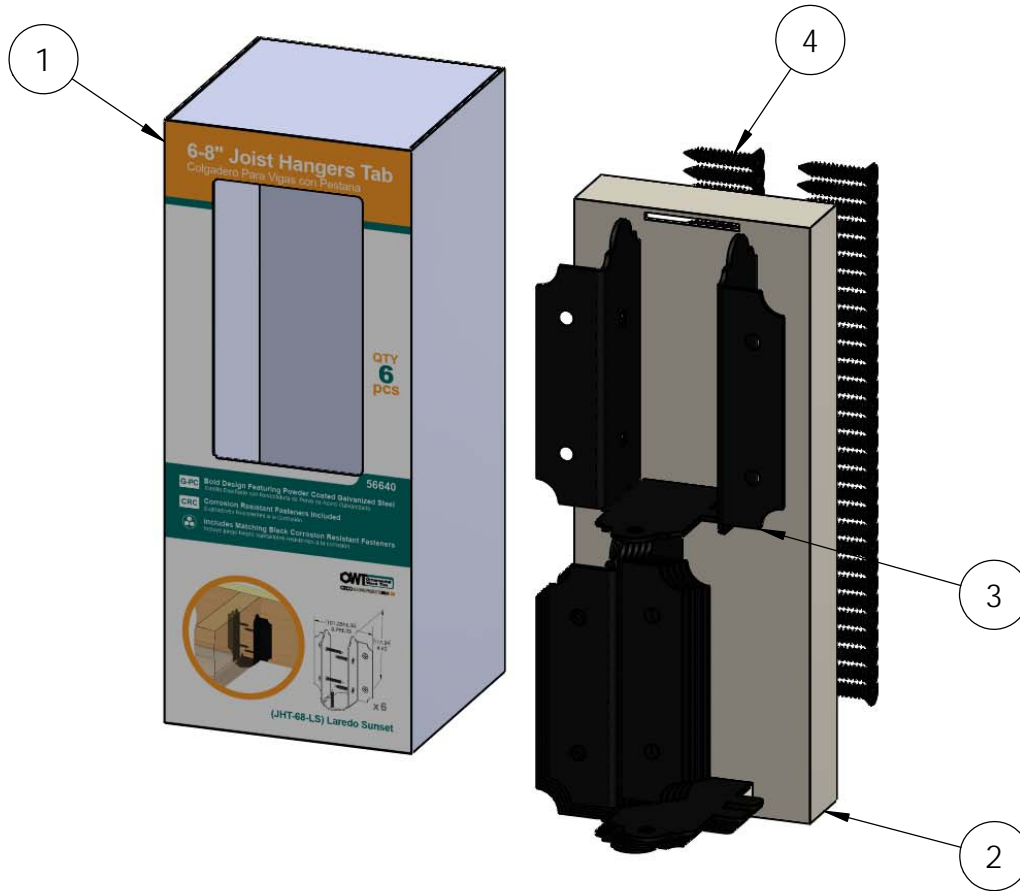

ITEM NO.	QTY.	PART NUMBER	DESCRIPTION
1	1	56639 Box Insert	Joist Hanger Box Insert
2	6	56640-10	6-8" Joist Hanger Tab
3	1	56640 Box	Box, 6-8" Joist Hanger
4	60	80014	Screw, FHP #12 X 1.25", Black

Screws placed inside a small plastic bag and placed inside each box

Weight: 7.33 LBS
 Scale: 1:4
 Last updated: 7/13/2015

56640-10

revision B corrects #10 screws to #12

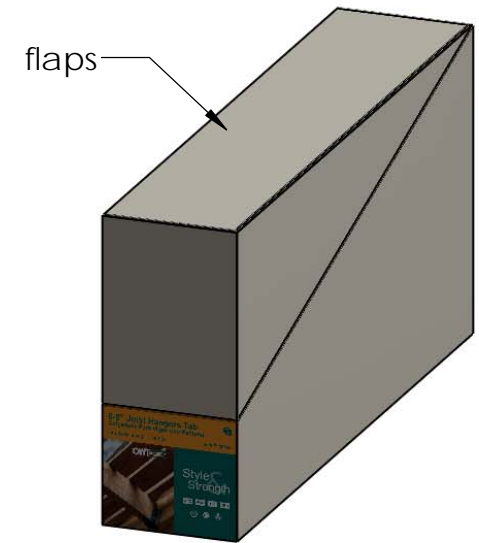
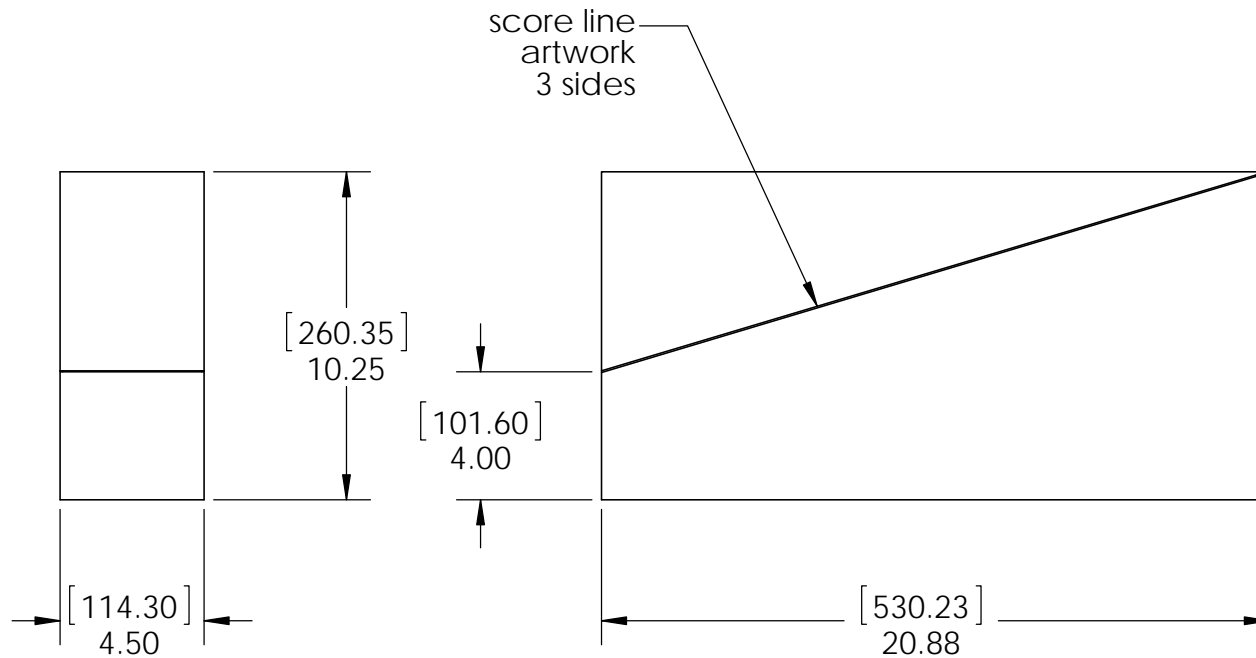

Material: Corrugated Paper
 Finish: Natural
 Weight: 0.32 LBS
 Scale: 1:6
 Last updated: 7/13/2015

56640-10

Product & Packaging Specs

56640 Packing

Item #: Case Packing

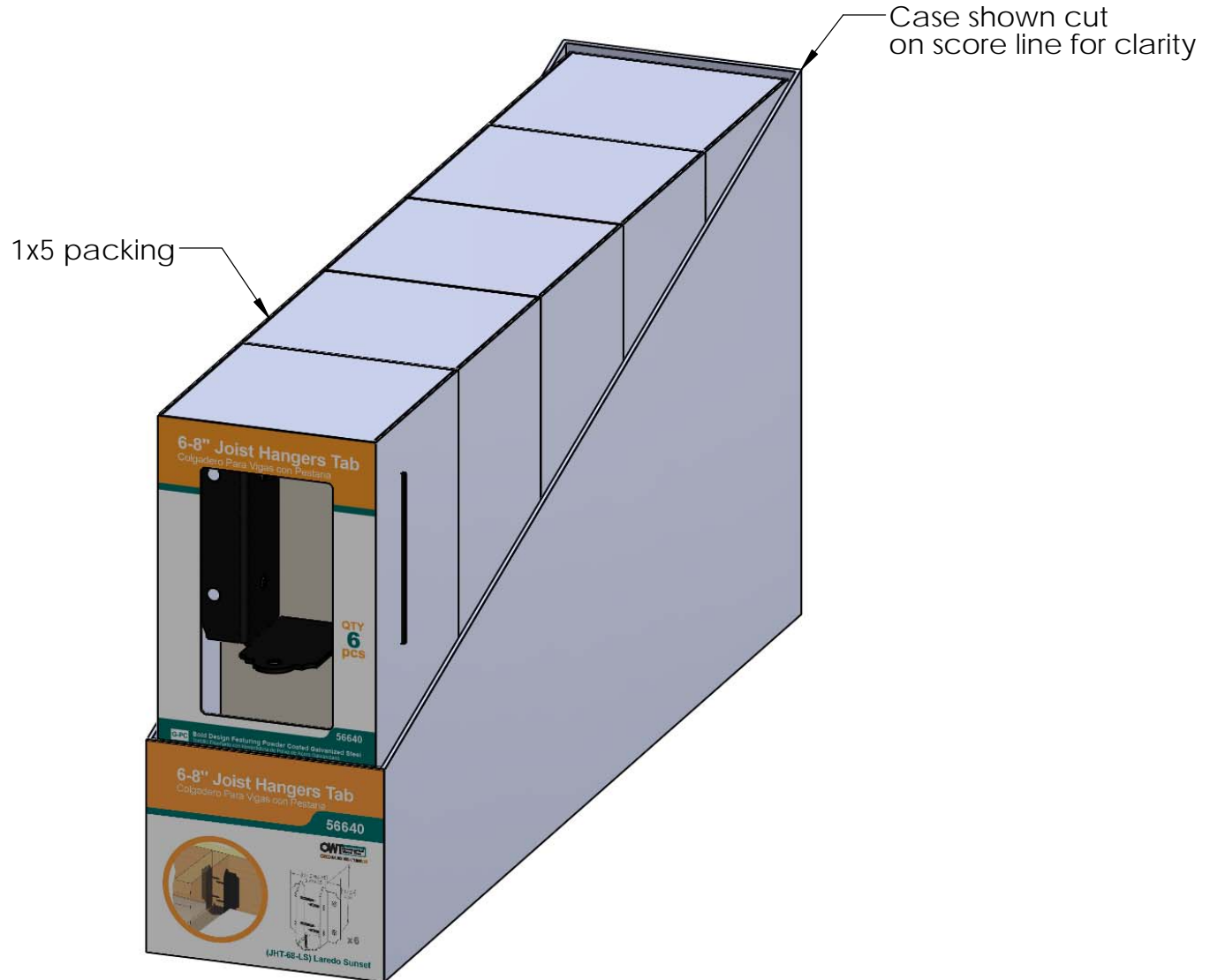

Weight: 21.75 LBS
 Scale: 1:2
 Last updated: 7/13/2015

56640-10



OZCO BUILDING PRODUCTS

Item #: **56640** | **JHT-68-LS**

6-8" Joist Hanger Tab LS

PALLET | **165 pcs**

SKU#: **56840**



Weight: **746 lbs**

LOT# _____ Priority# _____

Product & Packaging Specs

56640 Packing

Item #: Pallet Packing

Total number of cases: 33
Total number of pieces:
33x5=165 pieces on pallet

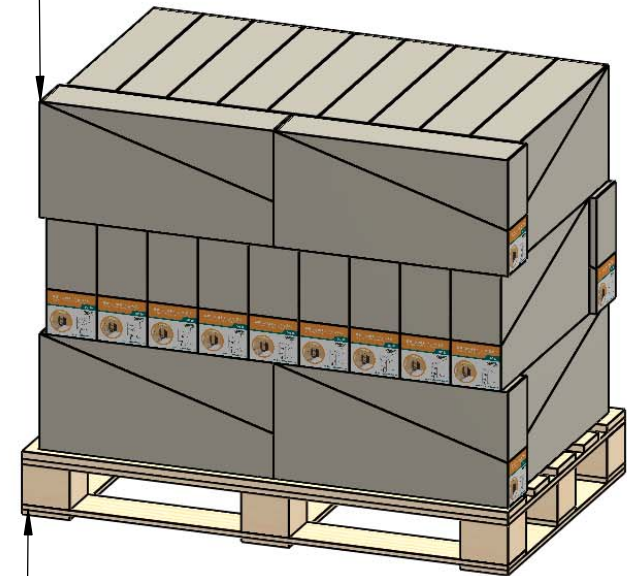

H pallet



additional pallet packing instructions

- plywood on top layer
- strap to pallet
- clear wrap around boxes

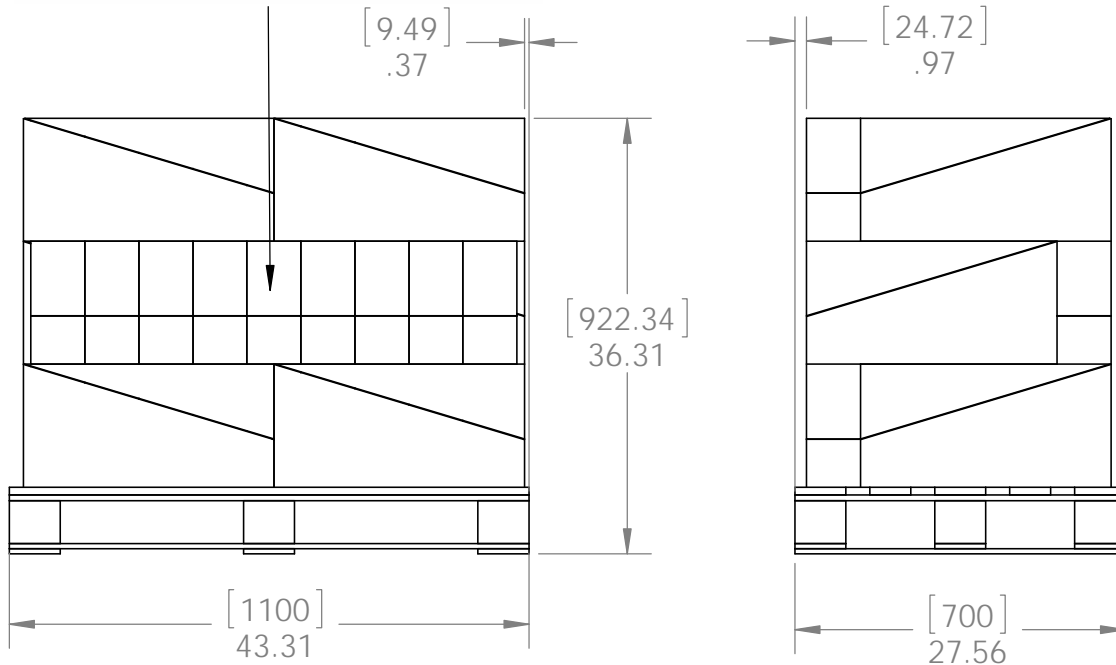

Weight: 746 LBS
Scale: 1:2
Last updated: 7/13/2015

56640-10

V1.00 - Installation Instructions effective May 1, 2015 and reflects information that available as of April 10, 2014. This information is updated periodically and should not be relied upon after May 1, 2015. Please visit www.OZCOBP.com to get current information