

Product & Packaging Specs

2x4 Top Rail Saddle

Item #: 56641

ITEM NO.	QTY.	PART NUMBER	DESCRIPTION
1	6	80014	Screw, FHP #12 X 1.25", Black
2	1	56641-12	Bracket, 2x4 Top Rail Saddle

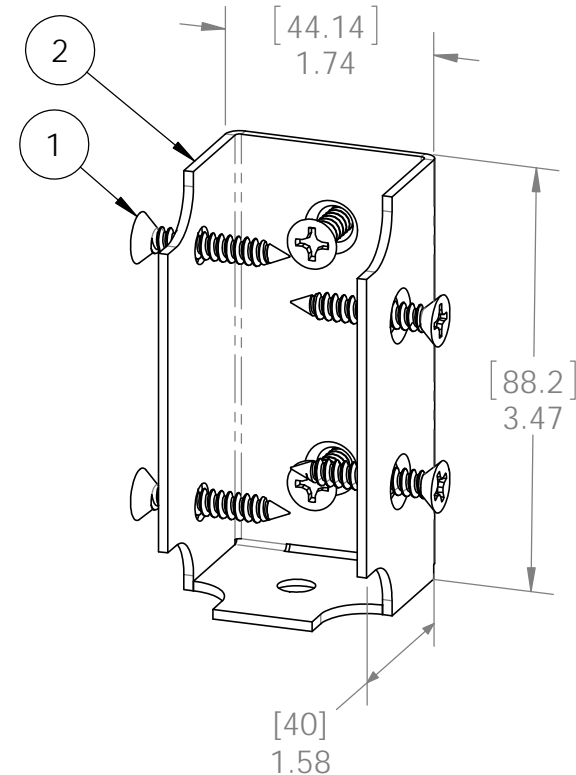
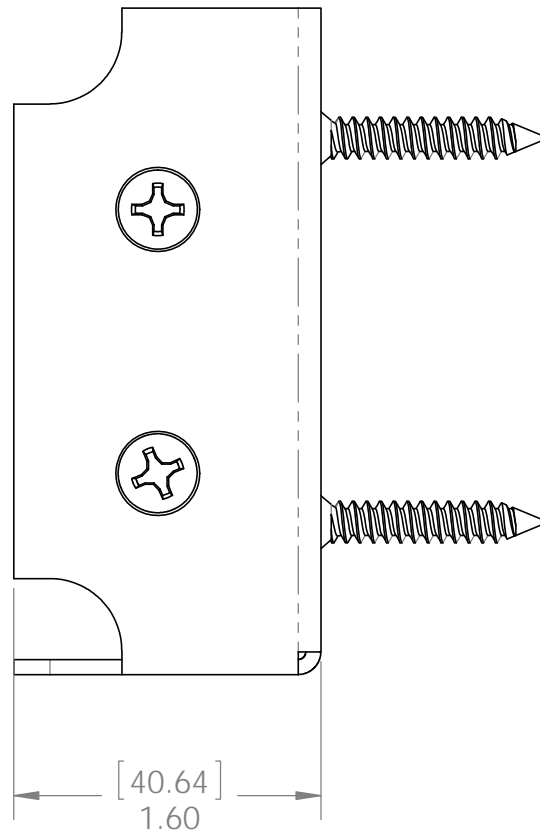
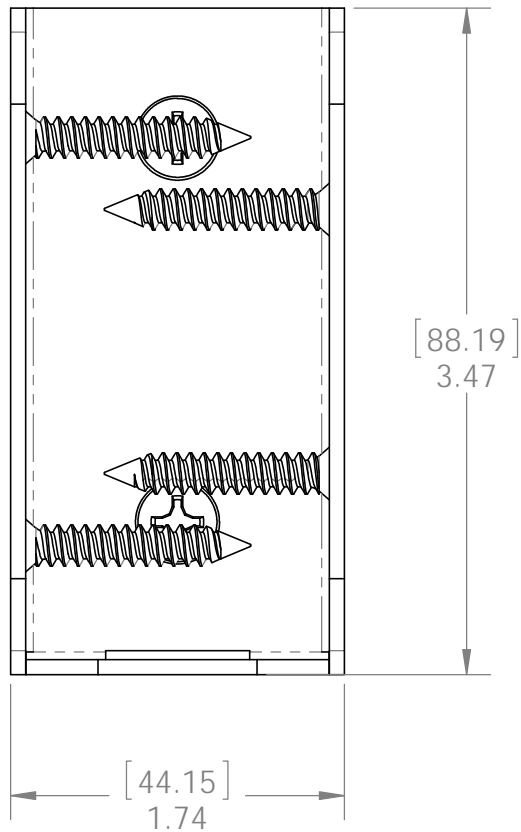

Weight: 0.42 LBS
Scale: 1:1
Last updated: 5/29/2015

revision B adds bend relief
revision C corrects #10 screws to #12

Product & Packaging Specs

2x4 Top Rail Saddle

Item #: Typical Installation & Basic Assembly

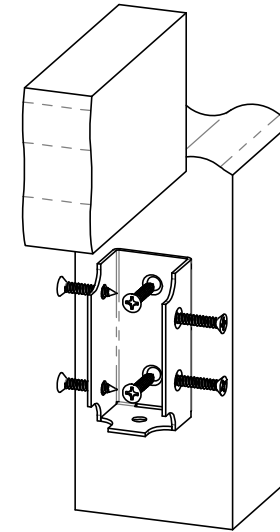
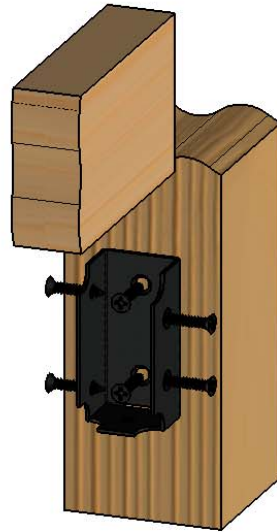
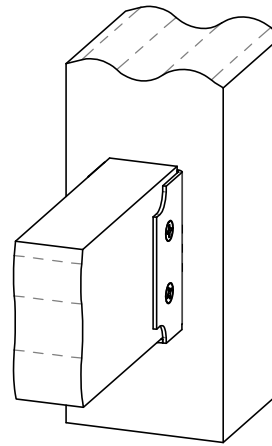
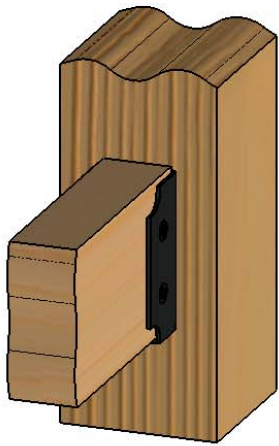

Scale: 1:4
Last updated: 5/29/2015

56641-10

Product & Packaging Specs

Box, 56641
 Item #: Box

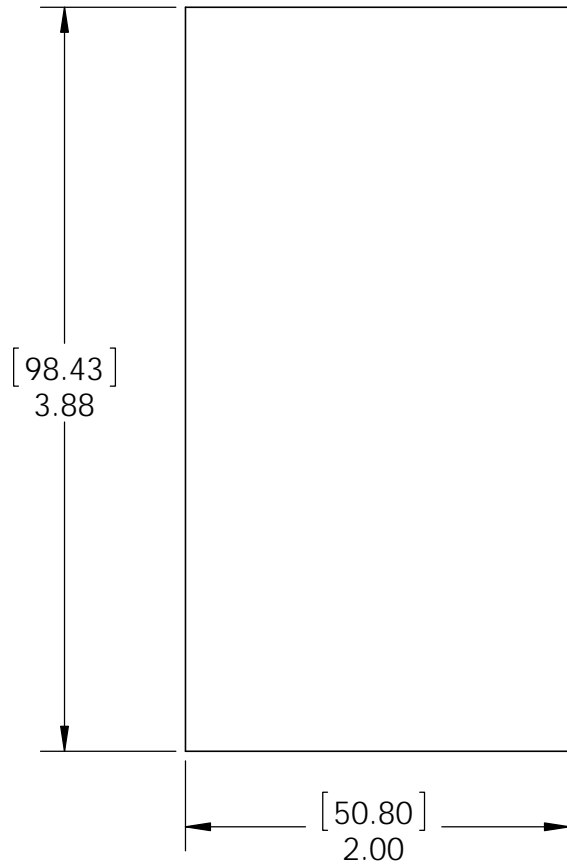

Material: Corrugated Paper
 Finish: See Artwork
 Weight: 0.01 LBS
 Scale: 1:1
 Last updated: 5/29/2015

56641-10

Product & Packaging Specs

56641 Packing
 Item #: Box packing

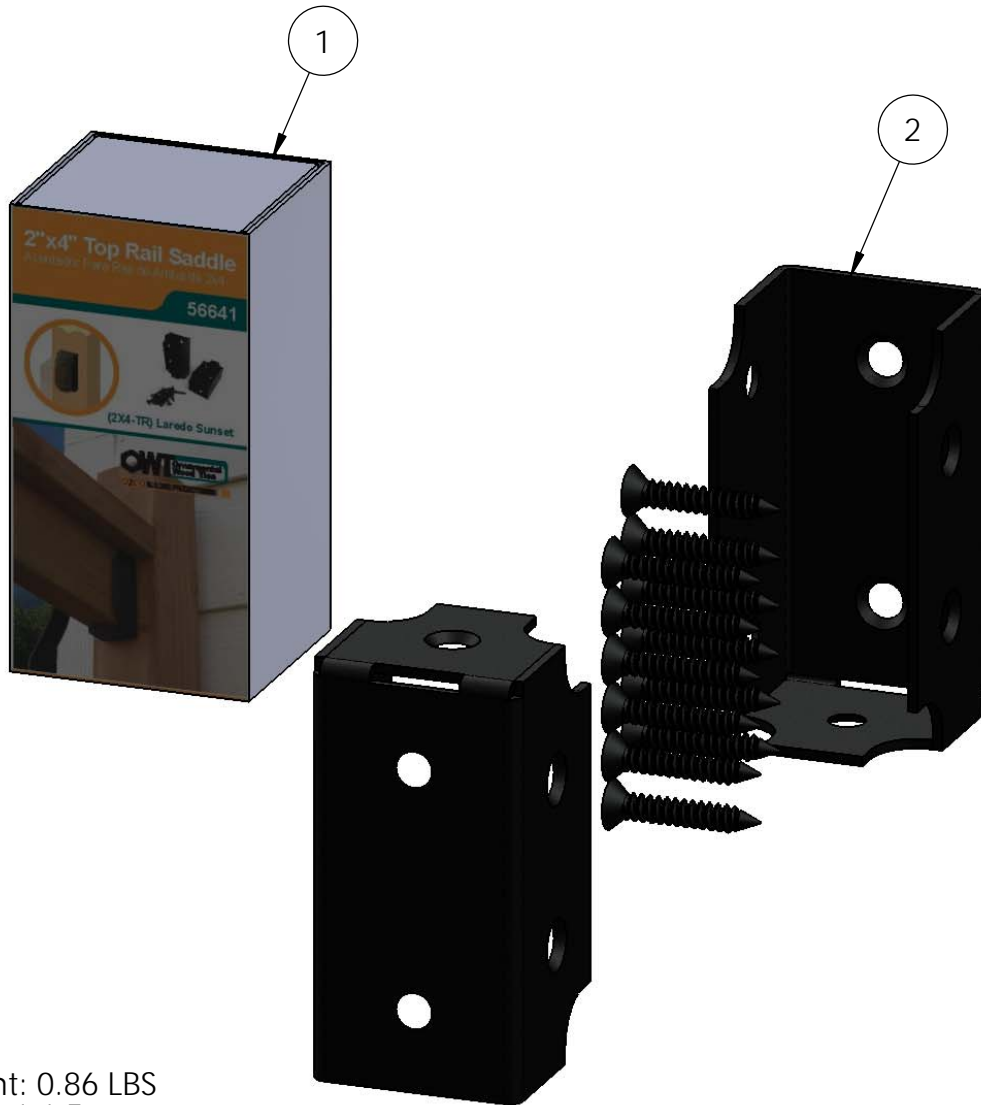

ITEM NO.	QTY.	PART NUMBER	DESCRIPTION
1	1	Box, 56641	Box, 56641
2	2	56641-11	2x4 Top Rail Saddle

screws shall be placed in bag and placed between brackets

Weight: 0.86 LBS
 Scale: 1:1.5
 Last updated: 5/29/2015

56641-10

revision B adds bend relief
 revision C corrects #10 screws to #12

V1.00 - Installation Instructions effective May 1, 2015 and reflects information that available as of April 10, 2014. This information is updated periodically and should not be relied upon after May 1, 2015. Please visit www.OZCOBP.com to get current information

Product & Packaging Specs

Case, 56641

Item #: Case

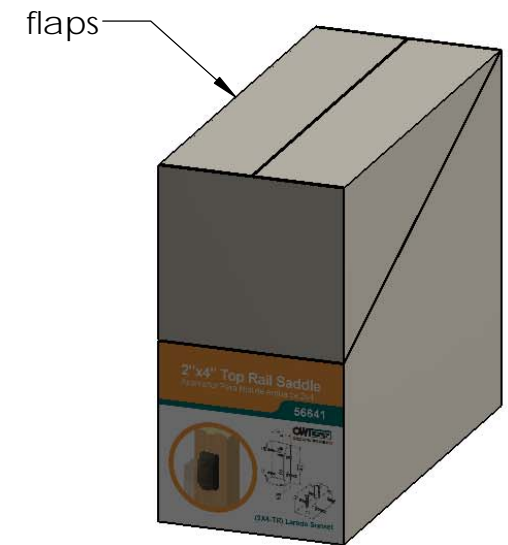
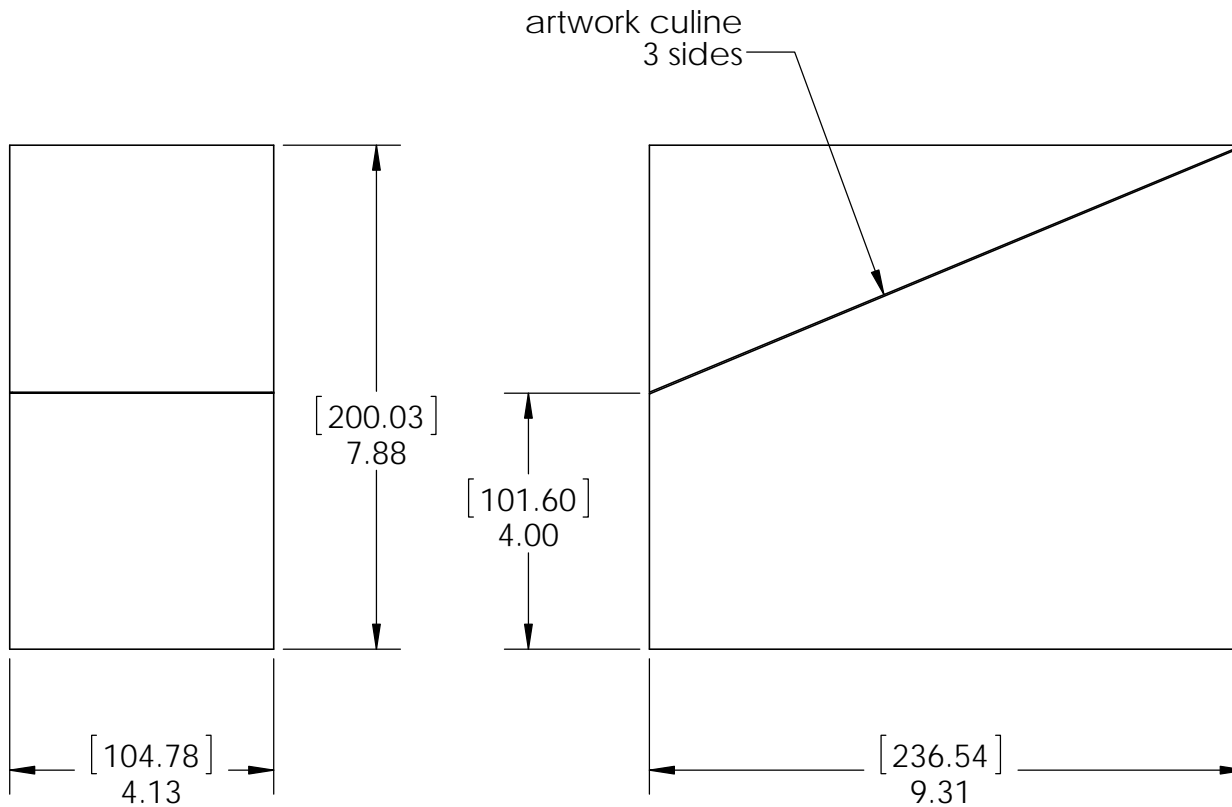

Material: Corrugated Paper
 Finish: Natural
 Weight: 0.04 LBS
 Scale: 1:3
 Last updated: 5/29/2015

56641-10

Product & Packaging Specs

56641 Packing

Item #: Case packing

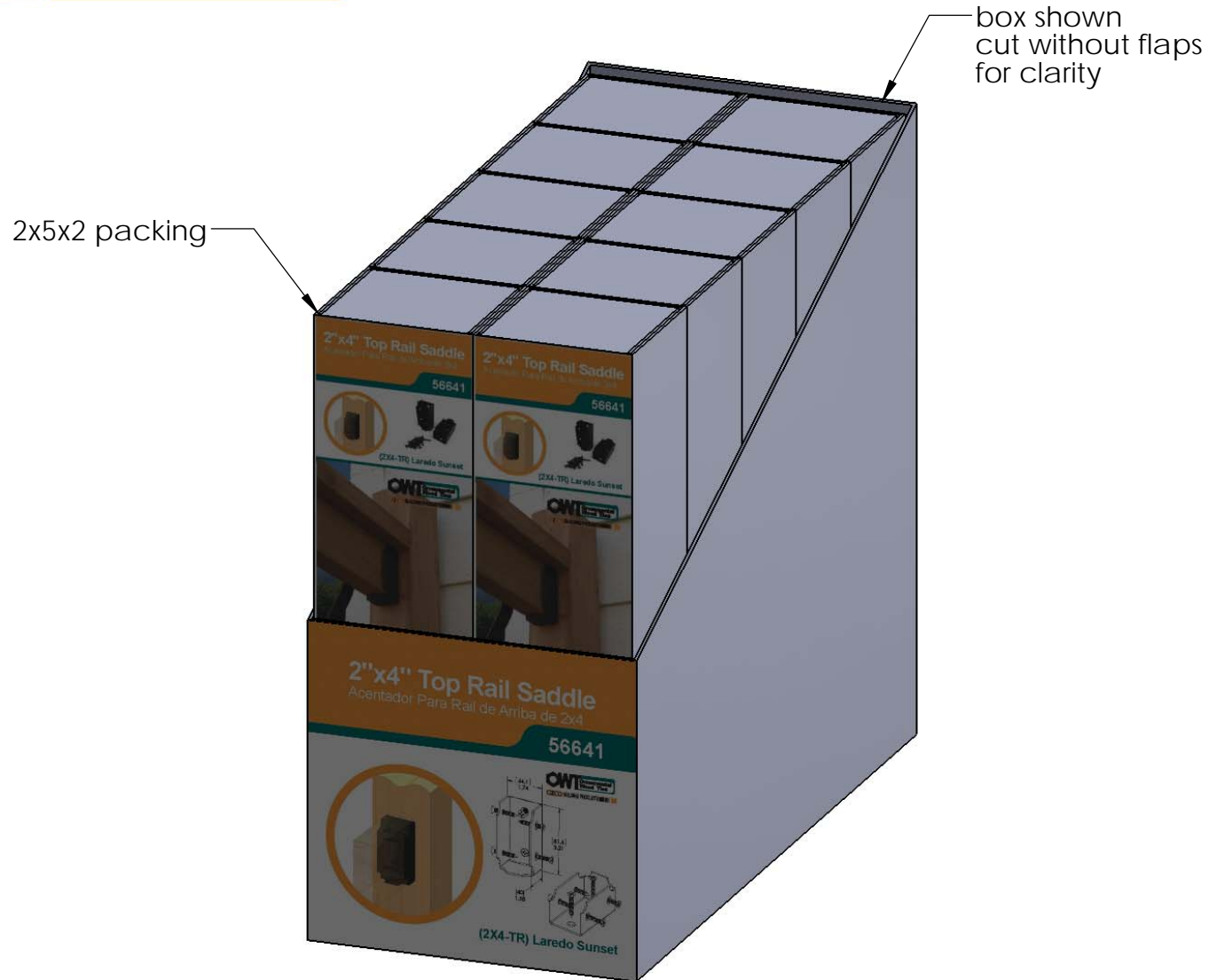

Weight: 9.17 LBS
 Scale: 1:2
 Last updated: 5/29/2015

56641-10

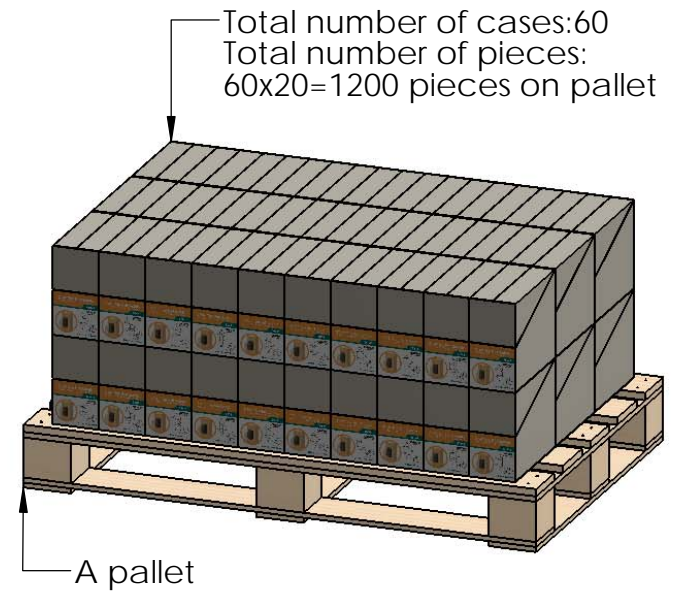
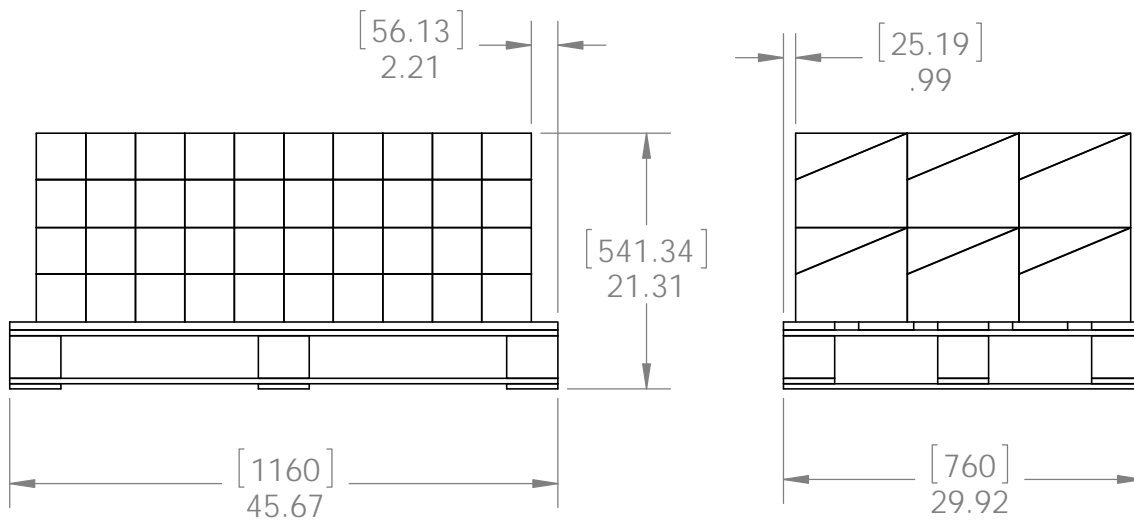

additional pallet packing instructions

- plywood on top layer
- strap to pallet
- clear wrap around boxes

Weight: 1240 LBS
 Scale: 1:16
 Last updated: 5/29/2015