

# Product & Packaging Specs

## 8" Post to Beam Flush (P2B-LS-8F)

Item #: 56676

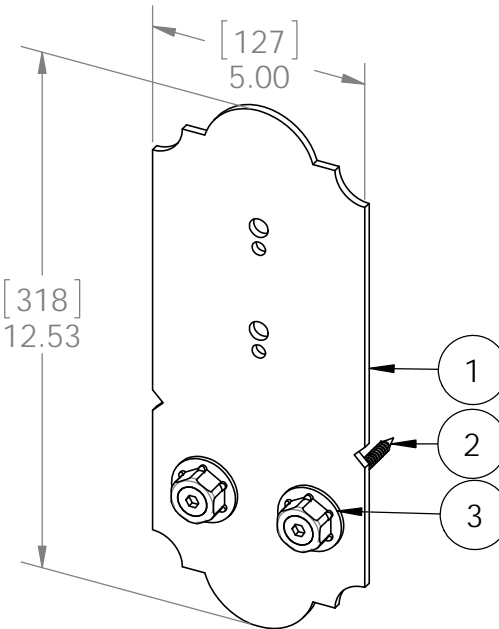
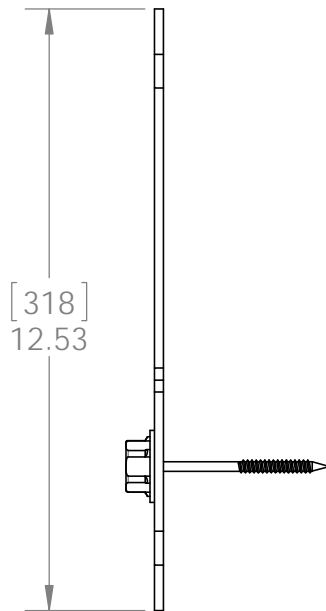
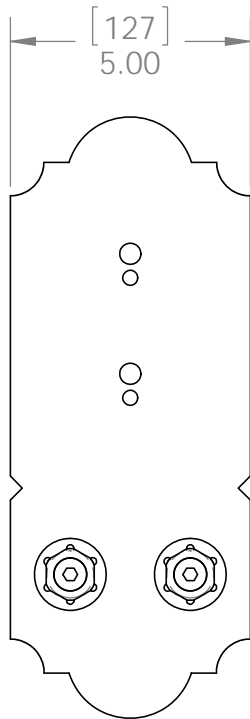
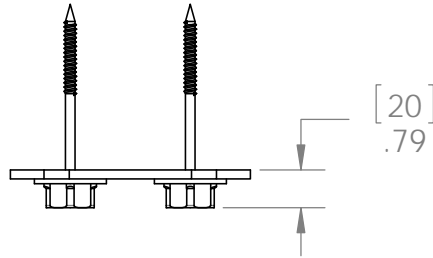

kit includes 2 assemblies

ITEM NO.	QTY.	PART NUMBER	DESCRIPTION
1	1	56676-11	Bracket, 8" Flush Post to Beam
2	2	56627	OWT Timber Screw 3-3/4"
3	2	56621	1 1/2" Hex Cap Nut

Weight: 3.01 LBS each  
Scale: 1:4  
Last updated: 7/15/2015

56676

# Product & Packaging Specs

## 8" Post to Beam Flush (P2B-LS-8F)

Item #: 56676

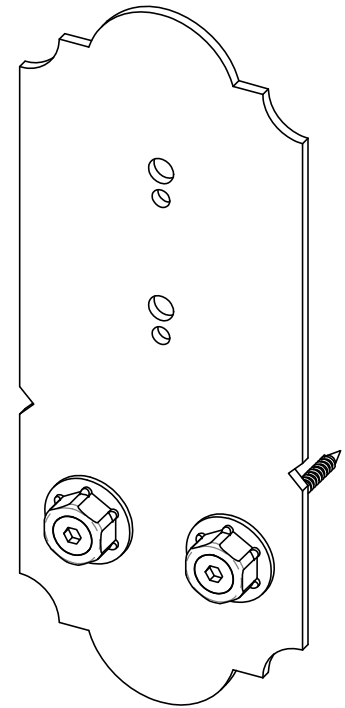
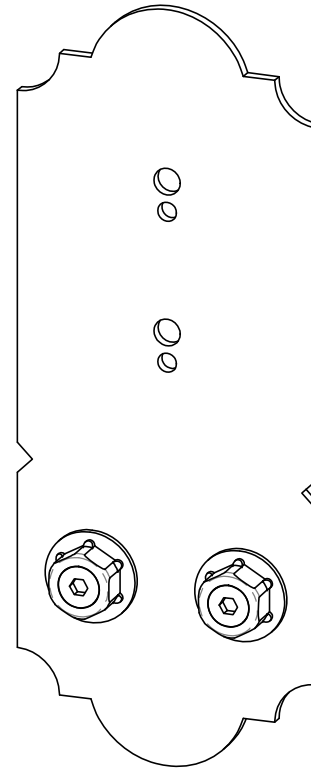
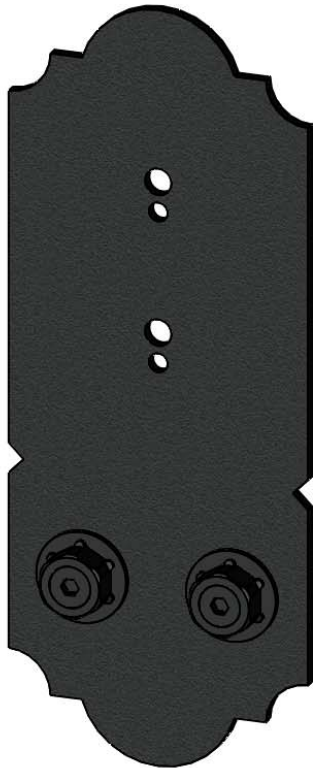

Weight: 3.01 LBS each  
Scale: 1:3  
Last updated: 7/15/2015

56676

# Product & Packaging Specs

## 8" Post to Beam Flush (P2B-LS-8F)

Item #: Typical Installation & Basic Assembly

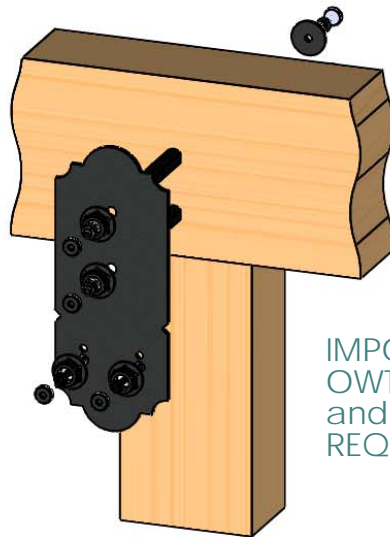
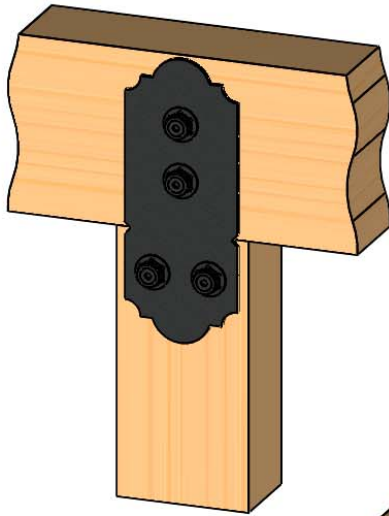

IMPORTANT: Each Sold Separately  
OWT Timber Bolts, Timber Screws  
and/or Hex Cap Nuts are  
REQUIRED for proper installation.

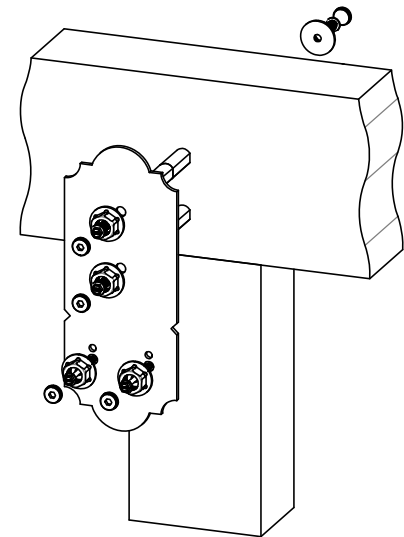
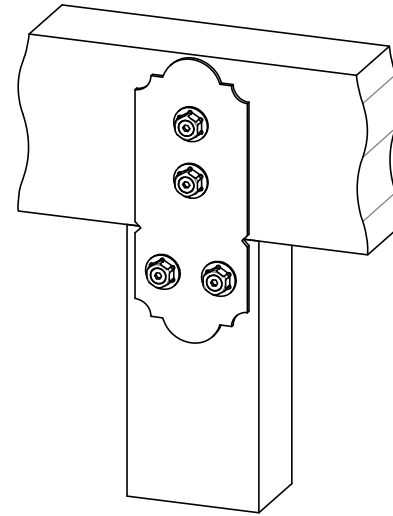

Scale: 1:8  
Last updated: 7/15/2015

56676

# Product & Packaging Specs

Box, 56676

Item #: Box, 56676

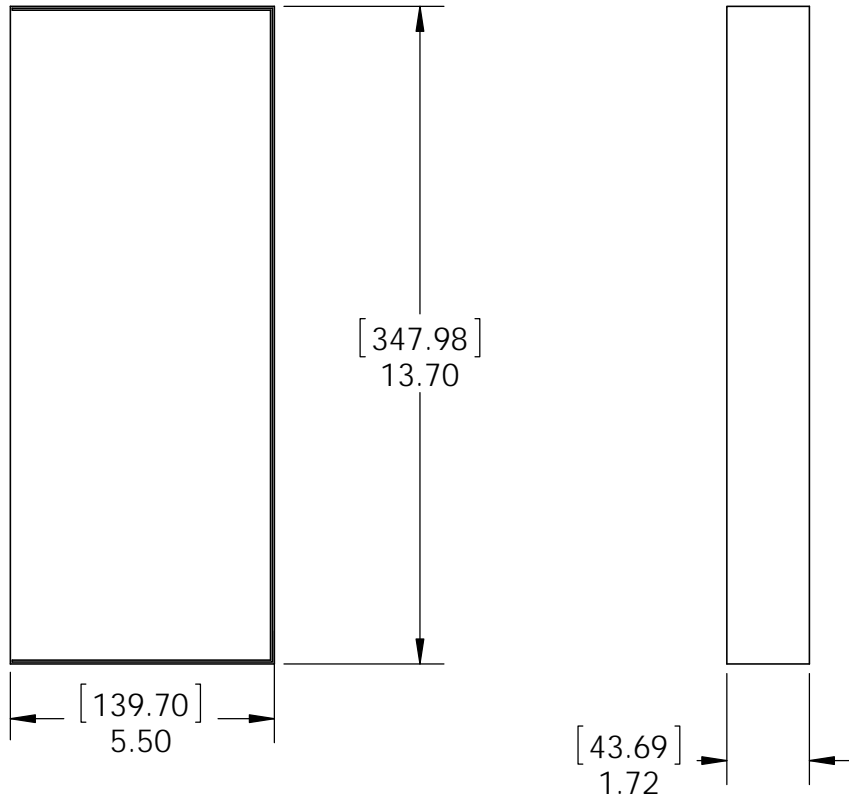

flap

Material: Corrugated Paper  
Finish: See artwork  
Weight: 0.05 LBS  
Scale: 1:4  
Last updated: 7/15/2015

56676

# Product & Packaging Specs

## 56676 Packing

Item #: Box packing

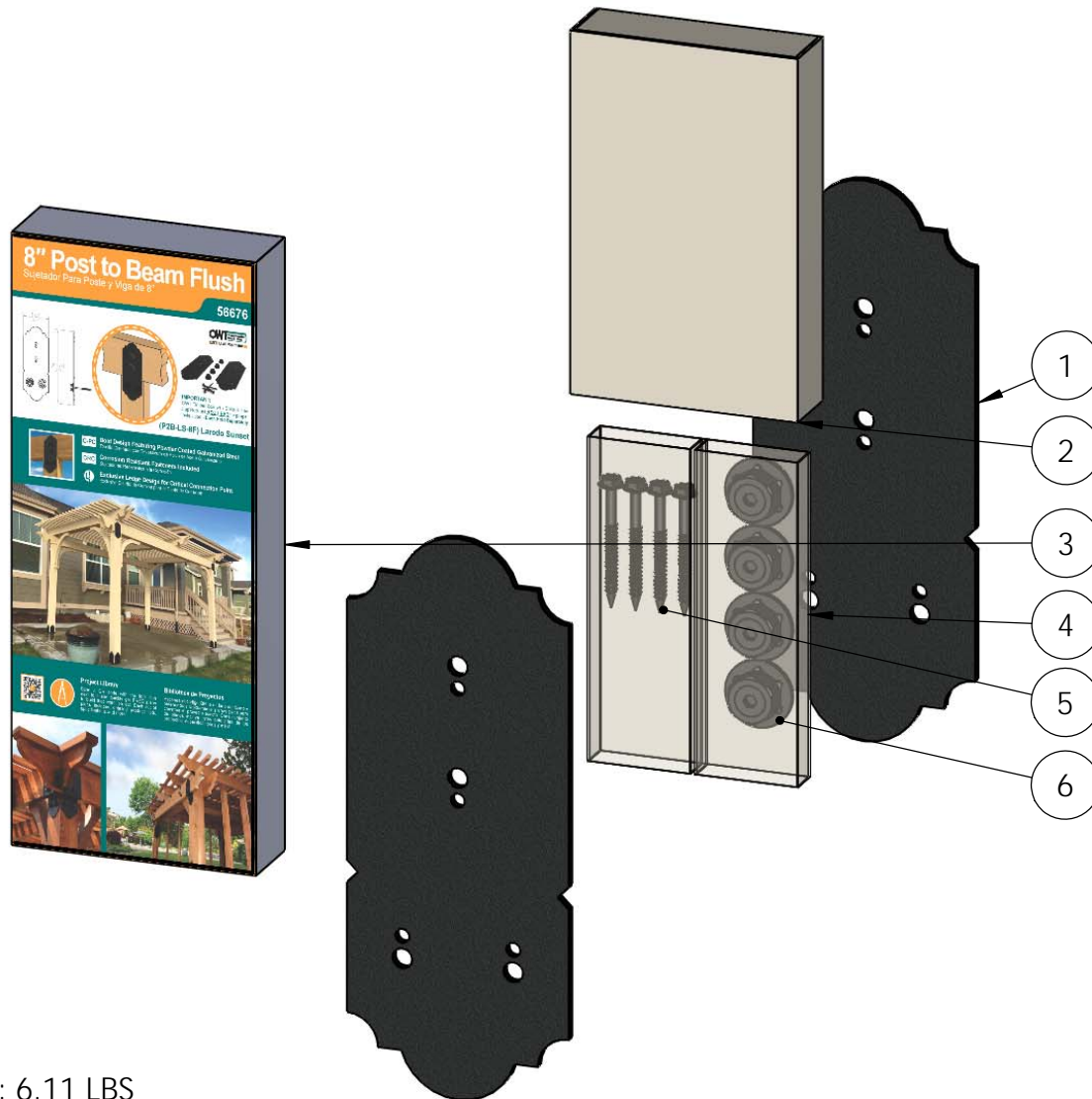

ITEM NO.	QTY.	PART NUMBER	DESCRIPTION
1	2	56676-11	Bracket, 8" Flush Post to Beam
2	1	56637 Inner Box	Box, 56637 Inner
3	1	Box, 56676	Box, 56676
4	1	56637 Inner Box Sleeve	Sleeve, Post to Beam Inner Box
5	0.16	56626	OWT Timber Screw 2-3/4"
6	4	56621	1 1/2" Hex Cap Nut

Weight: 6.11 LBS  
Scale: 1:4  
Last updated: 7/15/2015

56676

# Product & Packaging Specs

Case, 56676

Item #: Case, 56676

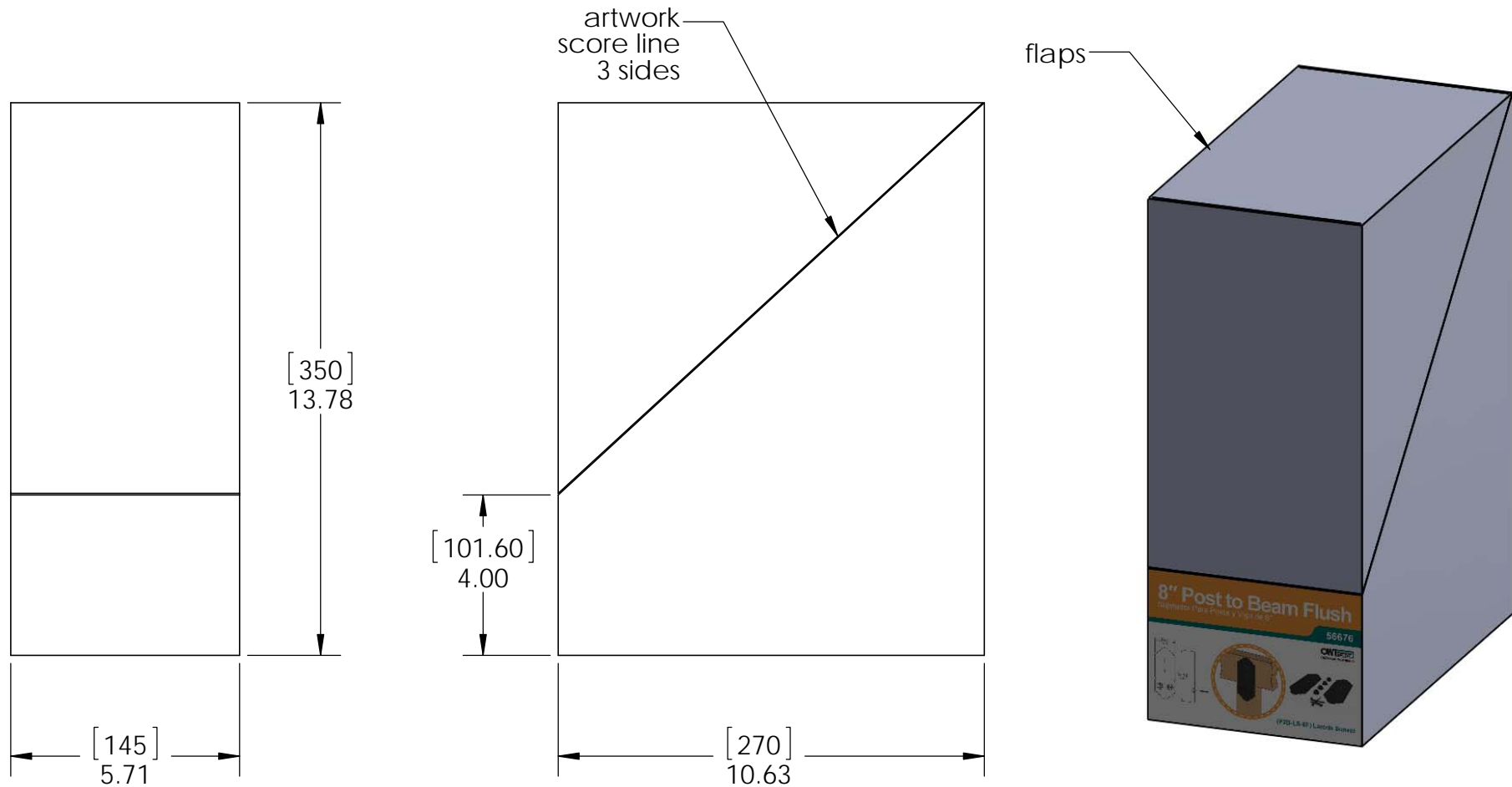

Material: Corrugated Paper  
Finish: See artwork  
Weight: 0.16 LBS  
Scale: 1:4  
Last updated: 7/15/2015

56676

# Product & Packaging Specs

56676 Packing  
Item #: Case packing



Weight: 37 LBS  
Scale: 1:4  
Last updated: 7/15/2015

56676

V1.00 - Installation Instructions effective May 1, 2015 and reflects information that available as of April 10, 2014. This information is updated periodically and should not be relied upon after May 1, 2015. Please visit [www.OZCOBP.com](http://www.OZCOBP.com) to get current information



# Product & Packaging Specs

56676 Packing  
Item #: Pallet packing

Item #: **56676** | **P2B-LS-8F**  
8" POST TO BEAM FLUSH  
LAREDO SUNSET  
**PALLET** 180 pcs  
SKU#: **56876**  
Weight: 545 lbs  
LOT# Priority# OWT

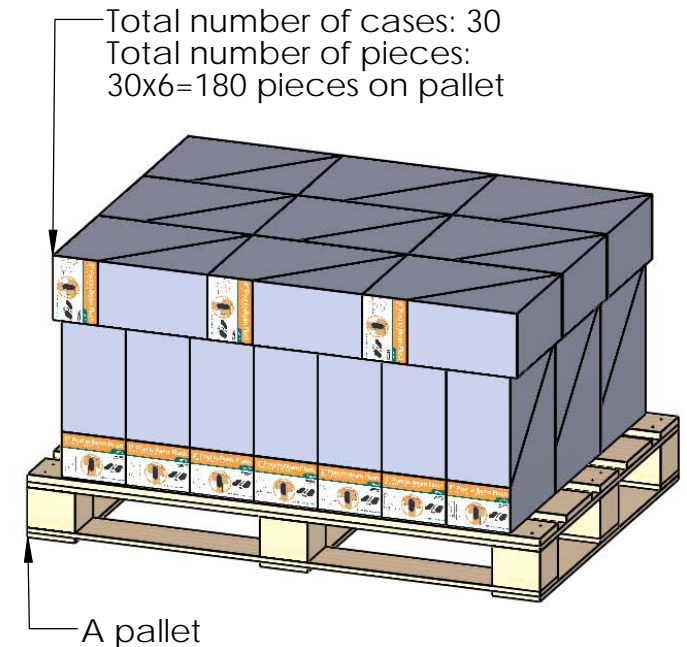
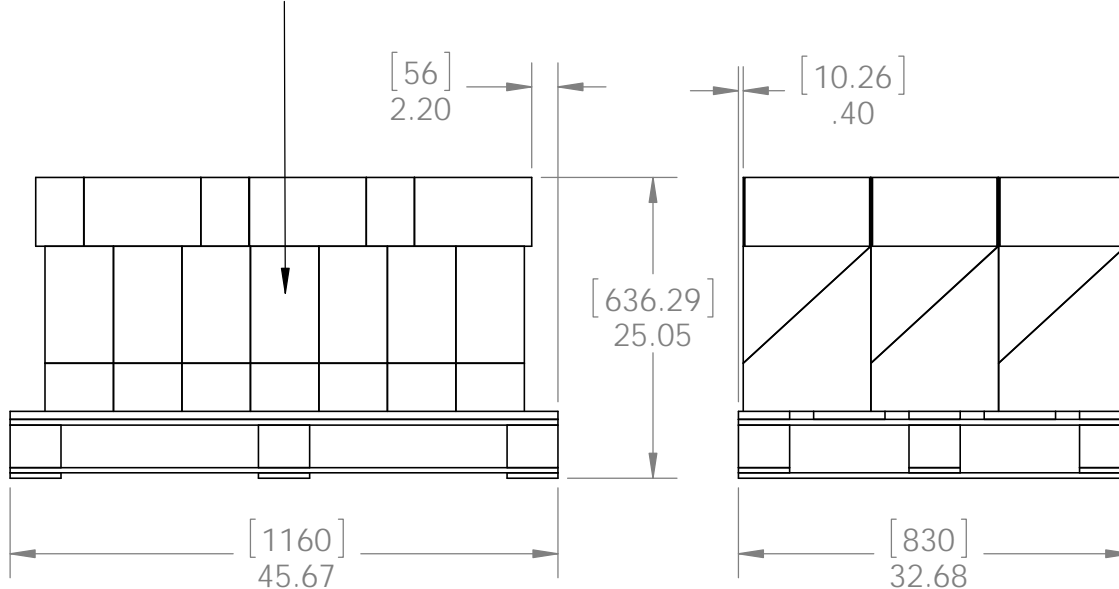

Total number of cases: 30  
Total number of pieces:  
30x6=180 pieces on pallet



additional pallet packing instructions  
plywood on top layer  
strap to pallet  
clear wrap around boxes

Weight: 545 LBS  
Scale: 1:16  
Last updated: 7/15/2015

56676