

Product & Packaging Specs

8" Post to Beam Coupler Laredo Sunset (P2B-SB-8)

Item #: 56677

ITEM NO.	QTY.	PART NUMBER	DESCRIPTION
1	1	56610-11	Ledge, Post to Beam
2	1	56677-11	Plate, 8" Post to Beam
3	0.08	56626	OWT Timber Screw 2-3/4"
4	2	56621	1 1/2" Hex Cap Nut

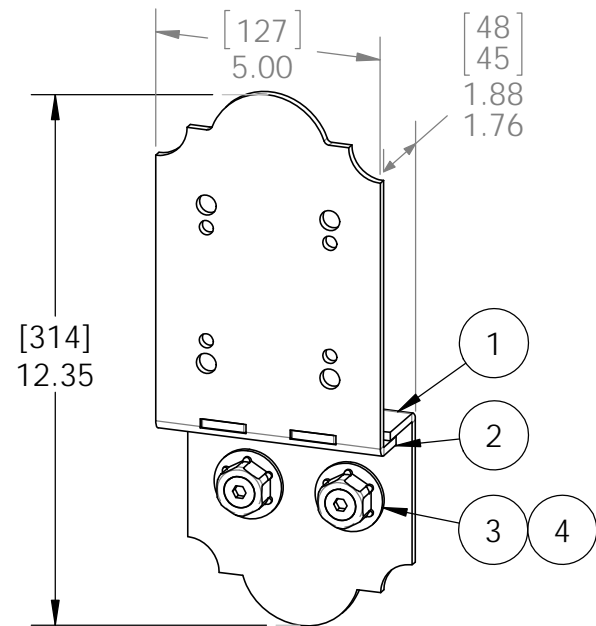
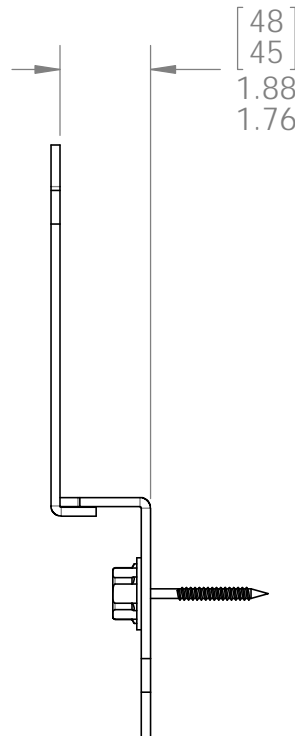
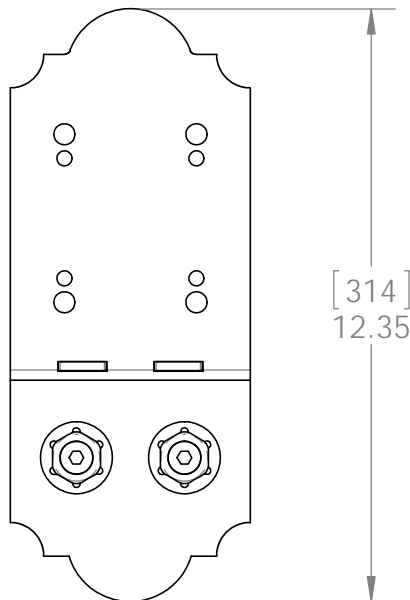
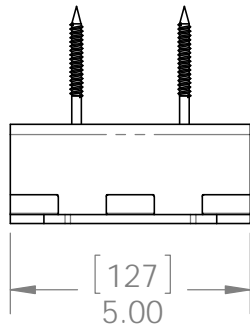

kit contains 2 assemblies

Weight: 3.61 LBS
 Scale: 1:4
 Last updated: 7/15/2015

Product & Packaging Specs

8" Post to Beam Coupler Laredo Sunset (P2B-SB-8)

Item #: 56677

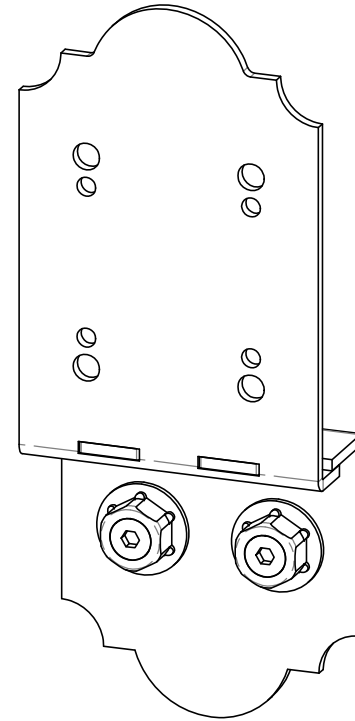
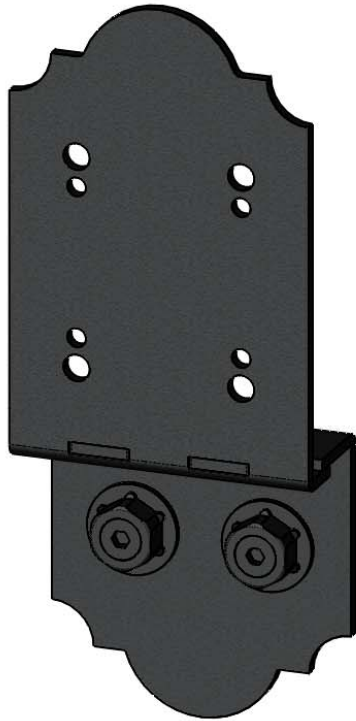

Weight: 3.61 LBS
Scale: 1:3
Last updated: 7/15/2015

56677

Product & Packaging Specs

8" Post to Beam Coupler Laredo Sunset (P2B-SB-8)

Item #: Typical Installation & Basic Assembly

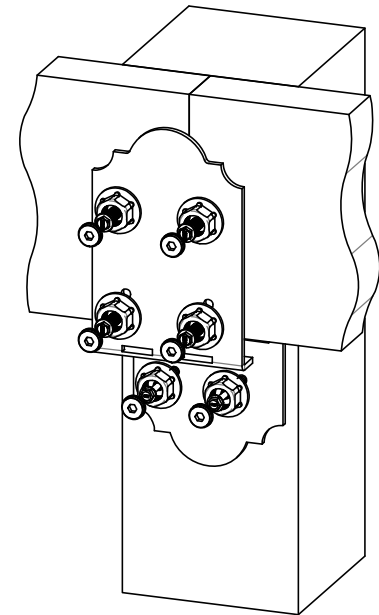
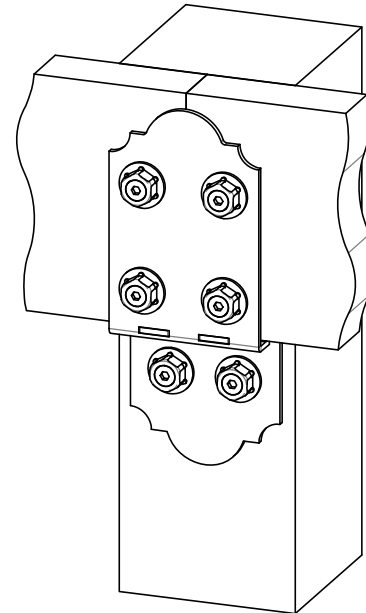
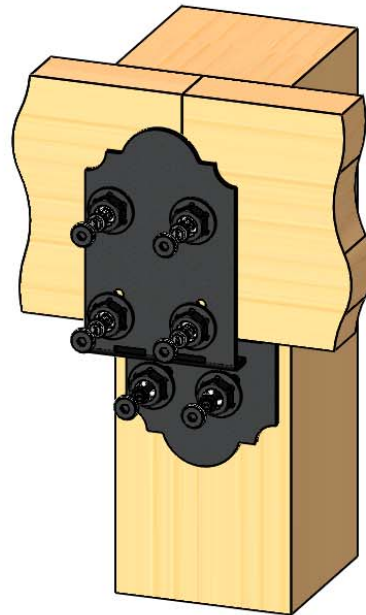
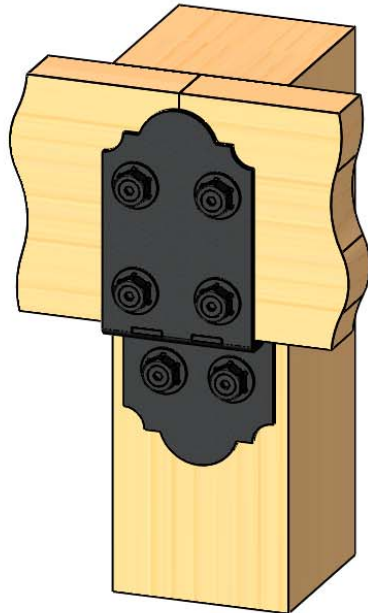

Scale: 1:6
Last updated: 7/15/2015

56677



OZCO BUILDING PRODUCTS

Product & Packaging Specs

Box, 56677

Item #: Box, 56677

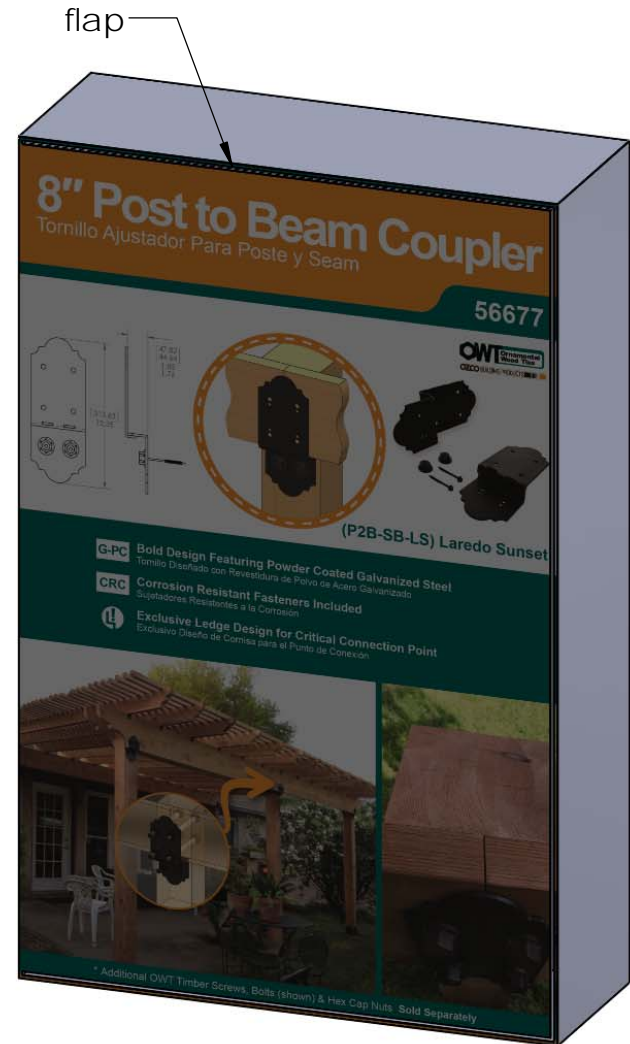
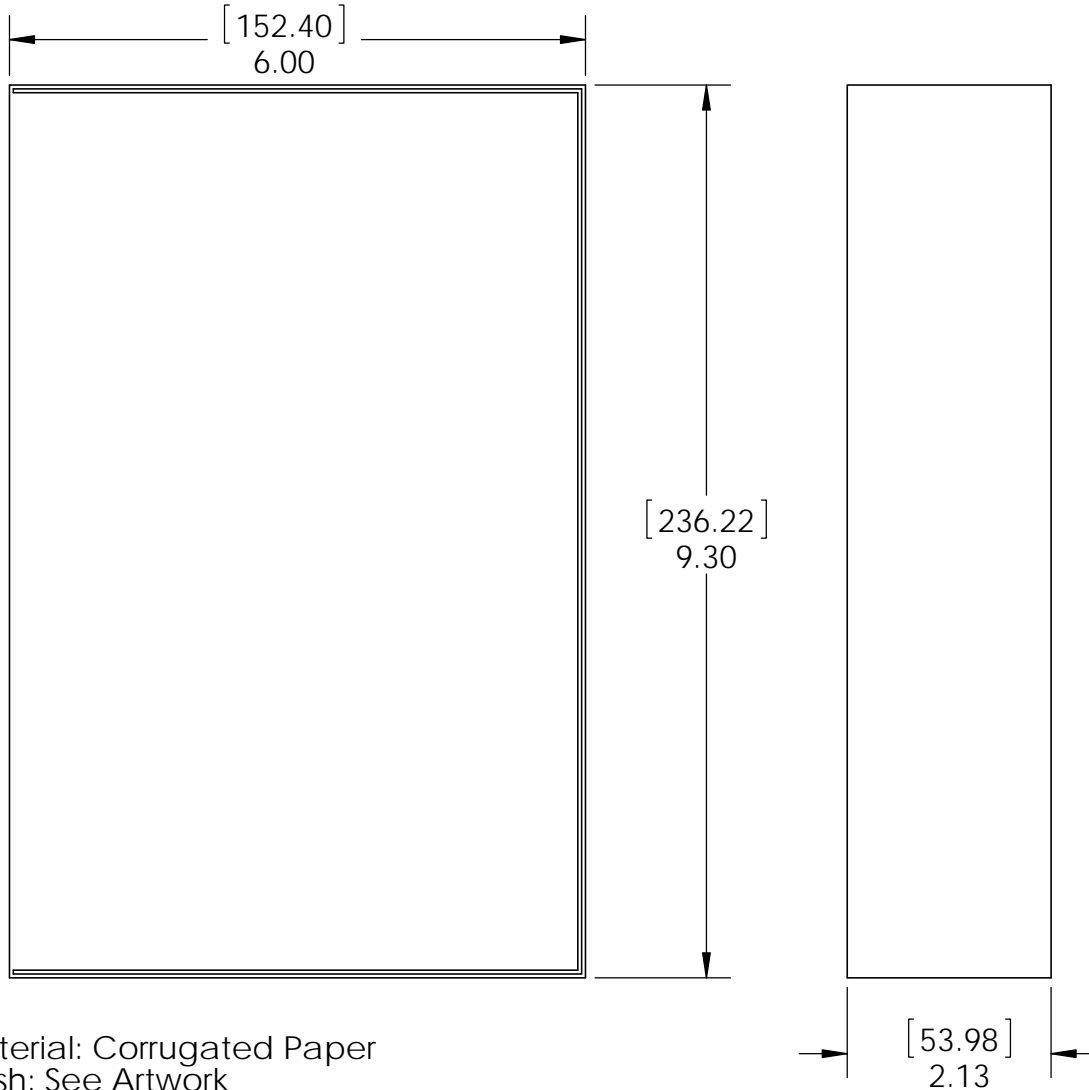

Material: Corrugated Paper
 Finish: See Artwork
 Weight: 0.04 LBS
 Scale: 1:2
 Last updated: 7/15/2015

56677

Product & Packaging Specs

56677 Packing
 Item #: Box packing

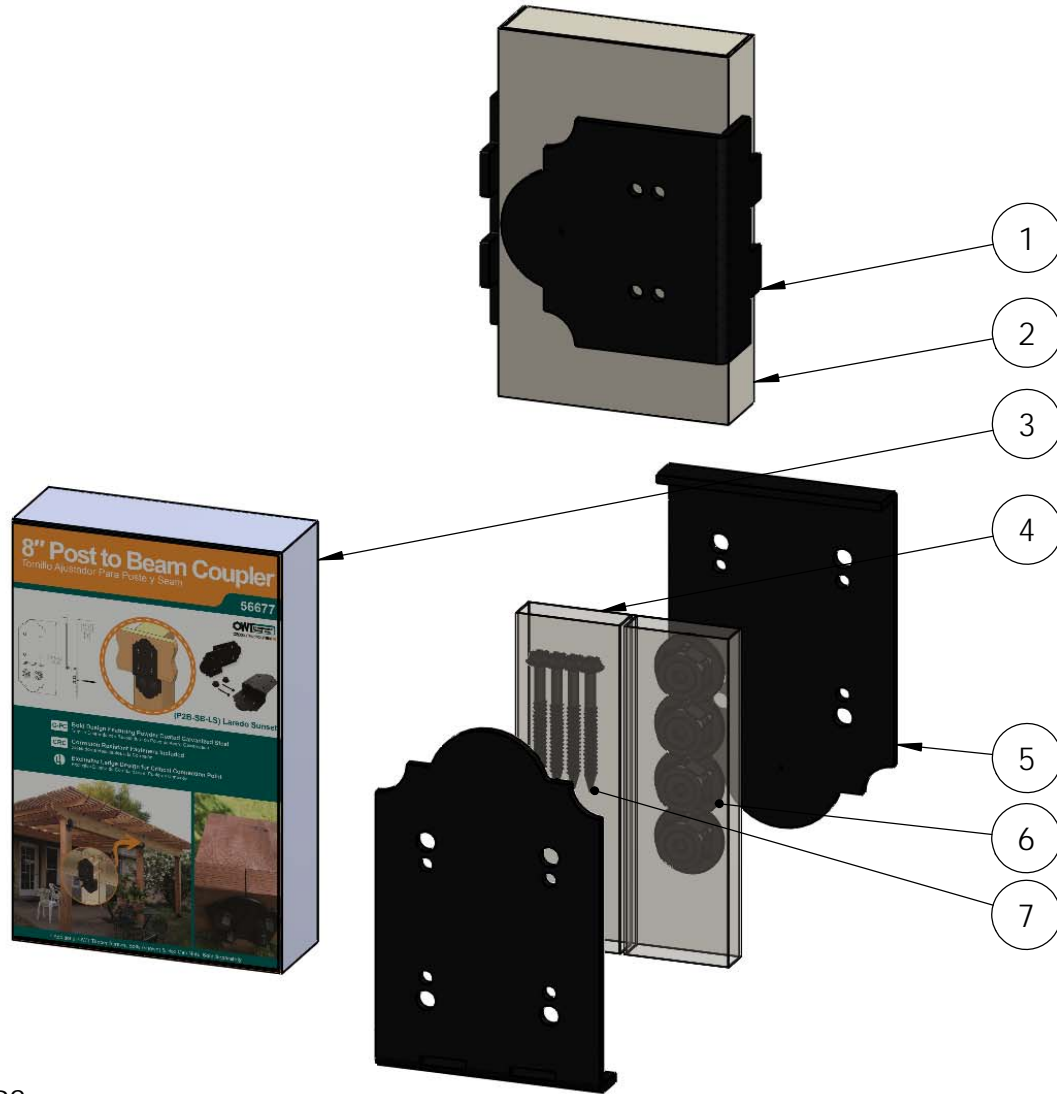

ITEM NO.	QTY.	PART NUMBER	DESCRIPTION
1	2	56610-11	Ledge, Post to Beam
2	1	Box, 56677 Inner	Box, 56677 Inner
3	1	Box, 56677	Box, 56677
4	1	Insert, 56677	Insert, 56677
5	2	56677-11	Plate, 8" Post to Beam
6	4	56621	1 1/2" Hex Cap Nut
7	0.16	56626	OWT Timber Screw 2-3/4"

Weight: 7.30 LBS
 Scale: 1:2
 Last updated: 7/15/2015

56677

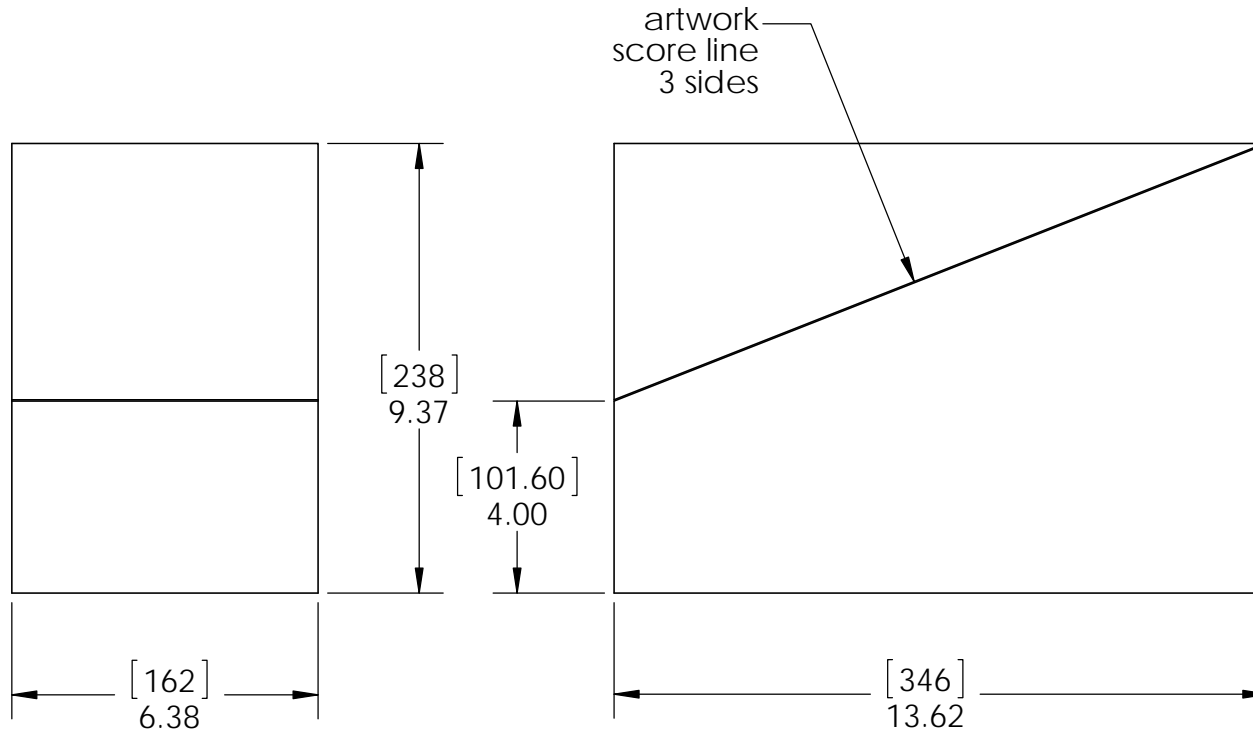

Material: Corrugated Paper
 Finish: Natural
 Weight: 0.24 LBS
 Scale: 1:4
 Last updated: 7/15/2015

56677

Product & Packaging Specs

56677 Packing

Item #: Case packing

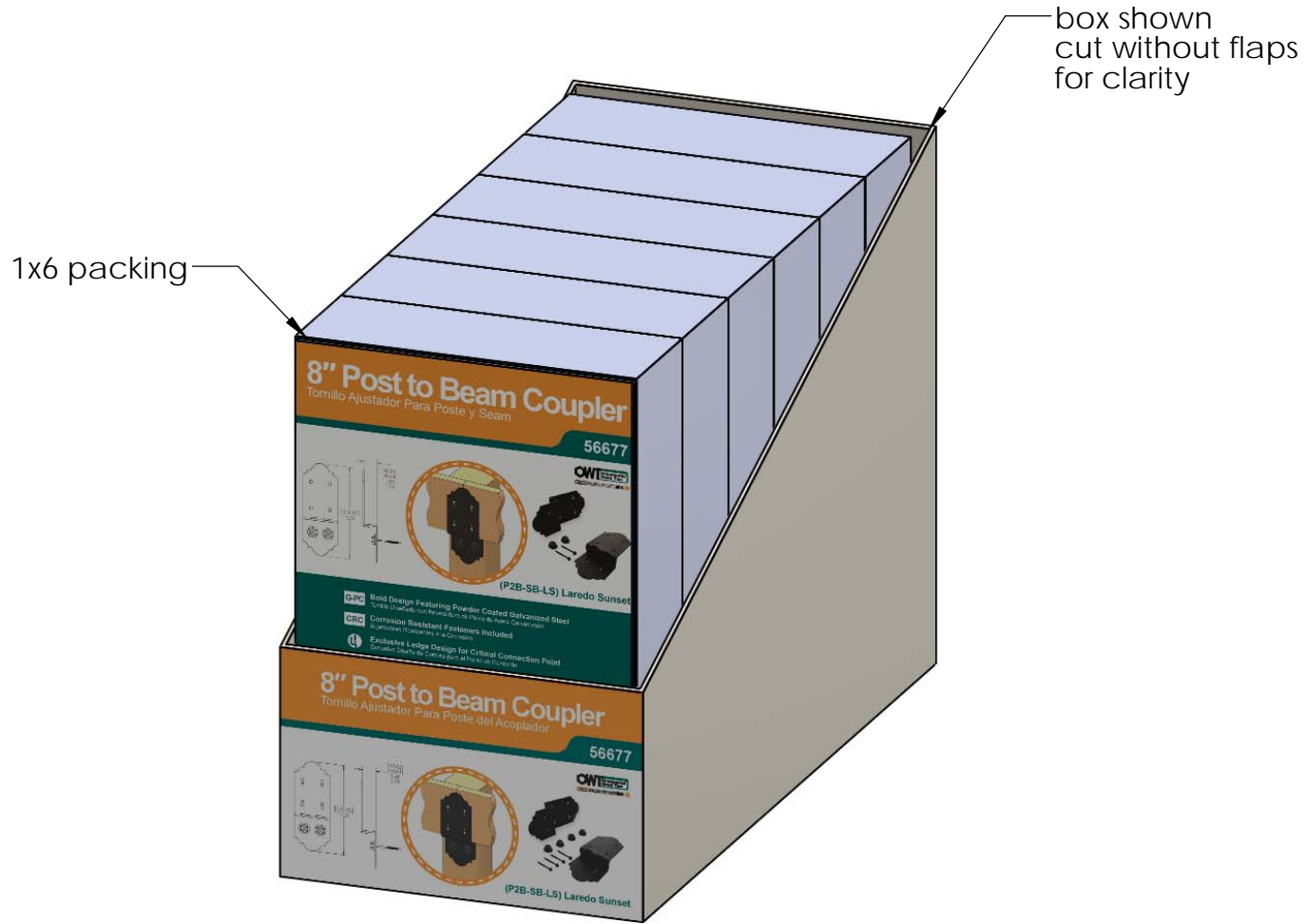

Weight: 45 LBS
 Scale: 1:3
 Last updated: 7/15/2015

56677

Item #: **56677** | **P2B-SB-8**
8" POST TO BEAM COUPLER
LAREDO SUNSET
PALLET **168 pcs**
 SKU#: **56877**
 Weight: **600 lbs**
 LOT# _____ Priority# _____ **OWT**

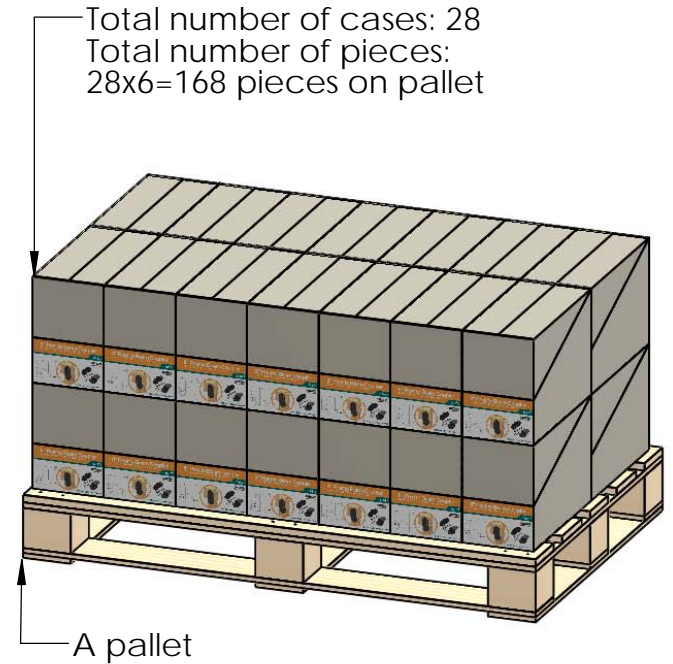
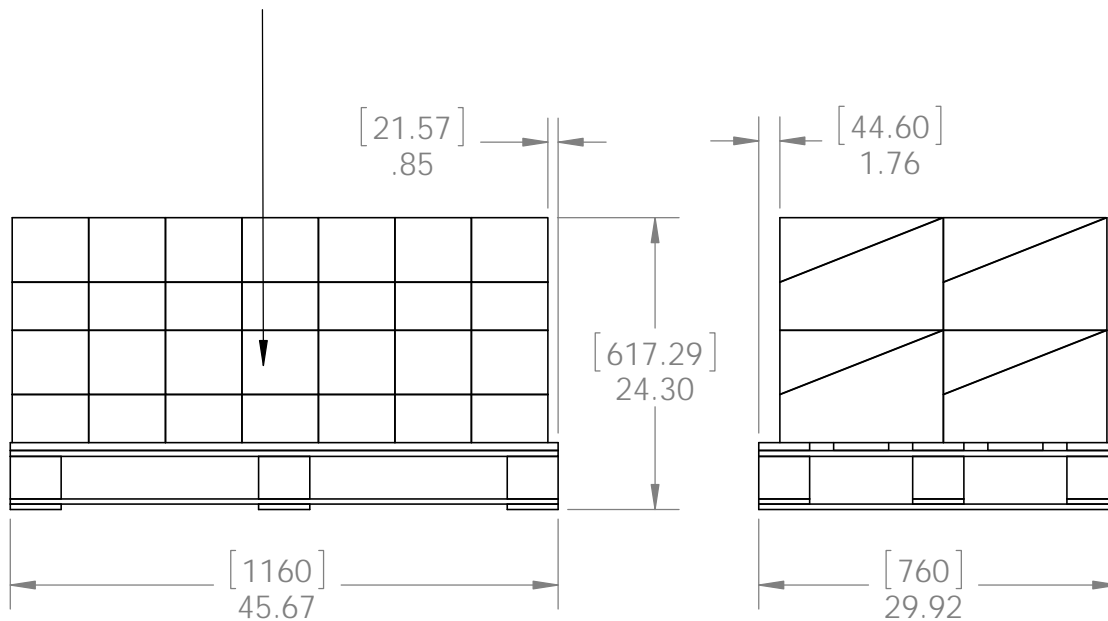

additional pallet packing instructions
 plywood on top layer
 strap to pallet
 clear wrap around boxes

Weight: 600 LBS
 Scale: 1:16
 Last updated: 7/15/2015

56677