

## Installation Instructions

### Hex Cap Nuts (56621) & Dome Cap Nuts (56622)

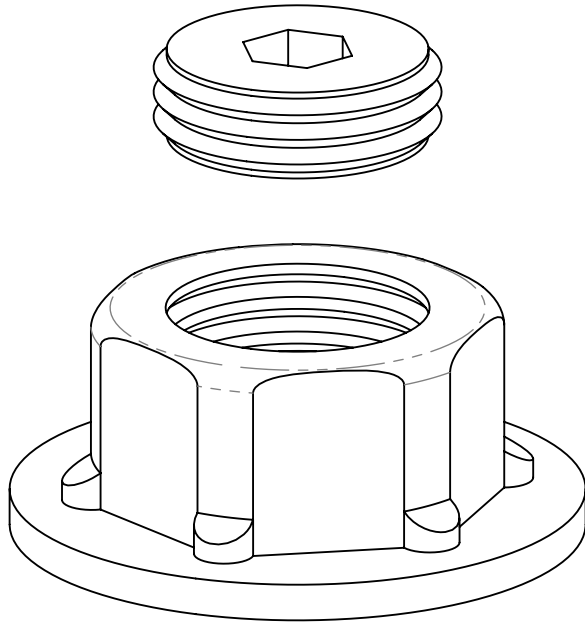

56621  
Hex Cap Nuts  
(10 per package)

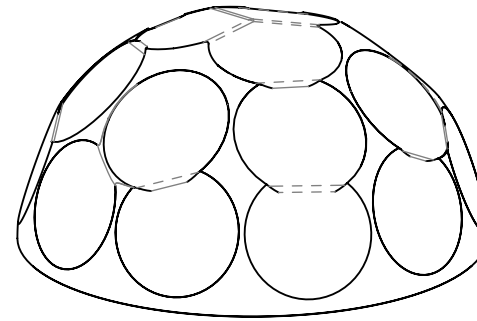

56622  
Dome Cap Nuts  
(10 per package)

Both Cap Nuts function the same.  
Hex Cap Nuts are standard on many products.  
Dome Cap Nuts are standard on hinges, but  
are suitable for use in place of Hex Cap Nuts  
for decorative applications.  
Both shown in exploded view



**OZCO** BUILDING PRODUCTS

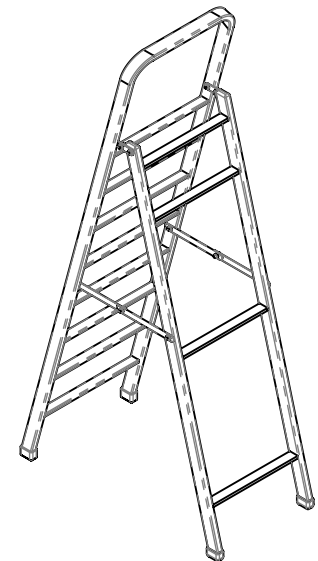
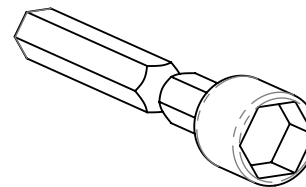
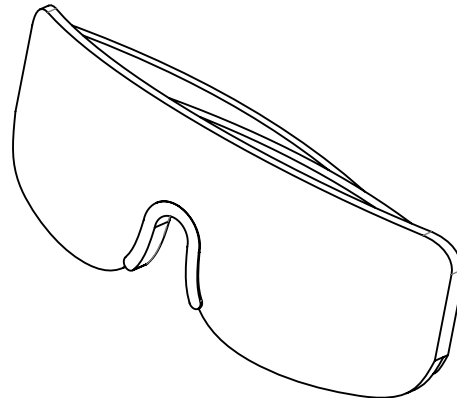
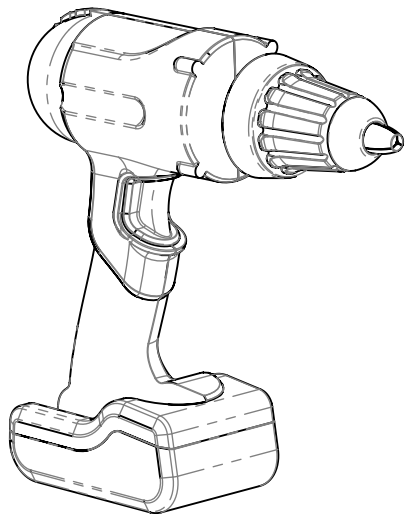

## Suggested Tools

(others may be required)

Installation Instructions, Cap Nuts

V1.00 - Installation Instructions effective May 1, 2015 and reflects information that available as of April 10, 2014. This information is updated periodically and should not be relied upon after May 1, 2015. Please visit [www.OZCOBP.com](http://www.OZCOBP.com) to get current information

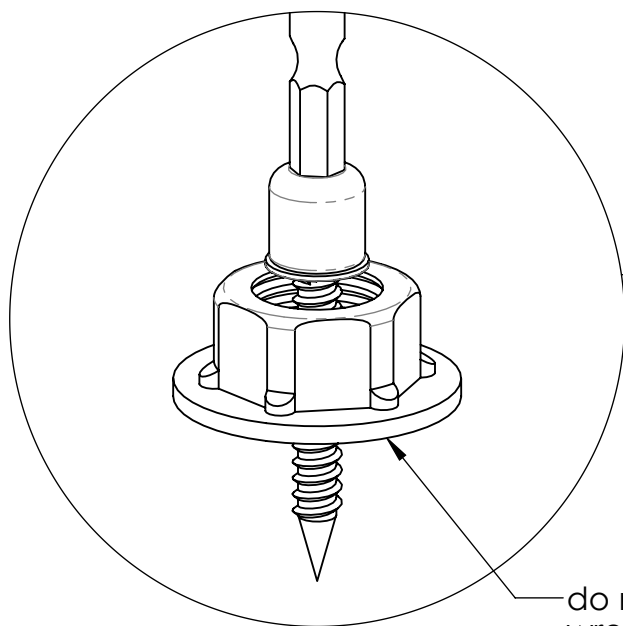
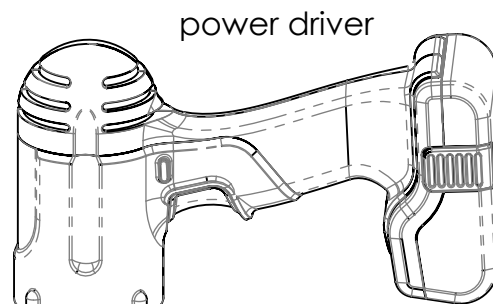
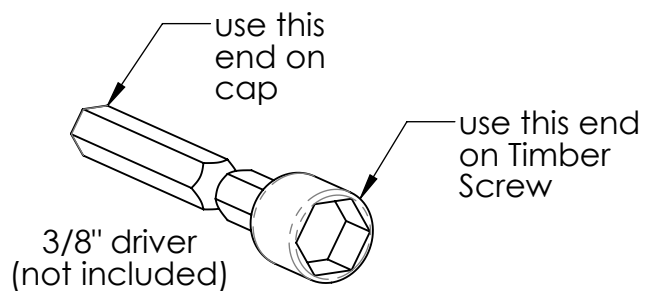

step 1  
securing  
Timber Screw  
(not included)

do not use  
wrench on nut

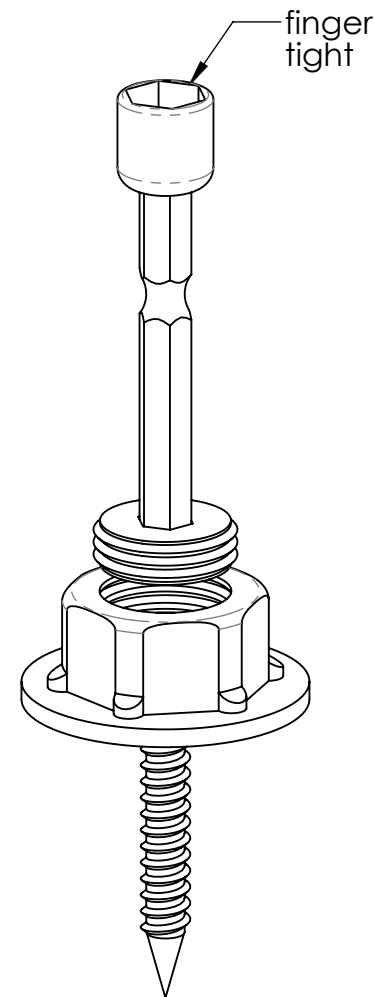

step 2  
securing  
Cap

## Hex Cap Nut Installation

Installation Instructions, Cap Nuts

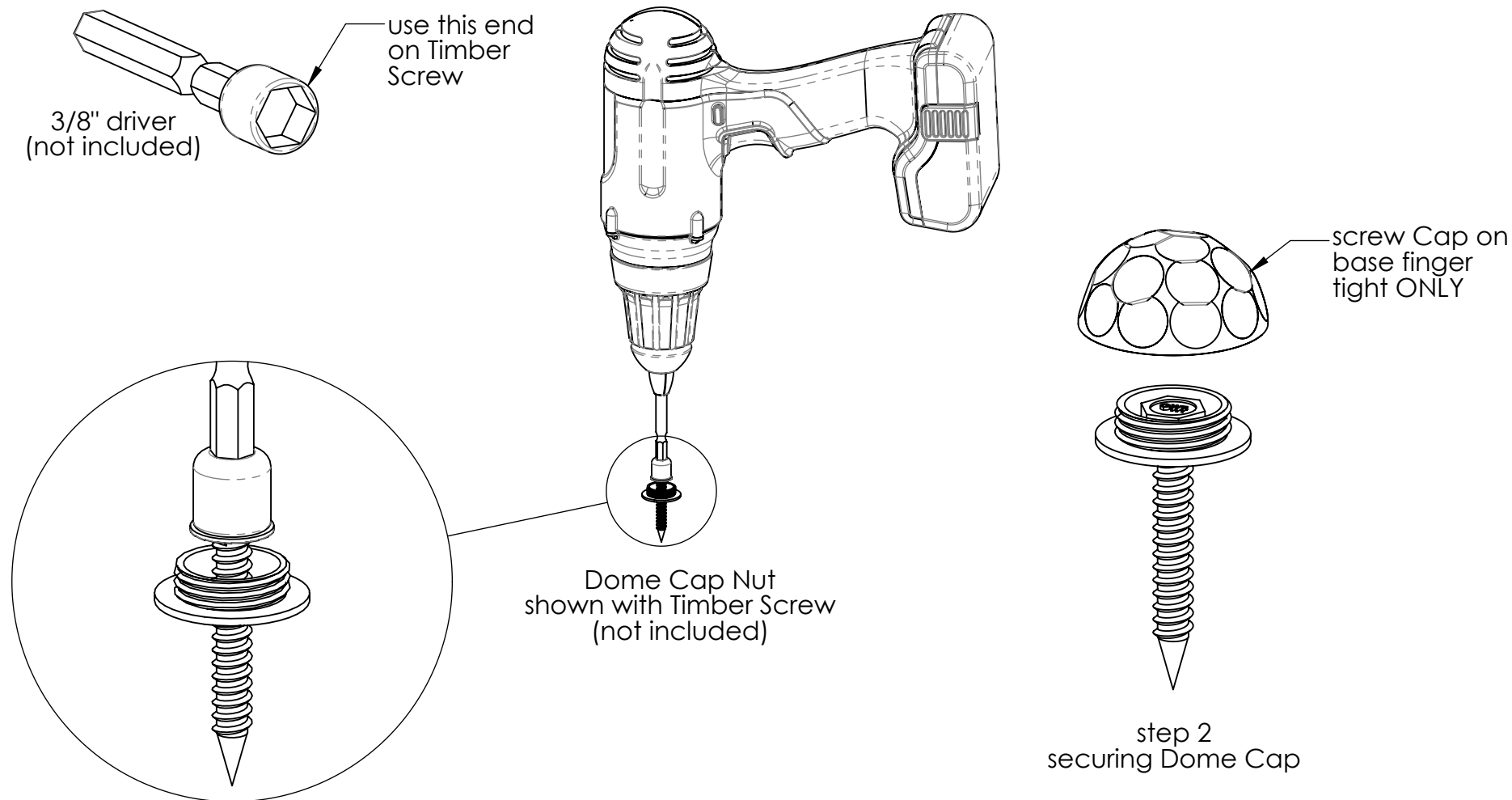

## Dome Cap Nut Installation

Installation Instructions, Cap Nuts

V1.00 - Installation Instructions effective May 1, 2015 and reflects information that available as of April 10, 2014. This information is updated periodically and should not be relied upon after May 1, 2015. Please visit [www.OZCOBP.com](http://www.OZCOBP.com) to get current information

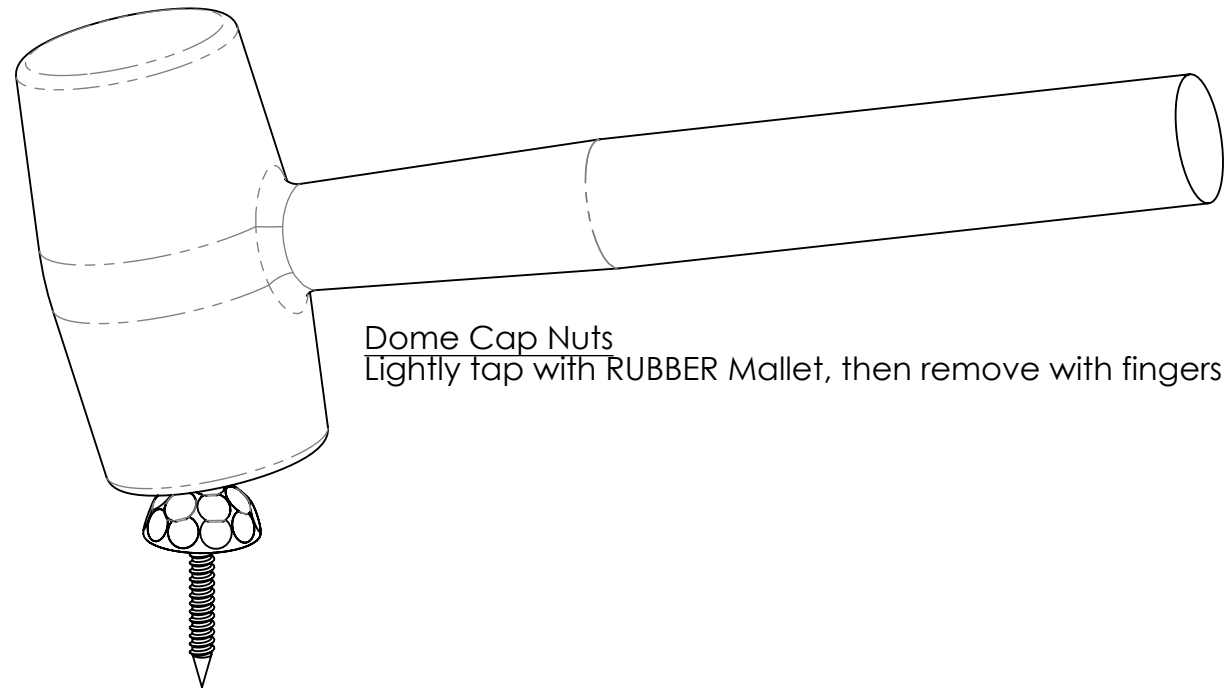
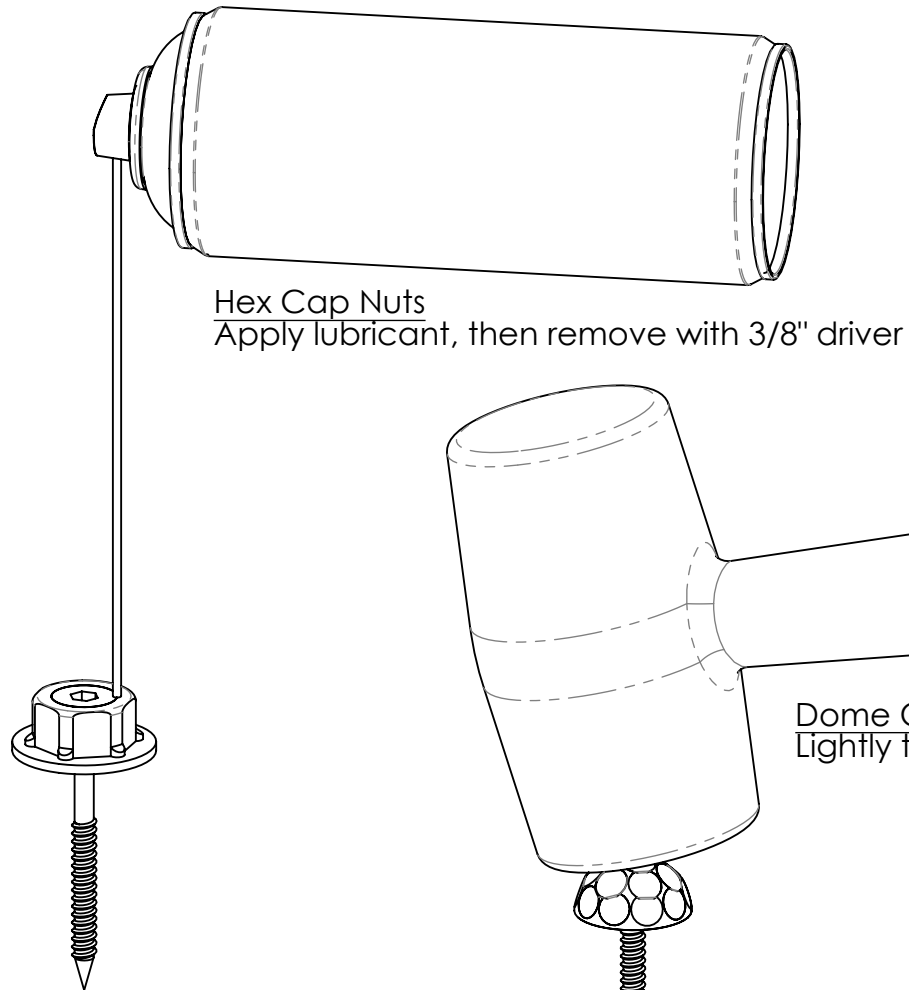

## Disassembly if Cap/Dome is hard to remove

Installation Instructions, Cap Nuts

V1.00 - Installation Instructions effective May 1, 2015 and reflects information that available as of April 10, 2014. This information is updated periodically and should not be relied upon after May 1, 2015. Please visit [www.OZCOBP.com](http://www.OZCOBP.com) to get current information