

## Installation Instructions, OWT Timber Bolts

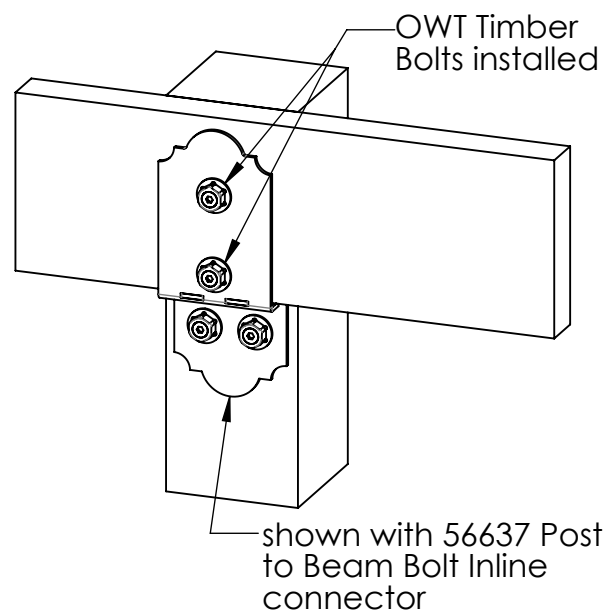

**OZCO** BUILDING PRODUCTS



Timber Bolts may be installed as standalone fastener or with many OZCO connector options

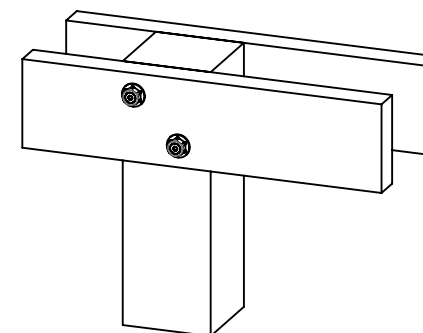
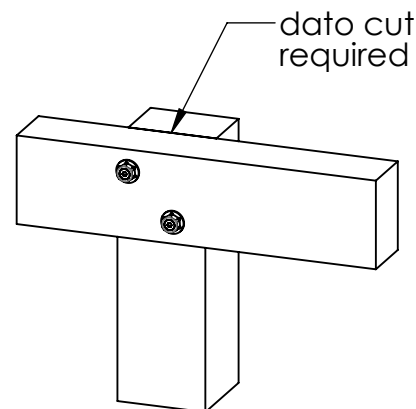
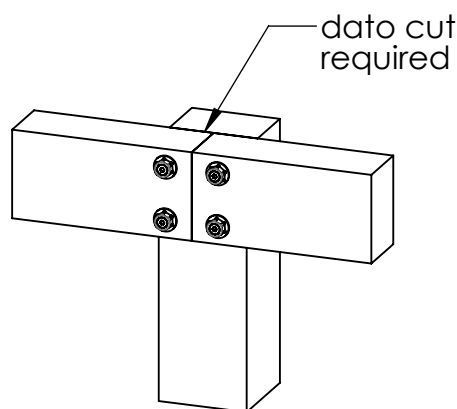
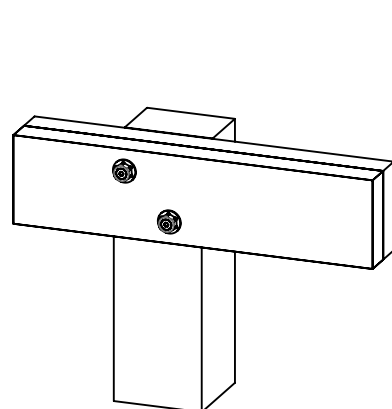
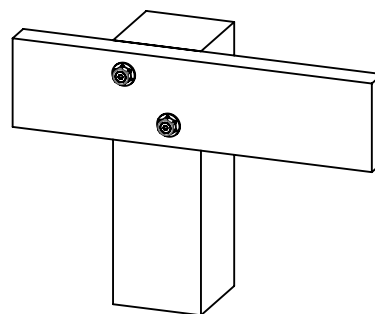

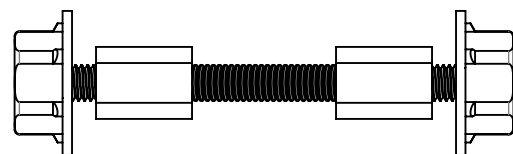

Assembly, OWT Timber Bolt 4-6"  
56649-10

[101-152] 4-6"

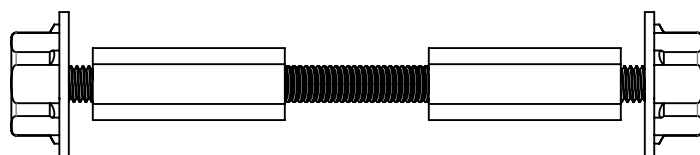

Assembly, OWT Timber Bolt 6-8"  
56650-10

[152-203] 6-8"

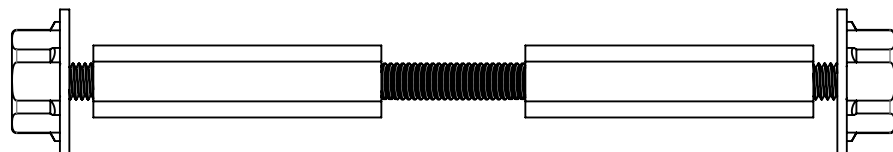

Assembly, OWT Timber Bolt 8-10"  
56651-10

[203-254] 8-10"

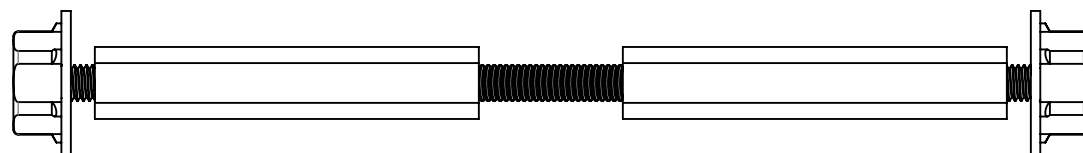

Assembly, OWT Timber Bolt 10-12"  
56652-10

[254-304] 10-12"

[19.05]  
Ø .75

[15.88]  
.63



[38.10]  
Ø 1.50

[25.40]  
1.00

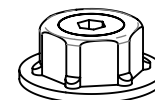
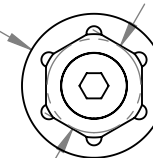

[15.24]  
Ø .60



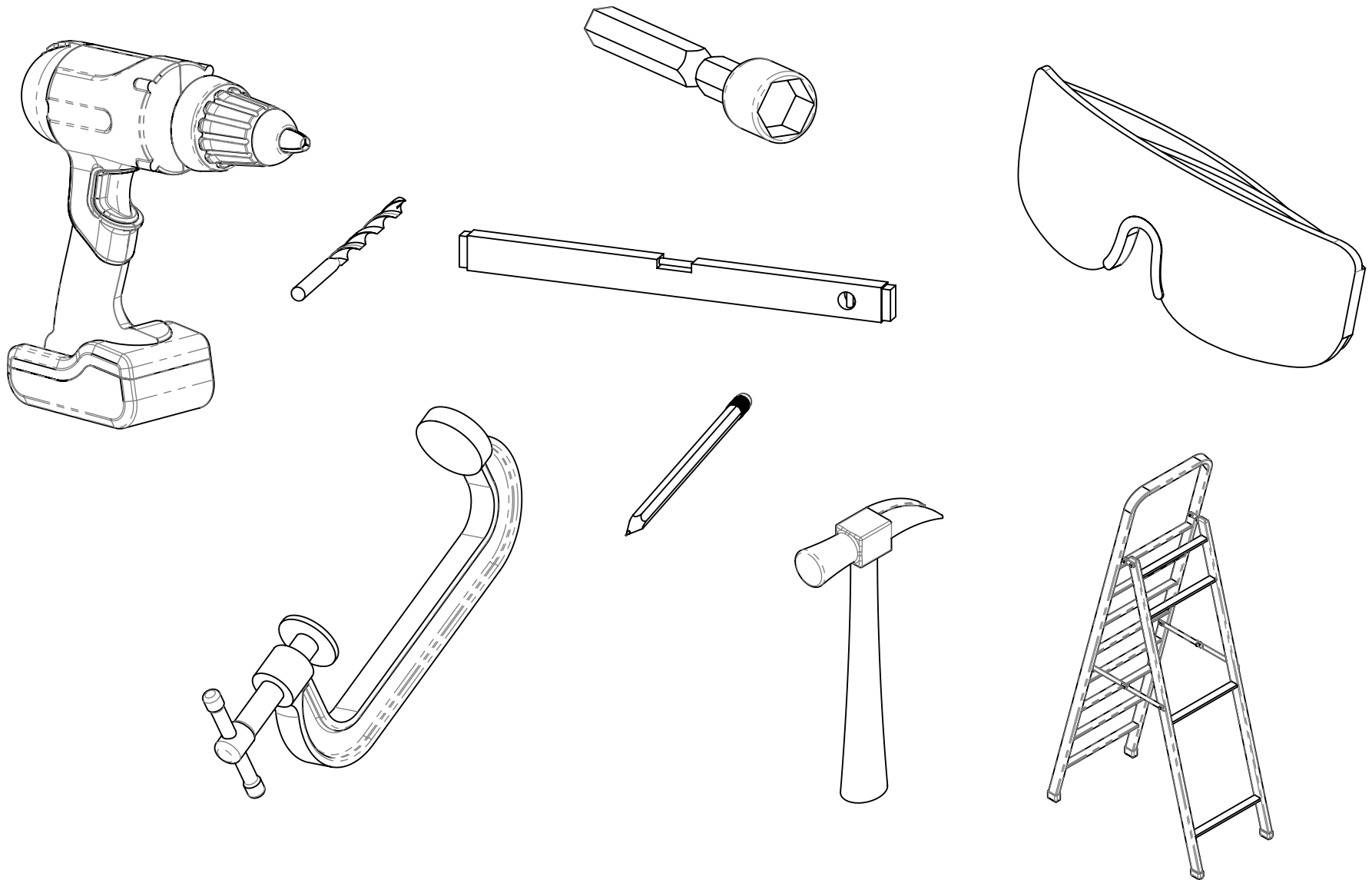

## Suggested Tools

(others may be required)

Installation Instructions, OWT Timber Bolts

V1.00 - Installation Instructions effective May 1, 2015 and reflects information that available as of April 10, 2014. This information is updated periodically and should not be relied upon after May 1, 2015. Please visit [www.OZCOBP.com](http://www.OZCOBP.com) to get current information

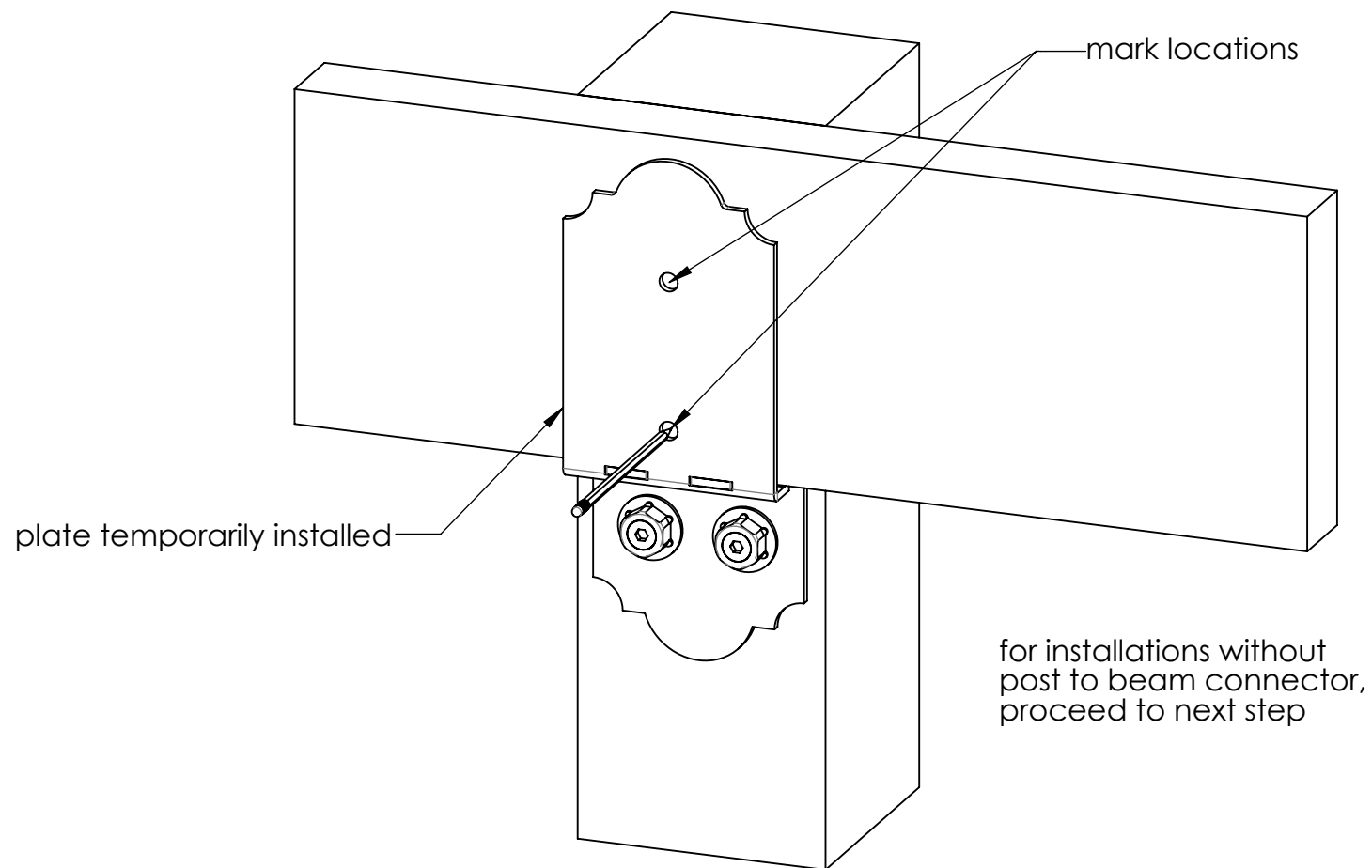

## step 1

### Installation Instructions, OWT Timber Bolts

V1.00 - Installation Instructions effective May 1, 2015 and reflects information that available as of April 10, 2014. This information is updated periodically and should not be relied upon after May 1, 2015. Please visit [www.OZCOBP.com](http://www.OZCOBP.com) to get current information

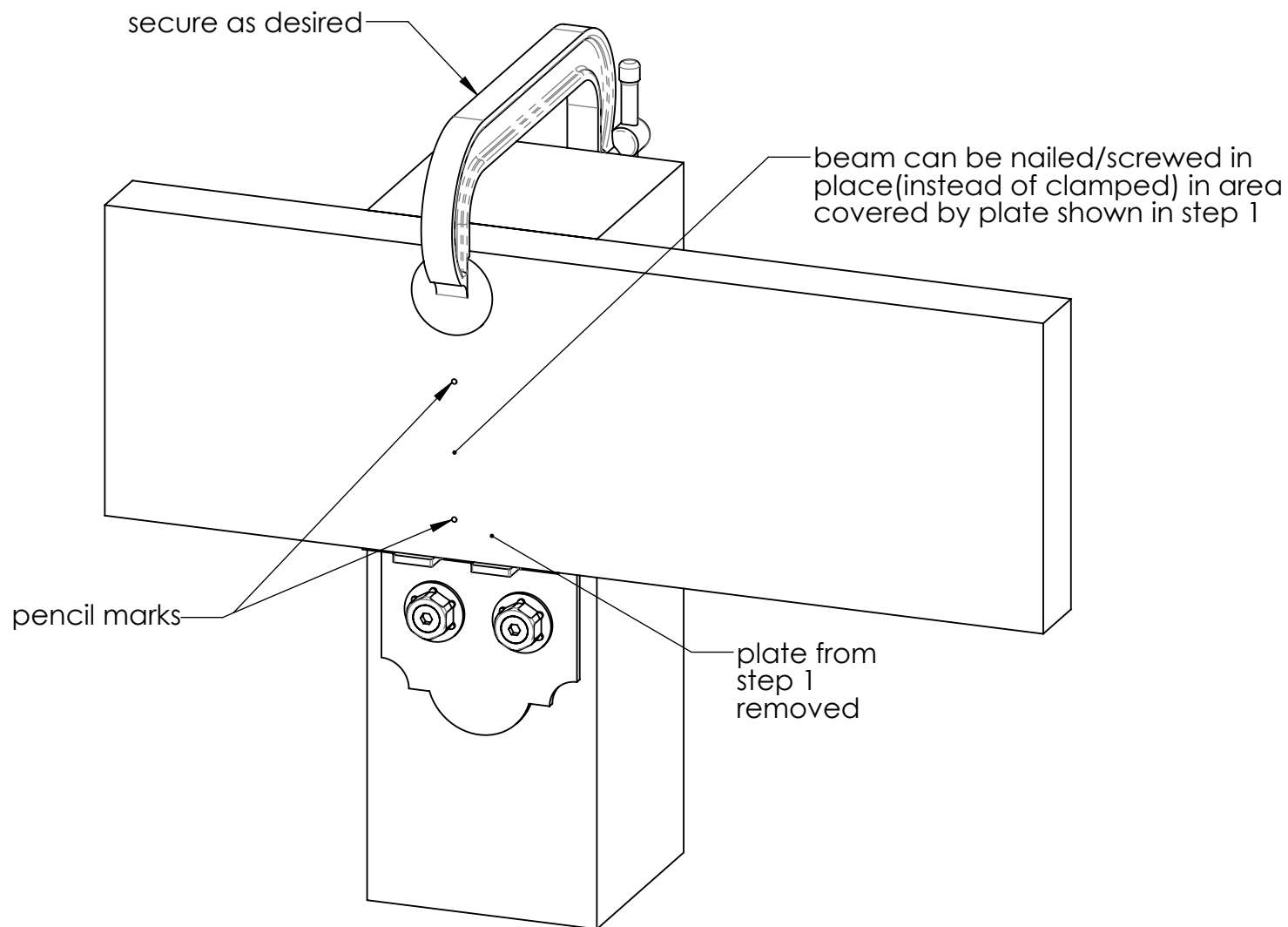

## step 2

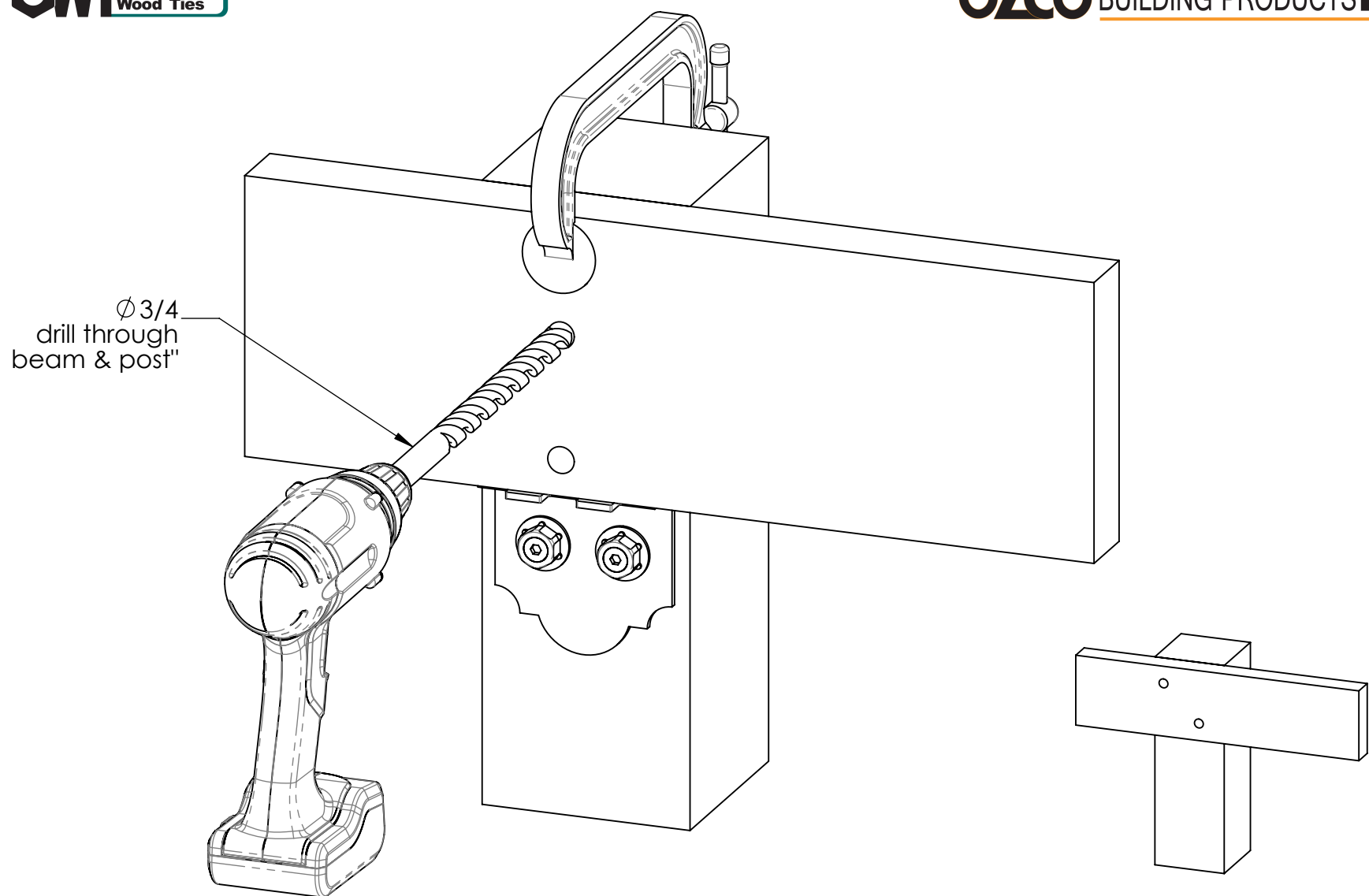

installation example  
without post to beam  
connector

## step 3

Installation Instructions, OWT Timber Bolts

V1.00 - Installation Instructions effective May 1, 2015 and reflects information that available as of April 10, 2014. This information is updated periodically and should not be relied upon after May 1, 2015. Please visit [www.OZCOBP.com](http://www.OZCOBP.com) to get current information

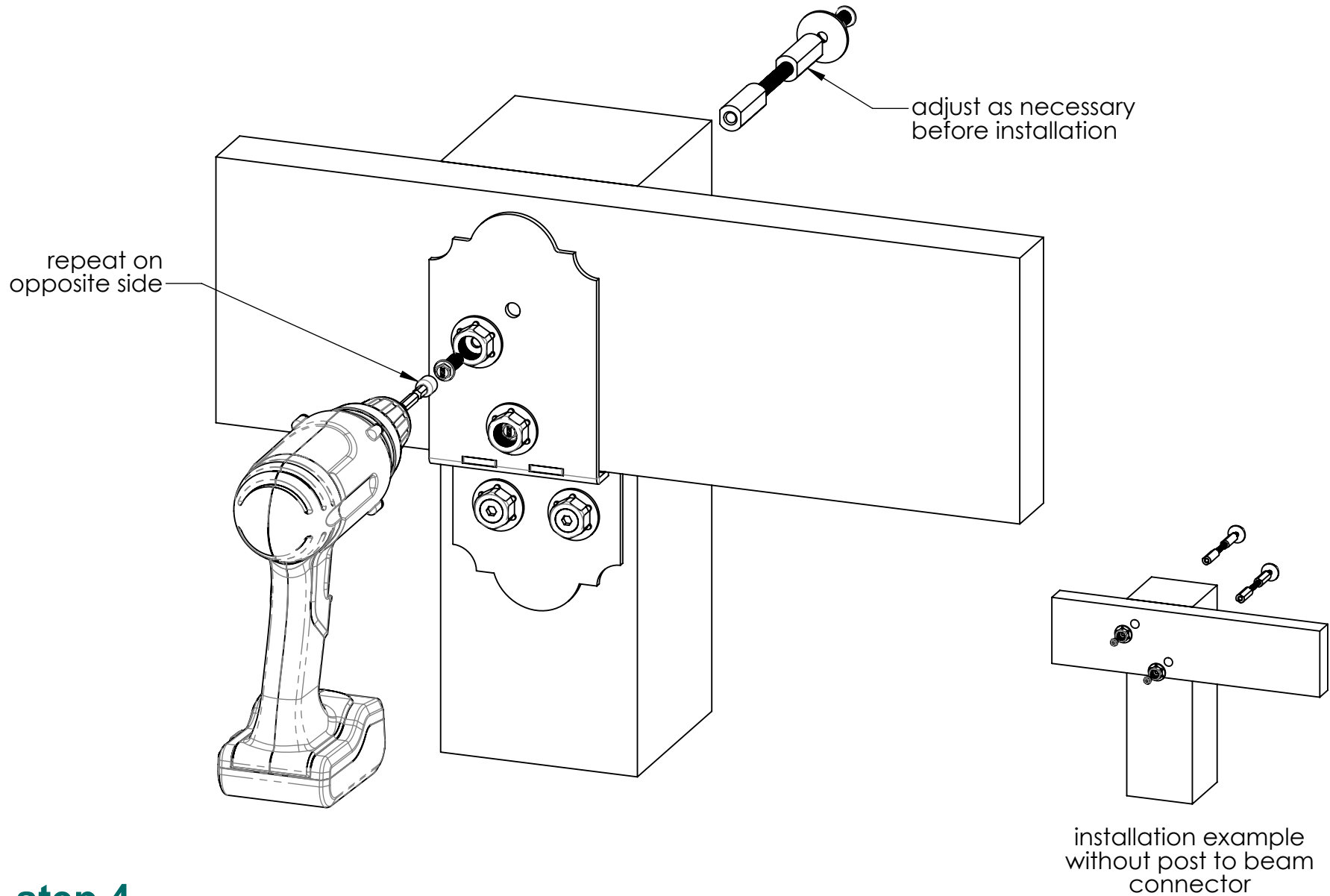

## step 4

Installation Instructions, OWT Timber Bolts

V1.00 - Installation Instructions effective May 1, 2015 and reflects information that available as of April 10, 2014. This information is updated periodically and should not be relied upon after May 1, 2015. Please visit [www.OZCOBP.com](http://www.OZCOBP.com) to get current information

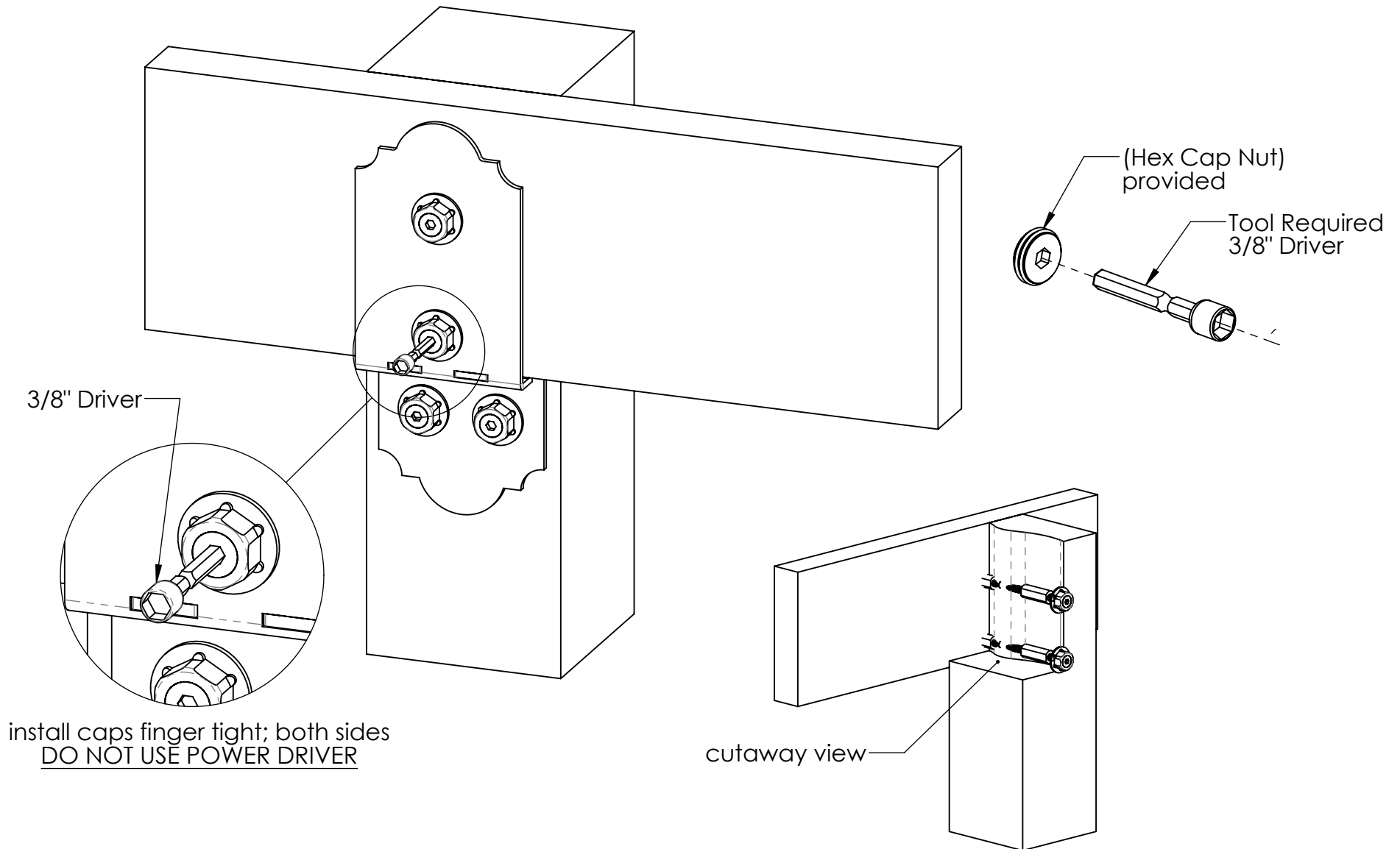

## step 5