

Product & Packaging Specs

OWT Timber Bolt

OWT Timber Bolt 4-6"
56649

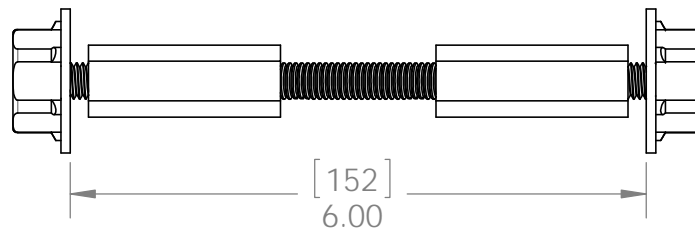
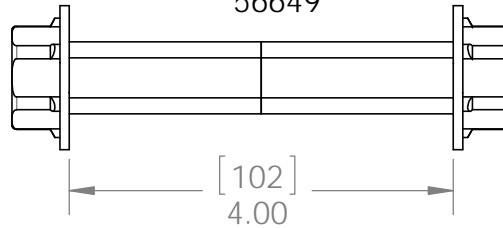

OWT Timber Bolt 6-8"
56650

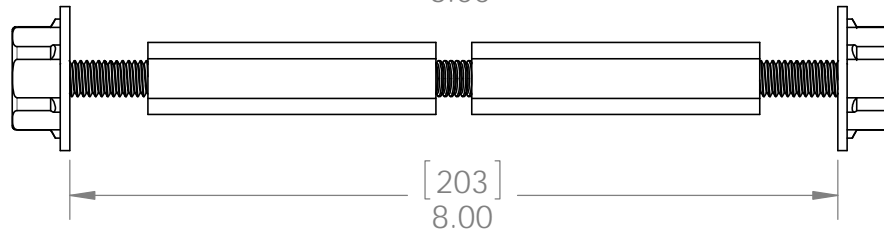
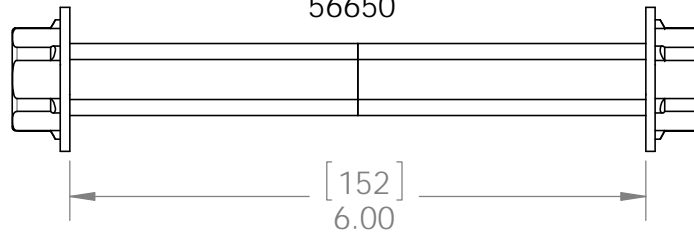



OZCO BUILDING PRODUCTS

Product & Packaging Specs

OWT Timber Bolt

OWT Timber Bolt 8-10"
56651

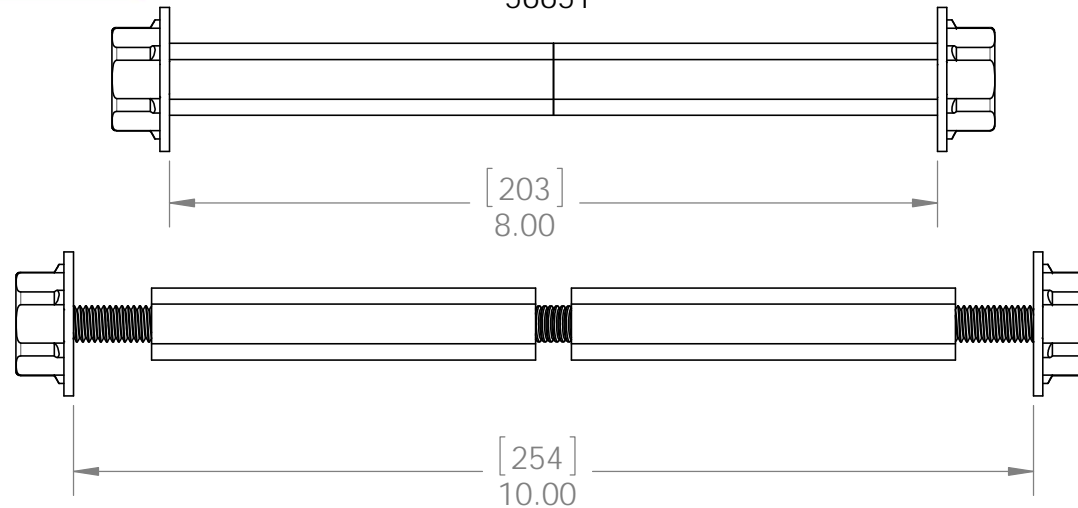

OWT Timber Bolt 10-12"
56652

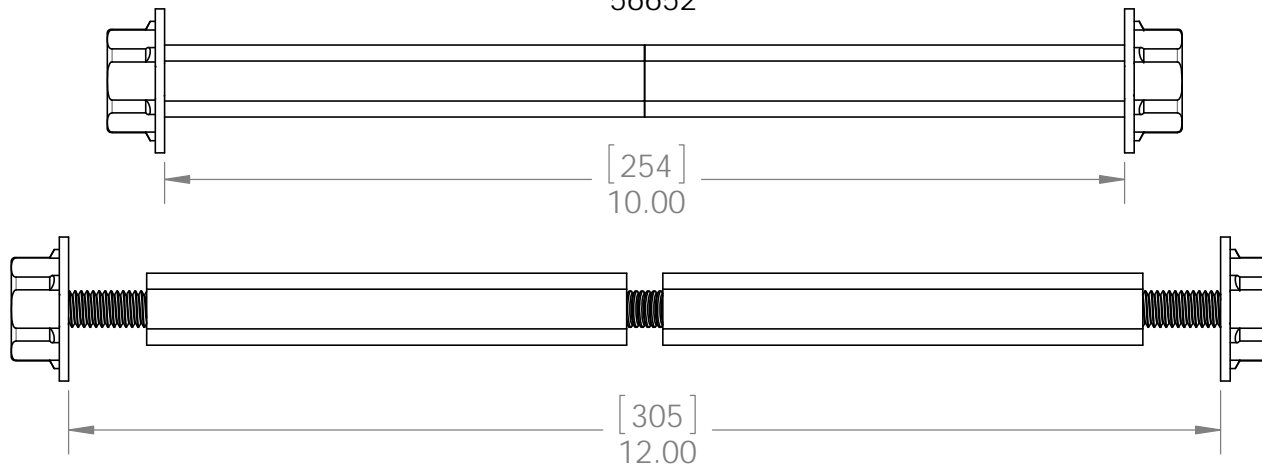

Scale: 1:4
Last updated: 7/13/2015
OWT Timber Bolts

V1.00 - Installation Instructions effective May 1, 2015 and reflects information that available as of April 10, 2014. This information is updated periodically and should not be relied upon after May 1, 2015. Please visit www.OZCOBP.com to get current information

Product & Packaging Specs

OWT Timber Bolt



OWT Timber Bolt 4-6"
56649



OWT Timber Bolt 6-8"
56650



OWT Timber Bolt 8-10"
56651



OWT Timber Bolt 10-12"
56652

Scale: 1:1
Last updated: 7/13/2015
OWT Timber Bolts

Product & Packaging Specs

OWT Timber Bolt 4-6"

Item #: 56649

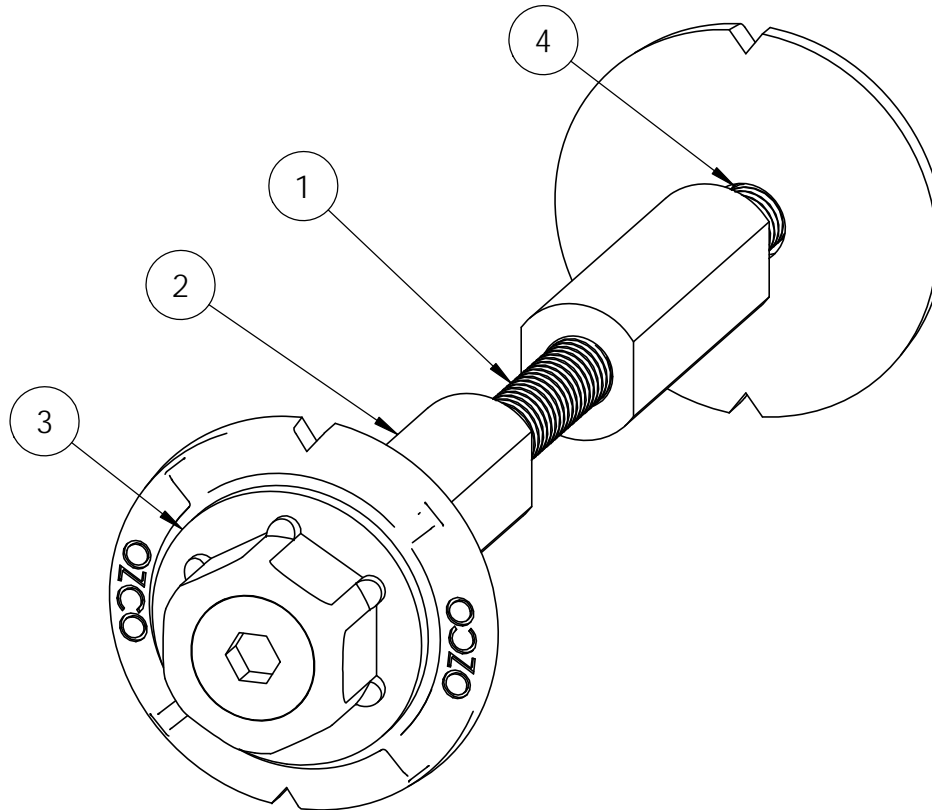

| ITEM NO. | QTY. | PART NUMBER | DESCRIPTION |
|----------|------|-------------|-------------------------------|
| 1 | 1 | 80115 | Stud, 3/8-16 x 2-1/2" |
| 2 | 2 | 80150-10 | Connector, OWT Thru Bolt 1.5" |
| 3 | 2 | 56621 | 1 1/2" Hex Cap Nut |
| 4 | 2 | 80110 | Bolt, Hex 3/8-16 x 1" |

Weight: 0.68 LBS
Scale: 1:1
Last updated: 7/13/2015

OWT Timber Bolts

Product & Packaging Specs

OWT Timber Bolt 6-8"

Item #: 56650

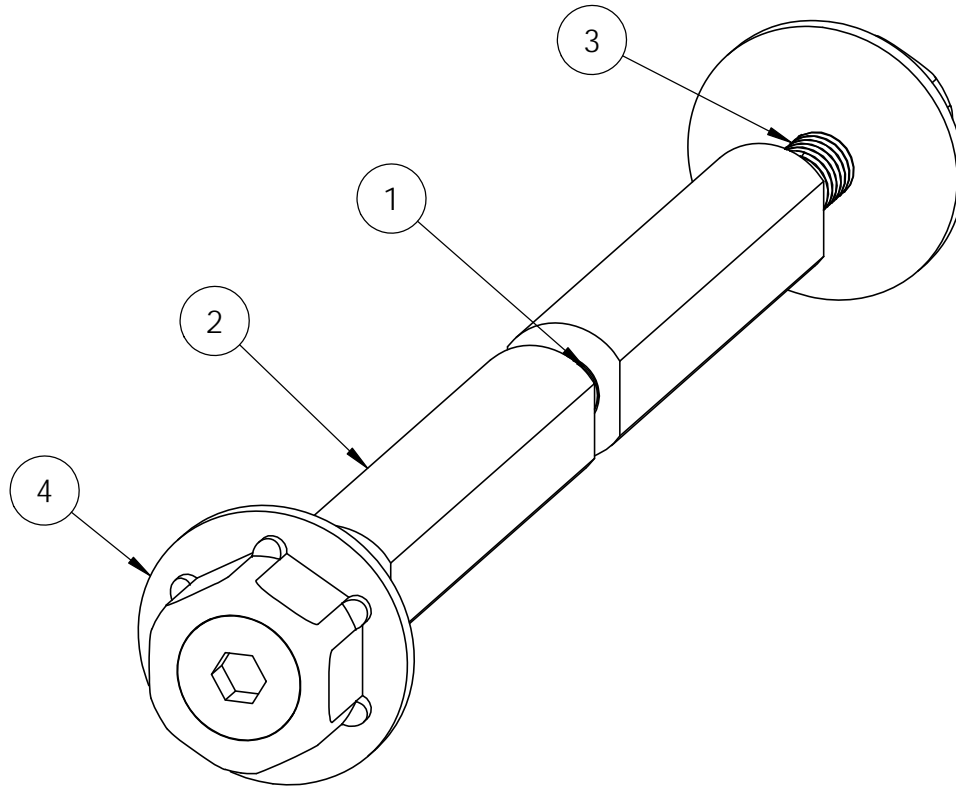

| ITEM NO. | QTY | PART NUMBER | DESCRIPTION |
|----------|-----|-------------|-------------------------------|
| 1 | 1 | 80115 | Stud, 3/8-16 x 2-1/2" |
| 2 | 2 | 80150-20 | Connector, OWT Thru Bolt 2.5" |
| 3 | 2 | 80110 | Bolt, Hex 3/8-16 x 1" |
| 4 | 2 | 56621 | 1 1/2" Hex Cap Nut |

Weight: 0.42 LBS
Scale: 1:1
Last updated: 7/13/2015

OWT Timber Bolts

Product & Packaging Specs

OWT Timber Bolt 8-10"

Item #: 0.500000

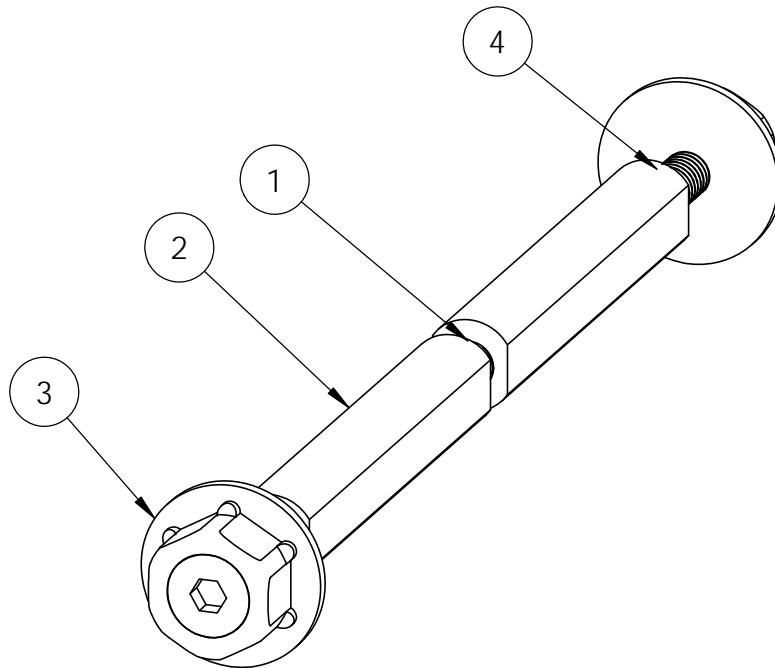

| ITEM NO. | QTY. | PART NUMBER | DESCRIPTION |
|----------|------|-------------|-------------------------------|
| 1 | 1 | 80115 | Stud, 3/8-16 x 2-1/2" |
| 2 | 2 | 80150-30 | Connector, OWT Thru Bolt 3.5" |
| 3 | 2 | 56621 | 1 1/2" Hex Cap Nut |
| 4 | 2 | 80110 | Bolt, Hex 3/8-16 x 1" |

Weight: 0.48 LBS
Scale: 1:1.5
Last updated: 7/13/2015

OWT Timber Bolts

Product & Packaging Specs

OWT Timber Bolt 10-12"

Item #: 56652

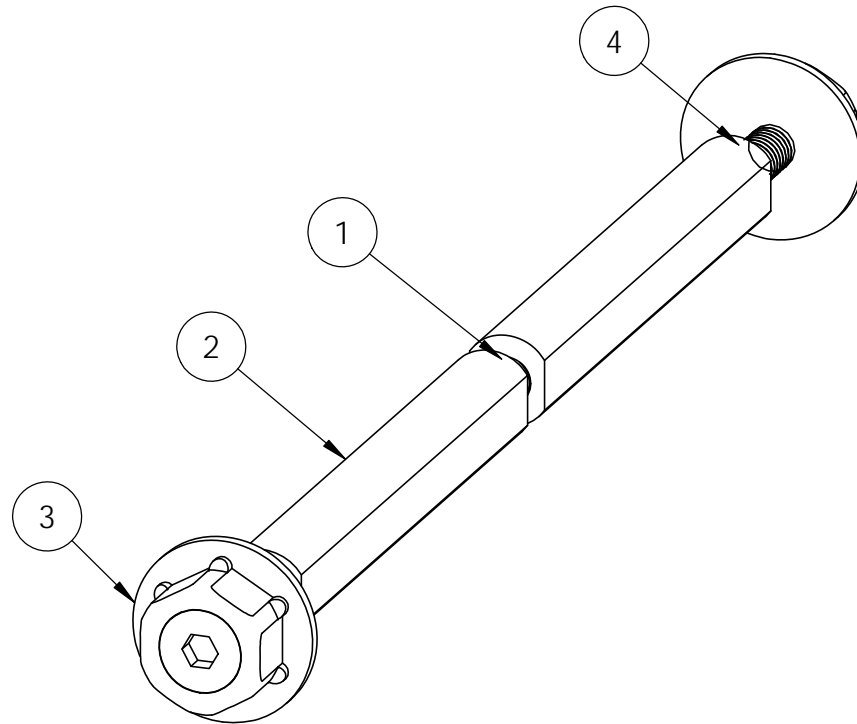

| ITEM NO. | QTY. | PART NUMBER | DESCRIPTION |
|----------|------|-------------|-------------------------------|
| 1 | 1 | 80115 | Stud, 3/8-16 x 2-1/2" |
| 2 | 2 | 80150-40 | Connector, OWT Thru Bolt 4.5" |
| 3 | 2 | 56621 | 1 1/2" Hex Cap Nut |
| 4 | 2 | 80110 | Bolt, Hex 3/8-16 x 1" |

Weight: 0.55 LBS
Scale: 1:1.5
Last updated: 7/13/2015

OWT Timber Bolts

Product & Packaging Specs

Box, OWT Timber Bolts

Item #: Box, Timber Bolt 4-6 & 6-8

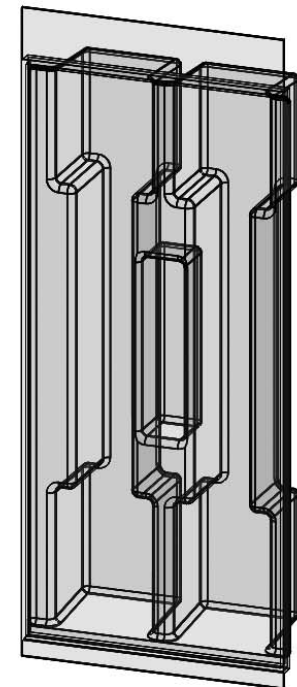
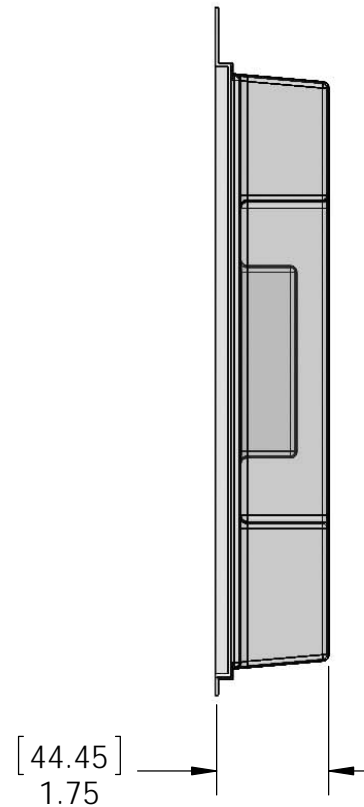
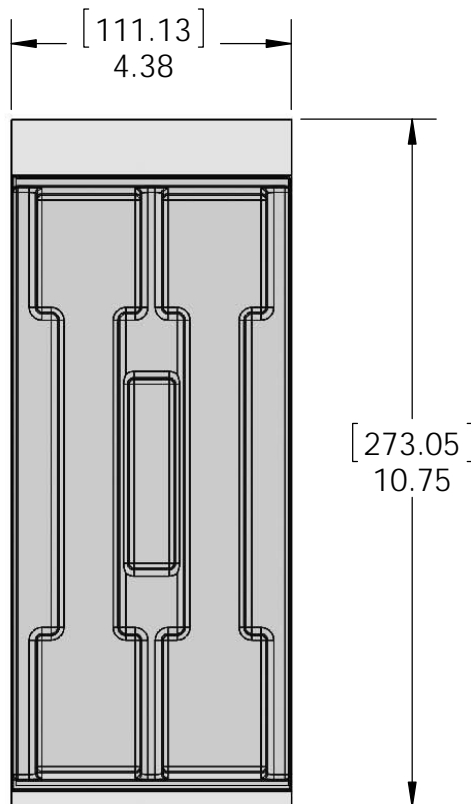

Material: ABS
Finish: Natural
Weight: 0.19 LBS
Scale: 1:3
Last updated: 7/13/2015

OWT Timber Bolts

Product & Packaging Specs

Box, OWT Timber Bolts

Item #: Box, Timber Bolt 8-10 & 10-12

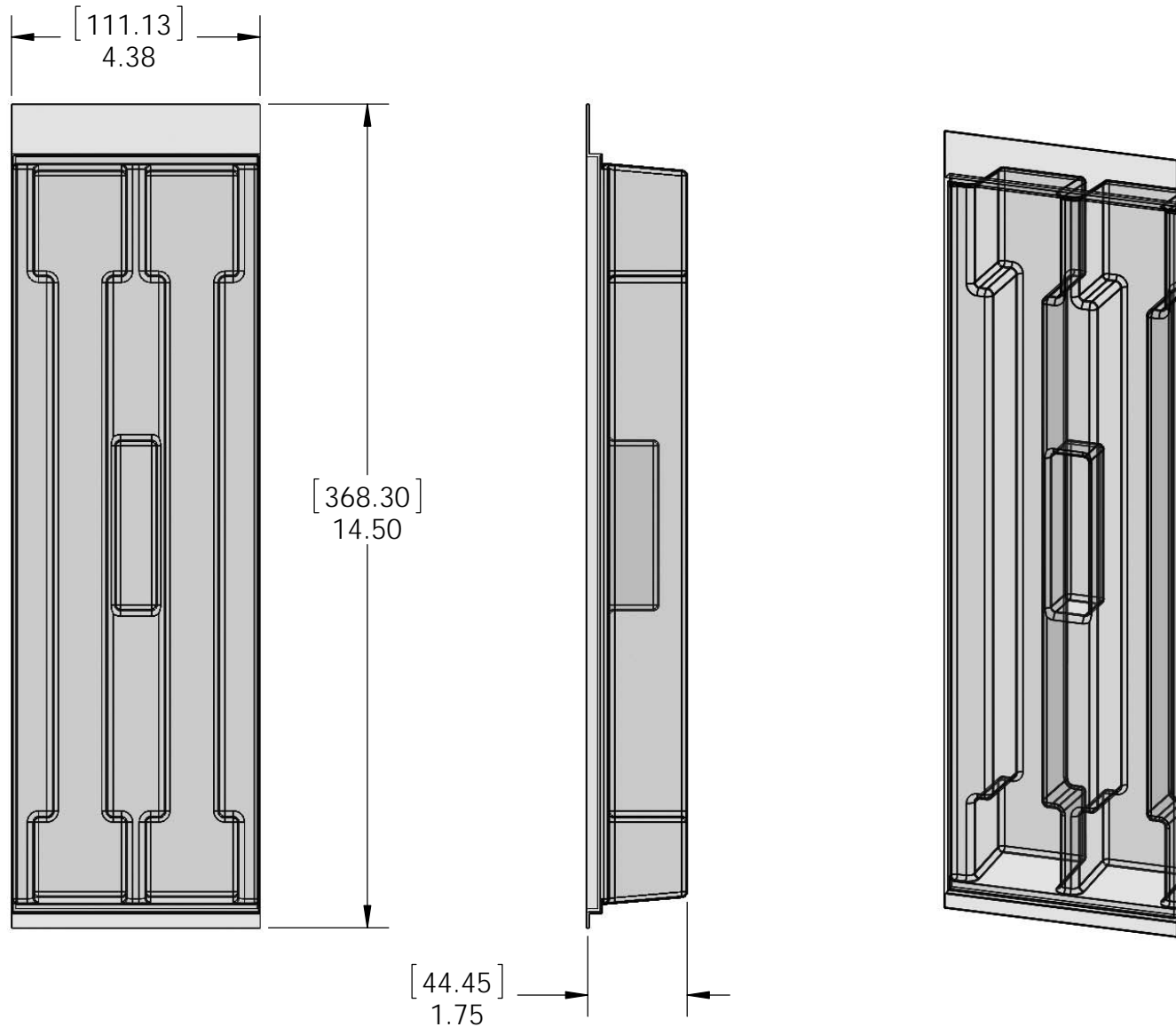

Material: ABS
Finish: Natural
Weight: 0.26 LBS
Scale: 1:2
Last updated: 7/13/2015

OWT Timber Bolts

Product & Packaging Specs

OWT Timber Bolt Packing

Item #: Box packing-56649

| ITEM NO. | Box packing-56649/QTY. | PART NUMBER | DESCRIPTION |
|----------|------------------------|----------------------------|-----------------------|
| 1 | 1 | Box, Timber Bolt 4-6 & 6-8 | Box, OWT Timber Bolts |
| 2 | 2 | 56649 | OWT Timber Bolt 4-6" |

| ITEM NO. | Box packing-56650/QTY. | PART NUMBER | DESCRIPTION |
|----------|------------------------|----------------------------|-----------------------|
| 1 | 1 | Box, Timber Bolt 4-6 & 6-8 | Box, OWT Timber Bolts |
| 2 | 2 | 56650 | OWT Timber Bolt 6-8" |

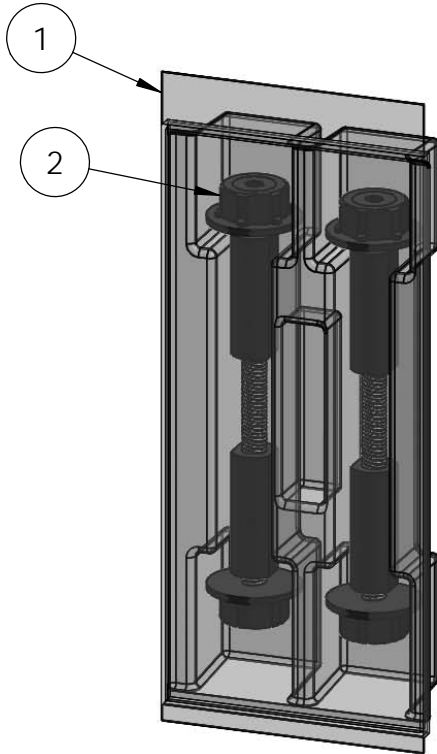

| PART NUMBER | WEIGHT |
|-------------|----------|
| 56649 | 1.27 LBS |
| 56650 | 1.58 LBS |

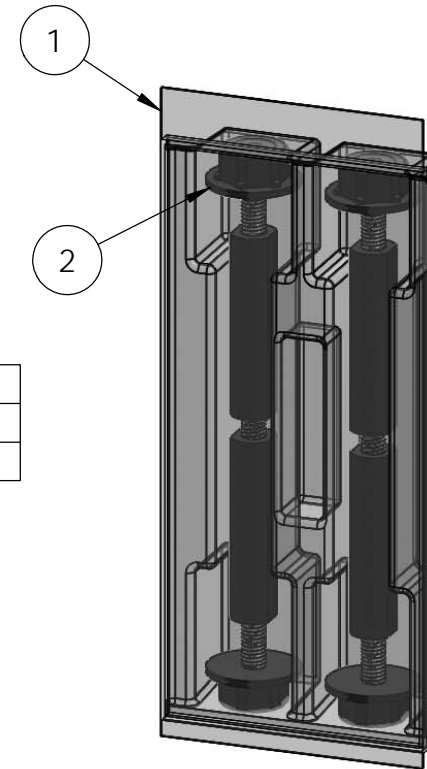

Weight: see table LBS
Scale: 1:3
Last updated: 7/13/2015

OWT Timber Bolts

Product & Packaging Specs

OWT Timber Bolt Packing

Item #: Box packing-56651

| ITEM NO. | Box packing-56651/QTY. | PART NUMBER | DESCRIPTION |
|----------|------------------------|-------------------------------|-----------------------|
| 1 | 1 | Box, Timber Bolt 8-10 & 10-12 | Box, OWT Timber Bolts |
| 2 | 2 | 56651 | OWT Timber Bolt 8-10" |

| ITEM NO. | Box packing-56652/QTY. | PART NUMBER | DESCRIPTION |
|----------|------------------------|-------------------------------|------------------------|
| 1 | 1 | Box, Timber Bolt 8-10 & 10-12 | Box, OWT Timber Bolts |
| 2 | 2 | 56652 | OWT Timber Bolt 10-12" |

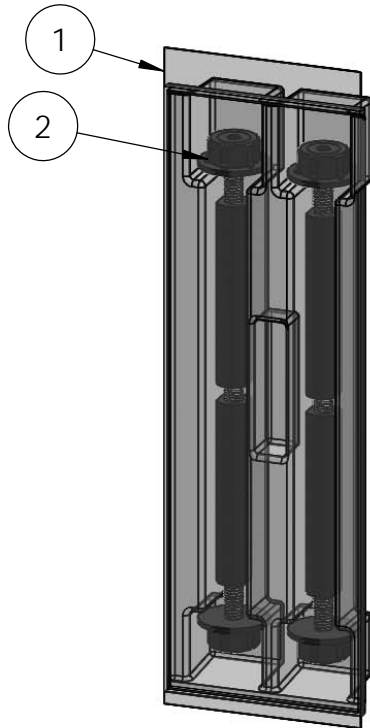

| PART NUMBER | WEIGHT |
|-------------|----------|
| 56651 | 1.89 LBS |
| 56652 | 2.24 LBS |

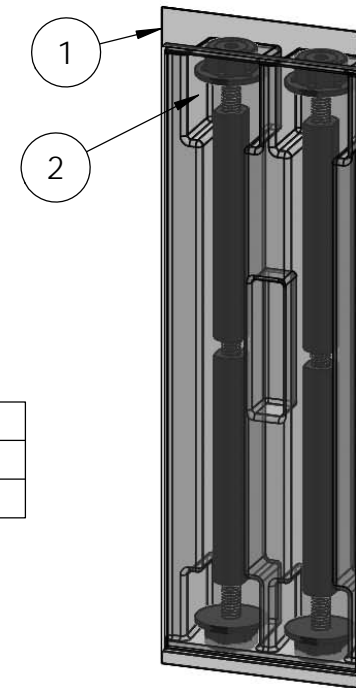

Weight: see table LBS
Scale: 1:4
Last updated: 7/13/2015

OWT Timber Bolts

Product & Packaging Specs

Case, Timber Bolt

Item #: Case, Timber Bolt 4-6 & 6-8

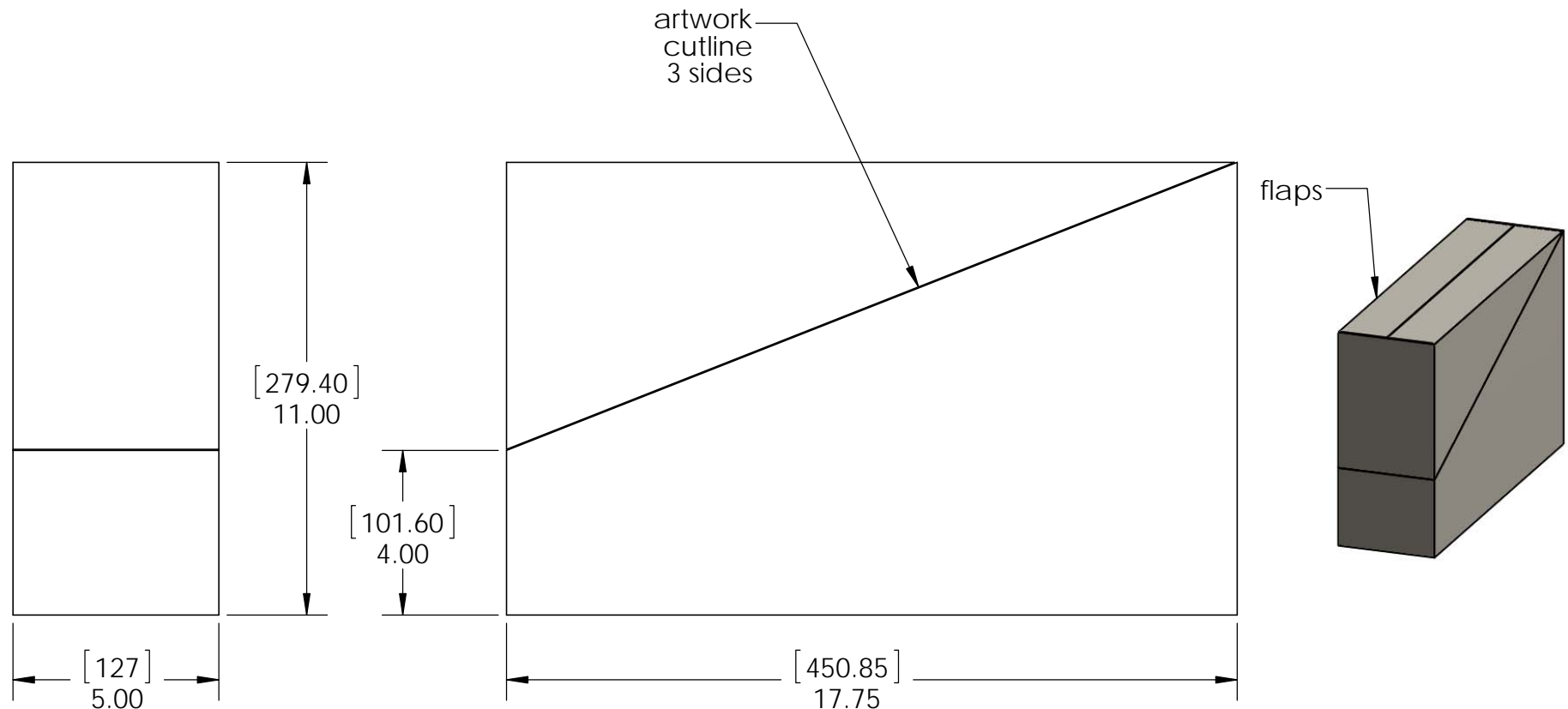

Material: Corrugated Paper
Finish: see artwork
Weight: 0.30 LBS
Scale: 1:4
Last updated: 7/13/2015

OWT Timber Bolts

Product & Packaging Specs

Case, Timber Bolt

Item #: Case, Timber Bolt 8-10 & 10-12

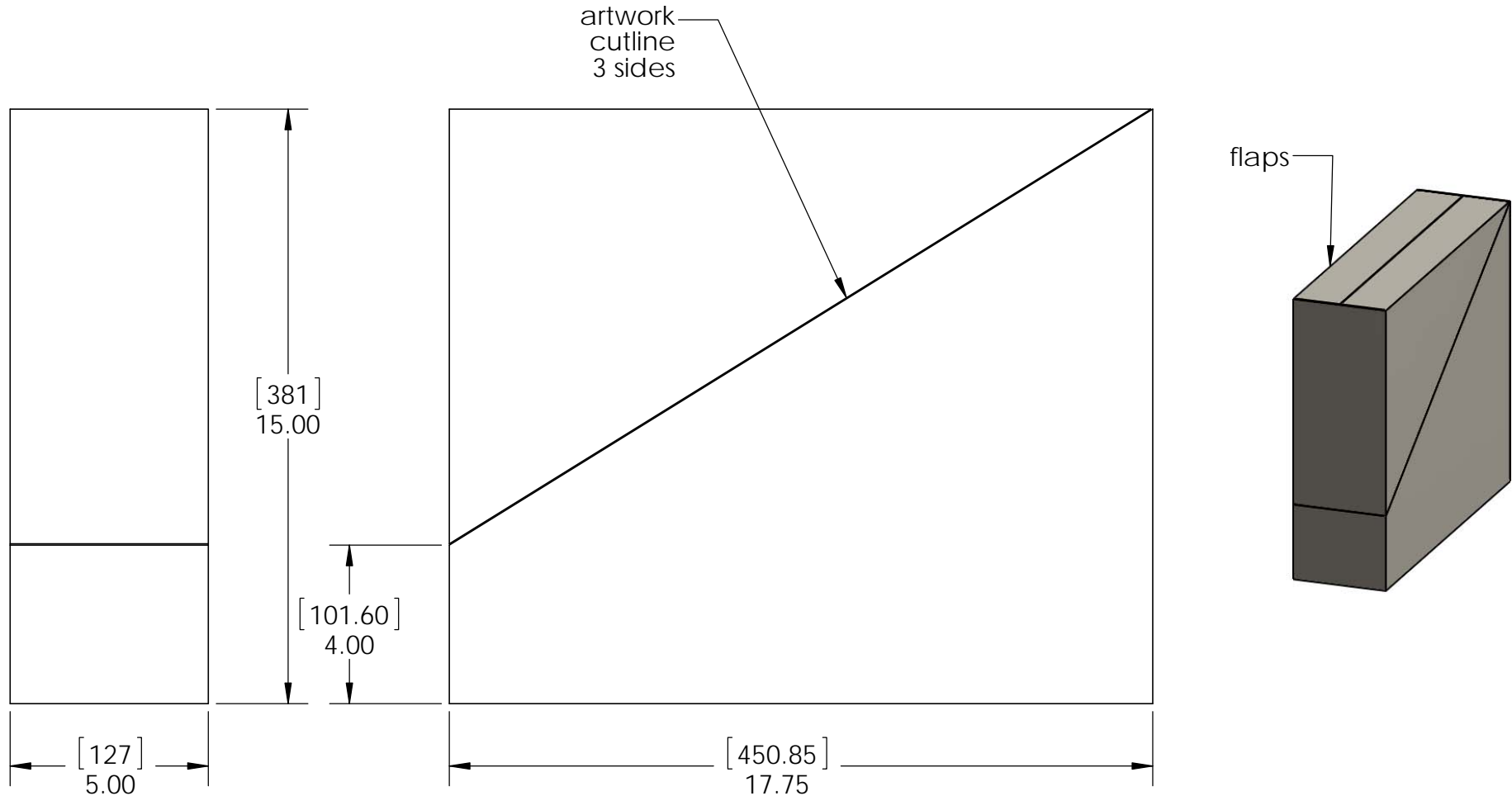

Material: Corrugated Paper
Finish: see artwork
Weight: 0.38 LBS
Scale: 1:4
Last updated: 7/13/2015

OWT Timber Bolts

Product & Packaging Specs

OWT Timber Bolt Packing

Item #: Case packing-56649

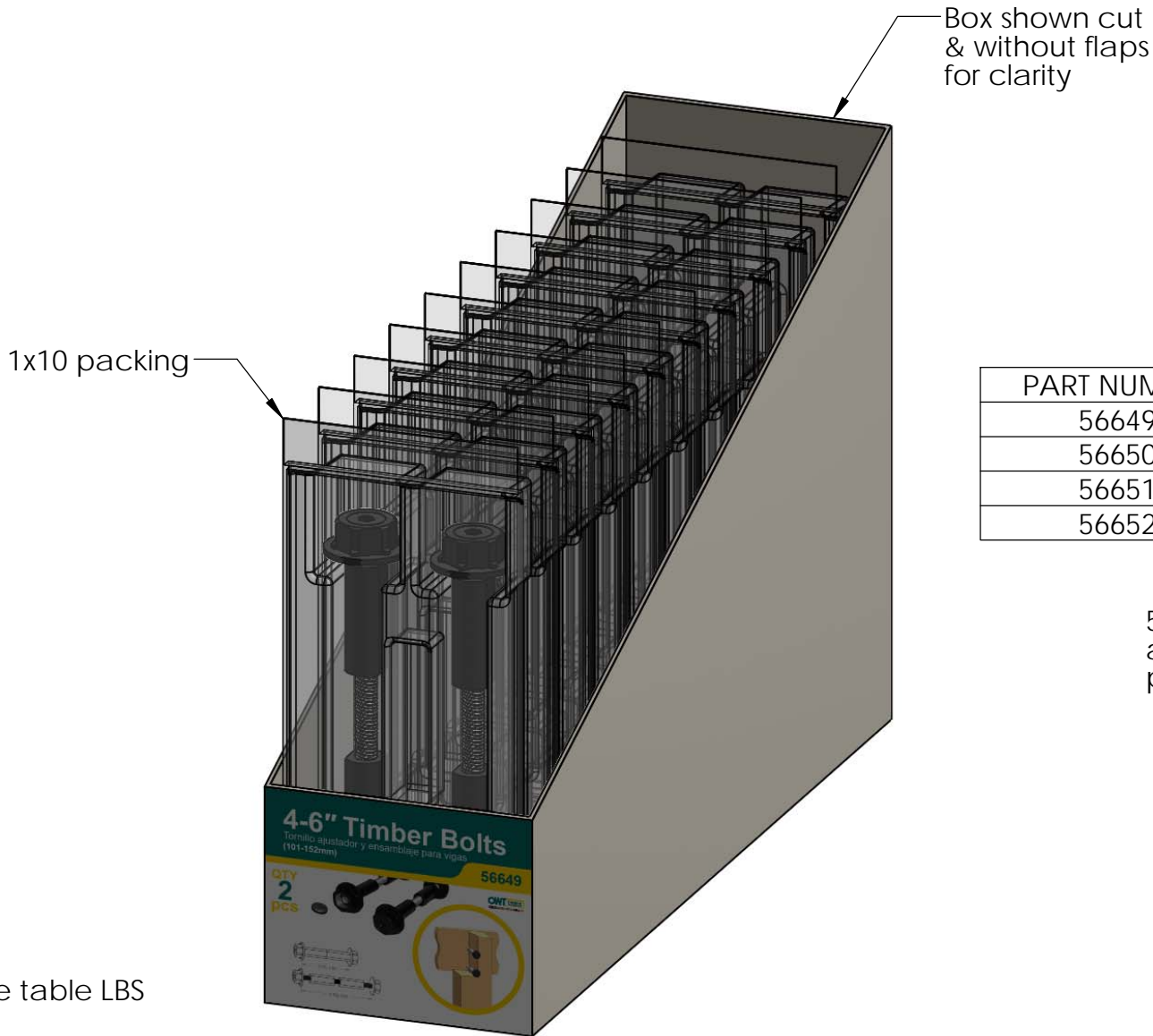

| PART NUMBER | WEIGHT |
|-------------|-----------|
| 56649 | 13.55 LBS |
| 56650 | 16.51 LBS |
| 56651 | 19.88 LBS |
| 56652 | 23.14 LBS |

56649 shown
all other lengths
packed the same

Weight: see table LBS
Scale: 1:3
Last updated: 7/13/2015

OWT Timber Bolts

Product & Packaging Specs

OWT Timber Bolt Packing

Item #: Pallet packing, 56649 & 56650

Item #: **56649** | **BOLT 4-6**

4" - 6" Timber Bolts

PALLET | **320 pcs**

SKU#: **56849**



Weight: 464 lbs

LOT# _____ Priority# _____



Item #: **56650** | **BOLT 6-8**

6" - 8" Timber Bolts

PALLET | **320 pcs**

SKU#: **56850**



Weight: 561 lbs

LOT# _____ Priority# _____

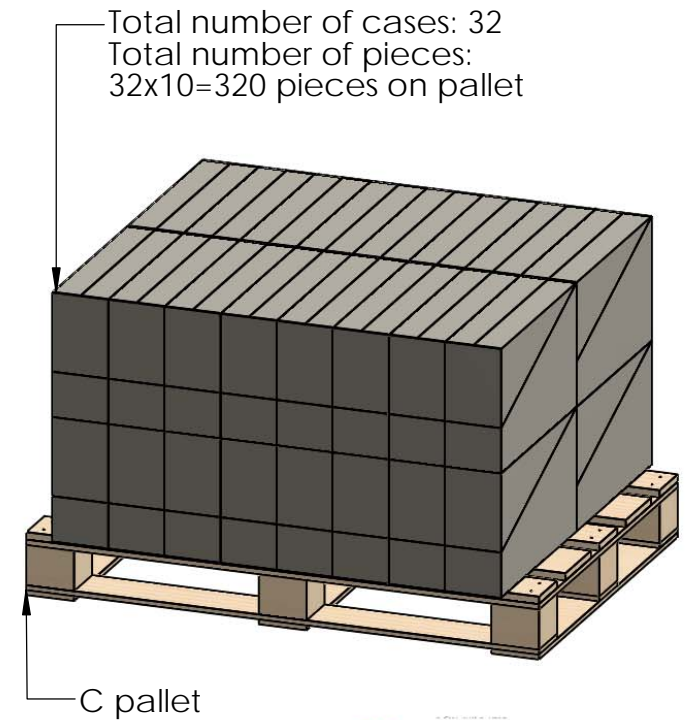
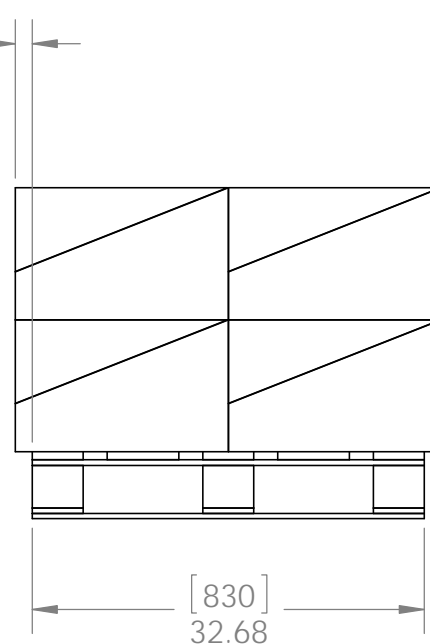
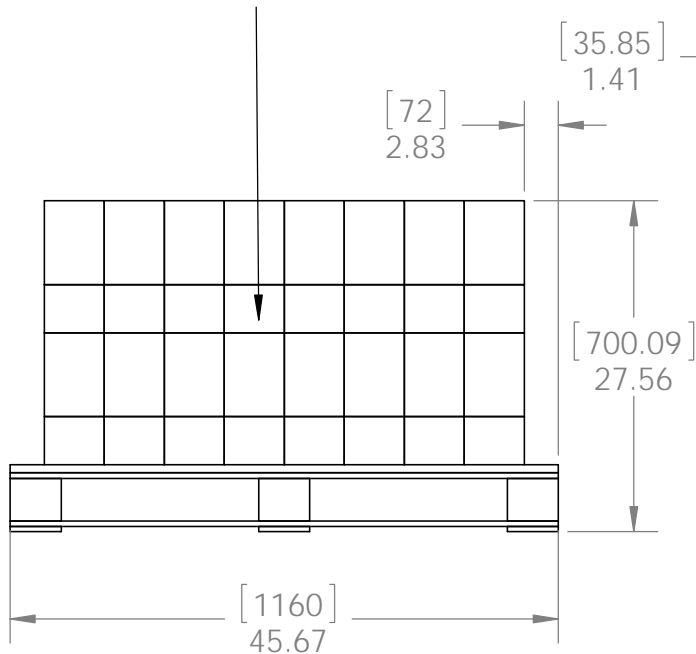

additional pallet packing instructions

- plywood on top layer
- strap to pallet
- clear wrap around boxes

Weight: see label
Scale: 1:2
Last updated: 7/13/2015

OWT Timber Bolts



OZCO BUILDING PRODUCTS

Item #: **56651** | **BOLT 8-10**

8" - 10" Timber Bolts

PALLET | **320 pcs**

SKU#: **56851**



Weight: **686** lbs

LOT# _____ Priority# _____



Product & Packaging Specs

OWT Timber Bolt Packing

Item #: Pallet packing-56651 & 56652

Item #: **56652** | **BOLT 10-12**

10" - 12" Timber Bolts

PALLET | **320 pcs**

SKU#: **56852**



Weight: **778** lbs

LOT# _____ Priority# _____



Total number of cases: 32
Total number of pieces:
 $32 \times 10 = 320$ pieces on pallet

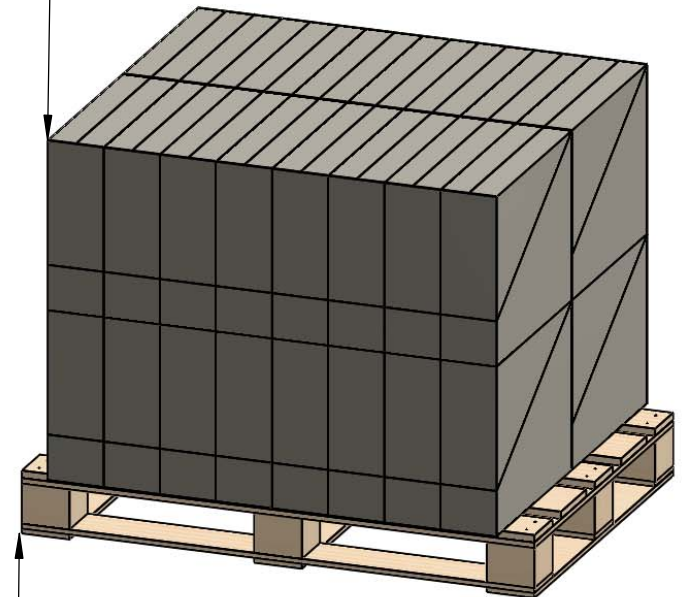

C pallet



additional pallet packing instructions

- plywood on top layer
- strap to pallet
- clear wrap around boxes

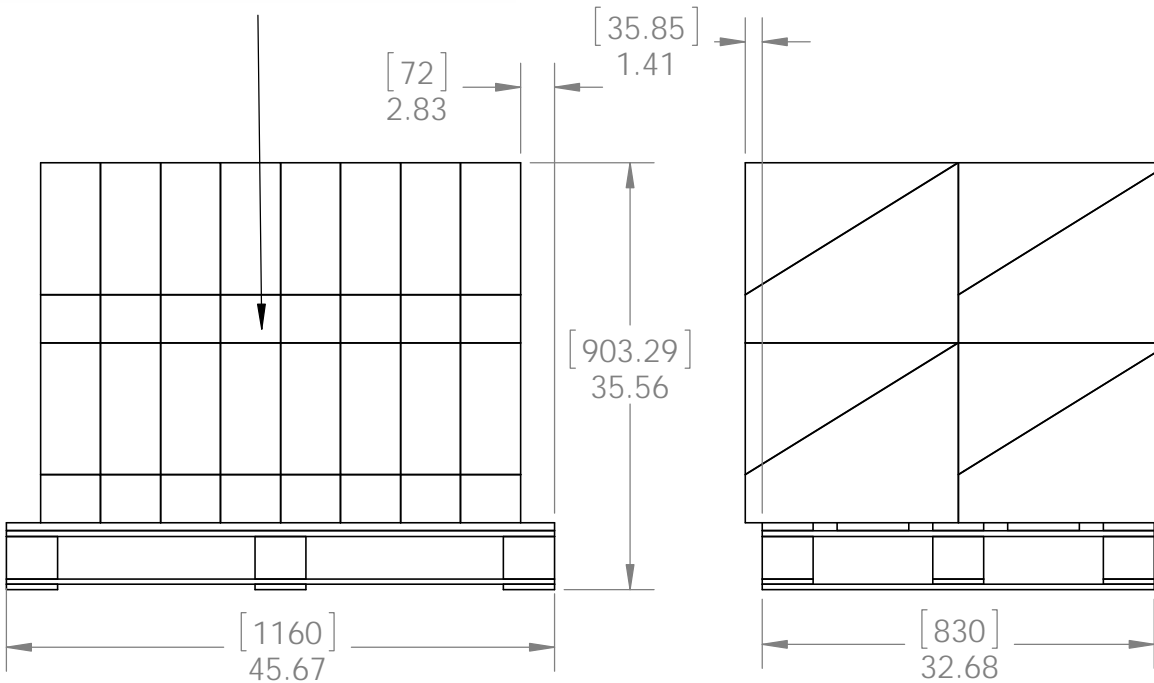

Weight: see label
Scale: 1:2
Last updated: 7/13/2015

OWT Timber Bolts

V1.00 - Installation Instructions effective May 1, 2015 and reflects information that available as of April 10, 2014. This information is updated periodically and should not be relied upon after May 1, 2015. Please visit www.OZCOBP.com to get current information